

Lloyd's Register of Shipping.

SURVEYS FOR FREEBOARD.

(CONDITIONS OF ASSIGNMENT.)

 Index No. _____
 (For London Office only.)

Ship's Name HAKUBASAN MARU Port of Survey NAGASAKI
 Official Number - Surveyor's Signature G. G. Young
 Nationality and Port of Registry JAPAN - TOKYO Date of Survey DURING CONSTRUCTION

Disposition and dimensions of superstructures, trunks, deckhouses and machinery casings to be inserted in the diagrams and tabular statement:—

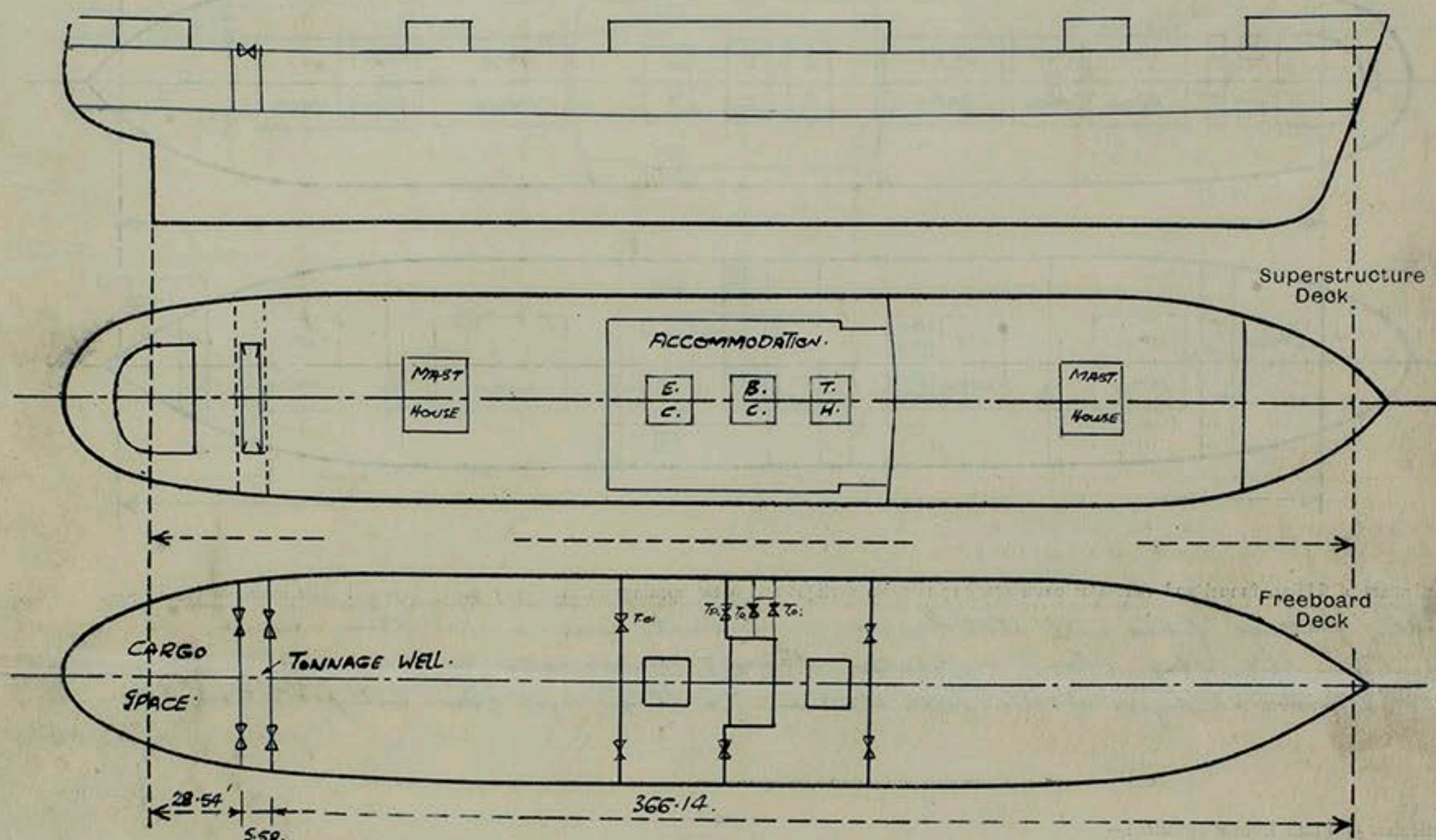

Particulars of Superstructures, Trunks, Casings, Deckhouses.

	Coaming	Plating	Stiffeners	Spacing	End Attachments of Stiffeners	Size of Openings	Height of Sills	Height of Casings
Poop Bulkhead ...	35' ✓	28' ✓	4" x 35" F.L.W.	27 1/2" ✓	NONE ✓	20 36.6" x 51.2"	24" ✓	9.22' ✓
Raised Quarter Deck Bulkhead ...	✓							
Bridge, After Bulkhead ...	35' ✓	28' ✓	D° ✓	D° ✓	D° ✓	20 36.6" x 51.2"	24" ✓	9.22' ✓
Bridge, Forward Bulkhead ...								
Forecastle Bulkhead ...								
Trunk, Aft ...	✓							
Trunk, Forward ...	✓							
Exposed Machinery Casings on Freeboard or Raised Quarter Decks ...	✓							
Exposed Machinery Casings on Superstructure Decks ...	✓							
Machinery Casings within Superstructures not fitted with Class I Closing Appliances ...	32" ✓	28" ✓	3 1/2" x 36" F.B.	33.4" ✓	None ✓	27 1/2" x 63" / 24" x 63"	300" ✓	9.22' ✓
Deckhouses on Flush Deck Ships ...								

Particulars of Closing Appliances (state if capable of being manipulated from both sides).

Poop Bulkhead ...	Steel Boxes 13" Thick in welded channels ✓
Raised Quarter Deck Bulkhead ...	
Bridge, After Bulkhead ...	Steel Boxes 13" Thick in welded channels ✓
Bridge, Forward Bulkhead ...	
Forecastle Bulkhead ...	
Exposed Machinery Casings on Freeboard or Raised Quarter Decks ...	✓
Exposed Machinery Casings on Superstructure Decks ...	✓
Machinery Casings within Superstructures not fitted with Class I Closing Appliances ...	Strong steel doors, capable of being manipulated from both sides ✓
Deckhouses on Flush Deck Ships ...	✓

PARTICULARS OF PROTECTION TO OPENINGS, ETC.

The following diagrams should be used to indicate the positions of cargo and coaling hatchways, gangway, cargo and coaling ports, ventilators, companionways, etc., which would affect the seaworthiness of the ship:—

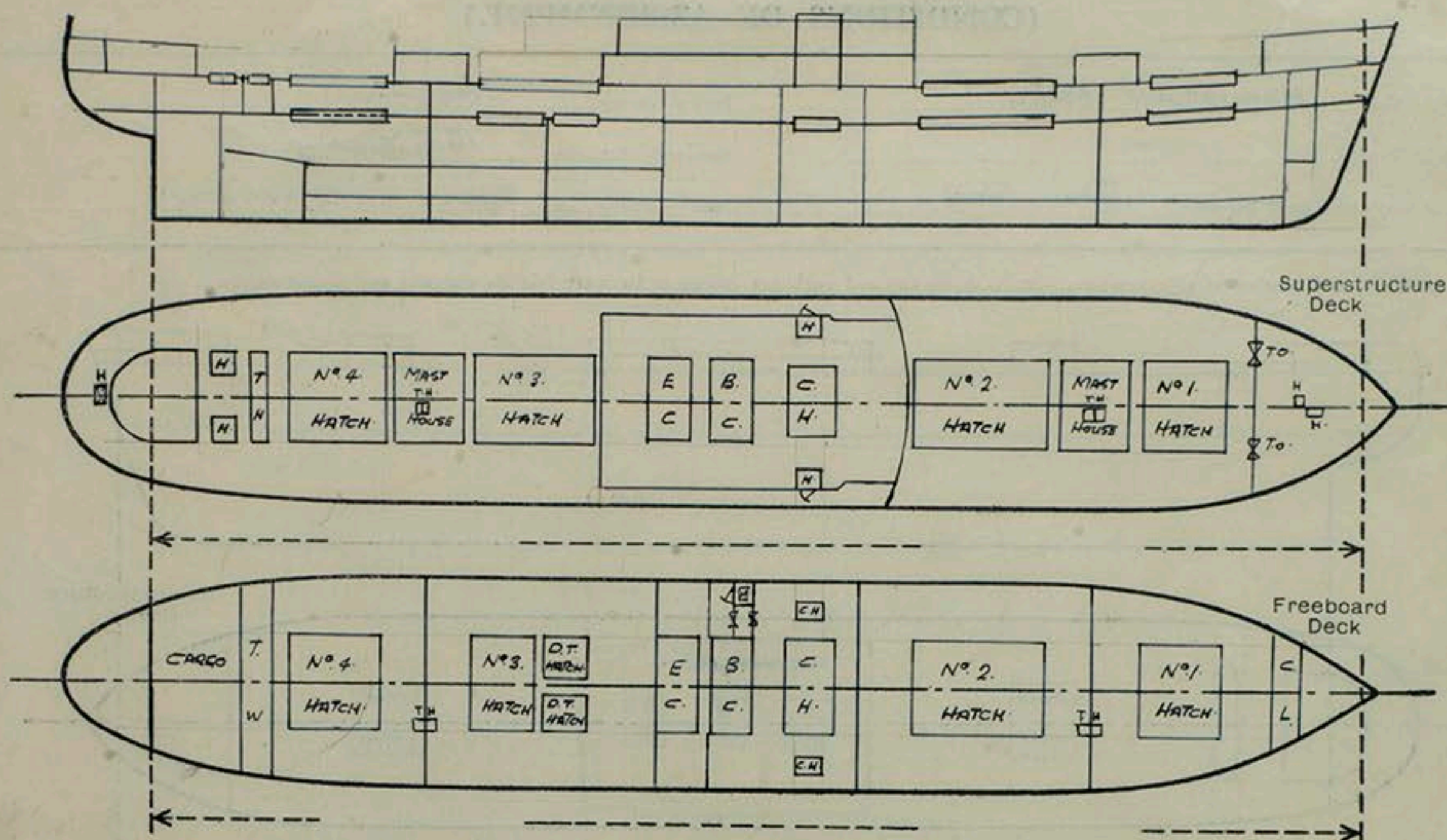

Particulars of fiddle, funnel and ventilator coamings, engine room skylight and other openings in machinery casing tops and their means of closing:—

Fiddle gratings fitted with steel hinged permanently secured steel storm covers.
 Funnel, Boiler & Engine Room ventilators strongly constructed and secured.
 Engine Room skylights of steel with steel hinged flaps and glass with protection bars.

Particulars of Flush Bunker Scuttles:—

none. /

Particulars of Companionways:—
 Masthouses 9^{ft} steel, with steel wpt door 1200 x 750^{ft} with door sill 630^{ft} capable of being manipulated from both sides. Access hatch inside masthouse 590 x 680^{ft} with 75^{ft} coaming with wood plug. / Doors operable from both sides.

Particulars of Ventilators in exposed positions on freeboard and superstructure decks:—

Forecastle Deck: 1-12ⁱⁿ V₁₂ 5 N° 1. TWEEN DECK.
UPPER DECK: 4 @ 25.6ⁱⁿ dia x .55. KING POST.
 2 @ 17.7ⁱⁿ dia x 30ⁱⁿ x 39. Coaming /
 2 @ 21.7ⁱⁿ " x 39. attached to Bridge front
 2 @ 13.8ⁱⁿ " x 36ⁱⁿ x 35. COAMING.
 1 @ 23.6ⁱⁿ " x 36ⁱⁿ x 39. " /

FORE MAST HOUSE
 2 @ 33.5ⁱⁿ dia x .63. King Post.
 2 @ 23.6ⁱⁿ " x 36ⁱⁿ x 39. Coaming /
 1 @ 11.8ⁱⁿ " x 20ⁱⁿ x 35. "

aft Mast House.
 2 @ 33.5ⁱⁿ dia x 63. King Post.
 2 @ 23.6ⁱⁿ dia x 36ⁱⁿ x 39. Coaming /
 1 @ 11.8ⁱⁿ dia x 35ⁱⁿ x 20. "

All Vents closed by wood plugs & canvas covers.

King Post Vents closed by wpt. Screw Covers. /

Particulars of Air Pipes in exposed positions on freeboard, raised quarter, or superstructure decks:—

FORECASTLE DECK
 1 @ 3ⁱⁿ dia 18ⁱⁿ to opening. F.P.T.K.
 1 @ 3ⁱⁿ " " " " F.P.

UPPER DECK:
 1 @ 2ⁱⁿ dia. to Cofferdam.
 2 @ 3ⁱⁿ dia. N° 1 D.B.
 4 @ 4ⁱⁿ dia. N° 2 D.B.
 4 @ 3ⁱⁿ dia. N° 3 D.B.
 1 @ 3ⁱⁿ dia. F.S.D.

UPPER DECK:
 2 @ 3ⁱⁿ dia. Pipe Passage.
 1 @ 2ⁱⁿ " C/D.
 4 @ 3ⁱⁿ " N° 4 D.B.
 2 @ 3ⁱⁿ " R.F.T.K.
 4 @ 3ⁱⁿ " N° 5 D.B.T.K.
 2 @ 3ⁱⁿ " C/D.
 2 @ 2ⁱⁿ " F.W.T.K.
 4 @ 5ⁱⁿ " DEEP T.K.

4 @ 3ⁱⁿ dia. N° 6 D.B.T.K.
 4 @ 3ⁱⁿ " N° 7 D.B.T.K.
 2 @ 3ⁱⁿ " N° 8 D.B.T.K.
 1 @ 3ⁱⁿ " C/D.
 1 @ 3ⁱⁿ " A.P.
 1 @ 4ⁱⁿ " A.P.

Height to all openings on upper Deck 35^{ft}.
 all openings fitted with wpt. covers (changed) /
 Oil lines D.B. T.K. air pipes & 9ⁱⁿ air pipes fitted with gauge.



Lloyd's Register Foundation

Particulars of Gangway Cargo and Coaling Ports:— Ark Port Door Frames 76.7. Port.

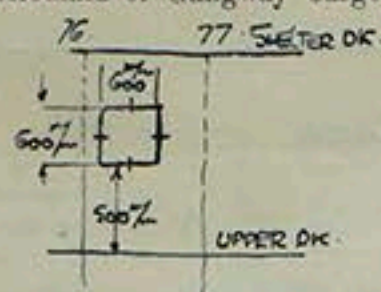

Hinged steel w/T. Door closed from inside with 4 strong steel eyebolts and butterfly nuts. ✓

Particulars of Scuppers and Sanitary Discharge Pipes:—

Shelter Tween Decks for cargo, scuppers drained to bilge and fitted at deck with C.I. drop valve, geared to deckplate on Shelter Deck with indicator to show whether valve is open or closed. ✓
Shelter Tween Deck scuppers from stores drain to hold and E.R. Bilge fitted with C.I. plugs at 2nd Deck. ✓
Tonnage OPENINGS 20.5" dia scuppers discharge through storm valve below Freeboard Deck and are geared to and controlled from the Shelter Deck with indicator to show whether valve is open or shut. ✓
Forecastle scuppers discharge through shell with G.M. Storm Valves ✓
BRIDGE SPACE scuppers discharge through shell below Freeboard Deck with G.M. Storm Valves ✓
Shelter Deck scuppers outside accommodation led overboard below Freeboard^{OK} with shell piece (no Valve) ✓

Particulars of Side Scuttles:—

None. ✓

Vertical distance of Sill of lowest Side Scuttle above top of keel — ✓

Particulars of Guard Rails:— Forecastle upper Rail 1 1/2" dia, 2 Rails 3/4" dia. stanchions 4-6' apart. 3-6" High. ✓
Shelter Deck off. 0". ✓

Particulars of Gangways, Lifelines, etc.:—

Complete Superstructure ✓

Particulars of Freeing Arrangements.						
	Length of Bulwark	Height of Bulwark	Size of Freeing Ports	Number each side	Area each side	Rule area each side
After Well	369.75' ✓	43.31" ✓	4 @ 118" x 9.06" ✓	58.47 ✓	58.47 ✓	28.08 ✓ 35.98 ✓
			2 @ 39" x 9.06" ✓			
			3 @ 102.36" x 9.06" ✓			
Forward Well			1 @ 90.55" x 9.06" ✓			
State position of each freeing port { After Well :— (F. and A. position and height above deck edge) { Forward Well :—						
State whether the freeing ports are fitted with shutters, bars, or rails, and give particulars of such :— not fitted .						
Additional area where sheer is less than standard.						

PARTICULARS OF PROTECTION TO OPENINGS, ETC.

HATCHWAYS ON FREEBOARD AND SUPERSTRUCTURE DECKS.													Tonnage Opening	Boat Deck
SUPERSTRUCTURE DECK.					FREEBOARD DECK.									
Description of Hatchway	Nº1.	Nº2.	Nº3.	Nº4.	Nº5.	Nº1.	Nº2.	Nº3.	Nº4.					
Dimensions of Hatchway	27'72" x 22'97"	44'62" x 22'97"	47'41" x 22'97"	33'46" x 22'97"	7'54" x 6'55"	27'72" x 22'97"	47'41" x 22'97"	33'46" x 22'97"	33'46" x 22'97"	22'97" x 4'27"	14'00" x 14'8"			
COAMINGS	Height above Deck	30"	30"	30"	30"	30"	9.06"					30"		
	Thickness	51"	51"	51"	51"	51"	.43 Ba.					.44		
	Stiffeners	5/8" x 3 1/2" x 11'8" x 3 1/2" x 11'8"	5/8" x 3 1/2" x 11'8" x 3 1/2" x 11'8"	5/8" x 3 1/2" x 11'8" x 3 1/2" x 11'8"	5/8" x 3 1/2" x 11'8" x 3 1/2" x 11'8"	5/8" x 3 1/2" x 11'8" x 3 1/2" x 11'8"	5/8" x 3 1/2" x 11'8" x 3 1/2" x 11'8"	5/8" x 3 1/2" x 11'8" x 3 1/2" x 11'8"	5/8" x 3 1/2" x 11'8" x 3 1/2" x 11'8"	5/8" x 3 1/2" x 11'8" x 3 1/2" x 11'8"	5/8" x 3 1/2" x 11'8" x 3 1/2" x 11'8"	5/8" x 3 1/2" x 11'8" x 3 1/2" x 11'8"	5/8" x 3 1/2" x 11'8" x 3 1/2" x 11'8"	
	Brackets, Stays	3/4" x 3/4" x 77" apart	3/4" x 3/4" x 77" apart	3/4" x 3/4" x 77" apart	3/4" x 3/4" x 77" apart	3/4" x 3/4" x 77" apart	3/4" x 3/4" x 77" apart	3/4" x 3/4" x 77" apart	3/4" x 3/4" x 77" apart	3/4" x 3/4" x 77" apart	3/4" x 3/4" x 77" apart	3/4" x 3/4" x 77" apart	3/4" x 3/4" x 77" apart	
HATCH BEAMS	Number	4	7	8	5	4	8	5	5		2			
	Spacing	5'54"	5'58"	5'27"	5'58"	5'54"	5'27"	5'58"	5'58"		4'65"			
	Scantling and Sketch	21'26" x 39"	21'26" x 39"	21'26" x 39"	21'26" x 39"	21'26" x 39"	21'26" x 39"	21'26" x 39"	21'26" x 39"	21'26" x 39"	21'26" x 39"	21'26" x 39"		
	Bearing Surface	3'94"	3'94"	3'94"	3'94"	3'94"	3'94"	3'94"	3'94"	3'94"	3'94"	3'94"		
FORE AND AFTERS	Number	None	None	None	None	None	None	None	None	None	None			
	Spacing	None	None	None	None	None	None	None	None	None	None			
	Unsupported Lengths	None	None	None	None	None	None	None	None	None	None			
	Scantling and Sketch	None	None	None	None	None	None	None	None	None	None			
HATCH COVERS	Material	W.P.	W.P.	W.P.	W.P.	W.P.	W.P.	W.P.	W.P.	W.P.	W.P.			
	Thickness	2'95"	2'95"	2'95"	2'95"	2'95"	2'95"	2'95"	2'95"	2'95"	2'95"			
	How fitted	F&A	F&A	F&A	F&A	F&A	F&A	F&A	F&A	F&A	F&A			
	Bearing Surface	4'67"	4'67"	4'67"	4'67"	4'67"	4'67"	4'67"	4'67"	4'67"	4'67"			
Spacing of Cleats	2'	2'	2'	2'	2'	2'	2'	2'	2'	2'	2'			
Number of Tarpaulins	2	2	2	2	2	2	2	2	2	2	2			
*Are wood fore and afters steel shod at all bearing surfaces?													Yes	
Are battens and wedges efficient and in good condition?													Yes	
Are tarpaulins in good condition and in accordance with rule requirements?													Yes	
Are lashings provided in accordance with rule requirements?													Yes	

Particulars of any special features:—

COAL BUNKER HATCH (FREEBOARD DECK). 4250 x 4500 mm. 230 x 90 mm 11% Ba Coaming. Cleats 610 apart. Wood covers 75% 1 Tarpaulin.

DEEP TANK HATCHES. 2ND DECK 11'15" x 8'20" Coaming. 11'81" x 5'51" with 43" O.T. Steel Hatch covers.

TRIMMING HATCHES. FREEBOARD DECK. Nº 1, 2, 3, 4. 560 x 620 mm with 230 x 97 mm Coaming } all fitted with hinged steel 9" W.T. covers secured by eyebolts and toggles.

TRIMMING HATCHES TO COAL BUNKER. 1700 mm x 1520 with 230 x 75 x 43 Ba. 75% wood hatches and cleats spaced 610 mm apart 1 Tarpaulin.

FORECASTLE DECK. Rope Hatch. 550 mm dia x 520 x 12.5% Coaming with hinged W.T. Cover secured by eyebolts and butterfly nuts.

SHELTER DECK. Forecastle Hatch. 1200 x 610 mm. Wood Hatch 75% Coaming with cleats and 1 Tarpaulin. 600 x 610 mm.

AFT. (BOYS STORE). 850 x 560 mm x 410 x 11 mm Coaming with W.T. Steel Cover secured by eyebolts and butterfly nuts.

BOAT DECK. (P+5) 1730 x 2060 mm Coaming 700 x 11 mm cleats spaced 610 mm with 75 wood covers and 2 Tarpaulins.

ASH EJECTOR DISCHARGE Through shell is fitted with an automatic non return valve. controlled from

BOILER ROOM ESCAPE HATCH. P.5. 78.79. on the Freeboard Deck is enclosed by a steel bulkhead with a hinged steel door, 9" coaming.

ASH EJECTOR deck opening is surrounded by a steel coaming 500 x 9 mm and the opening plated over.

ACCESS DOOR TO COAL BUNKER } W.T. Steel Door 600 x 1000 mm 580 mm door sill. Hinged and secured by 6 Toggles. openable from both sides.

TRIMMING HATCH (P.5. SHELTER DECKHOUSE)

X Length of ash ejector pipe minimal. and non return valve permanently closed. Connected to oil burning.