

Lloyd's Register of Shipping.

Ship's Name

"FELSPAR."

Official No. 128199.

Memorandum of alterations reported since ship was surveyed for assignment of Load Lines in FORECASTLES; ESCAPE HATCH, FOREHOLD; BULWARKS IN FORE WELL.

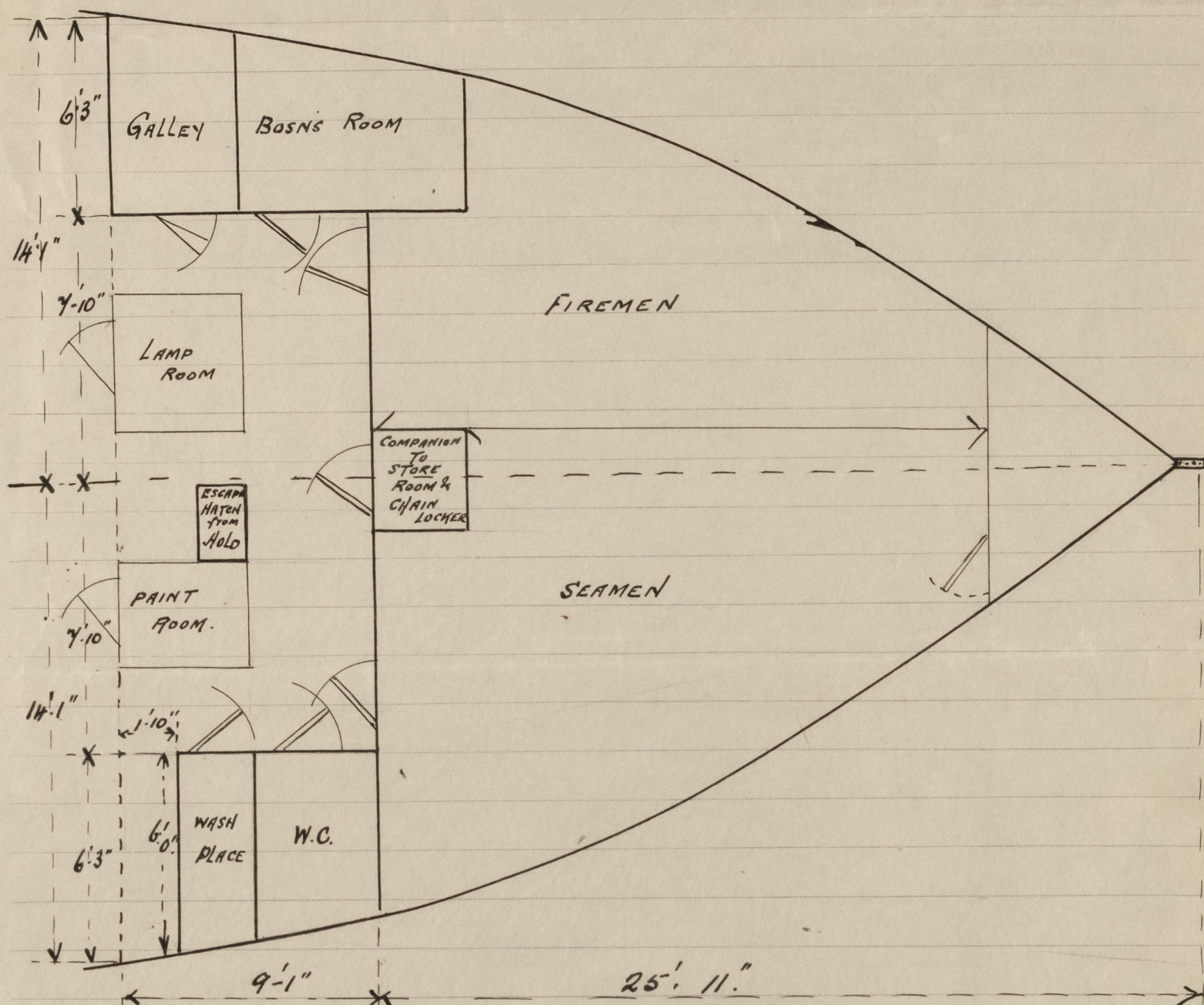

Companion in Fore-castle deck dispensed with and opening in deck plated over. Trunkway to original crew space (below Freeboard deck) remains with doorway cut in front leading to store room and chain locker (which was the original crew space). Space between Fore-castle & Freeboard Deck, has now been fitted out to accommodate crew etc. with bulkheads, doors etc. as per approved plan. All doors to Fore-castle spaces are hinged solid wood $1\frac{3}{4}$ " thick, except Galley door which is steel $4\frac{5}{8} \times 1-11$ " - 18" craming, operated from both sides.

Escape Hatch reduced in size from $1\frac{7}{8} \times 7\frac{11}{16}$ " to $1\frac{1}{4} \times 2\frac{1}{2}$ "

24" craming $\frac{3}{8}$ thick $2\frac{1}{2}$ " wood cover, efficiently battened.

Bulwark in fore well reduced in height from 4'3" to 3'6"

M. Macleod.

(Wokingham)