

S. S. Nos 611 & 612.

MIDSHIP SECTION.

SCALE $\frac{1}{2}$ INCH = ONE FOOT

LENGTH 240'-0" B.P.
BREADTH M^{LD} 34'-0"
DEPTH M^{LD} 16'-4"
LLOYDS CLASS 100 A.I.

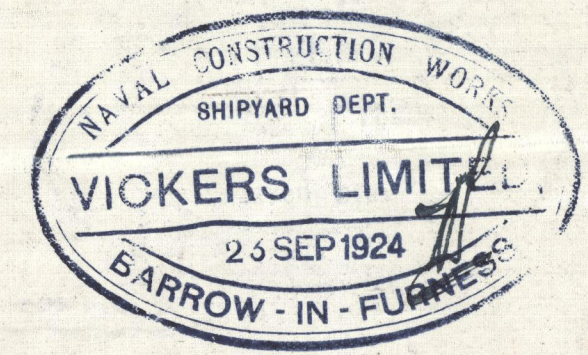

LLOYDS NUMERALS.

B + D = 50.4 TRANSVERSE N°
L (B + D) = 12,080 LONGITUDINAL N°
 $\frac{L}{B}$ UPPER DECK = 14.7
 $\frac{L}{B}$ BRIDGE DECK = 9.8
 $\frac{L}{d}$ = 13.6

EQUIPMENT NUMERALS.

L (B + D) = 12,080.
FORECASTLE (648 x 8.0 x .75) = 370
BRIDGE & POOP (1462 x 8.0 x .75) = 877
DECKHOUSES (71 x 7.5 x .5) = 266
13593

EQUIPMENT.

2 BOWER ANCHORS, STOCKLESS 28 CWT. EACH.
1 " " " 24 " "
1 STREAM ANCHOR 7 CWT. EX. STOCK
240 FATHOMS $1\frac{7}{8}$ " STUD LINK CABLE.
75 " 3" STREAM WIRE.
30 " 10" TOWING HAWSER.
2 AT 30 " 3" F.S.W.R.
4 " 60 " 2" "
2 " 60 " 2" "
4 " 30 " 4" MANILLA

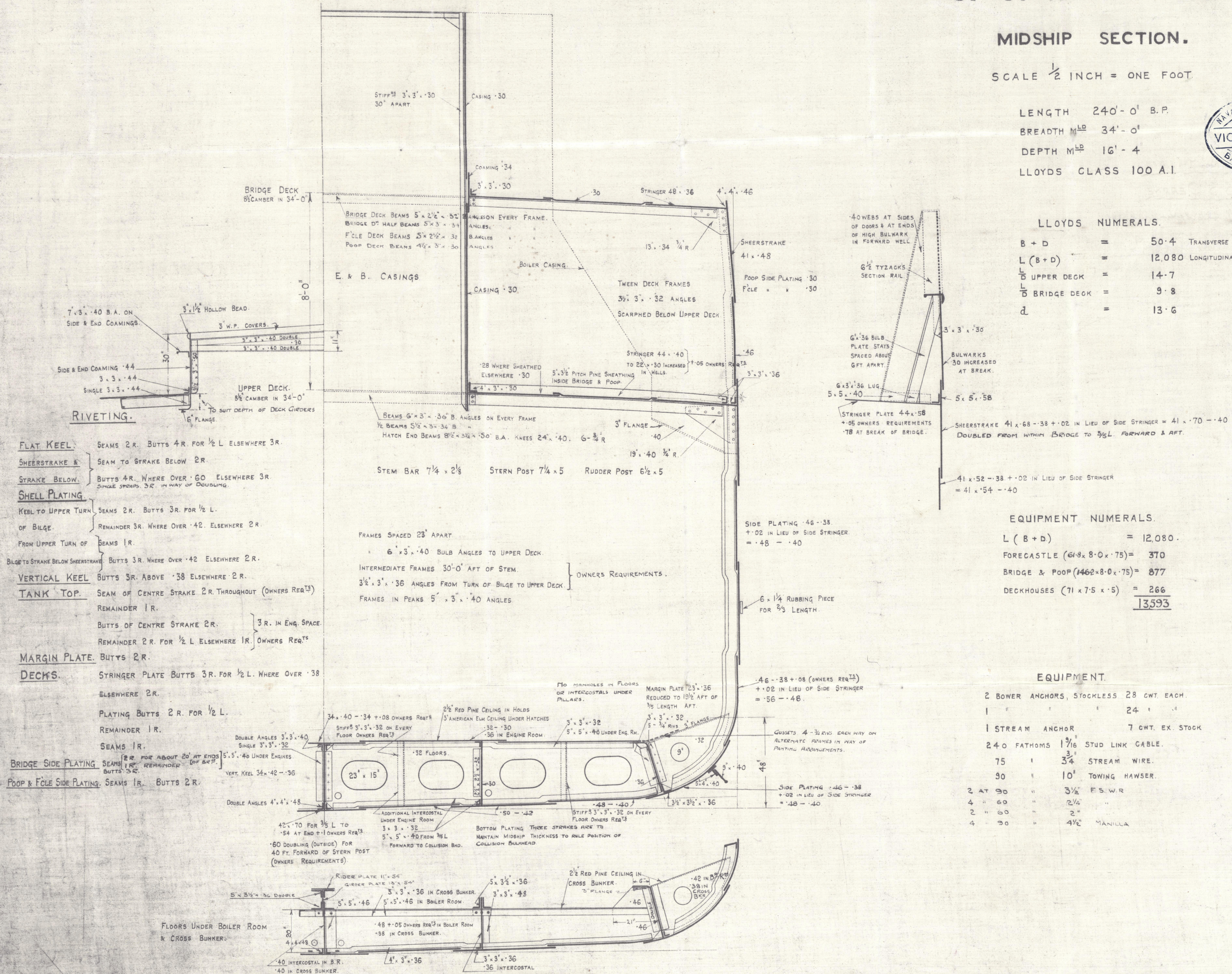

Vickers Ltd No 611

S. S. DEARNE

Midship Section as built

Barrow Report No 2081



© 2021

Lloyd's Register
Foundation

002085-002093-0055