

Lloyd's Register of Shipping.

Ship's Name "W A L B O R G"

Official No. 2969

Memorandum of alterations reported since ship was surveyed for assignment of Load Lines
in Hälsingborg.

Alterations:

Wood sheathing on bridge deck outside deckhouse removed and bulwark stiffeners attached to deck plating. The skylights, port and starboard, to accommodation forward in bridge replaced by closed steel skylights.

The poop deckhouse has been increased in length to a point 14.8' forward the aft perpendicular. The size does not interfere with the equipment number.

Hatch beams: The aftermost hatch beam in No.2 hatch cropped down to 575 - 750 instead of 930 - 1100 and lower angle replaced by a welded flat bar 100 x 10.

The two beams in No.3 hatch replaced by new beams as per sketch.

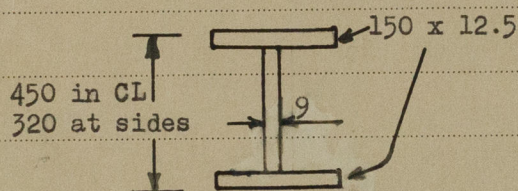

The coal bunker hatches on bridge deck replaced by 3 new ones each side, 1150 x 1000 and 460 x 10 mm. coaming, 2 1/2" cover, two tarpaulins, 2 1/2" bearing surface and 610 mm. spacing of cleats.

GOTHENBURG.
27.11.1947.

Hannu Kari



© 2020

Lloyd's Register
Foundation

002094002/00-0009