

Lloyd's Register of Shipping.

SURVEYS FOR FREEBOARD.—STEAM SHIPS.

PARTICULARS RELATING TO ALL STEAM SHIPS EITHER FLUSH DECKED, OR WITH GALLANT FORECASTLES, SHORT POOPS AND BRIDGE HOUSES DISCONNECTED, OR WITH TOP GALLANT FORECASTLES HAVING LONG POOPS, OR RAISED QUARTER DECKS CONNECTED WITH BRIDGE HOUSES, OR OTHERWISE.

Port of Survey London.Date of Survey 6 Dec 1923.Name of Surveyor C. M. Glashan

Ship's Name

ESTORIL

Port of Registry and Nationality.

British

Official Number.

147573

Gross Tonnage.

538

Date of Build.

1920

Particulars of Classification.

100A - (Class contemplated).Number in Register Book 19425.

Registered dimensions from Ship's Register.	LENGTH.	BREADTH.	DEPTH.	UNDER DECK TONNAGE.
	<u>163.3</u>	<u>25.65</u>	<u>10.8</u> <u>10.4</u>	<u>380.5</u> <u>377.9</u>
Length on LOADLINE.	<u>164.10"</u>	Frame Depth <u>4 3/4</u> Rule <u>3</u> <u>-29</u>	Ceiling <u>fitted</u> Sheer <u>+1.44</u> <u>10.88 L.T.T.</u>	Peak Tanks <u>Hammurabi</u> <u>-6.5 tons</u>
CORRECTED DIMENSIONS.	<u>164.83</u>	<u>25.36</u>	<u>11.32</u>	<u>371.4</u>

Co-efficient of fineness..... .48
Any modification necessary { C.O.B
[Para. 4 (a) to (e)]*
Co-efficient as corrected76

Sheer { Stem..... 5.18 } 87 ÷ 2 = 43.5 Mean 36.1579
at { Sternpost 3.678 }
Sheer at 1/4 of the length from { Stem 24 } 46.5 ÷ 2 = 23.25 Mean 21
{ Sternpost 22.2 }
Gradual mean Sheer 42.27 23.25
Standard mean Sheer [Table, Para. 18] 26.48 15.89 Correction
Difference..... 15.79 7.36 ÷ 4 = 1.84
§ If limited as Para. 18 (f) 3.95
-4 Par. 11 * -1 3/4 Par. 14

Rise in Sheer { At front of bridge house.....
from amidships {
[Para. 18 (e)] { At after end of forecastle

Fall in Sheer {
Para. 18 (d) { ÷ 2 =
Length uncovered Correction

ALLOWANCE FOR DECK ERECTIONS:— Par. 11 Par. 14
Freeboard, Table C..... 0.5 0.5
Correction for Length, if required (Para. 12, 13, and 14) + 1/2
Freeboard by Table A. corrected for sheer and for length Par. 11 Par. 14
if required (Para. 12, 13, and 14) { 1.4 3/4 2.0 1/4
Difference 1.2 3/4 1.7 1/4
Percentage as below..... 40% 32%
Par. 11 -4 +1/2 -5 1/2 -9 @ .60 -5.90 6.24
.14 -1 1/4 +1 -6 1/4 = -7 @ .50
for erections covering 538 area = -8 1/4
Correction for R. Q. Dk. if engine and boiler openings not covered by bridge house (Para. 11) { +2.29
Allowance for Deck Erections 5.61 -5 1/2 -6 1/4

	Length.	Length allowed.	Height.
Forecastle.....	<u>22.9"</u>	<u>22.15</u>	<u>7.2</u>
Bridge House	<u>12.8</u>	<u>12.67</u>	<u>7.0</u>
† Raised Qr. Dk.....	<u>57.2</u>	<u>57.17</u>	<u>4.0</u>
Poop.....	<u>9.2.4"</u>	<u>91.99</u>	<u>= .558</u>
Total	<u>1.64.10"</u>	<u>164.83</u>	
Corresponding percentage { (Para. 11, 12, 13, or 14)			

FREEBOARD recommended amidships from centre of Disc to top of Statutory Deck Line, Wood (Iron) Deck:—

Fresh Water Line above centre of Disc
Indian Summer Line " " "
Winter Line below " "
Winter North Atlantic Line " " "

28 DEC 1923

† If the frames, skin planking, or ceiling are of unusual thickness the breadth of vessel to inside of ceiling should be reported if possible.
† In vessels obtaining an allowance for deck erections under Para. 11 where the sheer drops abaft amidships the height of the R.Q.D. is to be taken from the level of the top of the amidship beam.
† In flush-decked vessels the total standard mean sheer means the sheer measured at the stem and sternpost. In vessels having poops and forecastles, it means the sheer measured at points distant one-eighth of the vessel's length from stem and stern-post.

Moulded Depth as measured..... 12.11"

Addition for Keel below base line
for draught record..... 1/2 inches.

CORRECTION FOR LENGTH.

Length of Ship on Loadline..... 164.83
Length in Table 155.0
Difference 9.83
Correction for 10ft., Table A.9 Table C. .5
× Difference divided by 1089 (if required.) .49
If 1/10ths length covered divide by 2 +1" Par. 14 +1/2" Par. 14

CORRECTION FOR IRON DECK.

Proportion covered, if less than 1/10ths length covered558
Thickness of usual wood deck, less stringer 3" -1 3/4"

CORRECTION FOR ROUND OF BEAM.

Breadth at Gunwale amidships..... 25.4"
Round of Beam 8"
Normal round..... 6.35
Difference 1.65 ÷ 2 =82
Proportion of Deck uncovered (Para. 19)44 .36 X. -1/2

Freeboard, Table A 1.11 3/4Correction for Sheer -8 1/4Correction for Length -8 1/4Allowance for Deck Erections 1.3 1/2Correction for Round of Beam..... -1/2Correction for fall in Sheer (if any)..... 1.3Correction for Iron Deck (if required) -1 3/4Additions for non-compliance with provisions of {
Para. 11 (d) and (e) †

Other Corrections (if any)

Winter Freeboard 1.11 1/4Summer Freeboard 1 1/2Indian Summer Freeboard 1 1/4N. A. Winter Freeboard 1 1/4

Correction necessary because clearside amidships, measured
in accordance with the Statute is not taken at the
intersection of the wood or iron deck with side. +1 1/4

Winter Freeboard from deck line 1.2 1/2Summer " " " " 1.1Indian Summer " " " " 1 1/4N. A. Winter " " " " 1 1/4

† State dimensions of freeing port area on back of this form.

† The Surveyor should state whether the fall in sheer as reported is measured relatively to the straight line of keel or to the water line. If measured relatively to water line the vessel's draft at time of survey, and also the usual load draft forward and aft should be reported.

MARKING FORM

RECEIVED 20 JUN 1928

MARKING FORM

RECEIVED 9 JAN 1924

Do all the Frames extend to the top height in the Poop? *Yes* ✓ Raised Quarter Deck? *Yes* ✓ Bridge House? *Yes* ✓ Forecastle? *Yes* ✓
 To what height do the Reverse Frames extend? *None* ✓
 Has the Poop or Raised Quarter Deck an efficient Iron Bulkhead at the fore end? *Yes* ✓
 Give particulars of the means for closing the openings in Bulkhead *None* ✓
 Is the Poop or Raised Quarter Deck connected with the Bridge House? *Yes* ✓ Has the Bridge House an efficient Bulkhead at the fore end? *Yes* ✓
 Give particulars of the means for closing the openings in Bulkhead *None* ✓
 What is the thickness of the Bridge Front plating? *6/20* ✓ and Coaming plate? *6/20* ✓
 Give scantlings and spacing of the Stiffeners *6 x 3 x 9/20 angles 27" apart* ✓
 Are bracket plates fitted at each end of the Stiffeners? *Yes* ✓ Are hor'l. brackets fitted connecting Bridge Bulk'd. with Bulwarks? *Yes* ✓
 Has the Bridge House an efficient Iron Bulkhead at the after end? *Yes* ✓
 How are the openings closed? *None* ✓
 Is the Forecastle at least as high as the main or top-gallant rail? *Yes* ✓ Has the Forecastle an efficient Iron or Wood Bulk'd. at after end? *Iron* ✓
 Are the Engine and Boiler openings covered by a Bridge, Poop, Raised Quarter Deck, or enclosed by a Strong Iron or Steel Deckhouse? *Steel deckhouse* ✓
 If the openings are not so protected are the exposed parts of the Casings efficiently constructed? *Yes* ✓
 Give thickness of plating; scantlings and spacing of Stiffeners *3 x 2 1/2 x .25 30 apart Plating .25 framing .40.* ✓
 What is the height of the exposed Casings? *4' 1 1/2* ✓ Are suitable means provided for closing all openings in them in bad weather? *Yes. Iron shutters* ✓
 Are the Weather Deck Hatchways efficiently constructed and at least equal to the requirements of Section 28 of the Rules for 1904-5? Give particulars below:—

Position and Size.		No. 1. 25' 3" x 13' 1"		No. 2. 25' 2" x 13' 1"		✓		✓		✓	
Item.		Ship.	Rule.	Ship.	Rule.	Ship.	Rule.	Ship.	Rule.	Ship.	Rule.
COAMING	Height above top of DECK	2' 11" ✓									
	Thickness { Sides.....	.44 ✓									
	Ends.....	.44 ✓									
SHIFTING BEAMS OR WEB PLATES	Number.....	Two ✓		One ✓							
	Section and Scantlings.....	11 20" x 36" ✓									
	Material.....	3 x 3 x .40 ✓									
* FORE AND AFTERS.	Number.....	Three ✓		Two ✓							
	Section and Scantlings.....	Centre 7 1/2 x 7 1/2 ✓									
	Material.....	Sides 6 x 6 } Wood ✓									
HATCHES	Thickness.....	2 1/2 ✓		Same as No. 1 ✓							
	Remarks.....	Wood ✓									

* The depth of Fore and Afters should be stated from the underside of the hatches in all cases.
 (If the sill of the lowest side scuttle will be less than 6 inches above the Indian Summer Load Line if assigned under the tables, state vertical distance from top of deck at side amidships to lower edge of lowest side scuttle.)
 The following information is to be given in all Cases of vessels dealt with under Paras. 11, 12 (under 15 feet Moulded depth) and under Shelter Deck Rules.
 What is the thickness of the Bridge Sheerstrake? *not* ✓ Strake between Main and Bridge Sheerstrakes? *not* ✓

File
 $\frac{1}{2}L = 20.60$
 $2.15 \times \frac{10}{24} = .90$
 21.50
 22.75
 244.25
 22.15

Delete the words } The Crew *are, are not*, berthed in the bridge house.
 that do not apply } The arrangements to enable them to get backwards and forwards from their quarters *are, are not* satisfactory. X
 Length of Bulwarks in well *42' 3"*
 Area of Freeing Ports required by Para. 11 (e) each side of vessel = *14.45* Sq. ft.

Ft.	Tenths.	Ft.	Tenths.	No.	Freeing Ports (each side of vessel) = <i>20.12</i> Sq. ft. <i>17.56</i>
2	5	x	2	0	
3	0	x	2	0	

 Total deficiency or excess = *17.56* Sq. ft.

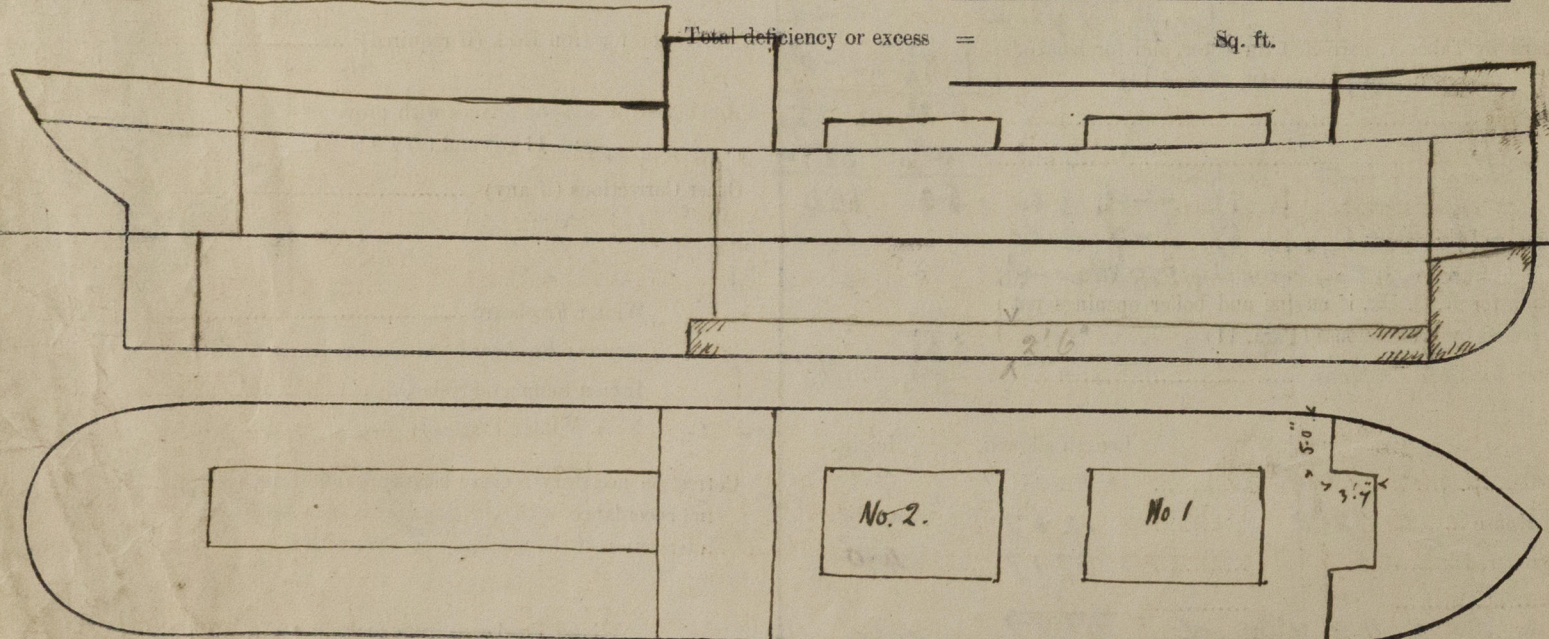

Show hereon line of Floors or Tank Top with position of any Breaks in same; also height of Peak Tank tops, &c., &c.
 State any special features in the construction of the Vessel
 Builder's name and yard number
 Names of sister vessels
 Owners
 Address
 Fee £ *4-0-0*
 Received by me *2/1.24 J.W.*
 12 DEC 1923