

18.9.13
24.12.13
17.1.14
16.2.14
13.3.14
23.3.14

TRACING N° 3022

— PROFILE AND DECK PLAN S. S. N° 224-5. —

2 BULB ANGLES 7.3 x 40 LENGTH 165.9 BREADTH 26.6 DEPTH MOULDED 13.2

SCALE 1/4" = 1 FOOT

TO CLASS 100A1 AT LLOYDS.

2 BULB ANGLES 7.3 x 40

2 BULB ANGLES 6.3 x 40

2 BULB ANGLES 6.3 x 40

2 BULB ANGLES 6.3 x 40

2 BULB ANGLES 7.3 x 40

LADDER RUNGS

FLAT BARS

SECTION AT A.B.

SECTION AT C.D.

SECTION AT E.F.

SECTION AT G.H.

SECTION AT J.K.

R WILLIAMSON & SON

SHIPBUILDERS

WORKINGTON

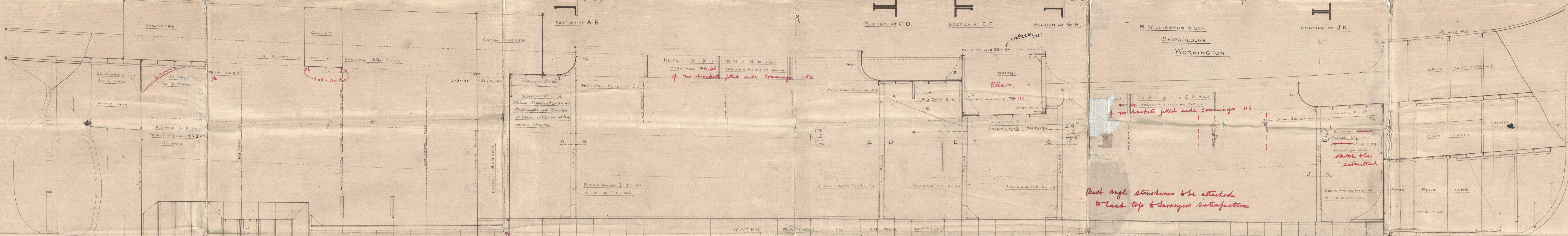

FROM 5 TO 15 INTERCOSTAL PLATES AT CENTRE LINE
TO DECK X 30 THICK CONNECTED TO PLANK BY SINGLE
ANGLE 3 x 3 x 30 AND STIFFENED FOR TOP WITH CONVEYOR IRON
THERE ARE ALSO ANOTHER SET OF INTERCOSTALS ON EACH
SIDE 5' 0" FROM CENTRE LINE

PLATING IN WAY OF OPENING .40 THICK

PLATING IN WAY OF OPENING .36 THICK IN ONE WIDTH BETWEEN
HATCH AND SIDE

BOTTOM STRENGTHENED FORWARD AS PER RULE

WEB FRAMES ON 11 AND 22 AND 2 SIDE STRINGERS IN ENGINE
AND BOILER SPACE AS FOLLOWS:-
WEB FRAMES 13 x 30 FACE ANGLES SINGLE 4.3 x 40
WEB FRAMES 15 x 30 FACE ANGLES SINGLE 4.3 x 40
SIDE STRINGERS 4 x 30 FACE ANGLES SINGLE 3 x 3 x 25
INTERCOSTAL ANGLES TO SHELL 3 x 3 x 25

RAISED QUARTER DECK

MAIN DECK

HATCH 25.8 x 15.11 x 2.6 HIGH

PLATING IN WAY OF OPENING .40 THICK IN ONE WIDTH BETWEEN
HATCH AND SIDE

2-1
3-6
4-11
6-6

C.F.
18.9.13.

Profile + Deck plan

W. Williams & Son
SS. "GALACUM"
Barrow in Furness 1650

Is damaged for No 228

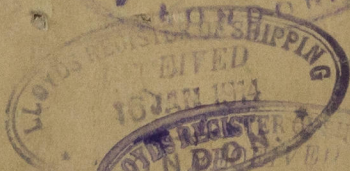
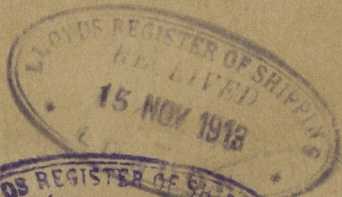
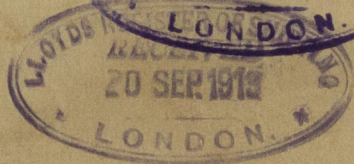
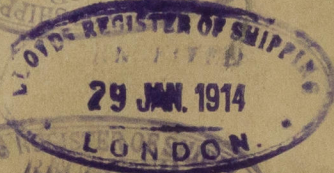

S/S LYNBURN
NEWCASTLE ON TYNE.

Report No. 69944

S/S "Stanley Force" No. 228

Barrow in Furness

Report No. 1828



© 2020

Lloyd's Register
Foundation

002109-002118-0042