

SECTIONS MARKED 'X' ARE NEW GERMAN STANDARD.

Verenigte Staalwerke
Hordoeuwkerke
Zak no. 1626. Plan no. 7708
16-11-29

SIR JOSEPH W. ISHERWOOD & CO. LTD.
4, LLOYDS AVE. (E).
LONDON, E.C.3.
FOR ENCLOSURE TO
DATE 18-11-29

THE SHAPINGS OF THE SULCI ARE ASSIGNED FOR A MIDSHIP LINE, 4.5 M AT CENTER LINE TO UPPER DECK. THE BUILDING STRUCTURE BELOW HORIZONTAL STIFFS ARE FOR SULCI HAVING A GEOMETRIC DEPTH TO BE USED FROM 10 TO BE AVERAGE AS SHOWN, BUT WITH THE PLATING STIFFS AND WRECKREINFORCING, INCREASED TO SUIT THE INCREASE IN BUILDUP DEPTH, I.E. FOR EACH FOUR FEET INCREASE IN HEAD, BELOW THE UPPER DECK, EACH STIFF OR PLATING IS ONE OF 180.8% IN THICKNESS, FOR EACH 2" INCREASE IN HEAD, FOR HORIZONTAL STIFFS, IT IS THE SAME THE SIZE OF STIFFS, NEXT TO PLATING, THE STIFFS, BEYOND BEING OBTAINED, THE WEBB THE SLASH IS INCREASE IN HEAD AND THE INCREASE IN WIDTH.

APPROVED STANDARD OIL CO. (NY)
MARINE DEPARTMENT
26 BROADWAY N.Y.C.
John Stewart 7/1/27
NAVAL ARCHITECT.

PREPARED BY SIR J. WISHERWOOD & CO LTD
17 BATTERY PLACE
NEW YORK CITY
SIGNED *A. B. ...*

TYPICAL MIDSHIP
TRANSVERSE OILTIGHT BULKHEAD
IN WAY OF CARGO OIL TANKS
TWIN SCREW BULK OIL CARRYING
MOTORSHIP - DESIGN (SCM) N° 54C

EQUivalent ANGLES	
SECTION ANGLES	METRIC EQUIVALENT
$3/4 \times 1 1/4 = 135^\circ$	$90^\circ + 90^\circ + 45^\circ = 225^\circ$
$8/8 \times 1/4 = 90^\circ$	$90^\circ + 90^\circ + 110^\circ = 190^\circ$
$4 \times 4 = 113^\circ$	$100^\circ + 100^\circ + 115^\circ = 115^\circ$
$0 \times 3/4 = 135^\circ$	$150^\circ + 90^\circ + 100^\circ = 345^\circ$
$0 \times 3/4 = 180^\circ$	$150^\circ + 90^\circ + 110^\circ = 350^\circ$
$0 \times 3/4 = 262^\circ$	$150^\circ + 90^\circ + 120^\circ = 360^\circ$
$0^\circ = 0^\circ = 170^\circ$	$150^\circ + 150^\circ + 115^\circ = 415^\circ$
$7 \times 3/4 = 170^\circ$	$180^\circ + 90^\circ + 115^\circ = 385^\circ$
$0^\circ = 0^\circ = 180^\circ$	

IF SECTIONS OTHER THAN THOSE GIVEN FOR CHANNEL BULK STIFFERS ARE USED, THE SECTION MODULUS OF THE SUBSTITUTED SECTION WITH A PLATING WIDTH EQUAL TO BULK STIFFER PLATING INCLUDED IS TO BE EQUIVALENT TO THE CORRESPONDING SECTION MODULUS OF THE GIVEN SECTION.

NO SUBSTITUTED SECTION IS TO HAVE A FLANGE WIDTH LESS THAN $85\text{mm} \sqrt{t}$ (6) TO SUIT PLATING THICKNESS DRAWN THICKNESS LESS THAN 0.5mm .

W Bhd

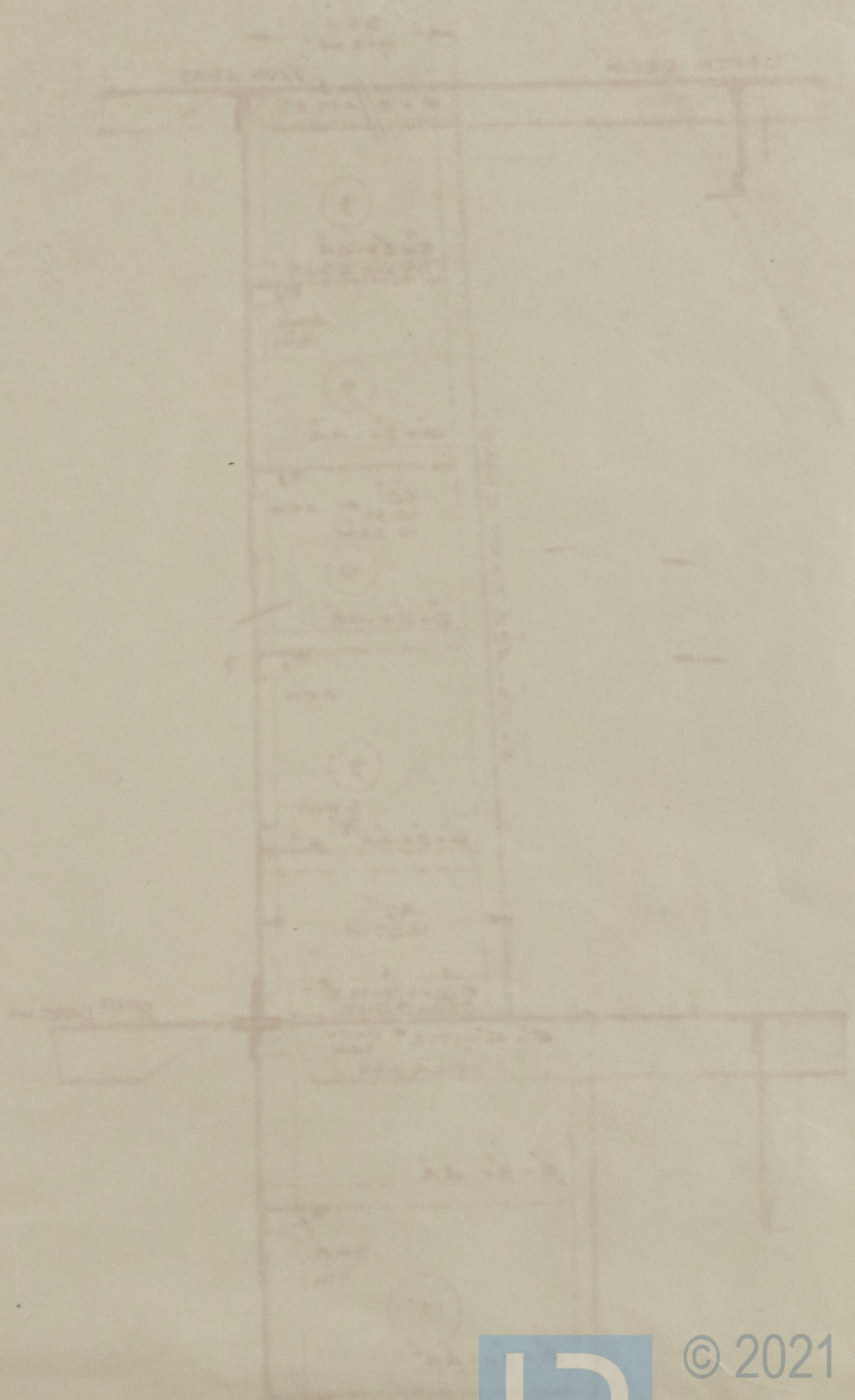

© 2021

Lloyd's Register
Foundation

Sherrwood

1626⁹

Typical Midship Sec. & Oil Tight Bhd.

~~~~~ 164

"J. A. Mawmick"



© 2021

Lloyd's Register  
Foundation

002298-002304-0192