

Lloyd's Register of Shipping.

SURVEYS FOR FREEBOARD. STEAM SHIPS. 52129

PARTICULARS RELATING TO ALL STEAM SHIPS EITHER FLUSH DECKED, OR WITH TOP GALLANT FORECASTLES, SHORT POOPS AND BRIDGE HOUSES DISCONNECTED, OR WITH TOP GALLANT FORECASTLES HAVING LONG POOPS, OR RAISED QUARTER DECKS CONNECTED WITH BRIDGE HOUSES, OR OTHERWISE.

Port of Survey Glasgow
Date of Survey February 1932
Name of Surveyor Roman Dobson

Ship's Name.	Port of Registry and Nationality.	Official Number.	Gross Tonnage.	Date of Build.	Particulars of Classification.
<u>ROWAN</u>	<u>Newry British</u>	<u>160292</u>		<u>1932</u>	<u>+100 A1 (Contemplated)</u>
Number in Register Book					

Registered dimensions from	LENGTH.	BREADTH.	DEPTH.	UNDER DECK TONNAGE.
Waterline	<u>167.0</u>	<u>25.6</u>	<u>10.05</u>	<u>348.31</u>
Length on				
LOADLINE.	<u>166.6</u>			
		<u>mean</u>	<u>Frame Depth 5'</u>	<u>Peak</u>
		<u>Rule 3</u>	<u>Sheer + 58</u>	<u>Tanks</u>
		<u>x 2 = - .33</u>	<u>To Tank Top</u>	<u>For ordy floors</u>
		<u>No. of plating + .33</u>	<u>10.31</u>	<u>in B.R. - 3 Tons</u>
				<u>For floors in F.R. + 1.5 Tons</u>
CORRECTED DIMENSIONS.	<u>166.6</u>	<u>25.6</u>	<u>10.89</u>	<u>346.81</u>

Moulded Depth as measured..... 12'-1"
Addition for Keel below base line for draught record..... 7.....inches. Bar Keel

NOTE. — If the depth is measured when vessel is afloat, the details of measurement should be reported.

CORRECTION FOR LENGTH.

Length of Ship on Loadline..... 166.6
Length in Table 145.0
Difference 21.6
Correction for 10ft., Table A.9 Table C.
× Difference divided by 10 1.944 (if required.)
If $\frac{1}{10}$ ths length covered divide by 2 .972 + 1"

CORRECTION FOR IRON DECK.

Proportion covered, if less than $\frac{1}{10}$ ths length covered
Thickness of usual wood deck, less stringer 3/4"

- 3/4"

CORRECTION FOR ROUND OF BEAM.

Breadth at Gunwale amidships..... 25.5
Round of Beam 8 inches
Normal round..... 6.375
Difference 1.625 ÷ 2 =81
Proportion of Deck uncovered (Para. 19)225 = 1/4"

NOTE. — The round of beam should be reported on the full breadth of vessel at the gunwale.

Co-efficient of fineness..... .447
Any modification necessary {
[Para. 4 (a) to (e)]* } C.D.B.
Co-efficient as corrected43

Sheer { Stem..... 60 } 93 ÷ 2 = 46.5 Mean
at { Sternpost ... 33 }
Sheer at $\frac{1}{2}$ of the length from { Stem 34 } 52.5 ÷ 2 = 26.25 Mean
Sternpost 18.5
Gradual mean Sheer Allowed 47.11 ÷ 55 = 47.73
Standard mean Sheer [Table, Para. 18] 26.66 Correction
Difference..... 20.45 ÷ 4 = 5.11
§ If limited as Para. 18 (f) - 5"

Rise in Sheer { At front of bridge house.....
from amidships {
[Para. 18 (e)] { At after end of forecastle

Fall in Sheer {
Para. 18 (d) } ÷ 2 =
Length uncovered Correction

ALLOWANCE FOR DECK ERECTIONS:—

Freeboard, Table C..... 0'-3 1/2"
Correction for Length, if required (Para. 11, 12, 13, and 14)
Freeboard by Table A, corrected for sheer, and for length, if required (Para. 11, 12, 13, and 14) 1.4 1/4
Difference 1.0 3/4
Percentage as below..... 65.35%
- 8.33

Correction for R. Q. Dk. if engine and boiler openings not covered by bridge house (Para. 11) Bridge in front of R.Q.D. + .21
Allowance for Deck Erections 8.12
- 8 1/4"

	Length.	Length allowed.	Height.
Forecastle.....	<u>26.58</u> <u>23.0</u>	<u>21.91</u>	<u>7.0</u>
Bridge House	<u>8.96</u>	<u>8.96</u>	<u>7.0</u>
† Raised Qr. Dk.....	<u>97.16</u>	<u>97.16</u>	<u>4.0</u>
Poop.....			
Total	<u>129.12</u> <u>128.03</u>	<u>128.03</u>	<u>7.69</u>
Length of Ship	<u>166.6</u>	<u>166.6</u>	
Corresponding percentage { (Para. 11, 12, 13, or 14) }	<u>65.35%</u>		

FREEBOARD recommended amidships from centre of Disc to top of Statutory Deck Line, Wood (Steel) Deck :—

Fresh Water Line	above centre of Disc
Indian Summer Line	"	"	"	"	"	"	"	"	...
Winter Line	below	"	"	"	"	"	"	"	...
Winter North Atlantic Line	"	"	"	"	"	"	"	"	...

Winter Freeboard 4" 5 1/2"
Summer Freeboard (1-2) 1 1/4" 4" 3 3/4"
Indian Summer Freeboard
N. A. Winter Freeboard

Correction necessary because clearside amidships, measured in accordance with the Statute is not taken at the intersection of the wood or steel deck with side.

$$\left(\frac{11.69}{12.75}\right)^2 \times 8 = 6.72 \quad 8 - 6.72 = 1.28$$

Winter Freeboard from deck line 4" 6 1/4"
Summer " " " " 4" 5"
Indian Summer " " " "
N. A. Winter " " " "
Raised Quarter " " " " 4" 5"

87.12
13/12/32

† If the frames, skin planking, or ceiling are of unusual thickness the breadth of vessel to inside of ceiling should be reported if possible.
† In vessels obtaining an allowance for deck erections under Para. 11 where the sheer drops abaft amidships the height of the R.Q.D. is to be taken from the level of the top of the amidship beam.
§ In flush-decked vessels the total standard mean sheer means the sheer measured at the stem and sternpost. In vessels having poops and forecastles, it means the sheer measured at points distant one-eighth of the vessel's length from stem and sternpost.

† State dimensions of freeing port area on back of this form.

† The Surveyor should state whether the fall in sheer as reported is measured relatively to the straight line of keel or to the water line. If measured relatively to water line the vessels draft at time of survey, and also the usual load draft forward and aft should be reported.

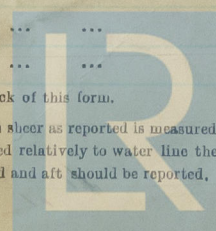

MARKING FORM
RECEIVED
15 FEB 1932

Do all the Frames extend to the top height in the Poop? ☒ Raised Quarter Deck? *Yes* Bridge House? *Yes* Forecastle? *Yes*
 To what height do the Reverse Frames extend? *Top of floors only. (Ridge to Ridge).*
 Has the ~~Poop~~ or Raised Quarter Deck an efficient Iron Bulkhead at the fore end? *Yes*
 Give particulars of the means for closing the openings in Bulkhead *None*
 Is the ~~Poop~~ or Raised Quarter Deck connected with the Bridge House? *Yes* Has the Bridge House an efficient Bulkhead at the fore end? *Yes*
 Give particulars of the means for closing the openings in Bulkhead *No openings*
 What is the thickness of the Bridge Front plating? *.28* and Coaming plate? *.32*
 Give scantlings and spacing of the Stiffeners *5x3x.40 @ 30" clear of hatch 5x3x.38 L in way of hatch @ 30"*
 Are bracket plates fitted at each end of the Stiffeners? *Yes* Are hor'l. brackets fitted connecting Bridge Bulk'd. with Bulwarks? *Yes*
 Has the Bridge House an efficient Iron Bulkhead at the after end? *Yes*
 How are the openings closed? *No openings*
 Is the Forecastle at least as high as the main or top-gallant rail? *Yes* Has the Forecastle an efficient Iron or Wood Bulk'd. at after end? *No*
 Are the Engine and Boiler openings covered by a ~~Bridge, Poop, Raised~~ Quarter Deck, or enclosed by a Strong ~~Iron or Steel~~ Deckhouse? *Yes*
 If the openings are not so protected are the exposed parts of the Casings efficiently constructed? *Yes*
 Give thickness of plating; scantlings and spacing of Stiffeners *.26" - .30" coaming Stiffeners 3x2.5x.28 @ 30" apart*
 What is the height of the exposed Casings? *7'0"* Are suitable means provided for closing all openings in them in bad weather? *Yes*
 Are the Weather Deck Hatchways efficiently constructed and at least equal to the requirements of Section 28 of the Rules for 1904-5? Give particulars below:— *Yes*

Position and Size.		No 1 26'-10 1/2" x 16'-0"		No 2 26'-10 1/2" x 16'-0"							
Item.		Ship.	Rule.	Ship.	Rule.	Ship.	Rule.	Ship.	Rule.	Ship.	Rule.
COAMING.	Height above top of DECK	<i>.42</i>		<i>.29</i>							
	Thickness { Sides.....	<i>.41</i>		<i>.41</i>							
	{ Ends.....	<i>.41</i>		<i>.41</i>							
SHIFTING BEAMS OR WEB PLATES.	Number	<i>7</i>		<i>7</i>							
	Section and Scantlings	<i>4x1/2x3x.42</i>		<i>4x1/2x3x.42</i>							
	Material	<i>Steel</i>		<i>Steel</i>							
* FORE AND AFTERS.	Number	<i>✓</i>		<i>✓</i>							
	Section and Scantlings	<i>✓</i>		<i>✓</i>							
	Material	<i>✓</i>		<i>✓</i>							
HATCHES Thickness		<i>2 1/2" w/line</i>		<i>2 1/2" w/line</i>							
Remarks.....											

* The depth of Fore and Afters should be stated from the underside of the hatches in all cases.

(If the sill of the lowest side scuttle will be less than 6 inches above the Indian Summer Load Line if assigned under the tables, state vertical distance from top of deck at side amidships to lower edge of lowest side scuttle.)

The following information is to be given in all Cases of vessels dealt with under Paras. 11, 12 (under 15 feet Moulded depth) and under Shelter Deck Rules.

What is the thickness of the Bridge Sheerstrake? _____ Strake between Main and Bridge Sheerstrakes? _____

Delete the words { The Crew ~~are~~, are not, berthed in the bridge house.
 that do not apply { The arrangements to enable them to get backwards and forwards from their quarters are, are not satisfactory. *✓*

Length of Bulwarks in well *Fore 34'-0" R.Q.D.K. 97'-16" 97'-7" R.Q.D.K.*

Area of Freeing Ports required by Para. 11 (e) each side of vessel = *9.9* Sq. ft.

Ft. Tenth.	Ft. Tenth.	No.	} Freeing Ports (each side of vessel) = <i>10.5</i> Sq. ft. <i>10.12</i> ✓
<i>2.5</i>	<i>x 1.5</i>	<i>x 1</i>	
<i>2.25</i>	<i>x 1.5</i>	<i>x 2</i>	

Total deficiency or excess = *0.6* Sq. ft.

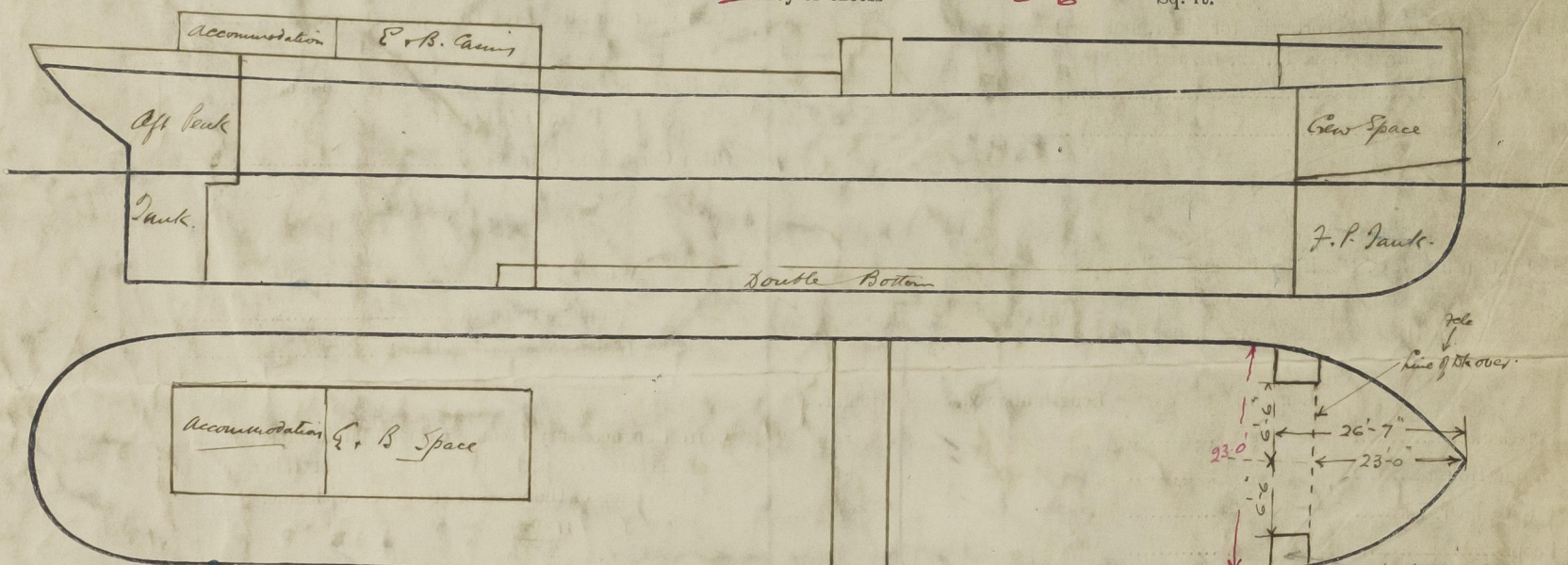

Show hereon line of Floors or Tank Top with position of any Breaks in same; also height of Peak Tank tops, &c., &c.

State any special features in the construction of the Vessel

Builder's name and yard number *Scott & Sons.*

Names of sister vessels *✓*

Owners *J. Fisher*

Address

Est Fee £ *4* : *0* : *0* Received by me *J. Fisher*



© 2020

Lloyd's Register Foundation