

M. V. BLYTH EXPLORER. M/V "OLIVEBANK".

CAPACITY PLAN.

SCALE :- 1/16" = 1FOOT

GENERAL PARTICULARS
LENGTH BETWEEN PERPENDICULARS --- 420'-0"
BREADTH MOULDED --- 53'-9"
DEPTH MOULDED TO SHELTER DECK --- 37'-0"
TONNAGE GROSS 5378.20
TONNAGE NETT REG. 3131.45
MACHINERY 2SETS. 4STROKE DIESEL. SA 6 830 960

DERRICKS			
POSITION	TYPE	LENGTH	WORKING LOAD
Nº1 FOREMAST	TUBULAR	42'-0"	5 TONS
Nº2 "	"	"	"
Nº3 "	"	46'-0"	"
Nº4 "	"	"	"
Nº5 "	CHANNEL	56'-6"	25 TONS
Nº6 POST (P)	TUBULAR	46'-0"	5 TONS
Nº7 (S)	CHANNEL	46'-0"	"
Nº8 MAINMAST	TUBULAR	42'-0"	"
Nº9 "	"	"	"
Nº10 "	CHANNEL	"	"
Nº11 "	TUBULAR	"	"
Nº12 POST (P)	"	40'-0"	"
Nº13 (S)	"	"	"

STORE CAPACITIES	
COMPARTMENT	CU. FEET
BOSUNS STORE (UPPER DECK)	1752
FORE PEAK STORE	922
BULK STORE	914
SPECIE ROOM	963
MATE'S STORE	564
HANDLING ROOM	512
Nº1 COLD CHAMBER	370
Nº2 "	509
PROVISION ROOM	619
STEWARDS STORE	546
CARPENTERS SHOP	474
MATES LOCKER	176
ENGINEERS STORE	564
TOTAL STORES	313
TOTAL STORES	9,198

MASTS				
	MAX. DIA.	HIGH. DIA.	TRUCK DIA. TO HOUNS	SHELV. DIA. TO TRUCK
FOREMAST	26"	26"	4 1/2"	41'-6"
MAINMAST	"	"	"	35'-6"

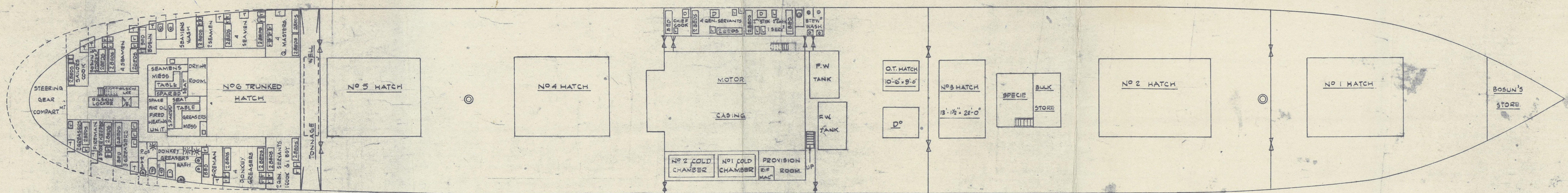
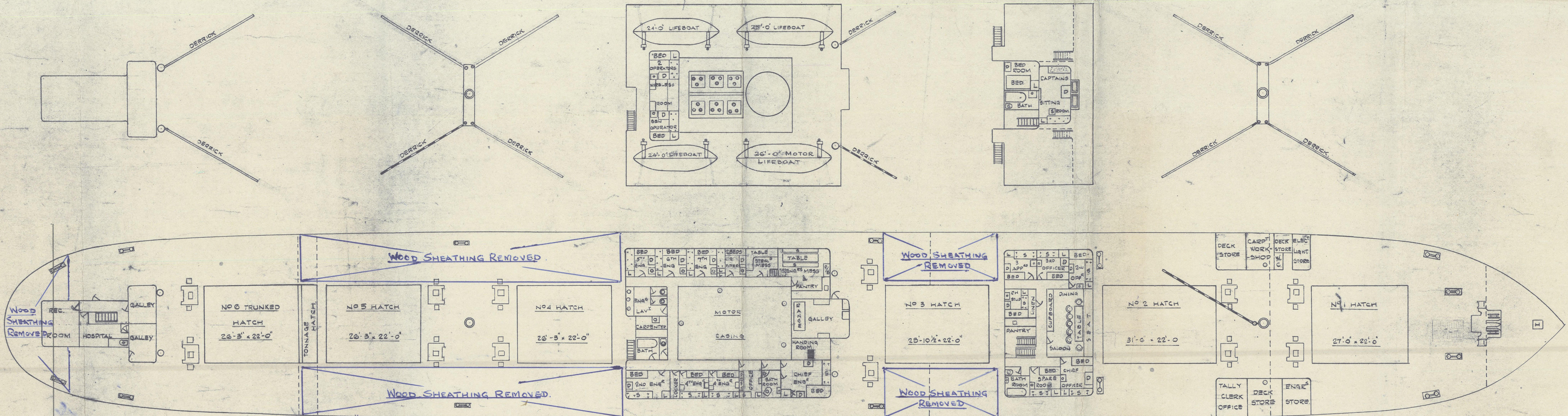
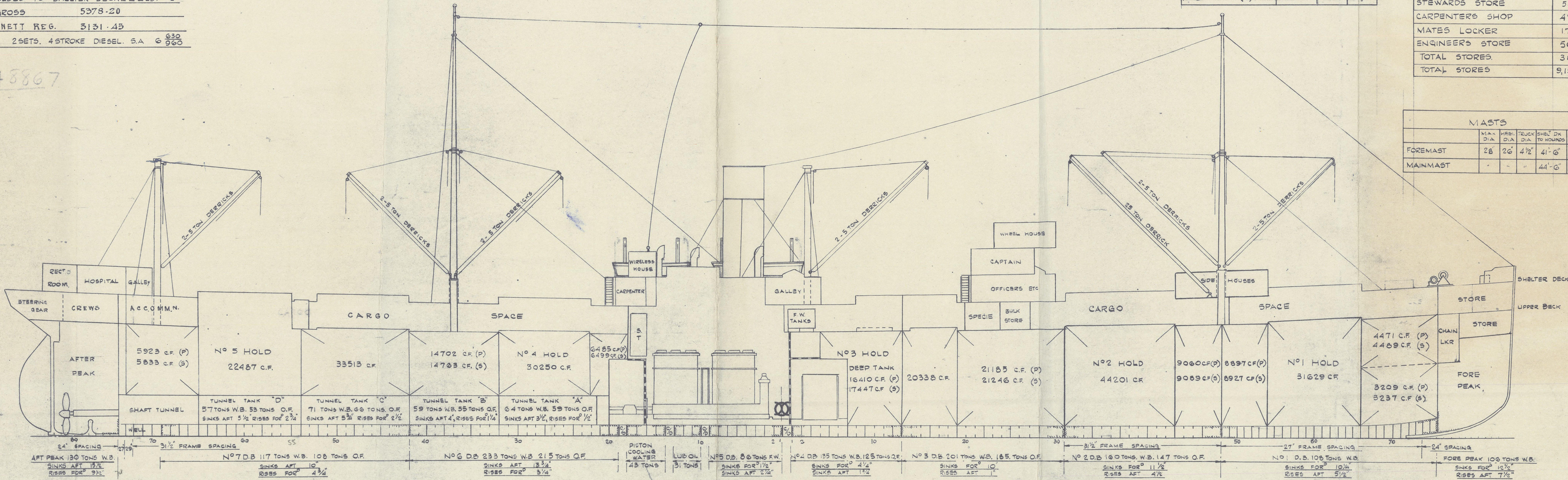

ALL PARTICULARS GIVEN IN GOOD FAITH BUT WITHOUT GUARANTEE