

NW 5309

# Lloyd's Register of Shipping.

Ship's Name "ARDGRYFE" Official No. 142318

Memorandum of alterations reported since ship was surveyed for assignment of Load Lines in February 1946

Alterations to No.2 Cargo Hatchway noted at Annual Freeboard Survey held February 1947, at Hamburg.

Hatch Dimensions 50'-9" x 16'-0"  
Height above deck 3'-6"  
Side plate thickness .5"  
End " " .44"  
Side stiffener - bulb angle - 7" x 3" x 8/20"

One new hatch beam.

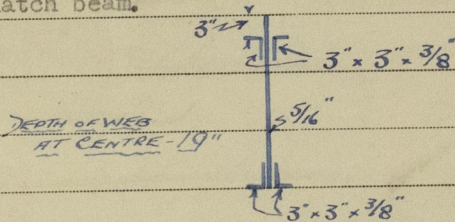

(R. E. PRITCHARD)

Hamburg, 14th February, 1947,

Noted  
3rd Mar 1947  
EY

