

LLOYD'S REGISTER
LONDON.
REC'D 128 APR 1922
ANSD

LLOYD'S REGISTER OF SHIPPING
CALLE DE IBANEZ DE BILBAO 22
BILBAO 25th April 1922

Sir,

We beg to acknowledge receipt of your classing letter of 21st April, respecting the case of the steamer "ALDECOA", Bilbao Report N°5977.

The hatch coaming of N°3 hatch on the main deck are fitted in ship as indicated in the sketch at the foot of this letter.

The pillar at N°39 frame is formed of four angles 150 X 150 X 10 m/m, and a plate 300 X 10 m/m. The pillar on N°54 frame is formed of four angles 150 X 150 X 10 m/m.

The hold and tween deck pillars through ^{OUT} the vessel are fitted in the sizes as given on the approved plans.

We regret that on the profile plans, prepared by the builders and forwarded with our report shows that the pillars ^{ARE} formed of angles without a plate which was an error on the drawing.

The following additional strengthening in way of N°3 main deck has been fitted viz:-

Center line bulkhead has been fitted, and the deck plating of tween decks has been fitted 9 m/m thick instead of 7 1/2 m/m as required by the Rules which we are of opinion compensates the strengthening of N°3 hatch.

002659-002666-0258 1/2

We are, Dear Sir,

Yours faithfully,

M. S. Langdon
Per Surveyors,

Secretary,
LONDON

Sketch in no. of Pl 3 Main deck detail.

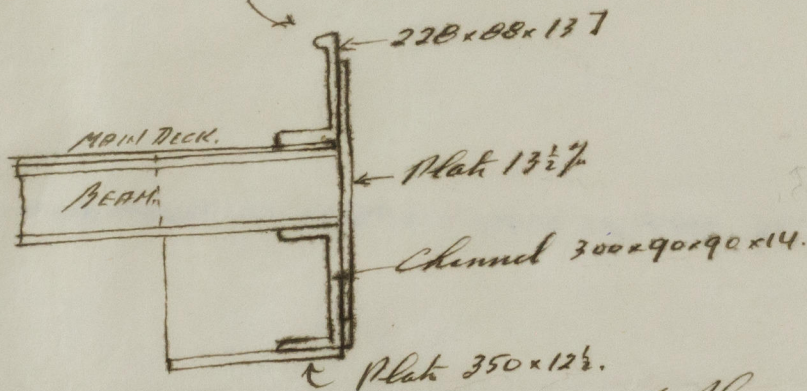

M. S.



© 2020

Lloyd's Register
Foundation

0258 2/2

Referred to the Chief Ship Surveyor.

Referred to the Chief Ship Surveyor.

Cy.R

FRI. APR. 28 1922
TUESDAY 17

Also H. Dept.

Handwritten signature

141 x 88 x 85

141 x 88 x 85

141 x 88 x 85

141 x 88 x 85

141 x 88 x 85

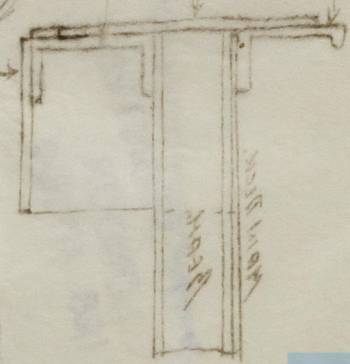

Handwritten signature

141 x 88 x 85

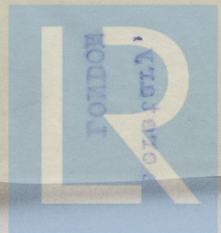

© 2020

Lloyd's Register Foundation