

JUL 30 1937

Index No. 14227
(For London Office only).

Lloyd's Register of Shipping.

SURVEYS FOR FREEBOARD.

(CONDITIONS OF ASSIGNMENT.)

No 17713.

Ship's Name "INARI" Laita Runnen Port of Survey West Hattloppa.
 Official Number _____ Surveyor's Signature Hugh L. Walker
 Nationality and Port of Registry Finnish, Helsingfors. Date of Survey 20th, 21st and 22nd July, 1937.

Disposition and dimensions of superstructures, trunks, deckhouses and machinery casings to be inserted in the diagrams and tabular statement:—

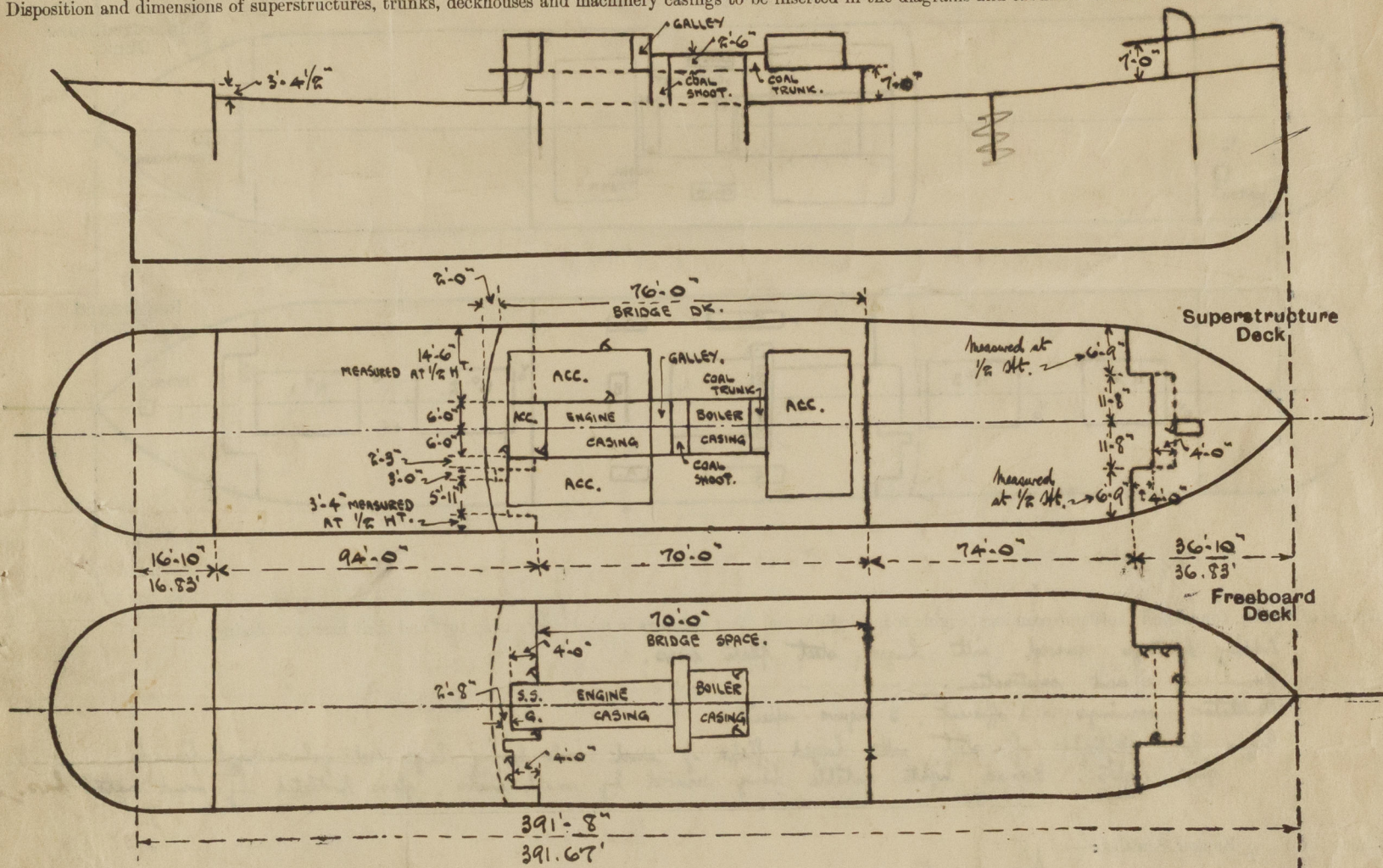

Particulars of Superstructures, Trunks, Casings, Deckhouses.

| | Coaming | Plating | Stiffeners | Spacing | End Attachments of Stiffeners | Size of Openings | Height of Sills | Height of Casings |
|---|---------|---------|--------------------------------|-------------|-------------------------------|---------------------------------|-----------------|-------------------|
| Poop Bulkhead ... | ✓ | .37 | 7 1/2 x 3 x 42 | | | | | |
| Raised Quarter Deck Bulkhead ... | | .30 | 5 x 3 x 36 A. | 30" | None | 10 1/2" Portlight on each side. | 28" to br. | 3'-4 1/2" |
| Bridge, After Bulkhead ... | | .28 | 3 x 3 x 30 A. | " | " | 20 4-5 x 1-11 20 5-0 x 2-0 | 25" 15" | 7'-0" |
| Bridge, Forward Bulkhead ... | .40 | .36 | 7, 8 & 9 B.A. | 27" - 30" | Blkt. 2. & 3. | 6-8 x 3-0 | None | " |
| Forecastle Bulkhead ... | | .32 | 5 x 3 x 36 A. 3 x 3 x 30 A. | 3-11 3-0 | None. | 4-7 x 2-0 | 18" & 19" | " |
| Trunk, Aft ... | ✓ | | | | | | | |
| Trunk, Forward ... | ✓ | | | | | | | |
| Exposed Machinery Casings on Freeboard or Raised Quarter Decks ... | ✓ | | 3 1/2 x 3 x 32 | | | | | |
| Exposed Machinery Casings on Superstructure Decks ... | | .26 | 3 x 2 1/2 x 30 A. | 31" | None. | None. | ✓ | 2'-6" |
| Machinery Casings within Superstructures not fitted with Class I Closing Appliances ... | .32 | .26 | - | 31" & 32" | None. | 3-4 x 1-8 | 24" | 7'-0" |
| Deckhouses on Flush Deck Ships ... | ✓ | | | | | | | |

Particulars of Closing Appliances (state if capable of being manipulated from both sides).

| | |
|---|---|
| Poop Bulkhead ... | ✓ |
| Raised Quarter Deck Bulkhead ... | 10 1/2" diam. hinged portlights, no deadlights or plugs. (now closed by riveted plates) |
| Bridge, After Bulkhead ... | 4-3" doors of wood 1 1/4" thick, one capable of being closed from both sides, other outside only, hinged doors. |
| Bridge, Forward Bulkhead ... | 5-0" steel plate secured by bolts and lock bolts, manipulated from outside only. |
| Forecastle Bulkhead ... | " hinged doors, one capable of being closed from outside, remainder no closing appts. |
| Exposed Machinery Casings on Freeboard or Raised Quarter Decks ... | ✓ |
| Exposed Machinery Casings on Superstructure Decks ... | ✓ |
| Machinery Casings within Superstructures not fitted with Class I Closing Appliances ... | Steel hinged doors, capable of being manipulated from inside casing only. |
| Deckhouses on Flush Deck Ships ... | ✓ |

PARTICULARS OF PROTECTION TO OPENINGS, ETC.

The following diagrams should be used to indicate the positions of cargo and coaling hatchways, gangway, cargo and coaling ports, ventilators, companionways, etc., which would affect the seaworthiness of the ship:—

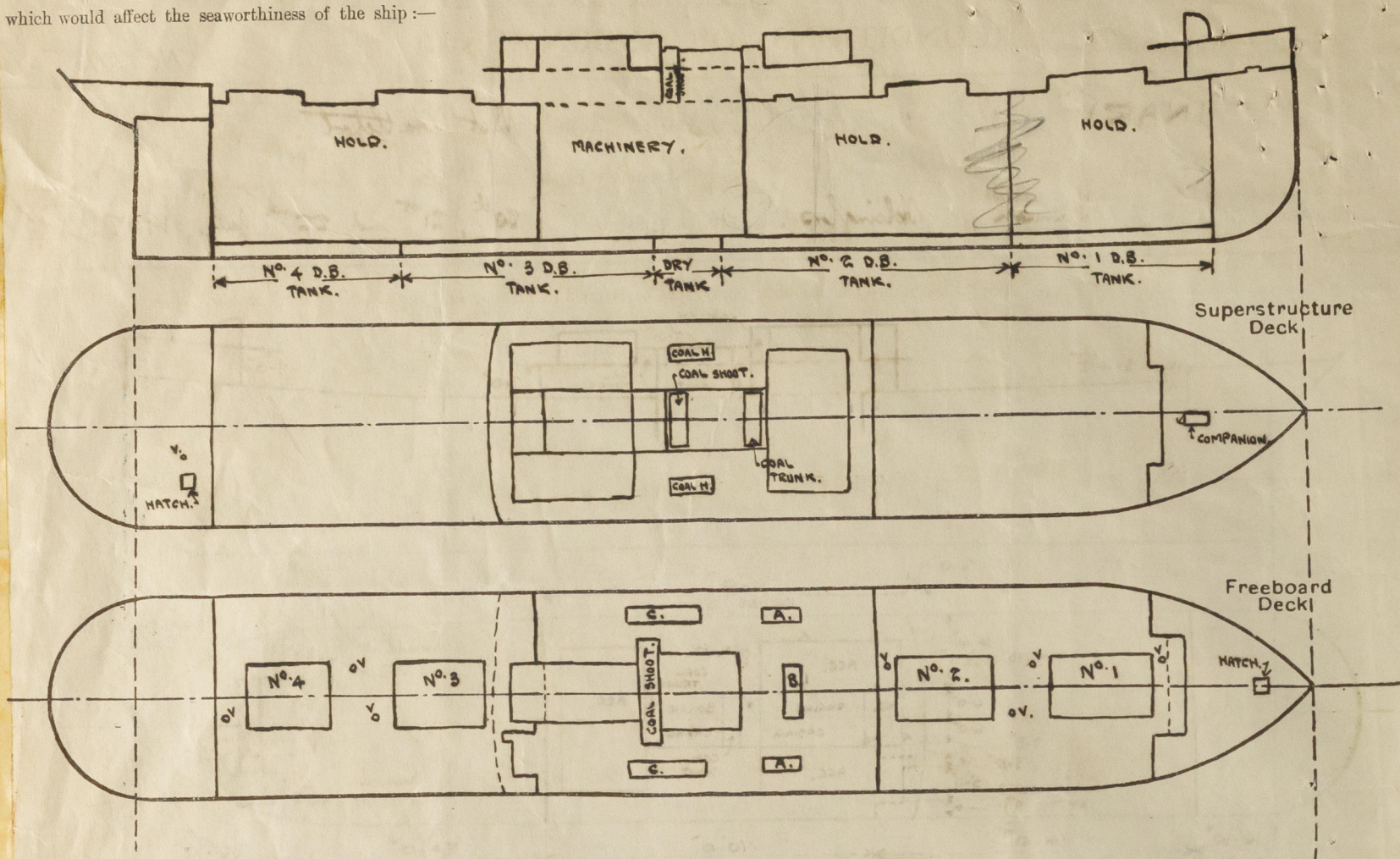

Particulars of fiddle, funnel and ventilator coamings, engine room skylight and other openings in machinery casing tops and their means of closing:—

Fiddle gratings covered with hinged steel plate covers.

Funnel of efficient construction.

~~Ventilator coamings: 1 efficient, 3 require repairs.~~

Engine Room skylight of steel, with hinged flaps of wood each having large rectangular wood framed glass lights. Framed lights portable being secured by small bolts, glass protected by sand metal bars.

Particulars of Flush Bunker Scuttles:—

None.

Particulars of Companionways:—

Steel Companion, on Forecastle Deck, giving access to crew's quarters. Material about 1/4" thick.
Steel Door ~~now renewed~~ ^{two parts}, size of opening 4'-6" x 3'-6", 8" coaming above deck.
spring lock operated from both sides

Particulars of Ventilators in exposed positions on freeboard and superstructure decks:—

On Upper Deck. 6 Ventilators 14 1/4" Dia., coamings 2'-4" x 2'-8" } 1st holds.
1 Ventilator - - - 3'-1" x 3'-7"

On Raised Quarter Deck.
1 Ventilator 1 1/2" - - - 2'-6" x 3'-0" 2nd Deck.

All ventilator coamings have wood plugs and canvas covers.

Particulars of Air Pipes in exposed positions on freeboard, raised quarter, or superstructure decks:—

1, 3" Dia. - Raised Quarter Deck, to aft Peak. 14" to opening above deck.
2, 2 1/2" - Upper Deck, 1st & 2nd, - No. 4 D.B. Tank. 33" x 36" to opening above deck.
2, 3" - Bridge - - - No. 3 - 10" to opening above deck.
2, 2 1/2" - Coaling Deck, - - - Dry Tank. 21" to opening above casing tops.
2, 2 1/2" - Upper Deck, - - - No. 2 D.B. Tank. 36" to opening above deck.
1, 4" - - - - - to No. 1 D.B. Tank. 9" to opening above deck.
1, 3" - - - - - Fore Peak. 33" to opening above deck.
Air pipe to No. 1 D.B. Tank has perforated plate cover over opening. Remainder have ~~no cover or closing arrangements~~ ^{by wood plugs}.

PARTICULARS OF PROTECTION TO OPENINGS, ETC.

| HATCHWAYS ON FREEBOARD AND SUPERSTRUCTURE DECKS. | | | | | | | | | | |
|---|---|--|---------------------------------|----------------------------------|---------------------------------|---------------------------------|---------------------------------|---------------------------------|--|--|
| ← UPPER D ^C . → BRIDGE D ^C . ← CASING TOP. → R.Q.D ^C . | | | | | | | | | | |
| Description of Hatchway | No. | Local Stitches. | | C | Fore Stakes & Chain Lbr. | Local Stitches | Local Stakes | Local Trunks | Stitch to T.D ^C . | |
| Dimensions of Hatchway | 1, 2, 3 & 4 | A | B | C | | | | | | |
| COAMINGS | 36" 40" | 14" 40" | 15 1/2" 40" | 12 1/2" 40" | 2 1/2" Angle Frame. | 14" 40" | 2 1/2" 30" | 2 1/2" 30" | Steel beaming to 18" above Deck, with 3" thick | |
| HATCH BEAMS | Number ... Spacing ... Scantling and Sketch ... Bearing Surface ... | Equal. 3" x 3" x 35" 3 1/2" x 4 1/2" x 1/2" 3" | None. | None. | None. | None. | None. | None. | Wood beaming up to 24" above deck. | |
| FORE AND AFTERS | Number ... Spacing ... Unsupported Lengths ... Scantling and Sketch ... Bearing Surface ... | 3 Equal. 7'-7" Wood 8" deep x 6" wide. Where renewed 7" x 7" 2" | None. | None. | None. | None. | None. | None. | None. | |
| HATCH COVERS | Material ... Thickness ... How fitted ... Bearing Surface ... | Wood 2 1/2" ATW.P. 2" | Wood 2 1/2" ATW.P. 1 1/4" | Wood 2 1/2" F. & A. 1 1/4" | Wood 2 1/2" ATW.P. 2 1/2" | Wood 2 1/2" ATW.P. 1 1/4" | Wood 2 1/2" ATW.P. 2 1/8" | Wood 2 1/2" ATW.P. 2 1/8" | Hinged cover, framed by wood & 1" thick. | |
| Spacing of Cleats | 26" & 28" | 13 1/2" & 28" | 27" | 24" | Beaming. | 27" & 20" | 28" & 30" | 28" & 36" | Two cleats on each side, for ladders and tarpaulins. | |
| Number of Tarpaulins | 3 | None. | None. | None. | None. | 2 | 2 | 2 | | |
| <p>*Are wood fore and afters steel shod at all bearing surfaces? Some are steel shod, material 4" wide & less than 1/8" thick.</p> <p>Are battens and wedges efficient and in good condition? Yes.</p> <p>Are tarpaulins in good condition and in accordance with rule requirements? Yes, except as noted.</p> <p>Are lashings provided in accordance with rule requirements? Wood fore and afters are fitted over tarpaulins at No. 1, 2, 3 & 4 Stitches.</p> | | | | | | | | | | |

Particulars of any special features:—

Fore & After 8" deep x 6" wide screwed down by heavy bolt at each end to eyeplates on hatch and coaming. Two fore and afters to each hatch, 1 Port and 1 Starboard.

Double bottom Tanks within the midship half length are sub-divided longitudinally and are not pierced by holes. Stays to Bulwarks to rule requirements. New rail top supports for uprights fitted. Lockets for uprights to rule requirements. Eye plates for lashings.

Endorsement at first survey and at surveys for renewal of Certificate:—

The fittings and appliances are in accordance with the particulars shown on this form (or as now modified) and are in good condition.



© 2021

Lloyd's Register Foundation