

Lloyd's Register of Shipping.

Ship's Name *Clarecastle*Official No. *136345*

Memorandum of alterations reported since ship was surveyed for assignment of Load Lines in *Belfast February 1940*

alteration of crews accommodation from lower Forecastle space to existing open Forecastle.

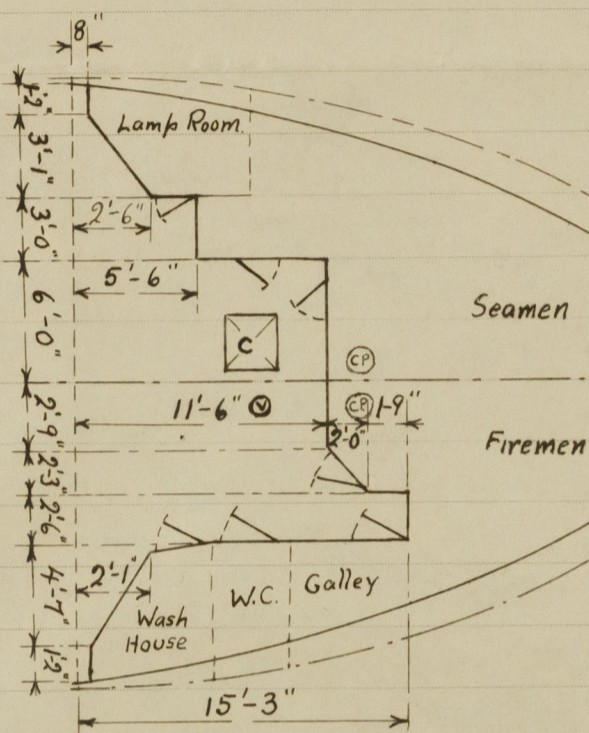

Runs

$$2 \times 67 \times 1.17 =$$

1.56

$$\frac{3.17}{2} \times 3.08 =$$

4.88

$$5.5 \times 3.0 =$$

16.50

$$11.5 \times 8.75 =$$

100.63

$$\frac{11.5 + 13.5}{2} \times 2.25 =$$

28.13

$$15.25 \times 2.5 =$$

38.13

$$\frac{2.75}{2} \times 4.58 =$$

6.30

26.5 196.13

Total length 32.67

9 units enclosed 25.27

The existing companionway in open Forecastle dispensed with and opening in upper deck permanently closed with steel plate electric-welded.

Steel Bulkhead erected across existing open Forecastle (see above sketch) coaming & plating 22"; Stiffeners 2½" x 2½" x 25", spaced 30" apart; size of openings 7 @ 5'-0" x 24"; height of sills 9"; height of casing 7'-0".

Solid wood doors 1½" thick capable of being operated from both sides fitted. Lower Forecastle space fitted with one additional 5½" cowl ventilator. Forecastle space fitted with hinged deadlights and two additional 7½" x 3½" oval Gyffe type ventilators fitted to the fore-castle deck leading to new crew space below, coamings 2'-9" x ¼" thick.

A small hatchway marked "C" has been fitted to the upper deck aft of the new fore-castle front bulkhead, leading to the existing crew space now converted to a store space and the new chain locker strongly built of wood has been erected in this space.

Size of hatchway 2'-0" x 2'-6" x 24" coaming plate, with sufficient hatch cleats, battens, 2½" nest angles, 2½" wood cover & 2 tarpaulins.

R. Muntton

Belfast, February 1940

A copy of the above memorandum C. 11 (contd.) will be placed on board the vessel when the alterations have been completed.