

YARD NO. 643.

TWIN SCREW OIL TANKER. MIDSHIP SECTION.

TO CLASS +100 A.I. LLOYDS.

CARRYING PETROLEUM IN BULK.

LONGITUDINAL FRAMING AT BOTTOM IS:-

CENTRE TANK, UPPER DECK, & TRUNK DECK.

DIMENSIONS.

LENGTH B.P. ----- 380'-0"
BREADTH MLD. ----- 62'-6"
DEPTH MLD. ----- 18'-9"
TRUNK HEIGHT ----- 7'-6"
TRUNK WIDTH ----- 38'-4"

SCALE 1/2" = 1 FOOT.

PLAN OF CARGO TANKS.

Scale, 1/16" = 1 FOOT

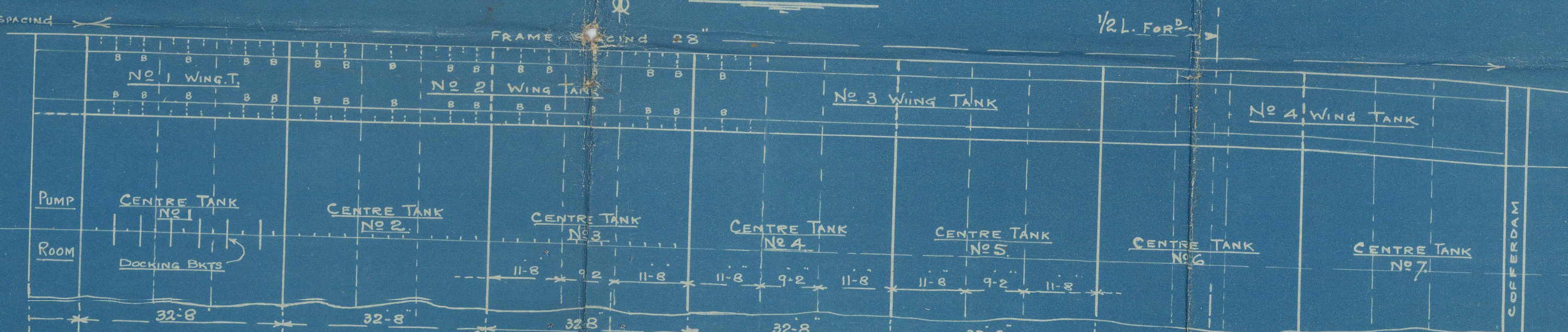

NUMERALS.

1ST LONGITUDINAL NO. L x D = 380 x 18.75 = 7125
2ND " " L (B x D) = 380 x (18.75 + 42.5) = 30780
DEPTHS TO LENGTH L/D = (380 ÷ 18.75) = 20.25.
TRUNK TOP AT SIDE = 14'-1"

EQUIPMENT NUMERAL

2ND LONGITUDINAL NO. ----- 30780
POOP & FORECASTLE --- 140' x 75' x 75' --- 790
CASINGS ON POOP --- 77' x 1075' x 50' --- 414
MIDSHIP HOUSE ON TRUNK --- 55' x 8' x 50' --- 212
" " ABOVE --- 50' x 8' x 50' --- 200
" " " " --- 45' x 8' x 50' --- 180
TRUNK --- 240' x 75' x 50' --- 900
35476

EQUIPMENT.

3 BOWER ANCHORS, STOCKLESS, 2 OF 60 CWTs, 1 OF 50 CWTs.
1 STREAM ANCHOR, 16 1/2 CWTs. (EX STOCK OF 4 CWTs.)
STUD CHAIN CABLE 270 FMS OF 2 3/8" OR 1 1/2" TAYCO.
STREAM WIRE (6/12) 90 FMS OF 4 3/8", BREAKING TEST 47 TONS.
TOWLINE STEEL WIRE (6/12) 120 FMS OF 4 3/8", BREAKING TEST 47 TONS.
HAWKERS " (6/12) 2 OF 90 FMS, 2 3/8" CIE.
WARPS " (6/12) 2 OF 90 FMS, 2 3/8" CIE.

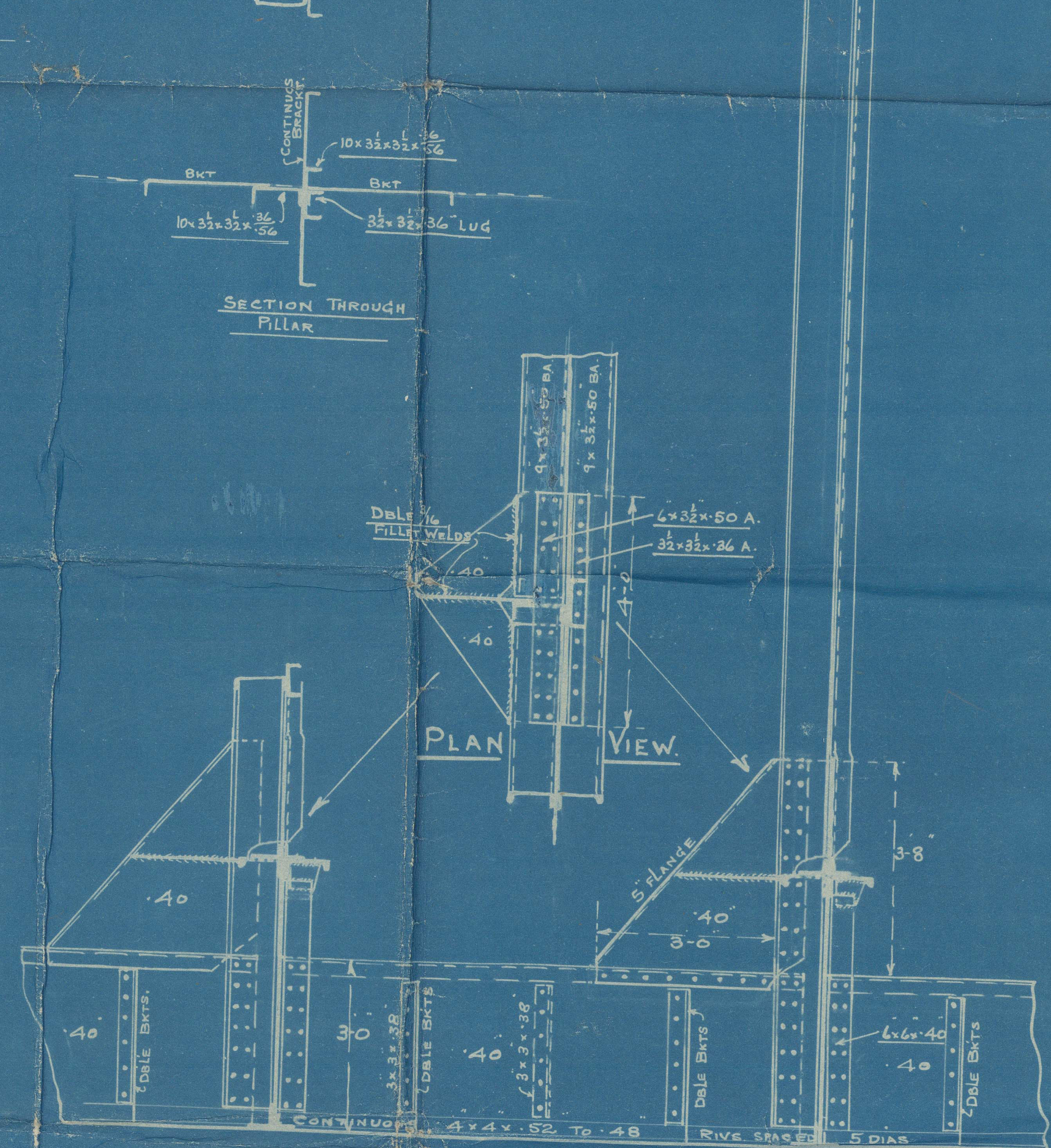
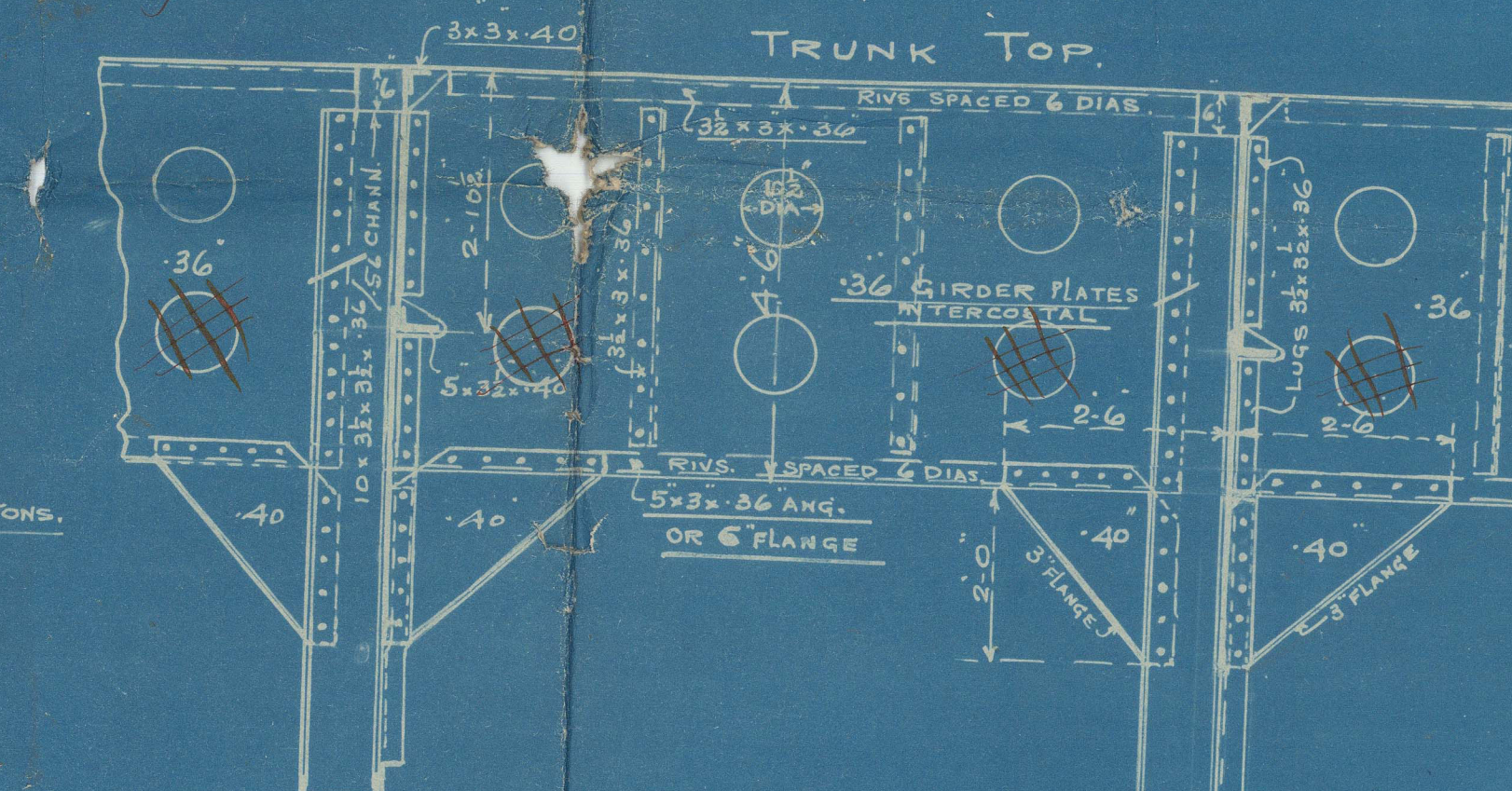

DOCKING GIRDER CONNECTIONS TO PILLARS & TRANSVERSES.

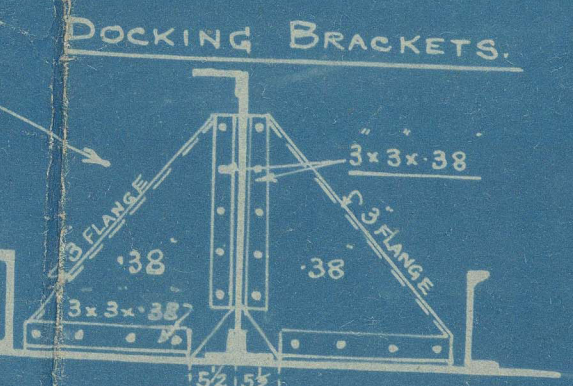
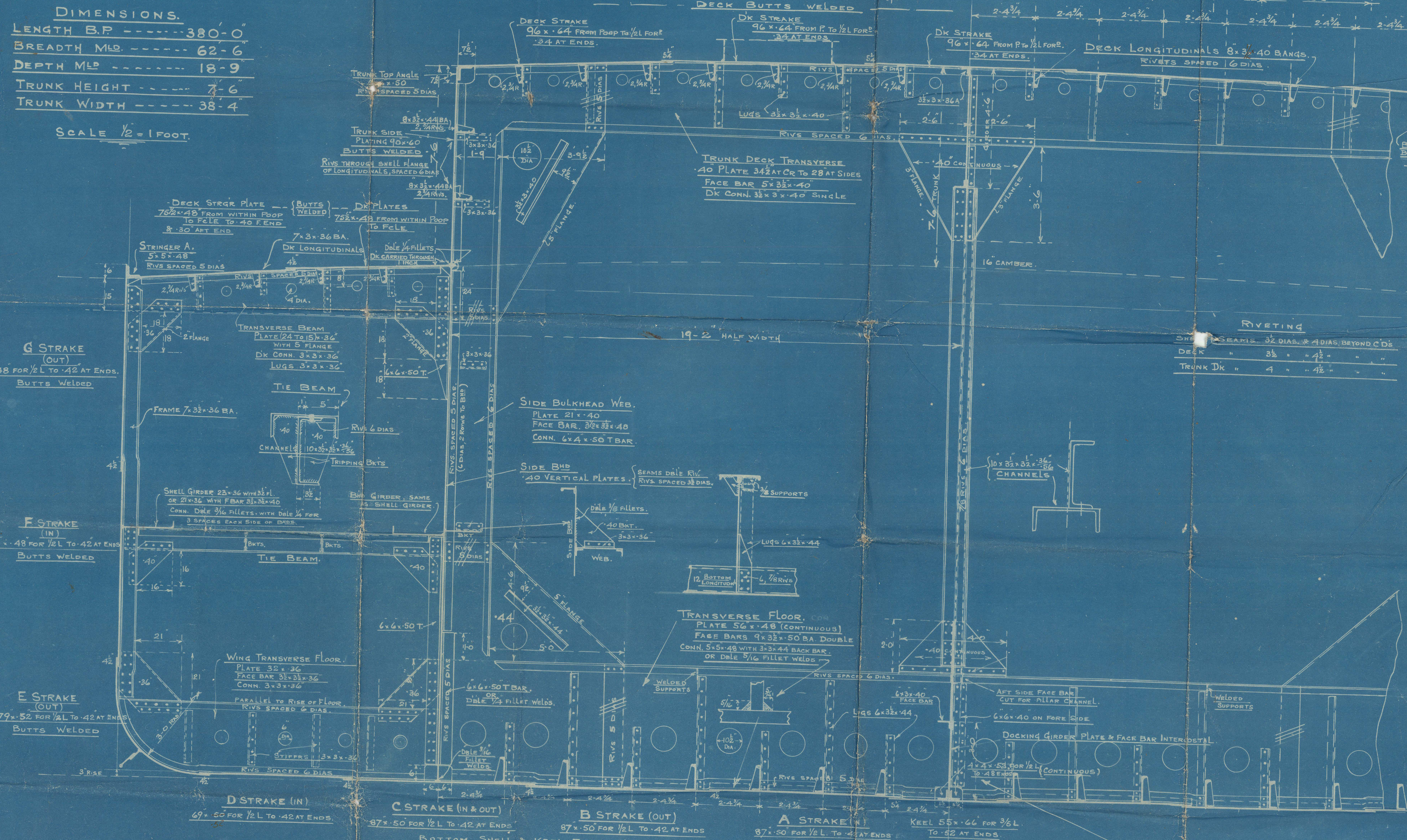

DOCKING BRACKETS.

FILE
8-1-45

WS 684

J. L. Thompson & Sons Ltd.,
Yard No. 643/5
Also Nos 655, 663 & 667.
Midship Section.

* "Galeomma" 

BUNDERLAND RPT. NO. 34479.

Garesella
BUNDERLAND RPT. NO. 34516.

Gomphina
BUNDERLAND RPT. NO. 34861



© 2021

Lloyd's Register
Foundation

002830-002831-0021

Lloyds

0027



© 2021

Lloyd's Register
Foundation