

DRY CARGO		
NO DECK	FR 78-89	CU FT
TOTAL DRY CARGO 18203		

MAIN CARGO TANKS		
TANK NO.	LOCATION	BALLONS BARRELS (420)
1	FR 78-79	39159.9 833.57
2	80-81	39159.9 833.54
3	82-83	39159.9 833.61
4	84-85	39159.9 833.60
5	86-87	39159.9 833.60
6	88-89	39159.9 833.60
7	90-91	39159.9 833.60
8	92-93	39159.9 833.60
9	94-95	39159.9 833.60
TOTAL 39159.9 833.60		

SIDE CARGO TANKS		
TANK NO.	LOCATION	BALLONS BARRELS (420)
1-P	FR 71-72	106822.8 2343.40
1-S	71-72	106822.8 2343.40
2-P	73-74	106822.8 2343.40
2-S	73-74	106822.8 2343.40
3-P	75-76	106822.8 2343.40
3-S	75-76	106822.8 2343.40
4-P	77-78	106822.8 2343.40
4-S	77-78	106822.8 2343.40
5-P	79-80	106822.8 2343.40
5-S	79-80	106822.8 2343.40
6-P	81-82	106822.8 2343.40
6-S	81-82	106822.8 2343.40
7-P	83-84	106822.8 2343.40
7-S	83-84	106822.8 2343.40
8-P	85-86	106822.8 2343.40
8-S	85-86	106822.8 2343.40
9-P	87-88	106822.8 2343.40
9-S	87-88	106822.8 2343.40
TOTAL 106822.8 2343.40		

FUEL OIL TANKS		
TANK NO.	LOCATION	BALLONS BARRELS (420)
WING TANK	FR 36-46 P	104687.5 2497.54
WING TANK	36-46 S	104687.5 2497.54
DEEP TANK	75-89 S	99489.0 2359.89
DEEP TANK	75-89 P	99489.0 2359.89
TOTAL FUEL 408465.4 9795.86		

BALLAST TANKS AND COFFERDAMS		
TANK	LOCATION	TONS S.W.
FORE PEAK	FR 89 - FORD	314.83
DEEP TANK	75 - 89 S	380.17
DEEP TANK	75 - 89 P	379.10
COFFERDAM	73 - 75 P	86.47
COFFERDAM	73 - 75 S	86.47
COFFERDAM	46 - 47 P	57.11
COFFERDAM	46 - 47 S	57.11
DEEP TANK	0 - 9	60.07
TOTAL BALLAST 1380.73		

FRESH WATER TANKS		
TANK	LOCATION	TONS F.W.
FEED WATER	FR 10-18 ENG. RM.	36.39
DISTILLED WATER	FR 10-18 ENG. RM.	36.39
INNER BOTTOM T.	11 - 27 PORT	41.39
DO	11 - 24 STBD.	31.41
DO	27 - 44 PORT	77.12
DO	27 - 44 STBD.	78.52
TOTAL FEED WATER 269.79		
DRINKING WATER		
FR TANKS	STEER'S 8" FLAT FR 78-89	88.51
DO	UNDER BRIDGE DK. P	35.37
DO	UNDER BRIDGE DK. S	35.37
TOTAL DRINKING WATER 99.25		

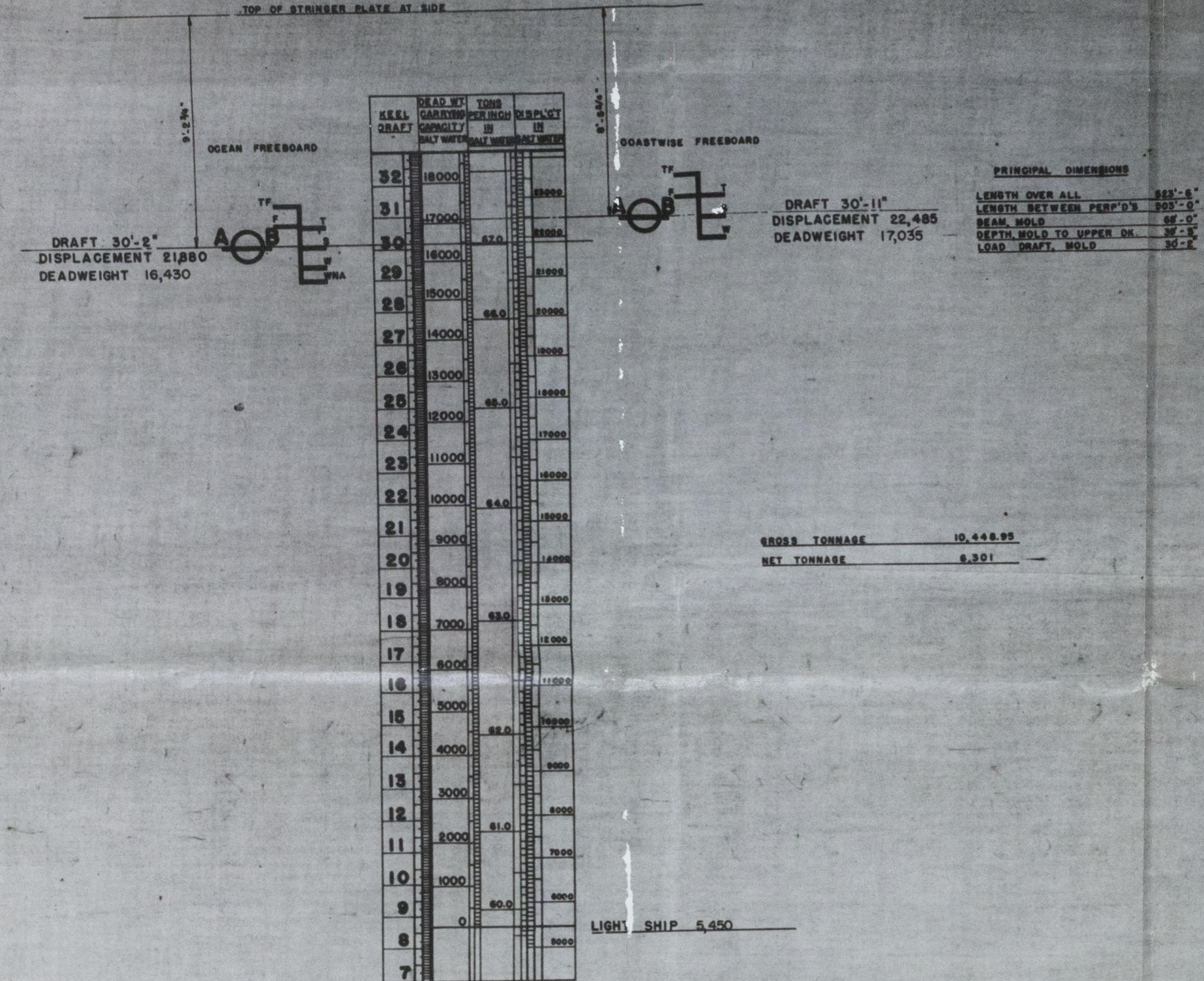
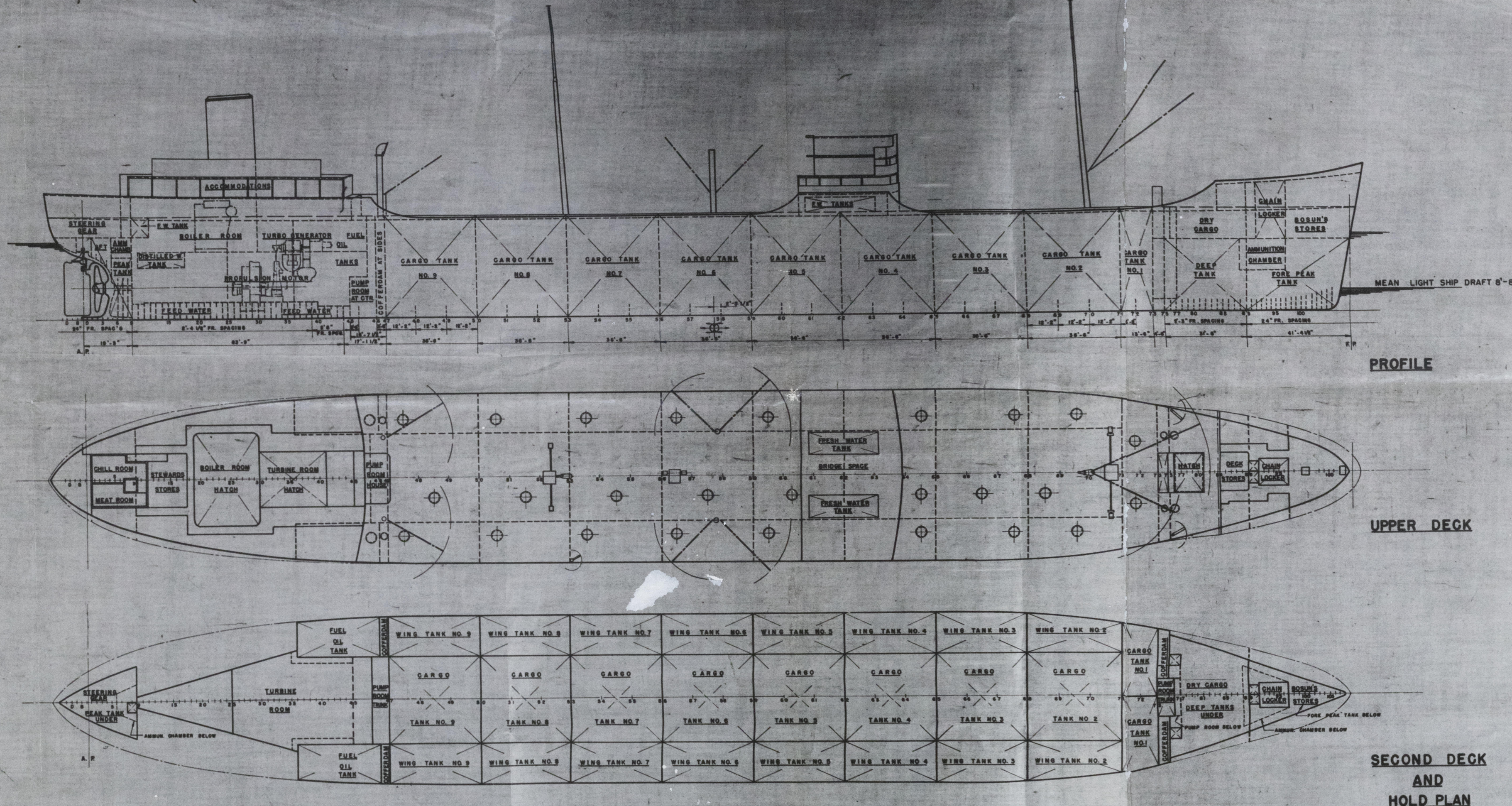

NOTE: THE LIGHTSHIP WEIGHT OF THE VESSEL AS DETERMINED FROM DEADWEIGHT DETERMINATION MADE ON TANKERS IS 6,450 LONG TONS. THIS LIGHTSHIP WEIGHT IS THE WEIGHT OF THE VESSEL COMPLETE, AND READY FOR SEA IN EVERY RESPECT. IT INCLUDES THE WEIGHT OF LIQUIDS IN MACHINERY, FIRE, AND SANITARY LINES, FUEL OIL SYSTEMS, SPARE PARTS, BOGUS'S AND DECK STORES, MATTRESSES AND BEDDING.

ALSO INCLUDED IS:

NO.	TYPE	PERSONS	LOCATION	WEIGHT
1	LIFE RAFT	16	MIDSHIP	189
2	LIFE RAFT	16	AFT	242
3	LIFE RAFT	16	AFT	129

BATTERY

NO.	TYPE	LOCATION	WEIGHT
1	AFT GUN	AFT	8.4
2	FWD GUN	FWD	3.0
3	20 M.M. ANTI-AIRCRAFT	MIDSHIP	2.9
4	20 M.M. ANTI-AIRCRAFT	AFT	2.9

PLASTIC ARMOR: ON MIDSHIP DECK HOUSE - WEIGHT ADDED 7.0
 GUN PLATFORMS AND BULKHEADS TOTAL WEIGHT 44.4
 AMMUNITION STOWAGE TOTAL WEIGHT 6.0
 ADDITIONAL QUARTERS FOR SUNNERS TOTAL WEIGHT 14.7
 DECAUSING SYSTEM TOTAL WEIGHT 15.8
 CARGO DECK TOTAL WEIGHT 75.8

THE FOLLOWING ITEMS ARE NOT INCLUDED IN THE LIGHTSHIP WEIGHT: AMMUNITION, FUEL OIL IN SETTLING OR STOWAGE TANKS, LUBE OIL IN SETTLING OR STOWAGE TANKS, FRESH WATER IN CULINARY OR FEED WATER TANKS, CONSUMABLES REPRESENTED ON DRY STORES AND CREW AND THEIR EFFECTS.

REGISTERED

DATE ISSUED

DISTRIBUTION

T2-SE-AI TANKER

GENCO HULLS 1914-20 2302-24 2710-25 1983-83

UNITED STATES MARITIME COMMISSION

EFFECTIVE HULL ST. USMC 1914

KAISER COMPANY, INC. K-700-9

CAPACITY PLAN

S.S. MODOG-POINT

THEODOXUS

APPROVALS

DRWG. NO. K-700-9 ALT. A

"THEODOXUS" ★

Capacity plan

RECORDS DEPT..
LONDON

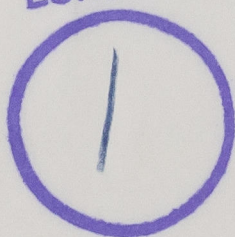

© 2020

Lloyd's Register
Foundation

003092-003099-10001