

# Lloyd's Register of Shipping.

## SURVEYS FOR FREEBOARD.

### (CONDITIONS OF ASSIGNMENT.)

Ship's Name ~~LANEVIEW~~ EMPIRE PLOVER

Port of Survey New Orleans LA.

Official Number ~~220704~~ 168189

Surveyor's Signature J. Rennie

Nationality and Port of Registry BRITISH  
~~GLASGOW~~ LONDONDate of Survey Oct. 28, 29 and 31. Nov. 1st  
1940.

Disposition and dimensions of superstructures, trunks, deckhouses and machinery casings to be inserted in the diagrams and tabular statement : --

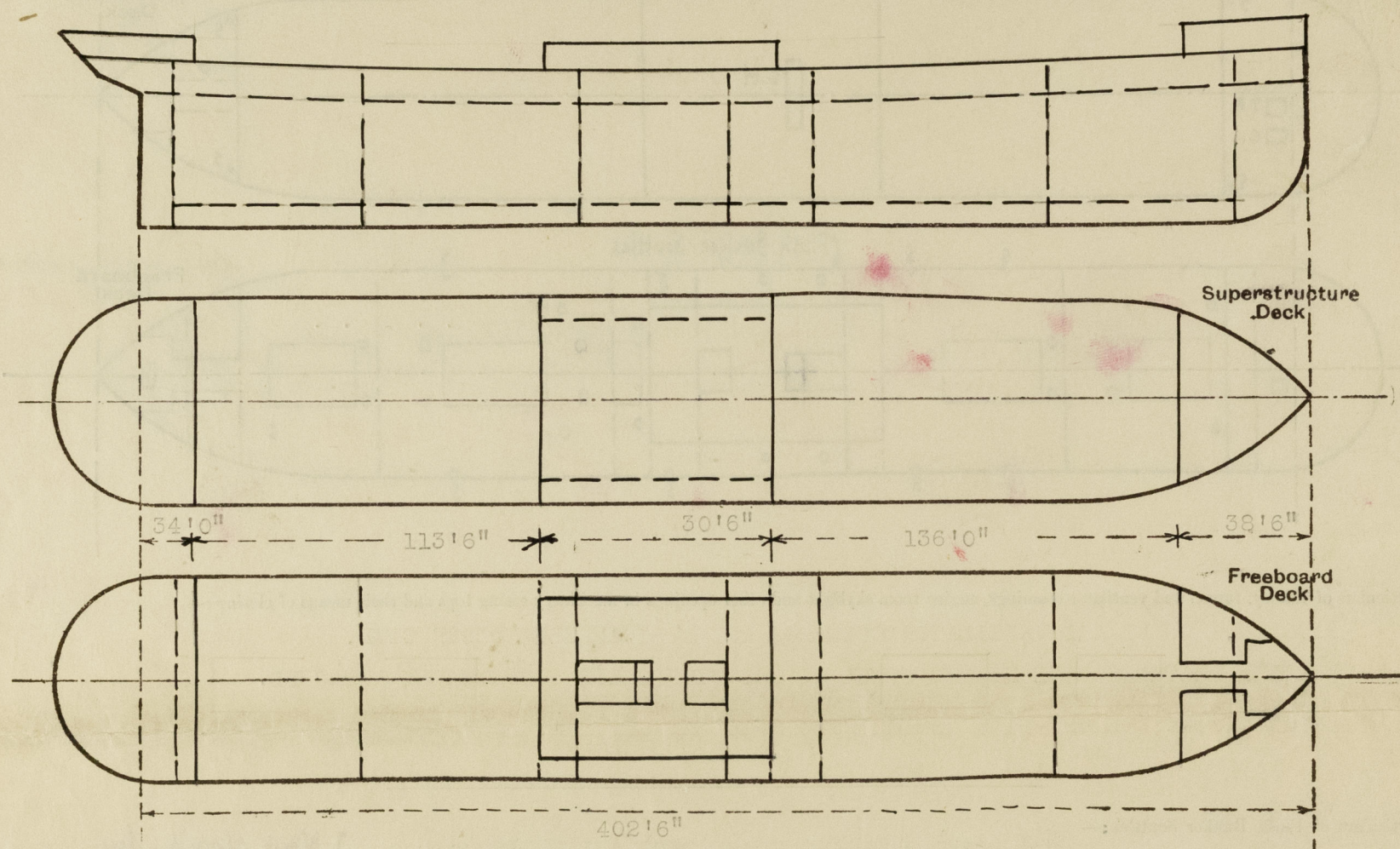

Particulars of Superstructures, Trunks, Casings, Deckhouses.

	Coaming	Plating	Stiffeners	Spacing	End Attachments of Stiffeners	Size of Openings	Height of Sills	Height of Casings
Poop Bulkhead ... ..	.44	.38	8x3 $\frac{1}{2}$ x3 $\frac{1}{2}$ x38	23" - 34"	Lugged	20'4"9"x2'0"	22"	8'0"
Raised Quarter Deck Bulkhead ...	✓							
Bridge, After Bulkhead ... ..	✓							
Bridge, Forward Bulkhead ... ..	✓							
Forecastle Bulkhead ... ..	.44	.30	5x3x.44L	33	Contd. to Longal at top. None at btm.	4'6" x2'0"	18"	7'9"
Trunk, Aft ... ..	✓							
Trunk, Forward ... ..	✓							
Exposed Machinery Casings on Freeboard or Raised Quarter Decks ...	.34	.28	4x3x.44L	24"	Lugged, bktd. to deck Extended below deck	20'4"6"x2'0"	18"	8'0"
Exposed Machinery Casings on Superstructure Decks ... ..	✓	(Protected by Light Deckhouse) Steel doors 15" sills.						
Machinery Casings within Superstructures not fitted with Class I Closing Appliances ... ..	✓							
Deckhouses on Flush Deck Ships ...	✓							

Particulars of Closing Appliances (state if capable of being manipulated from both sides).

Poop Bulkhead ... ..	HINGED STEEL WATERTIGHT DOORS - OPERATED FROM BOTH SIDES.	
Raised Quarter Deck Bulkhead ...	✓	
Bridge, After Bulkhead ... ..	✓	
Bridge, Forward Bulkhead ... ..	✓	
Forecastle Bulkhead ... ..	OPEN (DOORS - WOOD PANELLED. LESS THAN CLASS II REQUIREMENTS)	
Exposed Machinery Casings on Freeboard or Raised Quarter Decks ...	HINGED STEEL DOORS-OPERATED FROM BOTH SIDES	
Exposed Machinery Casings on Superstructure Decks ... ..	✓	
Machinery Casings within Superstructures not fitted with Class I Closing Appliances ... ..	✓	
Deckhouses on Flush Deck Ships ...	✓	



# PARTICULARS OF PROTECTION TO OPENINGS, ETC.

The following diagrams should be used to indicate the positions of cargo and coaling hatchways, gangway, cargo and coaling ports, ventilators, companionways, etc., which would affect the seaworthiness of the ship:—

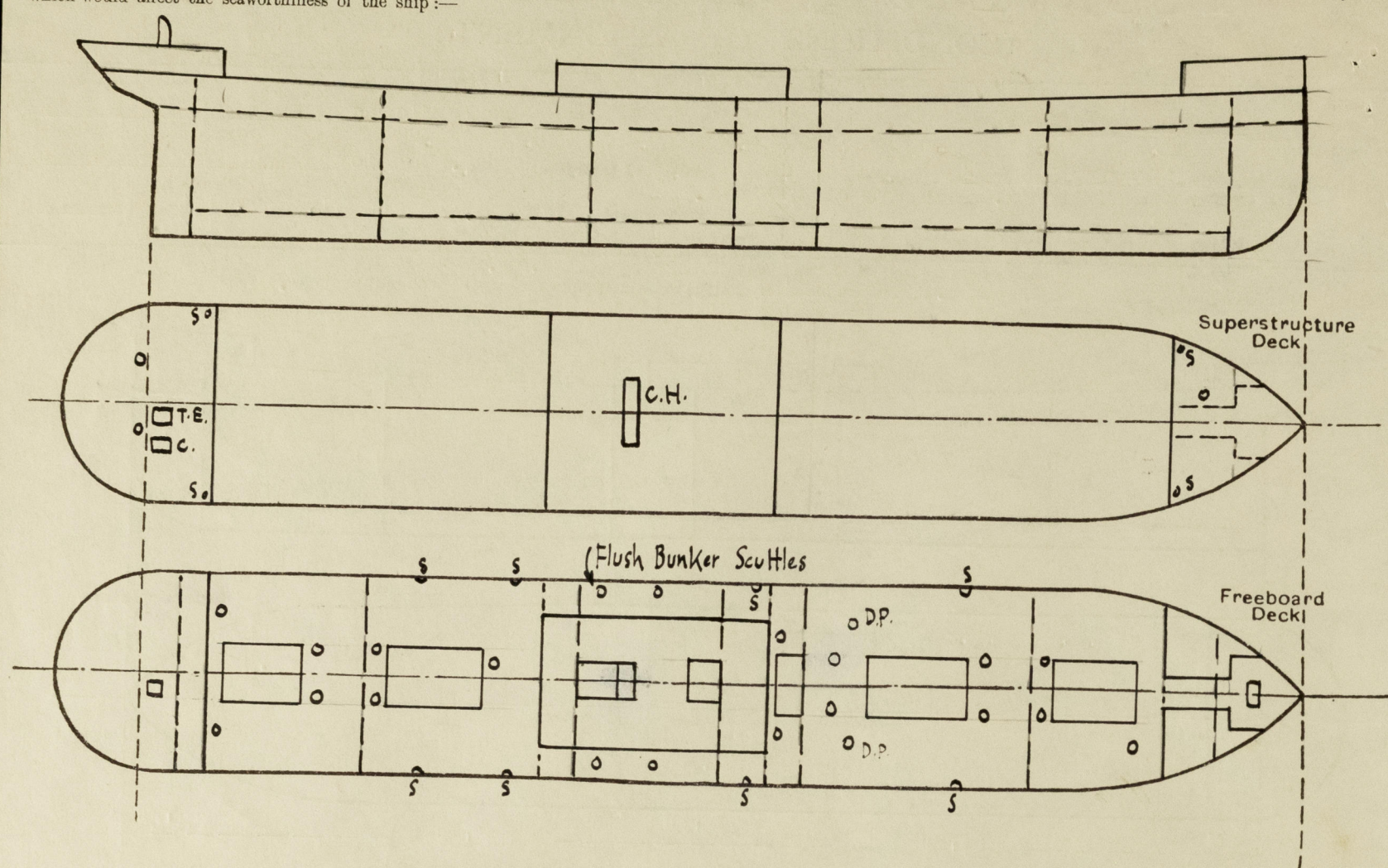

Particulars of fiddle, funnel and ventilator coamings, engine room skylight and other openings in machinery casing tops and their means of closing:—

FIDDLEY, FUNNEL AND VENTILATOR COAMINGS ARE EFFICIENTLY CONSTRUCTED. ✓

FIDDLEY GRATINGS HAVE HINGED STEEL COVERS WITH CLIPS PERMANENTLY ATTACHED. ✓

ENGINE ROOM SKYLIGHT IS OF STEEL WITH STEEL HINGED FLAPS AND GLASS BULLS EYES. ✓

Particulars of Flush Bunker Scuttles:—

TWO P AND S ON FREEBOARD DECK AMIDSHIPS ✓  
SCREWED STEEL SCUTTLE (WITH CHAIN ATTACHED). ✓

*} Now closed by riveted steel plates.*

Particulars of Companionways:—

ONE ON POOP DECK 6'6" x 4'0" x 2'4" ✓  
HINGED STEEL DOOR - OPERATED BOTH SIDES - SILL 18" ✓  
COMPANIONWAY OF STEEL STRONGLY CONSTRUCTED ✓

Particulars of Ventilators in exposed positions on freeboard and superstructure decks:—

FOCLE 1 @ 36" x 12" x .30" ✓

FBD.

DECK 14 @ 36" x 24" x .38" ✓  
2 @ 36" x 12" x .28" ✓

All coamings are provided with

canvas covers and wood plugs. ✓

POOP 2 @ 36" x 12" x .28" ✓

1 @ 27" x 30" x .38" TO TUNNEL ESCAPE ✓

TWO DERRICK POSTS 24" DIAM. STRONGLY CONSTRUCTED. SERVE AS VENTS ON FBD. DECK. ✓

Particulars of Air Pipes in exposed positions on freeboard, raised quarter, or superstructure decks:—

FOCLE 1 @ 3 1/2" diam. ✓ Mouth 21" above deck. ✓

POOP 1 @ 3 1/2" diam. ✓ Mouth 21" above deck. ✓

FBD. DECK 22 @ 3 1/2" diam. ✓ Mouth 36" above deck. ✓

2 @ 3 1/2" diam. ✓ Mouth 21" above deck. (To D. T. and protected by hatch coaming) ✓

AIR PIPES ARE PROVIDED WITH CANVAS COVERS AND WOOD PLUGS OR WIRE GAUZE. ✓

EMPIRE PLOVER.

Particulars of Gangway Cargo and Coaling Ports:—

Particulars of Scuppers and Sanitary Discharge Pipes:—

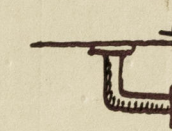

Scuppers from fbd. deck are cast pipes.

Pipe scuppers from fcle. and poop drain on to fbd. deck.

No sanitary discharge pipes from spaces below fbd.dk.

Pipes from poop, fcle., and deckhouses have flap valves at shipside.

Particulars of Side Scuttles:—

Poop and fcle. spaces 10" brass sidelights (hinged) Those on poop fitted with deadlights.

Vertical distance of Sill of lowest Side Scuttle above top of keel

None below freeboard deck.

Particulars of Guard Rails:—

Open rails. Three tiers - stanchions 42" high

spaced about 42" cr. to cr. ✓

Particulars of Gangways, Lifelines, etc.:—

Manila lifelines and fittings provided. ✓

(Wire ropes with tightening screws fitted) ✓

## Particulars of Freeing Arrangements.

	Length of Bulwark	Height of Bulwark	Size of Freeing Ports	Number each side	Area each side	Rule area each side
After Well ...	OPEN	RAILS ✓				
Forward Well ...						

State position of each freeing port ... After Well:—

(F. and A. position and height above deck edge) Forward Well:—

State whether the freeing ports are fitted with shutters, bars, or rails, and give particulars of such:—

Additional area where sheer is less than standard.



© 2020

Lloyd's Register Foundation

0055 1/2

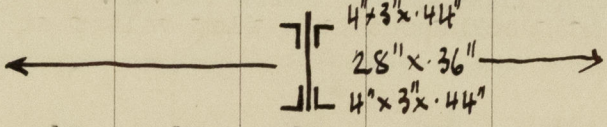

PARTICULARS OF PROTECTION TO OPENINGS, ETC.

HATCHWAYS ON FREEBOARD AND SUPERSTRUCTURE DECKS.										ON DECKHOUSE
FBD. DECK										
Description of Hatchway	No. 1	2	3	4	5	To fore peak store	To aft peak store	W.T. Manhole	COALING HATCH	
Dimensions of Hatchway	36'8"x20'	36'8"x20'	8'x 20'	36'8"x20'	33'x20'	4'x4'	3'6"x3'	1'6"x1'3"	4'0"x16'0"	
COAMINGS	Height above Deck	33"	33"	33"	33"	15"	12"	3"	3"	
	Thickness	.50"	.50"	.50"	.50"	.40"	.40"	.30"	.30"	
	Stiffeners	6x3 1/2"x.44	6x3 1/2"x.44	6x3 1/2"x.44	6x3 1/2"x.44	6x3 1/2"x.44	-	-	-	
	Brackets, Stays	2	2	-	2	2	-	-	-	
HATCH BEAMS	Number	6	6	1	6	5				
	Spacing	5'3"	5'3"	4'5"-3'7"	5'3"	5'6"				
	Scantling and Sketch									
	Bearing Surface	3 1/2"	3 1/2"	3 1/2"	3 1/2"	3 1/2"				
FORE AND AFTERS	Number									
	Spacing									
	Unsupported Lengths									
	Scantling* and Sketch			NONE						
HATCH COVERS	Material			OREGON & WHITE PINE		W.P.	W.P.	CAST	W.P.	
	Thickness			3"		2 1/2"	GRATING	STEEL	2 1/2"	
	How fitted			F. & A.		F. & A.		COVER	F. & A.	
	Bearing Surface			3 1/2" minm.		3"			3"	
Spacing of Cleats										
Number of Tarpaulins			24" maxm. 2 minm.		2 per side 2				24" 2"	
*Are wood fore and afters steel shod at all bearing surfaces? -										
Are battens and wedges efficient and in good condition? Yes										
Are tarpaulins in good condition and in accordance with rule requirements? Yes										
Are lashings provided in accordance with rule requirements? Yes										

Particulars of any special features :—

Endorsement at first survey and at surveys for renewal of Certificate :—

The fittings and appliances are in accordance with the particulars shown on this form (or as now modified) and are in good condition.

