

# Lloyd's Register of Shipping.

## SURVEYS FOR FREEBOARD.

### (CONDITIONS OF ASSIGNMENT.)

CHRISTIAN S

Ship's Name "~~BLOOMFIELD PARK~~ SUNDALÉ Port of Survey Saint John, N. B. Canada.  
 Official Number \_\_\_\_\_ Surveyor's Signature J. Good.  
 Nationality and Port of Registry \_\_\_\_\_ Date of Survey during construction

Disposition and dimensions of superstructures, trunks, deckhouses and machinery casings to be inserted in the diagrams and tabular statement:—

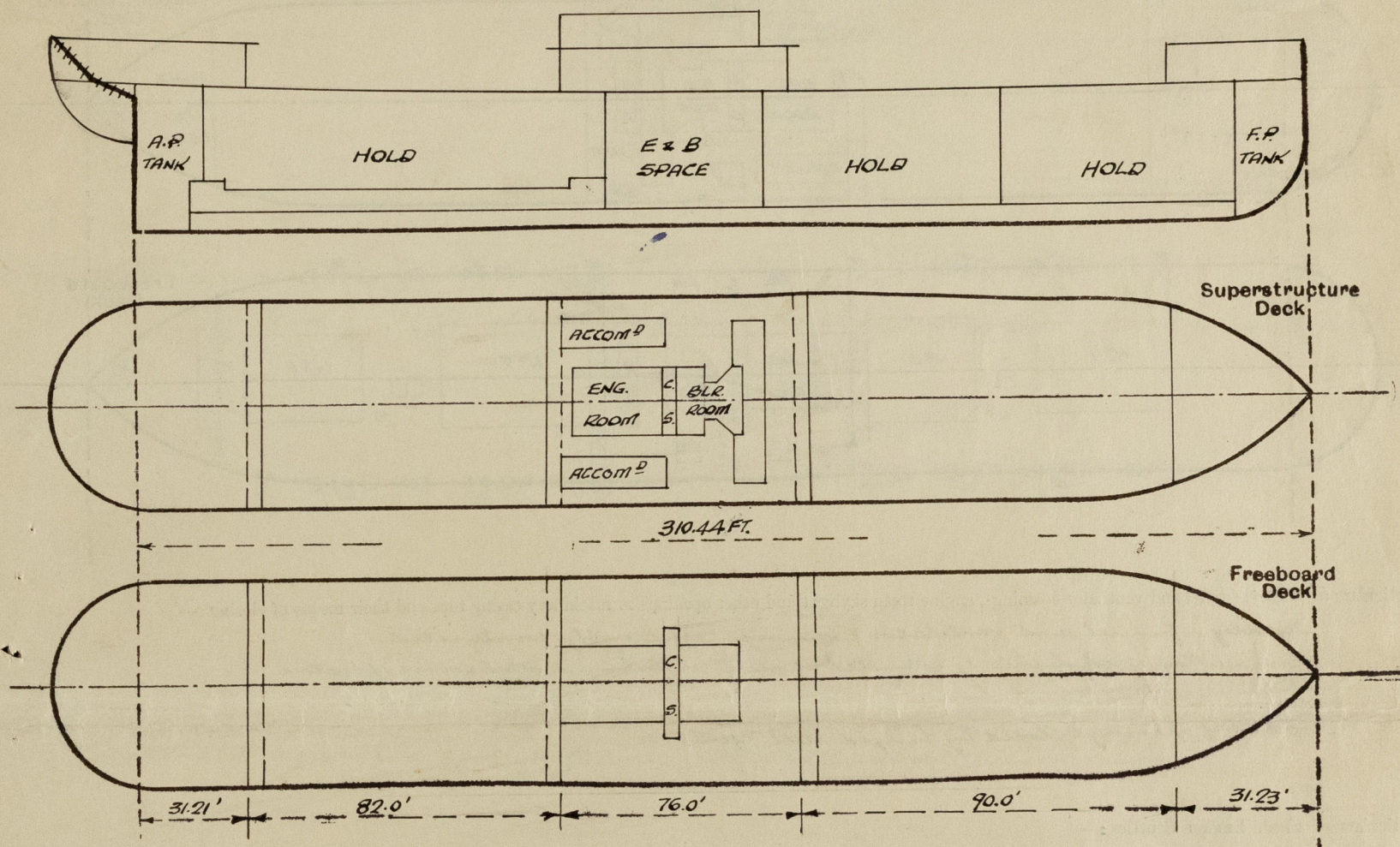

Particulars of Superstructures, Trunks, Casings, Deckhouses.								
	Coaming	Plating	Stiffeners	Spacing	End Attachments of Stiffeners	Size of Openings	Height of Sills	Height of Casings
Poop Bulkhead ...	—	11/32"	5"x3"x3/8" O.A.	NOT EXCEEDING 30"	LUGS TOP AND BOTTOM	NONE	—	7'-6"
Raised Quarter Deck Bulkhead ...	—	—	—	—	—	—	—	—
Bridge, After Bulkhead ...	—	9/32 & 5/16"	4"x3"x5/16 O.A. & DIV. BULK	AVERAGE 2'-4 1/2"	ENDS OF STIFFERS TAKE RIVETS IN BOUNDARY ANGLE	5'-0" x 2'-6" 4'-1" x 3'-1"	18"	9'-0"
Bridge, Forward Bulkhead ...	—	3/8"	8"x3 1/2" x 34 B.A.	— DO —	LUGS TOP AND BOTTOM	4'-9 1/2" x 2'-10 1/2"	18"	9'-0"
Forecastle Bulkhead ...	—	9/32"	4"x3"x5/16 O.A. & DIV. BULK	2'-3" TO 3'-6"	ENDS OF STIFFERS TAKE RIVETS IN BOUNDARY ANGLE	5'-1" x 3'-1" 4'-6" x 2'-0"	18"	7'-0"
Trunk, Aft ...	—	—	—	—	—	—	—	—
Trunk, Forward ...	—	—	—	—	—	—	—	—
Exposed Machinery Casings on Freeboard or Raised Quarter Decks ...	—	—	—	NONE	—	—	—	—
Exposed Machinery Casings on Superstructure Decks ...	18" x 1 1/32"	5/16"	3"x2 1/2" x 5/16 O.A.	2'-0"	BRACKETS AT TOP	5'-0" x 2'-0"	18"	7'-9"
Machinery Casings within Superstructures not fitted with Class I Closing Appliances ...	18" x 5/16"	1/4"	3"x2 1/2" x 5/16 O.A.	2'-0"	2 RIVETS THROUGH DECK BEAM	5'-0" x 2'-0"	18"	9'-0"
Deckhouses on Flush Deck Ships ...	—	—	—	—	—	—	—	—

Particulars of Closing Appliances (state if capable of being manipulated from both sides).

Poop Bulkhead ...	No openings. ✓
Raised Quarter Deck Bulkhead ...	✓
Bridge, After Bulkhead ...	Portable steel plates with hook bolts and hinged steel doors manipulated from both sides. ✓
Bridge, Forward Bulkhead ...	Hinged steel W.T. doors manipulated from both sides. ✓
Forecastle Bulkhead ...	Portable steel plates with hook bolts and hinged steel doors manipulated from both sides. ✓
Exposed Machinery Casings on Freeboard or Raised Quarter Decks ...	None. ✓
Exposed Machinery Casings on Superstructure Decks ...	Hinged steel doors manipulated from both sides. ✓
Machinery Casings within Superstructures not fitted with Class I Closing Appliances ...	Hinged steel doors manipulated from both sides. ✓
Deckhouses on Flush Deck Ships ...	✓



## PARTICULARS OF PROTECTION TO OPENINGS, ETC.

The following diagrams should be used to indicate the positions of cargo and coaling hatchways, gangway, cargo and coaling ports, ventilators, companionways, etc., which would affect the seaworthiness of the ship:—

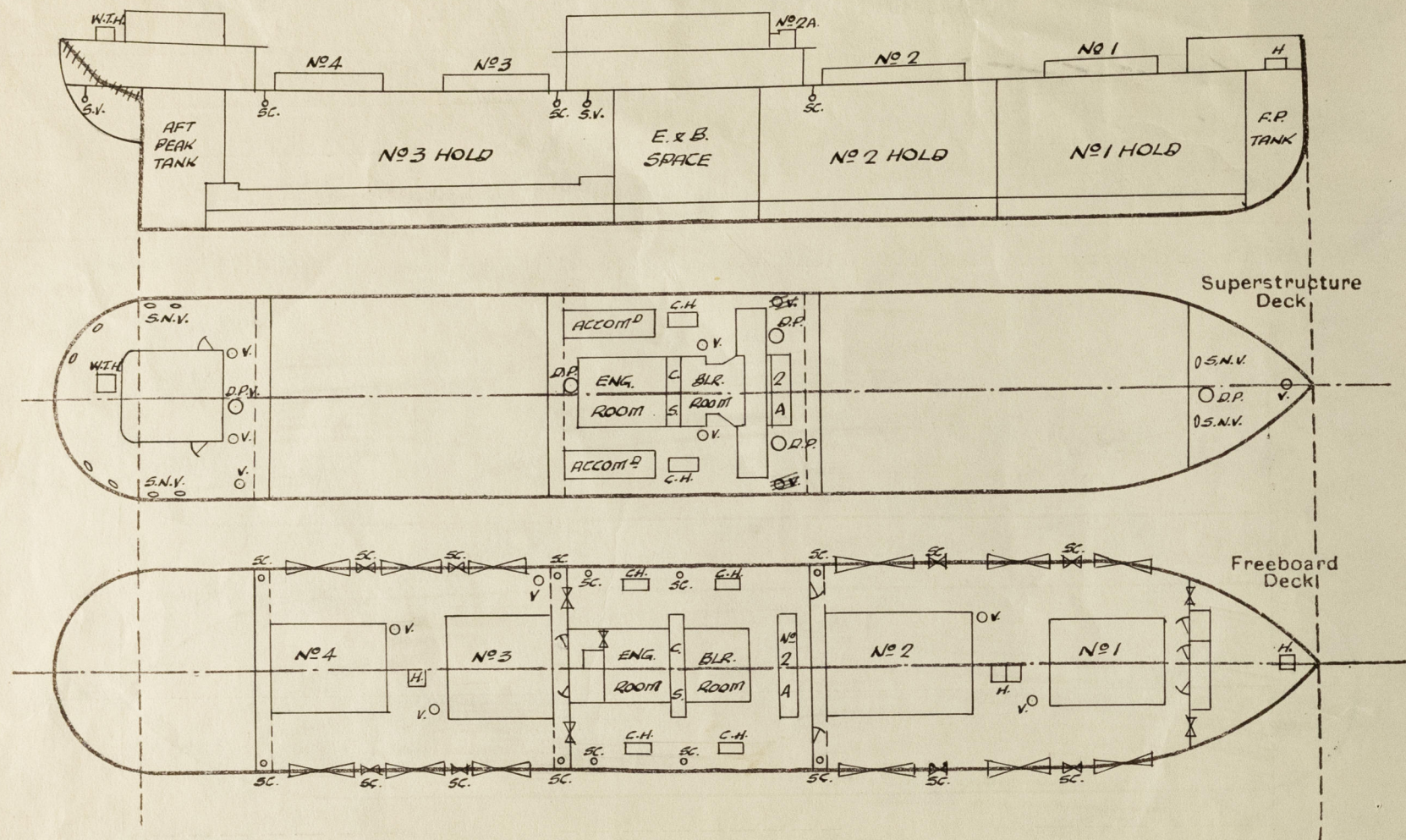

Particulars of fiddley, funnel and ventilator coamings, engine room skylight and other openings in machinery casing tops and their means of closing :—

Exhaust openings closed by hinged steel covers. ✓  
 Taddy, funnel and ventilator coverings, engine room skylight and other openings efficiently constructed. ✓  
 Engine Room skylights constructed of steel with hinged steel covers operators from inside of casing. ✓  
 Taddy openings closed by hinged steel covers. ✓

Particulars of Flush Bunker Scuttles:—

None ✓

Particulars of Companionways :—

Entrance to Crew's Quarters on Poop Deck - opening in casing side (P&S) with hinged steel door, 4'-11" x 1'-11" sill 21" above deck, door manipulated from both sides ✓

Particulars of Ventilators in exposed positions on freeboard and superstructure decks :—

Upper Deck 4 @ 15" dia. coaming 36" x 11/32" to holds. ✓  
1 @ 15" " " 11'-6" x 11/32" to holds (stayed at Bridge End). ✓

Paop Deck 1 @ 15" " " 30" x 11/32" " " ✓  
2 @ 8" " " 32" x 5/16" " accommodation. ✓  
8 @ 8" x 4" S.N.V. " 30" to opening to crew's accommodation. ✓

Bridge Deck 3 derrick posts with M.V. on top on ford posts - to hold ✓  
3 @ 12" dia. coaming 36" x 11/32" to tunnel and Bridge space. ✓

Forecastle Deck 1 derrick post with M.V. on top " hold. ✓  
1 @ 6" dia. coaming 26" x 5/16" " I. Pak Store ✓  
2 @ 8" x 4" S.N.V. " 36" to opening to Forecastle. ✓

Vents supplied with plugs and covers. ✓

Particulars of Air Pipes in exposed positions on freeboard, <sup>and</sup> ~~raised quarter,~~ or superstructure decks :—

Upper Deck	1 P & S	3 1/2" dia.	36"	to opening to D.B. Tank.
	1 P & S	2 1/2 "	36"	" " " "
Lower Deck	1 @	3 1/2 " dia.	27"	" " " Fore Peak Tank.
	1 @	4" "	18"	" " " " D.B. Tank.
Bridge Deck	1 P & S.	3" dia.	18"	" " " " Dry Tank.
	2 P & S.	2 1/4 " "	18"	" " " " E.R. Tank.
	1 P & S.	3 1/2 " "	18"	" " " " D.B. Tank.
Poop Deck	1 @	4" dia.	18"	" " " " Aft Peak Tank.
	1 @	3" "	18"	" " " " Rudder Trunk.
	1 @	3" "	18"	" " " " Cruiser Stern Space.

Air pipes supplied with plugs!

SUNDAY

Particulars of Gangway Cargo and Coaling Ports:—

None

Particulars of Scuppers and Sanitary Discharge Pipes :—

4 Scuppers on exposed part of Girdboard Deck cut through deck stringer angle P&S. ✓  
 All sanitary discharges fitted on ship side P&S. above Girdboard Deck and fitted with storm valves. ✓  
 3-3" dia. pipe scuppers fitted on Girdboard Deck at Bridge Ends and Poop Deck led through ship side below 1st Dk. (P&S). ✓  
 1-2" " " scupper " " " from Refug. Room led through ship side below 1st Dk. with Storm Valve (S.S.). ✓  
 1-2" " " " " " " " " " " " " " (P.S.). ✓  
 2-3 1/2" " " scuppers " " " " in Bridge Space led to bilges with cock and weighted handle (P&S). ✓

Particulars of Side Scuttles :—

Poop Space: 12" dia. side scuttles fitted with hinged deadlights efficiently constructed. ✓

Vertical distance of Sill of lowest Side Scuttle above top of keel..... *All side scuttles fitted above Treeboard Deck.*

Particulars of Guard Rails :—

Poof Deck:	2 rows of rails, stanchions	3'-0" high	spaced about 4'-6" apart.
Bridge Deck:	3 " " "	3'-9" "	" " 4'-9" "
Forecastle Deck:	2 " " "	3'-0" "	" " 4'-9" "

Particulars of Gangways, Lifelines, etc.:—

*Sittings provided at ends of Pop., Bridge and Forecastle Decks for rigging lifelines.* ✓

Particulars of Freeing Arrangements.						
	Length of Bulwark	Height of Bulwark	Size of Freeing Ports	Number each side	Area each side	Rule area each side
After Well ... ..	82'-0"	5'-0"	1 @ 12'-0" x 8 1/2" 1 @ 13'-10" x 8 1/2" 1 @ 11'-9" x 8 1/2"	3	26.68 $\phi$	16.4 $\phi$
Forward Well ... ..	90'-0"	5'-0"	1 @ 11'-7" x 8 1/2" 1 @ 11'-9" x 8 1/2" 1 @ 11'-10" x 8 1/2"	3	25.00 $\phi$	18.0 $\phi$
State position of each freeing port ... .. { <div style="display: inline-block; vertical-align: top; margin-left: 10px;">                         After Well:—                          (F. and A. position and height above deck edge) Forward Well:—                     </div> <div style="display: inline-block; vertical-align: top; margin-left: 10px;"> <div style="text-align: center;">POOP FRONT</div> <div style="text-align: center;">BRIDGE FRONT</div> </div> <div style="display: inline-block; vertical-align: top; margin-left: 10px;">                         } Height above deck edges 7 1/3.                     </div>						
State whether the freeing ports are fitted with shutters, bars, or rails, and give particulars of such:— none.						
Additional area where sheer is less than standard.						



PARTICULARS OF PROTECTION TO OPENINGS, ETC.

HATCHWAYS ON FREEBOARD AND SUPERSTRUCTURE DECKS.											
Freeboard Deck					S. S. Deck						
Description of Hatchway	Nos. 1 & 4	Nos. 2 & 3	No. 2A	Access to Holds	Inside Forecastle	Inside Bridge Space	No. 2A Bridge Deck	Coaling Hatchways	Hatchways on Poop Deck	Hatchways on Lower Deck	
Dimensions of Hatchway	32'-0" x 22'-0"	34'-0" x 24'-0"	24'-0" x 8'-0"	11'-6" x 2'-6" F. 5'-0" x 2'-6"	4'-0" x 3'-0"	6'-0" x 3'-0" 10'-0" x 3'-0"	5'-10" x 16'-0"	12'-0" x 3'-0"	3'-0" x 3'-0"	6'-0" x 12'-6"	
COAMINGS	Height above Deck ... 31" Thicknes ... 50" Stiffeners ... 9" x 3 1/2" x 44" Brackets, Stays ... 2" dia. 3 P&S	Height above Deck ... 31" Thicknes ... 50" Stiffeners ... 9" x 3 1/2" x 44" Brackets, Stays ... 2" dia. 3 P&S	Height above Deck ... 9" x 3 1/2" x 44" Thicknes ... 50" Stiffeners ... 9" x 3 1/2" x 44" Brackets, Stays ... 2" dia. 3 P&S	31" 7/16"	9" x 3 1/2" x 44" 7/16"	9" x 3 1/2" x 44" 7/16"	31" 7/16"	31" 7/16"	18" 3/8"	8" x 3 1/2" x 34"	
HATCH BEAMS	Number ... 5 Spacing ... 5'-4" Scantling and Sketch ... Plate 20 x 1 1/2" 4 angles 5" x 3 1/2" x 7/16" Bearing Surface ... 4"	Number ... 6 Spacing ... 4'-10 1/4" Scantling and Sketch ... Plate 20 x 3/8" 4 angles 5" x 3 1/2" x 50" Bearing Surface ... 4"	Number ... 1 Spacing ... 4'-0" Scantling and Sketch ... Plate 17 x 1 1/2" 4 angles 5" x 3 1/2" x 50" Bearing Surface ... 4 3/8"	none	none	none	none	none	none	none	
FORE AND AFTERS	Number ... Spacing ... Unsupported Lengths ... Scantling* and Sketch ... Bearing Surface ...	none									
HATCH COVERS	Material ... Spruce Thickness ... 2 1/2" How fitted ... F & A Bearing Surface ... 5" x 4"	Material ... Spruce Thickness ... 2 1/2" How fitted ... F & A Bearing Surface ... 5" x 4"	Material ... Spruce Thickness ... 2 1/2" How fitted ... F & A Bearing Surface ... 5" x 3"	Material ... Spruce Thickness ... 2 1/2" How fitted ... Bearing Surface ... 2 1/2"	Material ... Spruce Thickness ... 2 1/2" How fitted ... Bearing Surface ... 2 1/2"	Material ... Spruce Thickness ... 2 1/2" How fitted ... Bearing Surface ... 2 1/2"	Material ... Spruce Thickness ... 2 1/2" How fitted ... Bearing Surface ... 2 1/2"	Material ... Spruce Thickness ... 2 1/2" How fitted ... Bearing Surface ... 2 1/2"	Material ... Spruce Thickness ... 2 1/2" How fitted ... Bearing Surface ... 2 1/2"	Material ... Hinged steel W.T. cover and fastenings Thickness ... 2 1/2" How fitted ... Bearing Surface ... 2 1/2"	Material ... Spruce Thickness ... 2 1/2" How fitted ... F & A Bearing Surface ... 3"
Spacing of Cleats	23 1/2"	23 1/2"	21"	24" & 19"	19"	21"	19"	22"	20"	20"	
Number of Tarpaulins	3	3	1	3	1	1	3	3	✓	3	
<p>*Are wood fore and afters steel shod at all bearing surfaces? no fore and afters.</p> <p>Are battens and wedges efficient and in good condition? yes.</p> <p>Are tarpaulins in good condition and in accordance with rule requirements? yes.</p> <p>Are lashings provided in accordance with rule requirements? Ring bolts fitted on side coamings of exposed cargo hatches.</p>											

Particulars of any special features:—

Timber Load Line Particulars

Forecastle - Length 31.23 ft. Height 9.0 ft. Poop Height 7'-9" with deckhouse enclosing steering engine. Machinery casings on Freeboard Deck. Inside Bridge Space Height 9'-0". Double bottom tanks fitted within midship half of vessel have centre girder unpierced, except in way of dry tank under boilers where centre girder has timber holes. Bulwark fitted in forward and after wells, with top rail and stays to deck, freeing ports provided. Alternative arrangement of blocks and wires provided for steering in the event of breakdown in main steering gear. Eyeplates provided for lashings and riveted to sheerstrake in accordance with Clause 91 of Load Line Rules. Sockets for uprights provided on upper deck and bulwark rail in accordance with Load Line Rules.

Endorsement at first survey and at surveys for renewal of Certificate:—

The fittings and appliances are in accordance with the particulars shown on this form (or as now modified) and are in good condition.



© 2020

Lloyd's Register Foundation