

# Lloyd's Register of Shipping.

## SURVEYS FOR FREEBOARD.

(CONDITIONS OF ASSIGNMENT.)

 Index No. \_\_\_\_\_  
 (For London Office only.)

Ship's Name PUNTA ASPRA (EX. TURICUM.) Port of Survey ANTWERP.  
 Official Number \_\_\_\_\_ Surveyor's Signature J. J. J. J.  
 Nationality and Port of Registry ITALIAN. GENOVA. Date of Survey 20<sup>TH</sup> APRIL 1951

Disposition and dimensions of superstructures, trunks, deckhouses and machinery casings to be inserted in the diagrams and tabular statement:—

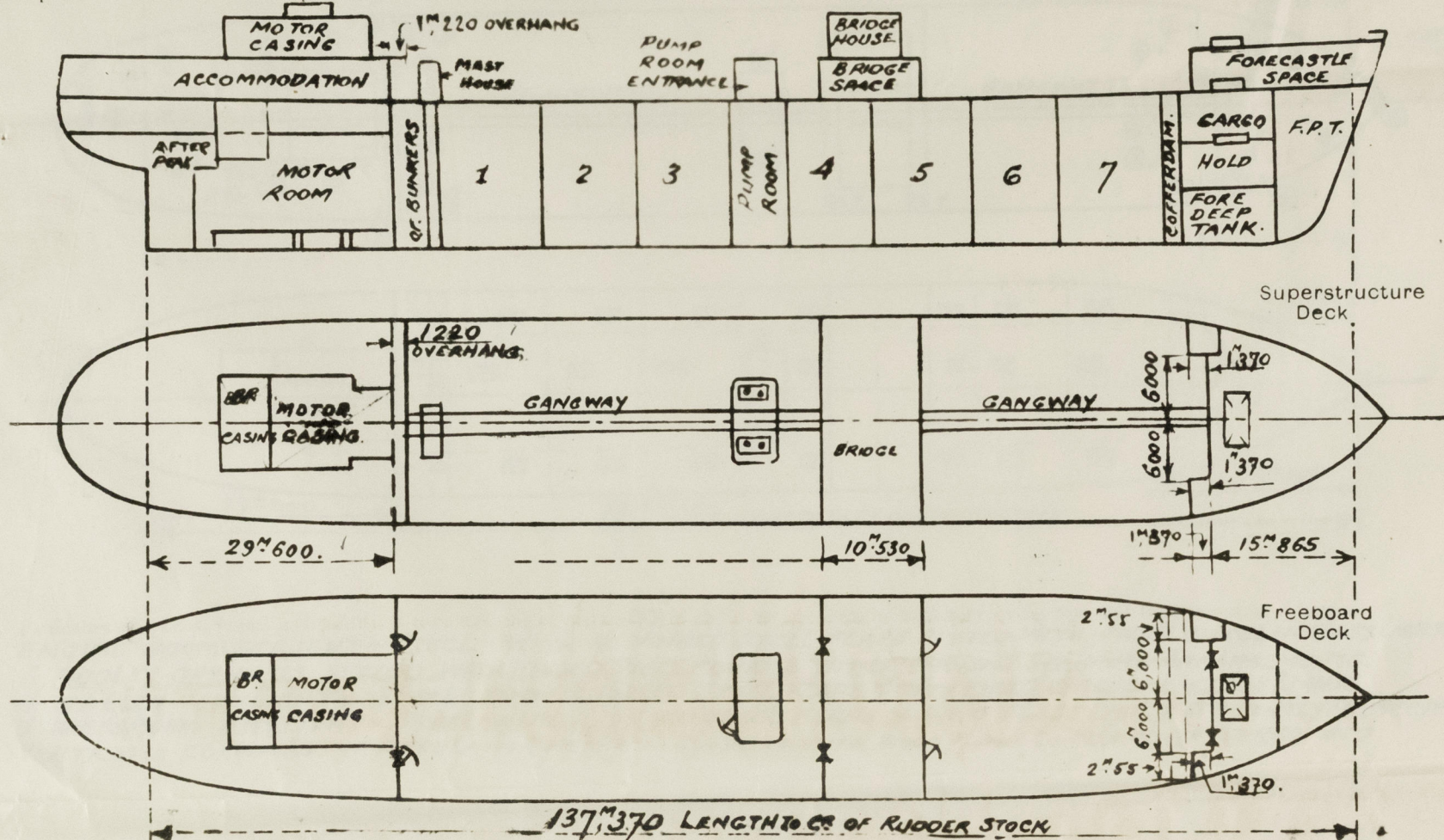

Particulars of Superstructures, Trunks, Casings, Deckhouses. METRIC DIMENSIONS								
	Coaming	Plating	Stiffeners	Spacing	End Attachments of Stiffeners	Size of Openings	Height of Sills	Height of Casings
Poop Bulkhead ...	11,5 mm	10,5	250x90x12 L	910 & 760	TOP & BOTTOM LUGS 150x150x12 L	1400x660	460	2280
<del>Raised Quarter Deck Bulkhead ...</del>	—	—	—	—	—	—	—	—
Bridge, After Bulkhead ...	10	10	180x75x11 L	760	BOTTOM LUGS ONLY 150x150x12 L	1350x960	530	2280
Bridge, Forward Bulkhead ...	11	11	230x90x12 L	760	BOTTOM LUGS ONLY 150x150x12 L	1300x860	530	2280
Forecastle Bulkhead ...	8	8	150x75x9	650 & 770	NONE	1350x1000	560	2280
Trunk, Aft ...	NO	TRUNK	—	—	—	—	—	—
Trunk, Forward ...	NO	TRUNK	—	—	—	—	—	—
Exposed Machinery Casings on Freeboard <del>or Raised Quarter Deck</del> <b>PUMP ROOM CASING</b>	7	7	100x65x8 L	660	BRACKETS 280x280x10	1500x680	460	2280
Exposed Machinery Casings on Superstructure Decks ( <b>POOP DECK</b> )	8	7	130x75x8 L	760	BRACKETS 380x380x8	1370x680	380	2280
Machinery Casings within Superstructures not fitted with Class 1 Closing Appliances ( <b>IN POOP TRAIL DECK</b> )	9	8	230x90x12 L	760	BRACKETS 380x380x8	1700x680	205	2280
Deckhouses on <del>Flush Deck Ships</del> <b>BRIDGE DECK</b>	8	6,5	100x75x7 L	700	BRACKETS - TOP LUGS - BOTTOM 1700x600	1700x600	230	2430

Particulars of Closing Appliances (state if capable of being manipulated from both sides).

Poop Bulkhead ...	2 HINGED STEEL W.T. DOORS (MANIPULATED FROM BOTH SIDES (CLASS I.)
<del>Raised Quarter Deck Bulkhead ...</del>	—
Bridge, After Bulkhead ...	3" STORM BOARDS IN FULL HEIGHT FITTED IN RIVETED CHANNELS (CLASS 2.)
Bridge, Forward Bulkhead ...	HINGED STEEL DOORS W.T. MANIPULATED FROM BOTH SIDES (CLASS 1.)
Forecastle Bulkhead ...	3" STORM BOARDS FULL HEIGHT, FITTED IN RIVETED CHANNELS (CLASS 2.)
<del>Exposed Machinery Casings on Freeboard or Raised Quarter Decks ...</del>	—
Exposed Machinery Casings on Superstructure Decks ( <b>POOP DECK</b> )	HINGED STEEL DOORS; MANIPULATED FROM BOTH SIDES. (CLASS 2.)
Machinery Casings within Superstructures not fitted with Class 1 Closing Appliances ( <b>IN POOP SPACE</b> )	HINGED STEEL DOORS; MANIPULATED FROM BOTH SIDES (CLASS 2.)
Deckhouses on Flush Deck Ships ( <b>PUMP ROOM ENTRANCE</b> )	W.T. HINGED STEEL DOORS, MANIPULATED FROM BOTH SIDES (CLASS 1.)



# PARTICULARS OF PROTECTION TO OPENINGS, ETC.

The following diagrams should be used to indicate the positions of cargo and coaling hatchways, gangway, cargo and coaling ports, ventilators, companionways, etc., which would affect the seaworthiness of the ship:—

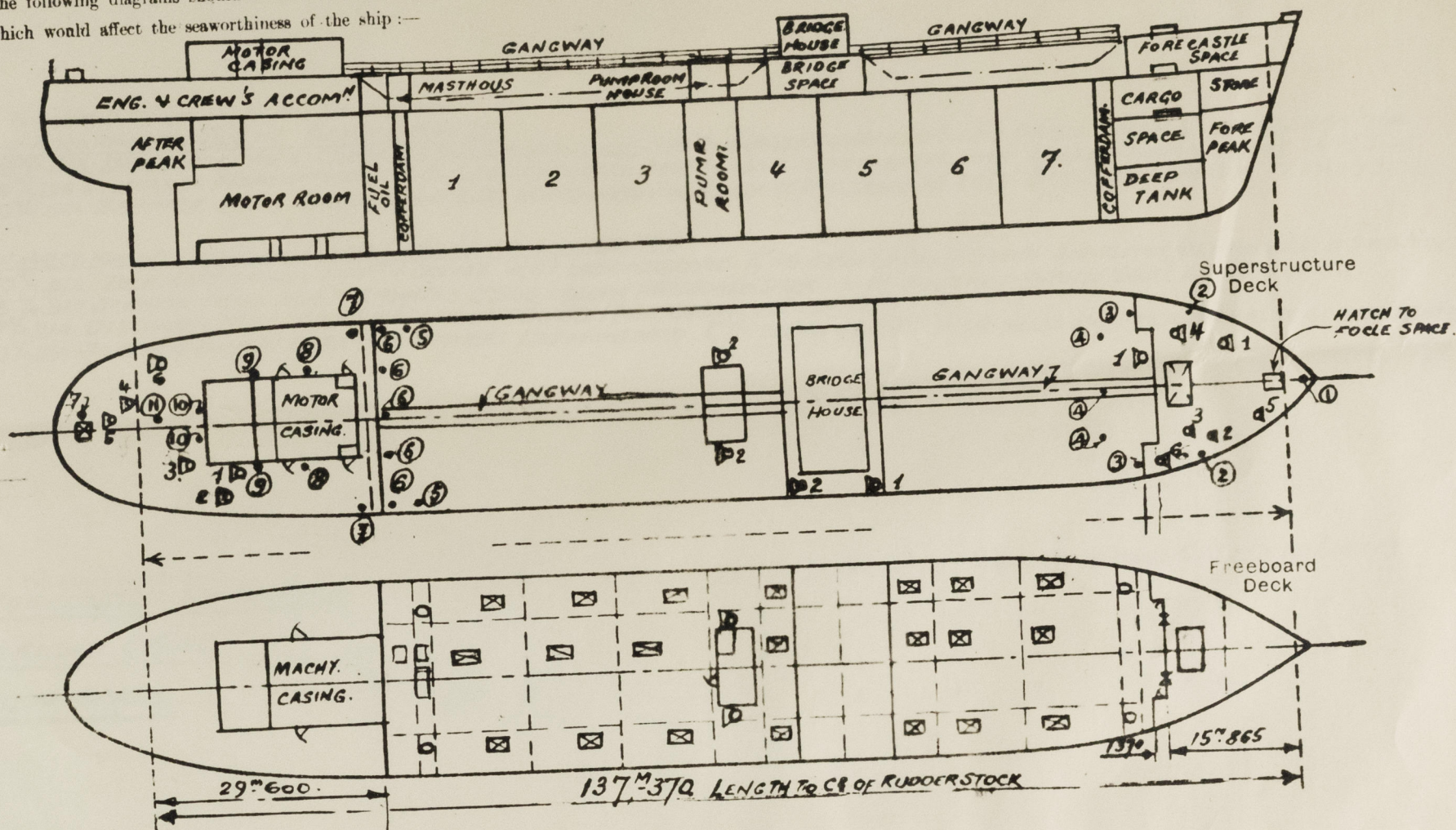

Particulars of filley, funnel and ventilator coamings, engine room skylight and other openings in machinery casing tops and their means of closing:—  
ENGINE ROOM SKYLIGHT - STEEL - WITH 12 HINGED STEEL FLAPS FITTED WITH FIXED CIRCULAR GLASS LIGHTS.  
6 FIDDLEY OPENINGS FITTED WITH HINGED STEEL COVERS WITH EFFICIENT SECURING ARRANGEMENTS.  
1 GALLEY SKYLIGHT - STEEL - WITH 4 HINGED STEEL FLAPS & WITH FIXED CIRCULAR GLASS LIGHTS.  
1 MESSROOM SKYLIGHT - STEEL - WITH 2 HINGED STEEL FLAPS & WITH GLASS LIGHTS EFFICIENTLY PROTECTED.  
VENTILATOR COAMINGS. OF REGULATION HEIGHT & SUPPLIED WITH WOOD PLUG & CANVAS COVER AS REQUIRED.

Particulars of Flush Bunker Scuttles:— **NONE**

Particulars of Companionways:—  
**DECKHOUSE ON POOP DECK - COAMING 8" - PLATING 7" - EFFICIENT WOOD HINGED DOORS - SILLS 15" HIGH.**

IDENTIFICATION		NOTE!	
Particulars of Ventilators in exposed positions on freeboard and superstructure decks		(ALL VENTILATORS FITTED WITH WOOD PLUGS & CANVAS COVERS)	
ON FORECASTLE DECK:—		HEIGHT OF COAMING	THICKNESS
1	300" DIA	900	12"
2	300" DIA	900	12"
3	350" DIA	900	12"
4	350" DIA	900	12"
5	250" DIA	900	8"
6	200" DIA	700	11"
ON FREEBOARD DECK		900	12"
1	600" DIA	3000	12"
2	900" DIA	760	10"
ON BRIDGE DECK		760	10"
1	200" DIA	850	10"
ON POOP DECK		1400	10"
1	300" DIA	900	10"
2	250" DIA	850	12"
3	250" DIA	850	12"
4	215" DIA	850	12"
5	200" DIA	850	12"
6	165" DIA	600	7"
7	180" DIA		

IDENTIFICATION NOS		NOTE!	
Particulars of Air Pipes in exposed positions on freeboard, raised quarter, or superstructure decks:			
ON FORECASTLE DECK	1 130" DIA	GOOSENECK TYPE	HEIGHT ABOVE DECK
	2 75" DIA	"	270" TO FOREPEAK TANK
	3 75	"	260 TO FORM DEPTANK P.V.S. SIDES.
	4 75	"	1" 600 TO FORM DEPTANK P.V.S. SIDES.
ON FREEBOARD DECK	5 75	"	870 TO FORM COFFERDAM P.V.S. SIDES
	6 75	"	870 TO FORM COFFERDAM CENTRE LINE
	7 75	"	1" 120 TO AFTER COFFERDAM.
	8 75	"	1" 300 TO FUEL TANK P.V.S. SIDES.
	9 75	"	1" 200 TO FUEL TANK, CENTRE LINE
	10 75	"	700 TO FUEL TANK P.V.S. SIDES
	11 75	"	300 TO D.B. TANK P.V.S. SIDES.
	12 75	"	600 TO D.B. TANK P.V.S. SIDES
ON POOP DECK.	13 75	"	500 TO D.B. TANK P.V.S. SIDES.
	14 75	"	250 TO F.W. TANK IN THREND ECK SPACE
	15 50	"	100 TO AFTER PEAK P.V.S. SIDES.
	16 75	"	

ALL AIR PIPES SUPPLIED WITH WOOD PLUGS AND/OR CANVAS COVERS.  
AIR PIPES TO OIL TANKS FITTED WITH GAUZE PROTECTION AT OPEN END OF PIPE.







# PARTICULARS OF PROTECTION TO OPENINGS, ETC.

HATCHWAYS ON FREEBOARD AND SUPERSTRUCTURE DECKS.										
Description of Hatchway	CARGO HATCH ON FORECASTLE DECK	HATCH ON FORECASTLE DECK	HATCH ON FORECASTLE DECK	HATCH ON FORECASTLE DECK	HATCH ON FORECASTLE DECK	HATCH ON FORECASTLE DECK	HATCH ON FORECASTLE DECK	HATCH ON FORECASTLE DECK	HATCH ON FORECASTLE DECK	HATCH ON FORECASTLE DECK
Dimensions of Hatchway	4'10" x 3'5 1/2"	4'10" x 3'5 1/2"	1'20" x 0'86"	1'20" x 0'86"	6'00" x 6'80"	6'00" x 6'80"	6'00" x 4'00"	9'50" x 7'60"	6'00" x 5'00"	6'00" x 5'00"
COAMINGS	Height above Deck	810	265	860	810	600	600	230	860	230
	Thickness	11 1/4"	12 1/4"	11 1/4"	11 1/4"	11 1/4"	11 1/4"	10 1/4"	11 1/4"	10 1/4"
	Stiffeners	8A, 180 x 75 x 10	NONE	NONE	8A, 230 x 90 x 11	NONE	NONE	NONE	8A, 230 x 90 x 11	NONE
	Brackets, Stays	NONE	NONE	NONE	NONE	NONE	NONE	NONE	NONE	NONE
HATCH BEAMS	Number	ONE								
	Spacing	1'5 1/2"								
	Scantling and Sketch	75 x 75 x 11								
	Bearing Surface	75 x 75 x 11								
FORE AND AFTERS	Number									
	Spacing									
	Unsupported Lengths									
	Scantling and Sketch									
HATCH COVERS	Material	W. PINE	STEEL	STEEL	STEEL	STEEL	STEEL	STEEL	STEEL	STEEL
	Thickness	3" (75)	8"	12"	15"	12"	10"	12"	12"	12"
	How fitted	FORE & AFT	BOLTED	HINGED AND BOLTED	HINGED AND BOLTED	HINGED AND BOLTED	HINGED AND BOLTED	HINGED AND BOLTED	HINGED AND BOLTED	HINGED AND BOLTED
	Bearing Surface	75								
Spacing of Cleats		600"								
Number of Tarps		2								

Are battens and wedges efficient and in good condition? YES.  
 Are tarpaulins in good condition and in accordance with rule requirements? YES.  
 Are lashings provided in accordance with rule requirements? YES.

Particulars of any special features:—

21 O.T. HATCHES TO CARGO TANKS ON FREEBOARD DECK

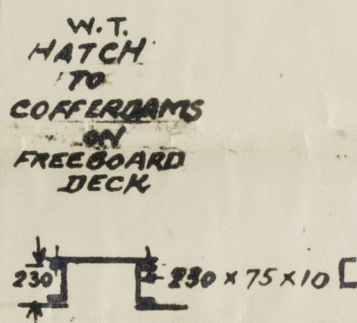
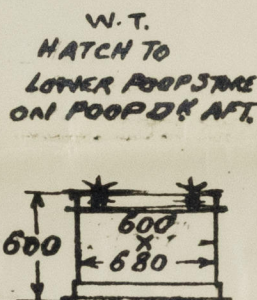
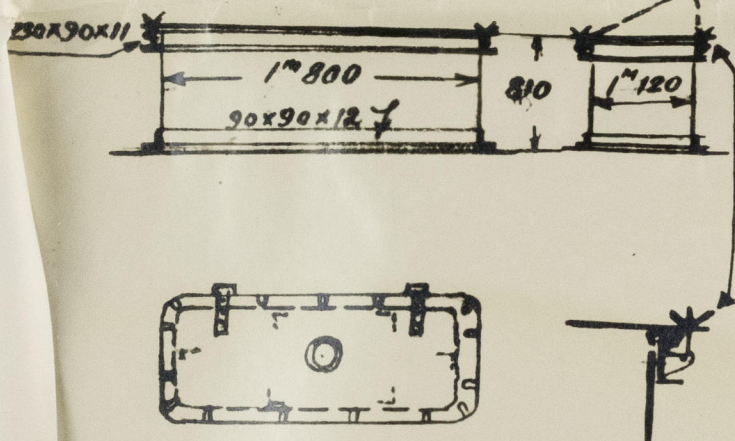

## GANGWAY.

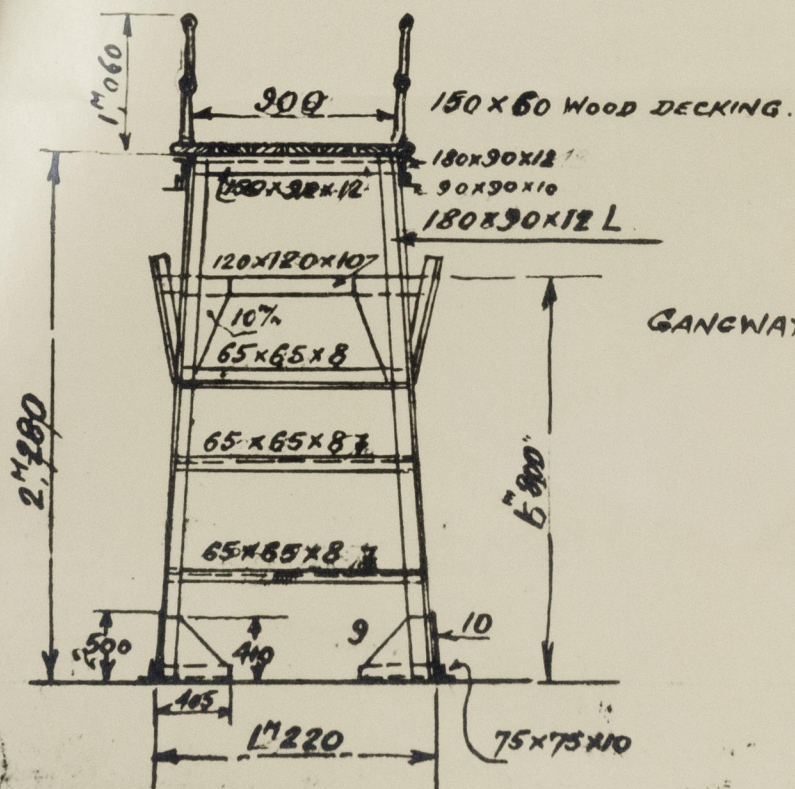

GANGWAY SUPPORTS SPACED ABOUT 2'700.



© 2020

Lloyd's Register Foundation