

# Nº 355-PROFILE & DECKS.

SCALE 1/8"=1 FOOT.

## DIMENSIONS.

LENGTH L.W.L. 242'-9"  
BREADTH MLD 39'-4"  
DEPTH MLD 18'-6"

ALL BOLD ANGLES SHOWN ARE H.B.S.

SHELL AT BREAK

S.S. CAPITOL.

S. P. AUSTIN & SON, LTD.  
SHIPBUILDERS & REPAIRERS,  
WEAR DOCK YARD,  
SUNDERLAND.  
Date 21 June 1941  
Reference No. 1111

BRIDGE FRONT  
BRIDGE END

BRIDGE DECK

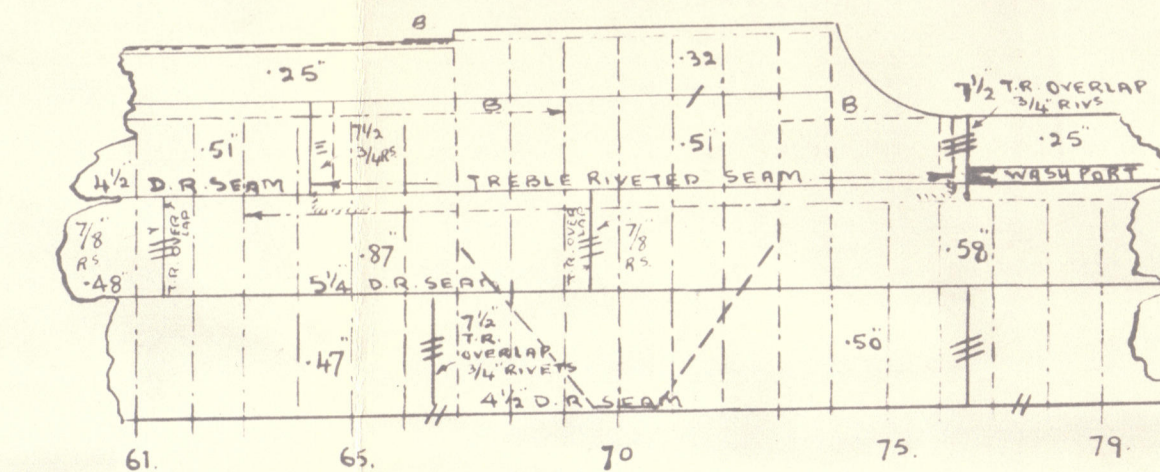

MASTS, WHOLASS, WINCH, STEERING GEAR,  
DECKHOUSES SUPPORTED TO SURVEYORS SATISFACTION.

W.T. B' 10 99

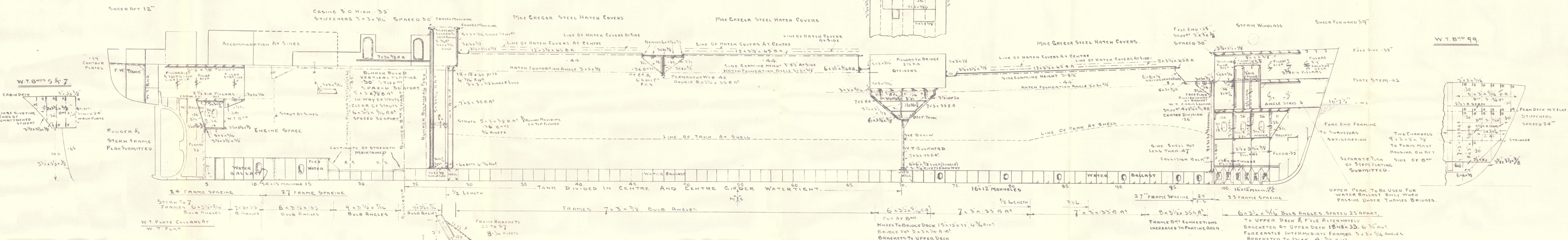

After Peak Flat

W.T. B' 23

RAISED QUARTER DECK

Cabin Deck

Diaphragms

FORECASTLE DECK

W.T. Flat

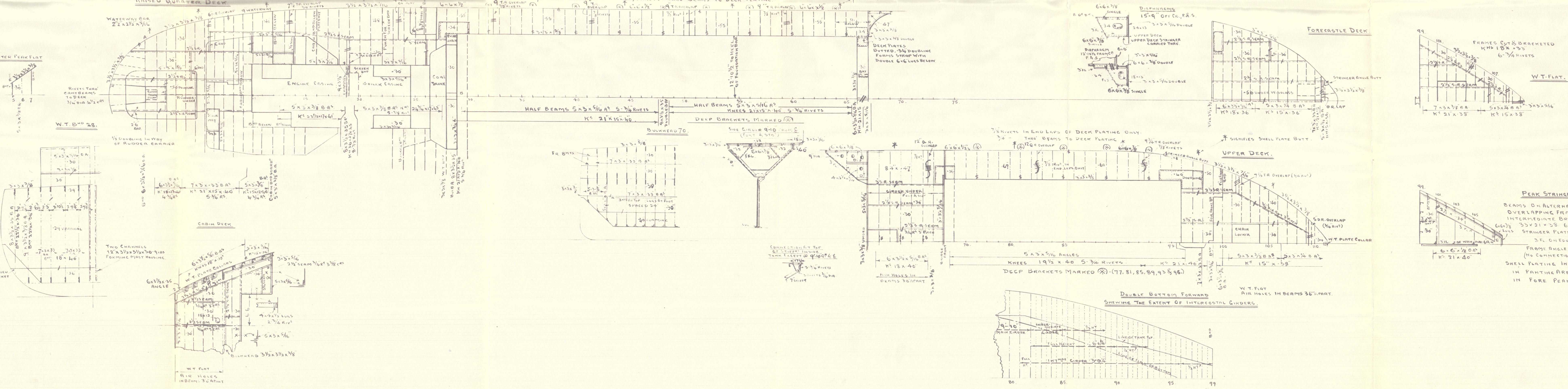

DOUBLE BOTTOM FORWARD  
SHOWING THE EXTENT OF INTERCOSTAL GIRDERS

PEAK STRINGER

BEAMS ON ALTERNATE FRAMES  
OVERLAPPING FRAMES  
INTERMEDIATE BRACKETS  
55x21x38 6 3/4 RIVTS  
STRONGER PLATE 27x34  
2L CHIEFLY  
FRAME ANGLE 3x5x1/2  
(NO CONNECTION TO FRAMES)  
SHELL PLATING INCREASED 05  
IN FORE PEAK



S. P. Austin's 355

s/s. "Capitol"

Profile & Decks.

(as built)

BUNDERLAND RPT. NO. 33126

RETAIN

003191-003199-0115



© 2020

Lloyd's Register  
Foundation