

CARGO STEAMER.

PROFILE AND DECKS.

1:100.

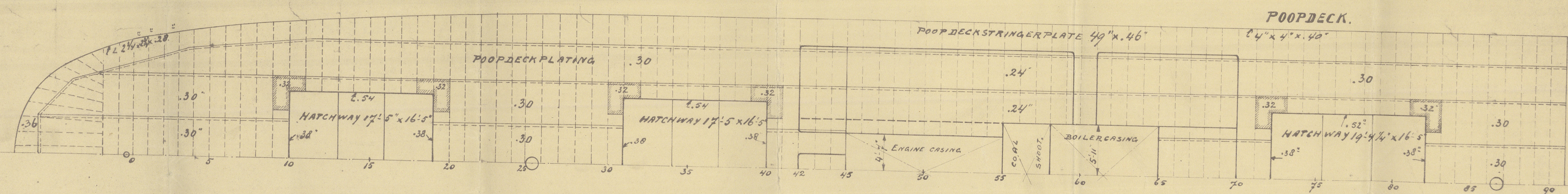

LENGTH OVER P.P.	235' 0."
BREADTH MOULDED.	36' 9."
DEPTH	20' 0."

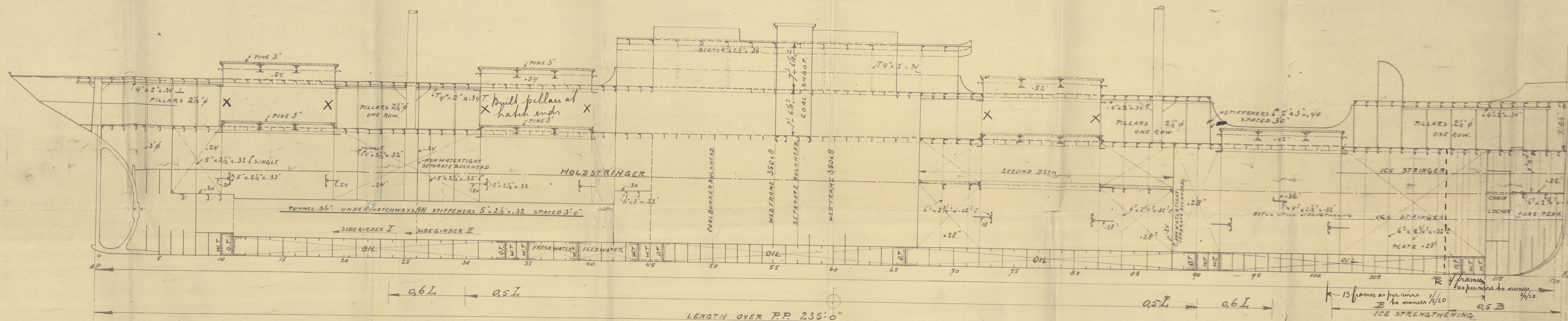

Planting arrangement
to surveyors
satisfaction

} note for ice strengthening
 } as per wire to owners
 3/120 Sm.

Shell 50% over Sloggett's requirements
 untill 15th frame about C. 17
 as per wire to owners
 3/120 Sm.

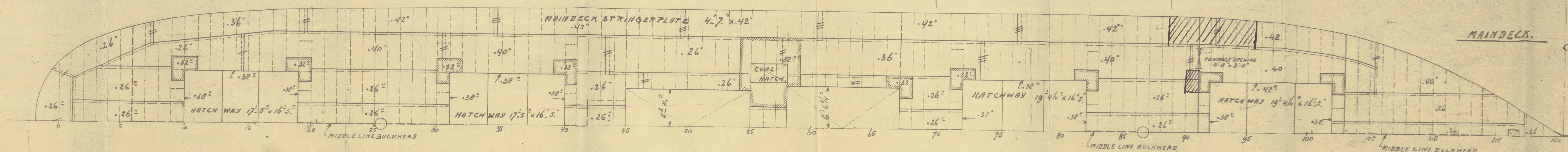

In accordance
with the approved plan
Rotterdam 20-4-20
RW

P. Smith

to No. 316 - 317

Profile - Decks

span copy

corrected.

~~Jan Box 3122~~

"
S. Argo " X

PLANS TRANSFERRED
TO SISTER VESSEL



P. Smith

Lloyd's Register
Foundation

003252-003262-0153