

# S.S. GLENCULLEN.

PROPOSED B'HEAD AT AFTER END OF FOCSLE.

SCALE:  $\frac{1}{2}" = 1 \text{ FT.}$

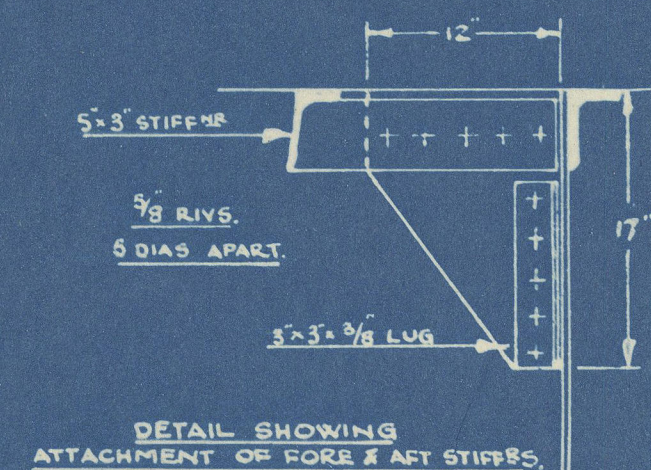
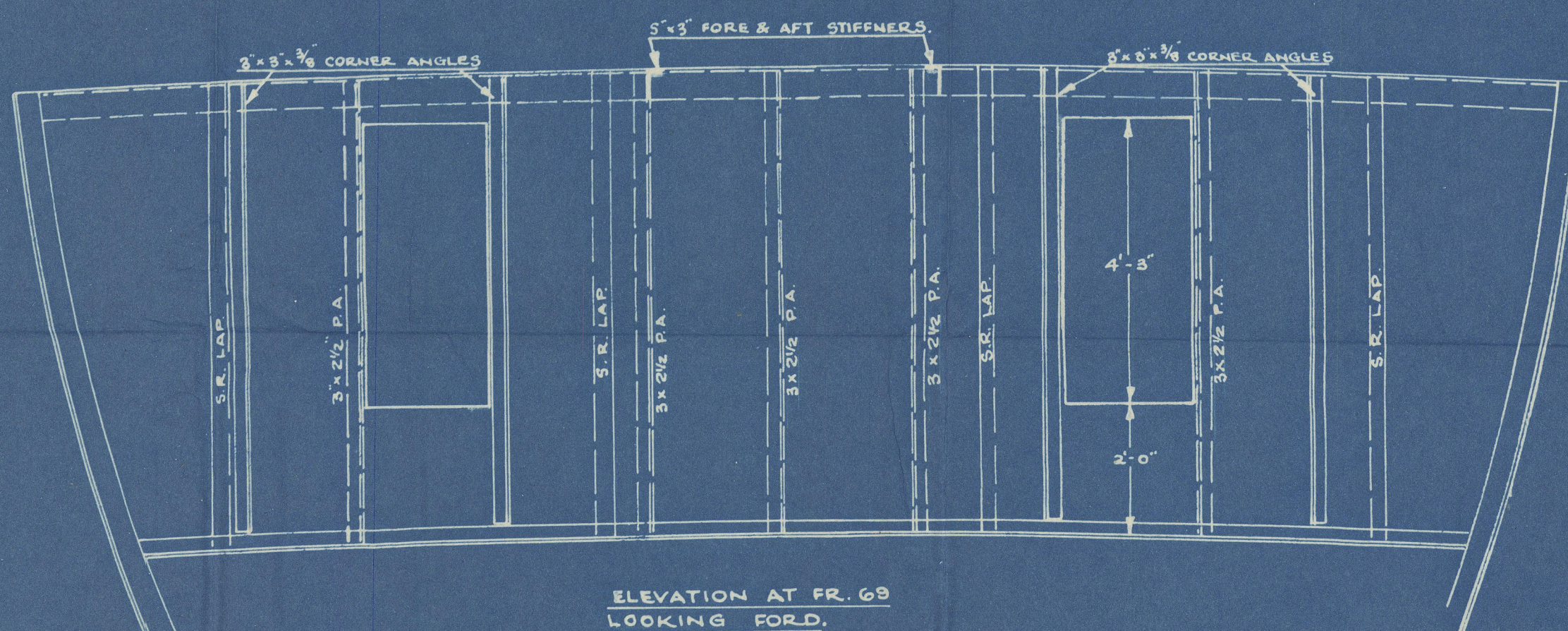
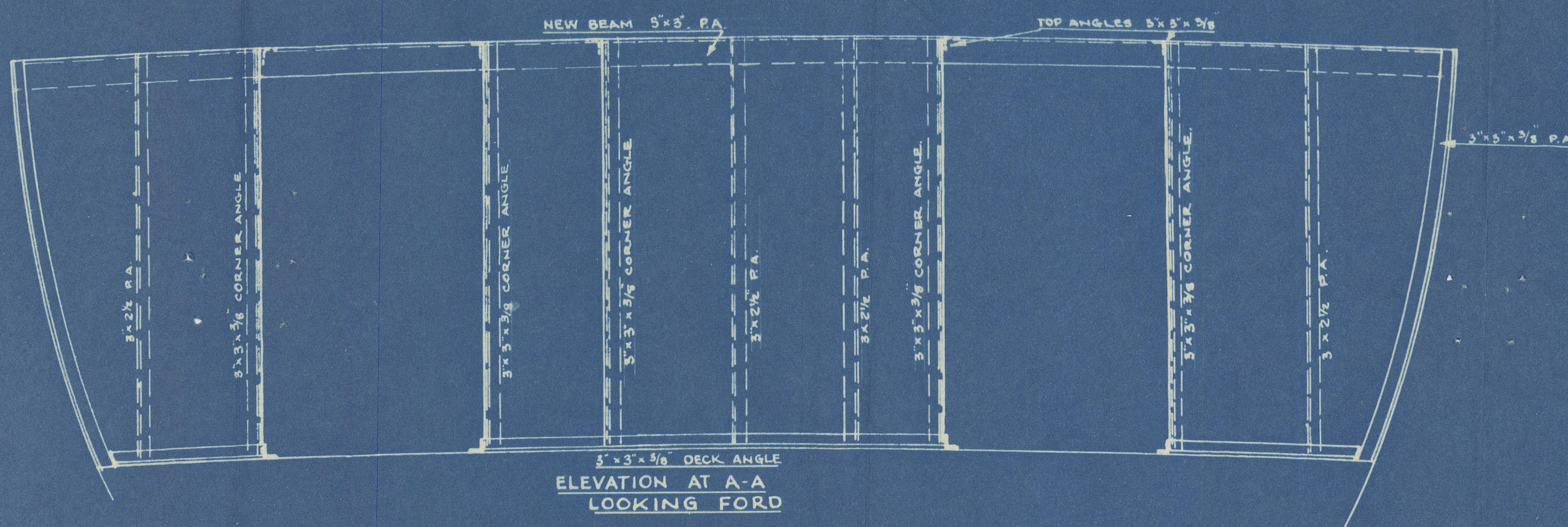

PLATING -  $\frac{5}{16}$ "  
GALLEY PLATING -  $\frac{3}{8}$ "  
KNEES -  $\frac{3}{16}$ "  
STIFFENERS - 3" x 2 1/2" x 26" P.A.  
CORNER ANGLES - 3" x 3" x 3/8" P.A.  
DECK ANGLES - 3" x 3" x 3/8"

RIVETING.  
SEAMS OF PLATING - 5/8" RIVS 4 1/2" DIAS APART.  
STIFFENERS - " " 7" DIAS APART.  
DECK ANGLES - " " 4 1/2" DIAS APART.

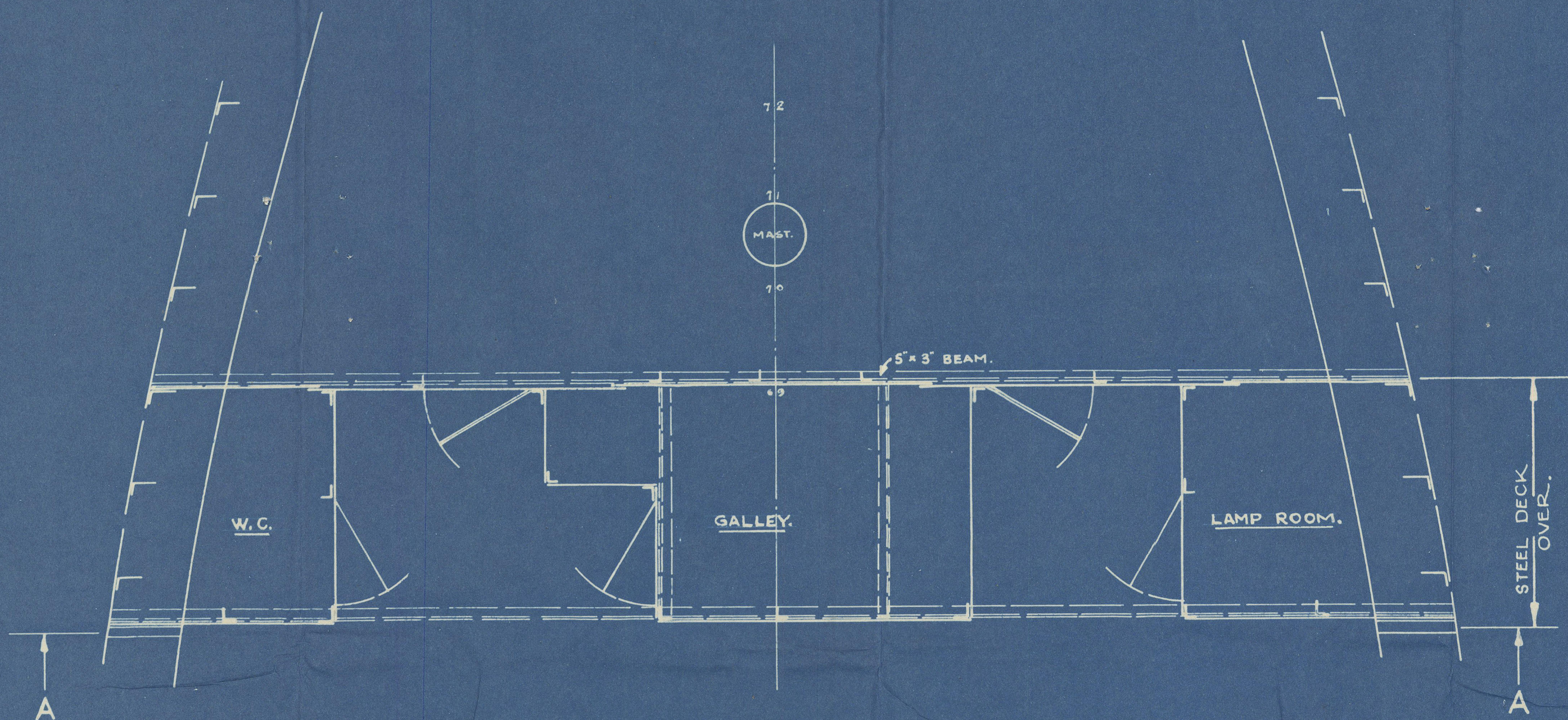

LIFFEY DOCKYARD LTD  
DRAWING NO. 642  
REF. NO. 8  
DATE. 15-10-45



S/S "Glencullen".

Proposed bulkhead at after end  
of focale.

Dub rept No. 6093.



© 2021

Lloyd's Register  
Foundation

003409-003416-0028