

C. 951. Motor cargo ship Longitudinal-plan 1:100

Length for Rule 149,349 m
Breadth 19,202
Depth to Upperdeck 11,945
Speed 16 Kn.

Class: Loyds Reg. 100 A1
Full scantling vessel with 60% superstructures
L.D. 149,349 + 11,945 = 178,4
L.B.D. 149,349 + 11,945 + 11,945 = 173,24
L.D. 149,349 + 11,945 = 173,24
L.D. (B.D. + 11,945) + 11,945 = 173,24
d = 4,30

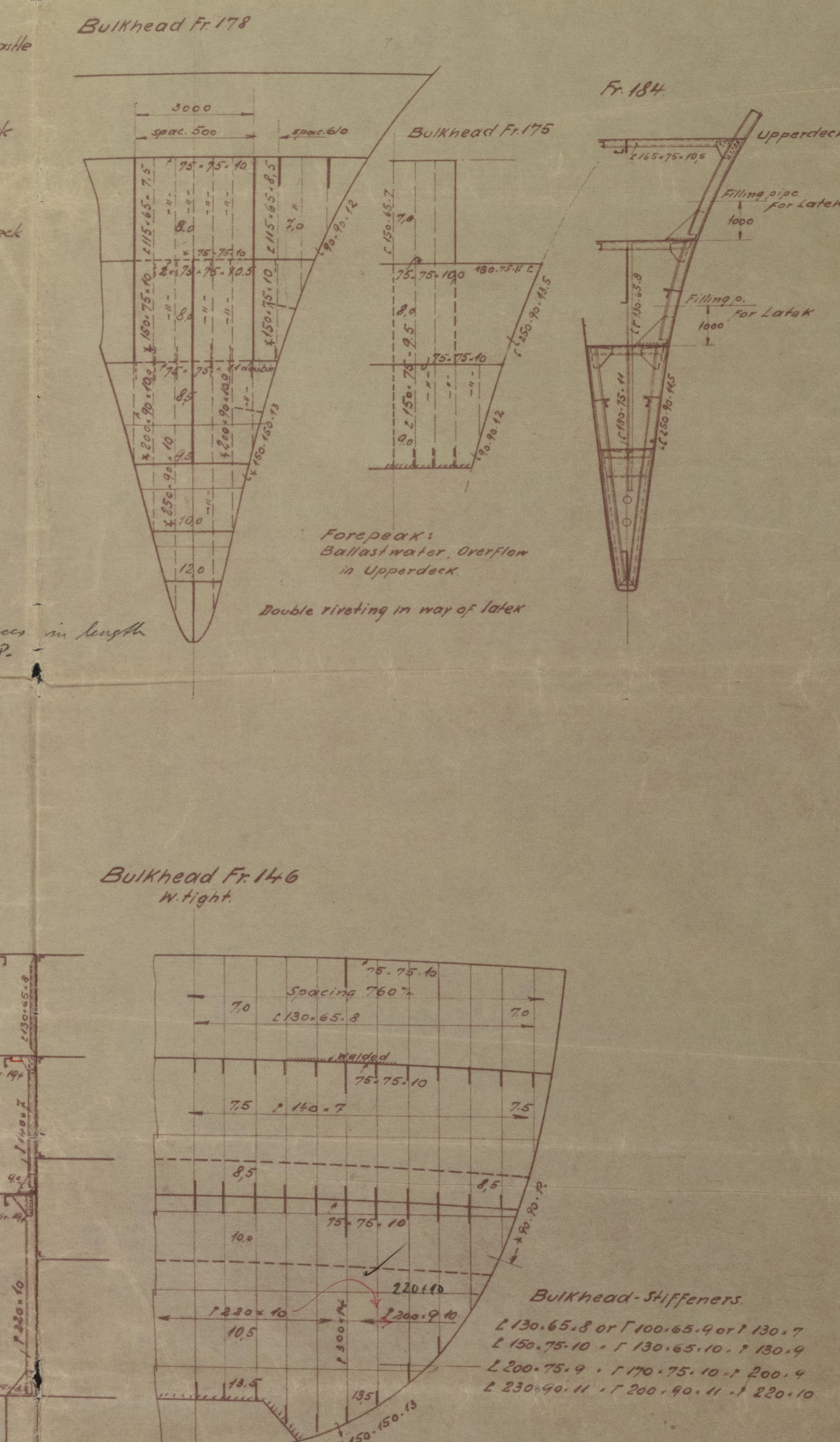
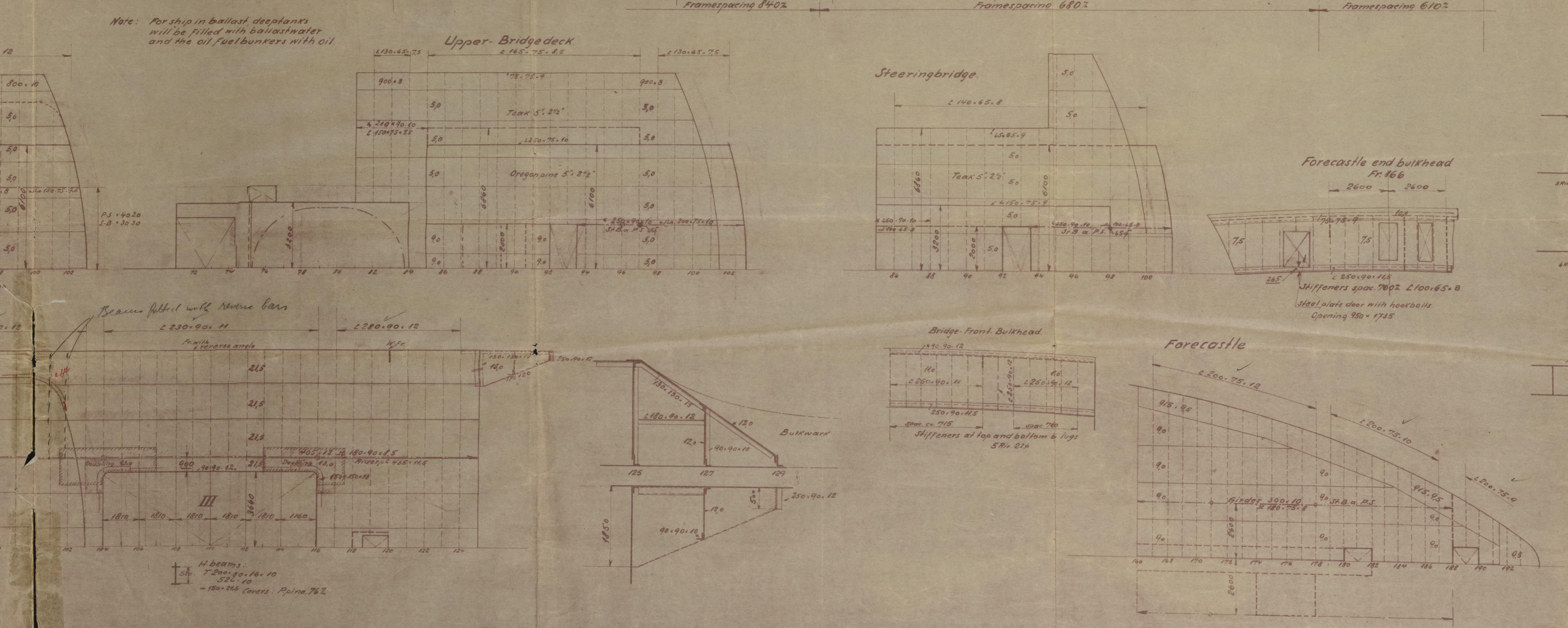
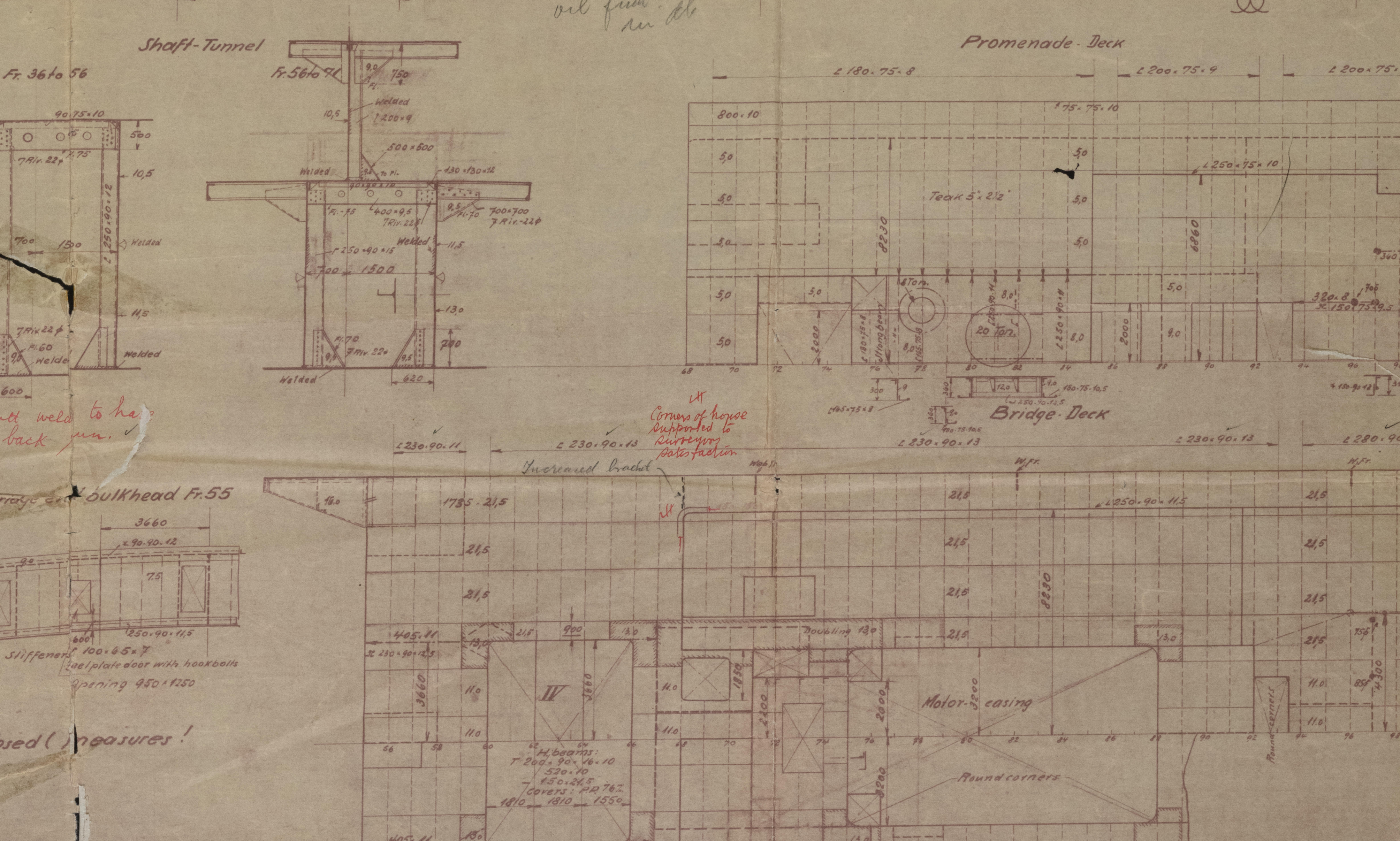
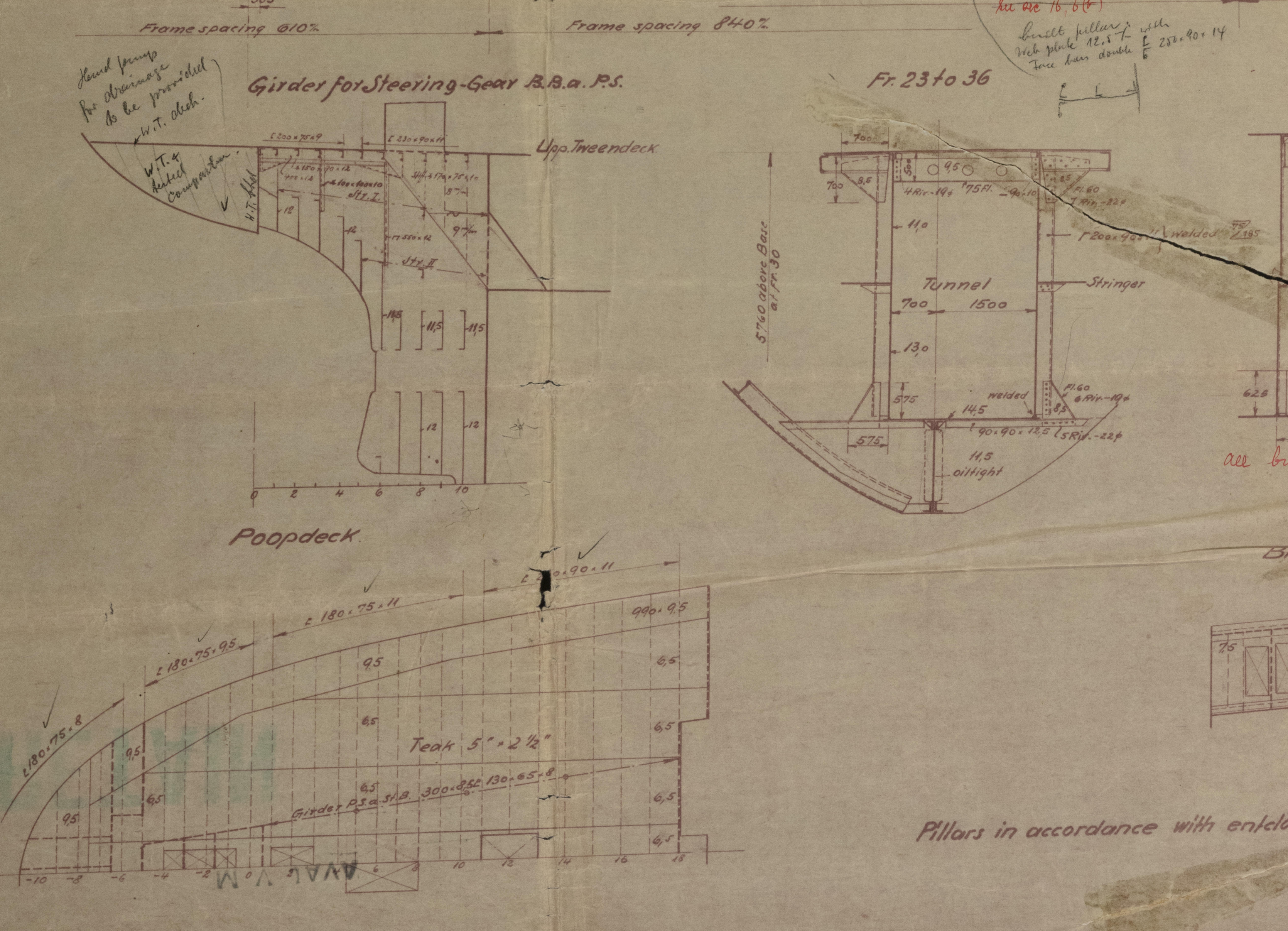


Konstruktionsbüro
für Handelsschiffbau

1000-003532-0001

2)

MESSE: DESCHIMAG WERK A.G. WESER'S YARD N^o 9801

FINAL PLAN OF PROFILE & UPPER DECK

REVISED PLAN N^o 2.

BREMEN LETTER M OF 14. 11. 38.

M V JAVA

RETAIN



© 2020

Lloyd's Register
Foundation

003525-003532-0001