

№ 796 GK.

(AS FITTED)

## TWIN SCREW TUG.

DIMENSIONS 120'-0" B.P. x 27'-0" x 13'-0" M.L.

SCALE  $\frac{1}{4}" = \text{ONE FOOT.}$

[FOR TOWING SERVICES]

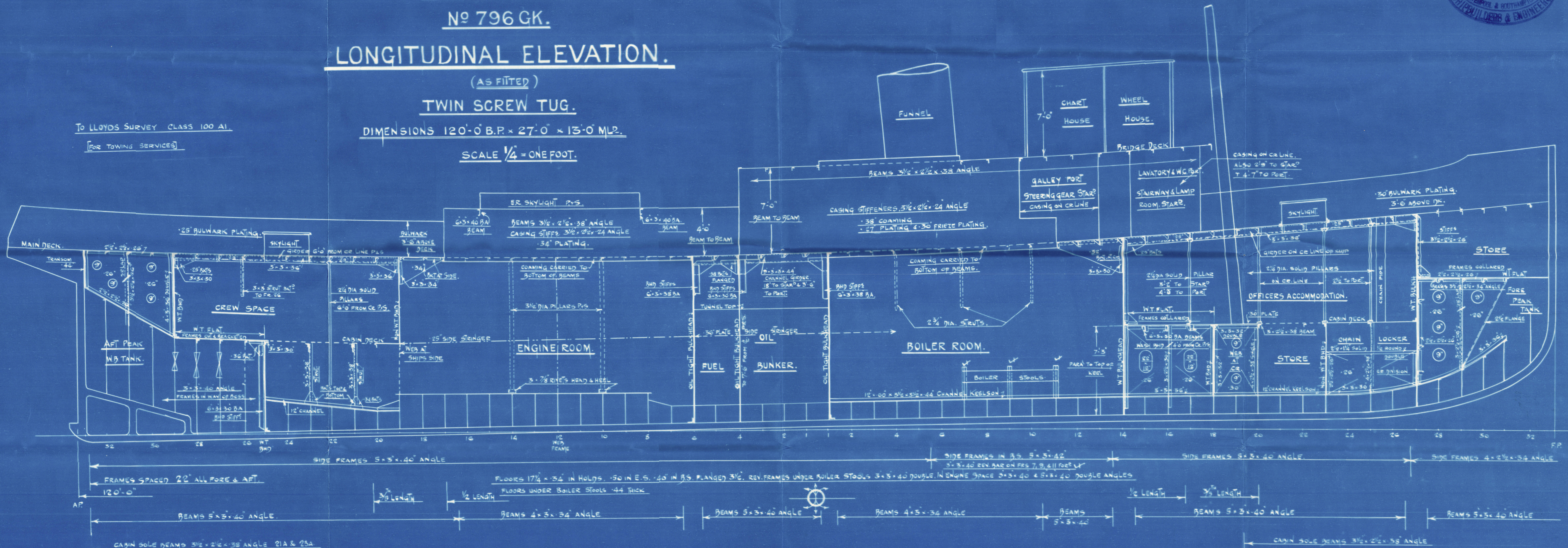



Profile plan of ship as  
built.

Harland & Wolff: No 796.

T. S. T. LAHEJ. \*

Grk rpt. No 18462.



© 2020

Lloyd's Register  
Foundation

003581-003590-0262