

Lloyd's Register of Shipping.

SURVEYS FOR FREEBOARD.

(CONDITIONS OF ASSIGNMENT.)

Ship's Name LOWLANDER (EX "LEME") Port of Survey AVONMOUTH
 Official Number 168281 Surveyor's Signature Ellwood
 Nationality and Port of Registry BRITISH. LONDON. Date of Survey May 4, 5, 6, 8, 11th 1942

Disposition and dimensions of superstructures, trunks, deckhouses and machinery casings to be inserted in the diagrams and tabular statement:—

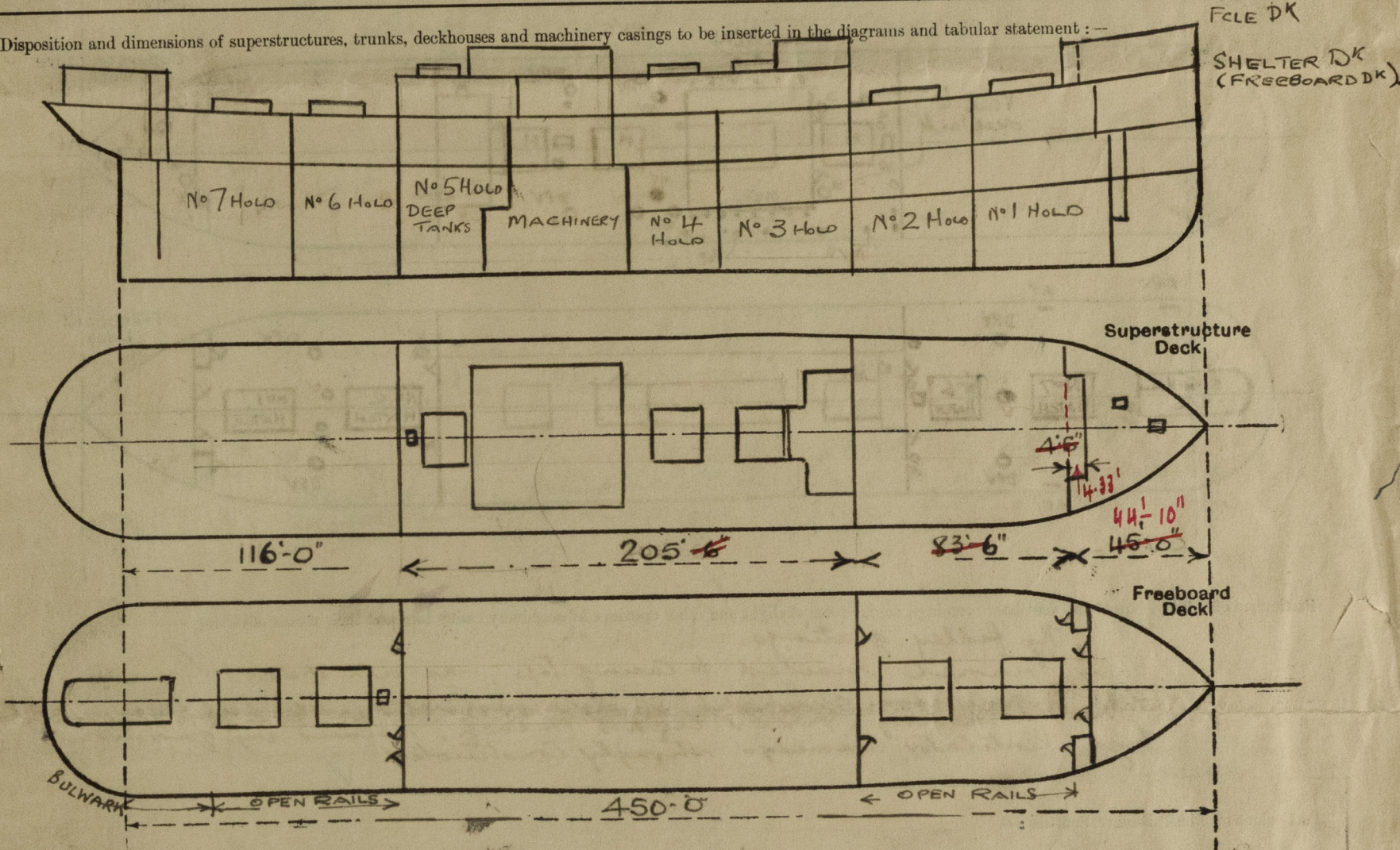

Particulars of Superstructures, Trunks, Casings, Deckhouses.

	Coaming	Plating	Stiffeners	Spacing	End Attachments of Stiffeners	Size of Openings	Height of Sills	Height of Casings
Poop Bulkhead ...	✓	✓	✓	✓	✓	✓	✓	✓
Raised Quarter Deck Bulkhead ...	✓	✓	✓	✓	✓	✓	✓	✓
Bridge, After Bulkhead ...	19' x 40' ✓	✓ 40	3 1/2 x 3 x 4 ANG ✓	30" ✓	none	1 @ 4-10 x 2-3 1/2 2 @ 4-10 x 3-6	19' ✓	9-0 ✓
Bridge, Forward Bulkhead ...	22 x 46 ✓	✓ 42	9 x 3 1/2 x 5 1/4 BA ✓	27" ✓	18" BKTS	2 @ 5-0 x 3-0 2 @ 11-8 x 2-6 2 @ 5-0 x 3-6	22 ✓	9-0 ✓
Forecastle Bulkhead ...	21 x 40 ✓	✓ 32	4 x 3 x 4 1/2 ANG ✓	30" ✓	none	2 @ 5-0 x 3-6	21 ✓	9-0 ✓
Trunk, Aft ...	✓	✓	✓	✓	✓	✓	✓	✓
Trunk, Forward ...	✓	✓	✓	✓	✓	✓	✓	✓
Exposed Machinery Casings on Freeboard or Raised Quarter Decks ...	✓	✓	Protected by Bridge	✓	✓	✓	✓	✓
Exposed Machinery Casings on Superstructure Decks ...	✓	✓	Protected by Deckhouse	✓	✓	✓	✓	✓
Machinery Casings within Superstructures not fitted with Class I Closing Appliances ...	✓	✓	✓	✓	✓	5-0 x 1-10	20"	9-0 ✓
Deckhouses on Flush Deck Ships ...	✓	✓	✓	✓	✓	✓	✓	✓

Particulars of Closing Appliances (state if capable of being manipulated from both sides).

Poop Bulkhead ...	none ✓
Raised Quarter Deck Bulkhead ...	none ✓
Bridge, After Bulkhead ...	1 hinged steel W.T. door manipulated from inside to gallery. ✓ 2 " " W.T. doors " " both sides ✓
Bridge, Forward Bulkhead ...	2 hinged W.T. Steel doors manipulated from both sides ✓ 2 hinged W.T. Steel doors } manipulated from both sides ✓ 2 " steel doors to wing spaces }
Forecastle Bulkhead ...	none ✓
Exposed Machinery Casings on Freeboard or Raised Quarter Decks ...	none ✓
Exposed Machinery Casings on Superstructure Decks ...	none ✓
Machinery Casings within Superstructures not fitted with Class I Closing Appliances ...	hinged steel doors manipulated from Both sides ✓
Deckhouses on Flush Deck Ships ...	✓

PARTICULARS OF PROTECTION TO OPENINGS, ETC.

The following diagrams should be used to indicate the positions of cargo and coaling hatchways, gangways, cargo and coaling ports, ventilators, companionways, etc., which would affect the seaworthiness of the ship:—

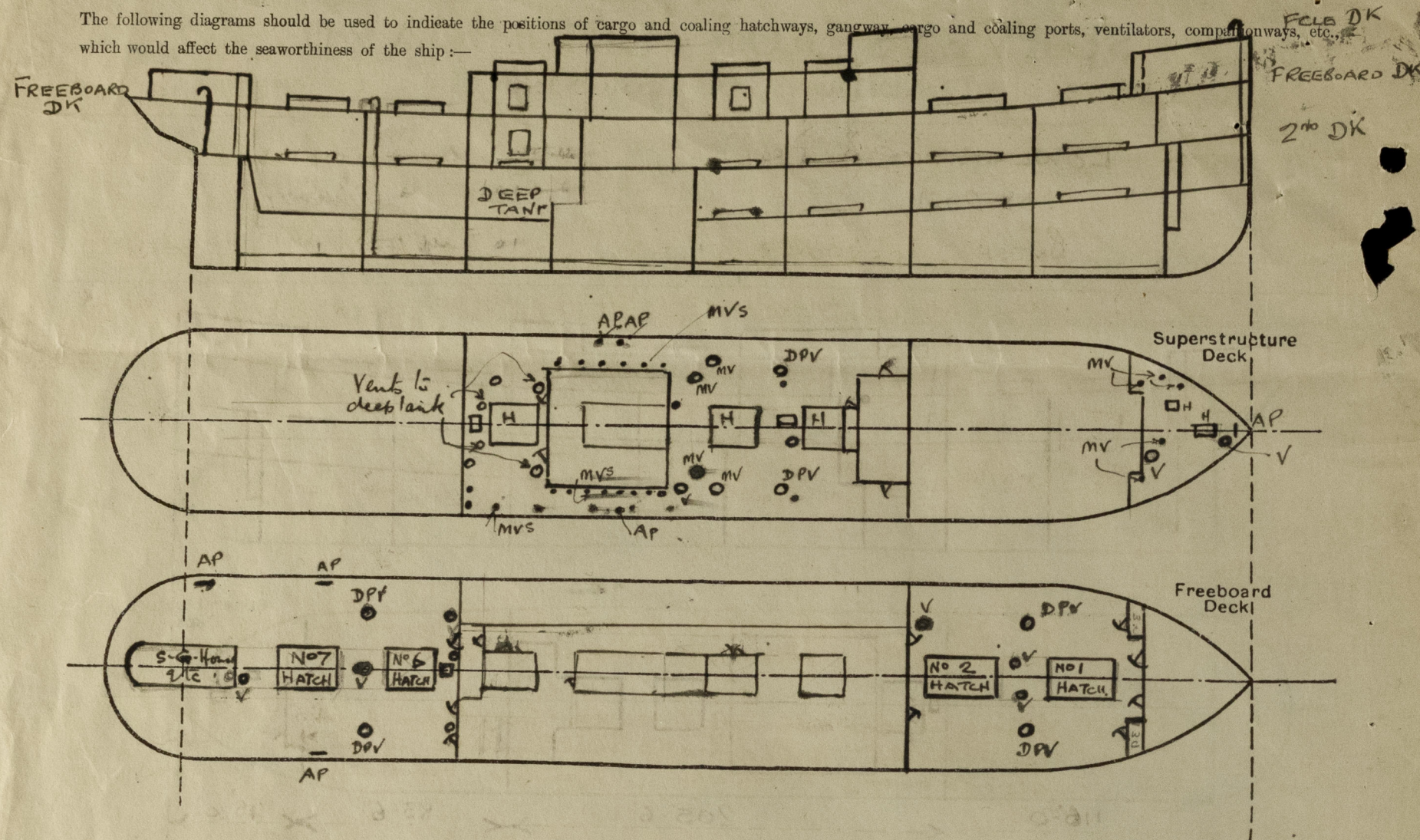

Particulars of fiddle, funnel and ventilator coamings, engine room skylight and other openings in machinery casing tops and their means of closing:—

No fiddle gratings.
Funnel riveted to casing top, no air space. ✓
Steel engine room skylight. Strongly constructed, with steel flaps having 5 fixed lights in each, secured by quadrants. ✓
High Ventilator Coamings strongly constructed. ✓

Particulars of Flush Bunker Scuttles:—

None ✓

Particulars of Companionways:—

Entrances from Bridge deck to bridge space, wood doors manipulated from both sides & having sills 18" above deck

Particulars of Ventilators in exposed positions on freeboard and superstructure decks:—

Bridge Deck Vents:
Ventilators to Hold
2-23" Derrick Post Vents on Bridge Bk ✓
6-23" " " " " " " ✓
5-23" dia Vents on Shelter Bk } 38" Coaming
1-23" " " Bridge Bk } 3'0" high ✓
1-23" " " Fore Bk }
Fore Bk 1-15" dia Vent to fore Peak Space } 38" Coaming 3'0" high ✓
1-6" Vent to accom. } 38" Coaming 12" high
5-7" dia mushroom vents to accommodation. Coamings 8" high with screws down W.T. Covers. ✓
Bridge Deck Vents:
4-20" dia mushroom vents on Bridge Bk } 38" Coaming
27" high to refrigerated chambers. filled with screws down W.T. Covers. ✓
1 ditto on Shelter decks with Coaming 8'0" high. ✓
4-9" Vents to Bridge Deck Accommodation below To Deep Tank } 2-12" Coaming 27" high ✓
1-5" 5/16" Coaming 27" high ✓
2-13" Vents to deep tank } 3/8" Coaming 9'0" high. ✓
20-8" mushroom vents to accommodation below Coamings 8" high fitted with screw down covers. ✓
Wood plugs & Canvas Covers supplied to Cool vents other than D.P. Vents. ✓
Canvas Covers to all mushroom vents. ✓

Particulars of Air Pipes in exposed positions on freeboard, raised quarter, or superstructure decks:—

1-3" air pipe to fore Peak, on fore Bk mouth 10" above deck ✓
1-3 1/2" " " aft Peak in Shelter Bk mouth 2'6" above deck ✓
2-2" " " to F.W. DB. tank. on Shelter Bk aft P.S. mouth 10" above deck ✓
2-4" " " P } to DB. tanks on Bridge Bk with mushroom head. 18" above deck
2-4" " " S } in Chambers.

air pipes supplied with wood plugs & Canvas Covers

Particulars of Gangway Cargo and Coaling Ports:—

None

Particulars of Scuppers and Sanitary Discharge Pipes:—

Sanitary discharges from Fore & Bridge Spaces led over board below Freeboard deck & fitted with strongly constructed storm valves at ship's side. Storm valves fitted about 15" above 2nd Deck. ✓

Particulars of Side Scuttles:—

72 Strongly constructed side Scuttles with hinged deadlights fitted to spaces in Bridge & Fore. ✓
3 Strongly constructed side Scuttles with hinged deadlights fitted below Shelter deck in Engine room stores & work shops. Position of sill as below. ✓

Vertical distance of Sill of lowest Side Scuttle above top of keel

33'-4"

Side Scuttles in Engine room Stores & work shops below Shelter deck

Particulars of Guard Rails:—

Fore back 4'-0" high 3 bars Stanchions spaced approx 4'-0"
Shelter Bk Forward well 4'-0" high 3 bars " " 4'-0"
" " aft of bridge 4'-0" " 3 bars " " 4'-0"
Bridge back 3'-9" high 6 bars " " 4'-0"

Particulars of Gangways, Lifelines, etc.:—

Efficient lifelines from fore front to bridge front and from aft end of bridge to after deck house. ✓

Particulars of Freeing Arrangements.

	Length of Bulwark	Height of Bulwark	Size of Freeing Ports	Number each side	Area each side	Rule area each side
After Well ...						
Forward Well ...						

position of each freeing port ... After Well:—

A. position and height above deck edge) Forward Well:—

State whether the freeing ports are fitted with shutters, bars, or rails, and give particulars of such:—

Additional area where sheer is less than standard.

PARTICULARS OF PROTECTION TO OPENINGS, ETC.

HATCHWAYS ON FREEBOARD AND SUPERSTRUCTURE DECKS.										HATCHWAYS ON SUPERSTRUCTURE DECK		
Description of Hatchway		No 1	2	3	4	5	6	7	3	4	5	
Dimensions of Hatchway		26'x17'	27'6"x17'	20'x17'	20'x17'	20'x17'	27'6"x17'	27'6"x17'	20'x17'	20'x17'	20'x17'	
COAMINGS	Height above Deck	3'-6"	3'-6"	TRUNKED BELOW BRIDGE DECK			3'-6"	3'-6"	3'-6"	3'-6"	3'-6"	
	Thickness	.46	.46				.46	.46	.46	.46	.46	
	Sides	.44	.44				.44	.44	.44	.44	.44	
	Ends	.44	.44				.44	.44	.44	.44	.44	
Stiffeners		9x3 1/2 x 1/2 B.A.	7x2 1/2 x 2 1/2 CHANS.				9x3 1/2 x 1/2 B.A.	7x2 1/2 x 2 1/2 CHANS.	9x3 1/2 x 1/2 B.A.	7x2 1/2 x 2 1/2 CHANS.	9x3 1/2 x 1/2 B.A.	
Brackets, Stays		7x2 1/2 x 2 1/2 CHANS.	7x2 1/2 x 2 1/2 CHANS.				7x2 1/2 x 2 1/2 CHANS.	7x2 1/2 x 2 1/2 CHANS.	7x2 1/2 x 2 1/2 CHANS.	7x2 1/2 x 2 1/2 CHANS.	7x2 1/2 x 2 1/2 CHANS.	
HATCH BEAMS	Number	5	5				5	5	3	3	3	
	Spacing	4'-4"	4'-7"				4'-7"	4'-7"	5'-0"	5'-0"	5'-0"	
	Scantling and Sketch	A = 22 1/2 B = 29 1/2 THK = .46 4 ANGLES 4x3x1/2	ALTERNATE BEAM PLATES EXTENDED				A = 22 1/2 B = 29 1/2 4 ANGLES	A = 22 1/2 B = 29 1/2 4 ANGLES	5'-0" 5'-0" 4x3x1/2	5'-0" 5'-0" 4x3x1/2	5'-0" 5'-0" 4x3x1/2	
	Bearing Surface	4"	4"				4"	4"	4"	4"	4"	
FORE AND AFTERS	Number	N.T. HATCH ON SHELTER DK ABAPT BRIDGE TO COLD STORES			N.T. HATCH ON FOLEY			N.T. HATCH ON FOLEY				
	Spacing	22'x22'x9"			2'3"x1'7"x24"			4'-0"x1'-9"x				
HATCH COVERS	Material	W.W.			W.W.			W.W.				
	Thickness	2 1/2"			2 1/2"			2 1/2"				
HATCH COVERS	How fitted	F+A			F+A			F+A				
	Bearing Surface	4"			4"			4"				
Spacing of Cleats		24"	24"				24"	24"	24"	24"	24"	
Number of Tarpaulins		3	3				3	3	3	3	3	

*Are wood fore and afters steel shod at all bearing surfaces? ☒ Yes

Are battens and wedges efficient and in good condition? ☒ Yes

Are tarpaulins in good condition and in accordance with rule requirements? ☒ Yes

Are lashings provided in accordance with rule requirements? ☒ Yes

W.T. manhole 24"x15" in steering gear house for access to after Peak & having close spaced bolts.

Locking bars fitted to No. 1 Hatchway

Particulars of any special features:—

Bridge deck sheathed with 2 1/2" wood deck 12" waterway. ✓

Endorsement at first survey and at surveys for renewal of Certificate:—

The fittings and appliances are in accordance with the particulars shown on this form (or as now modified) and are in good condition.