

30 JAN 1947

Index No. 36195
(For London Office only).

Lloyd's Register of Shipping.
SURVEYS FOR FREEBOARD.
(CONDITIONS OF ASSIGNMENT.)

Ship's Name NUEVA ANDALUCIA Port of Survey Newport News, Virginia
Official Number 10044 Surveyor's Signature J. H. Buchanan
Nationality and Port of Registry Norwegian - Oslo Date of Survey Whilst rebuilding

Disposition and dimensions of superstructures, trunks, deckhouses and machinery casings to be inserted in the diagrams and tabular statement:—

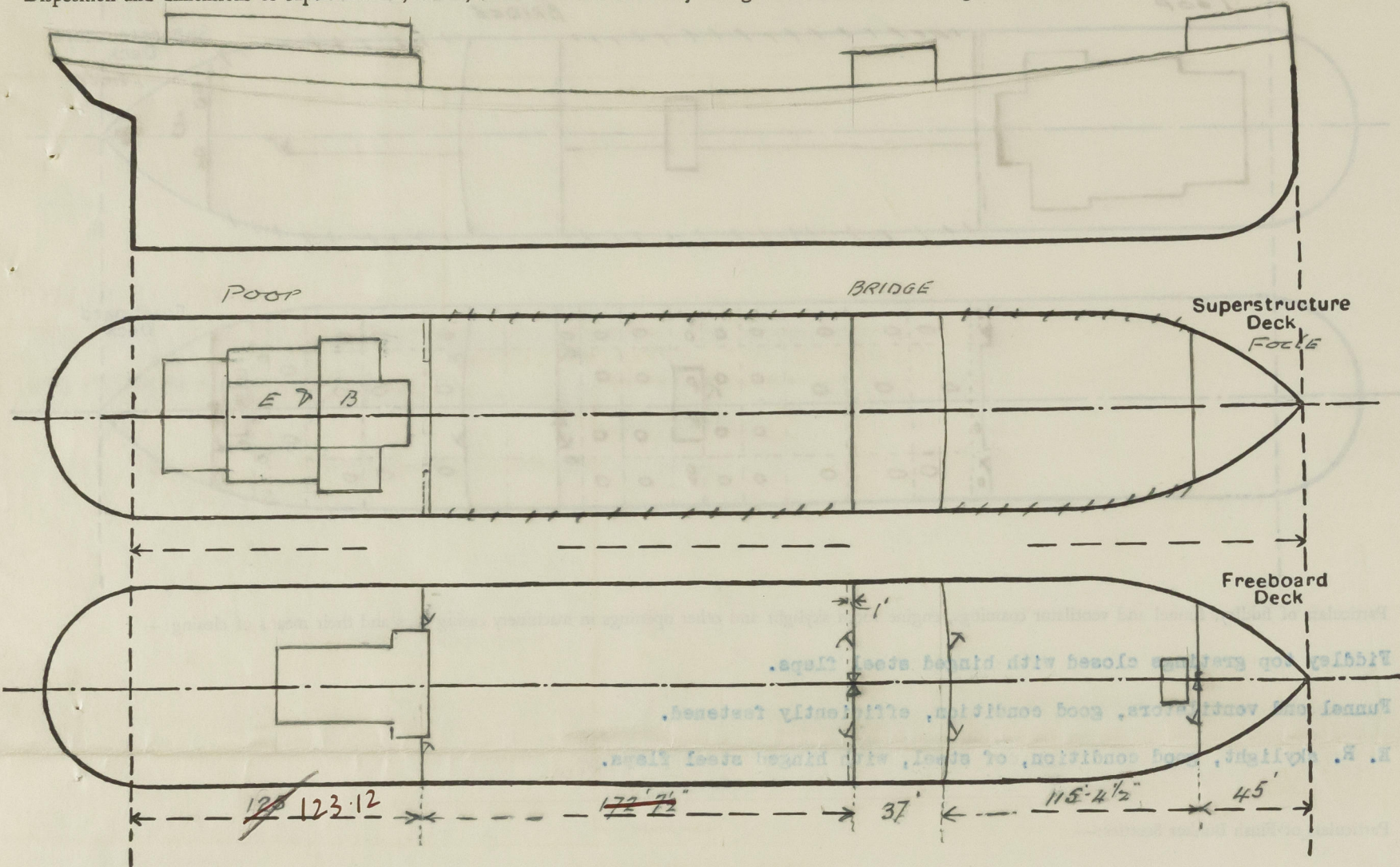

Particulars of Superstructures, Trunks, Casings, Deckhouses.								
	Coaming	Plating	Stiffeners	Spacing	End Attachments of Stiffeners	Size of Openings	Height of Sills	Height of Casings
Poop Bulkhead48	.46	10 x 3 1/2 x .50	32	Brackets top and bottom	1 (p & s) 59 x 27 1/2	18	8.0'
Raised Quarter Deck Bulkhead ...	-	-	-	-	-	-	-	-
Bridge, After Bulkhead32	.32	4 x 3 x .32	29	None	1 (s) 61 x 51 1 (p & s) 67 x 39	18 15	7' 9"
Bridge, Forward Bulkhead44	.44	10 x 3 1/2 x 3 1/2	27	Clips top welded bottom	1 (p & s) 63 x 36	16	7' 9"
Forecastle Bulkhead31	.31	4 x 3 x .31	25 - 28	None	1 (s) 63 x 36 1 (cr) 60 x 48	18	7' 9"
Trunk, Aft ...	-	-	-	-	-	-	-	-
Trunk, Forward ...	-	-	-	-	-	-	-	-
Exposed Machinery Casings on Freeboard or Raised Quarter Decks ...	None	exposed	-	-	-	-	-	-
Exposed Machinery Casings on Superstructure Decks34	.32	5 x 2 1/2 x .32	30	Bracket top extends below	1 (p & s) 59 x 27 1/2	19	8' 0"
Machinery Casings within Superstructures not fitted with Class I Closing Appliances ...	-	-	-	-	-	-	-	-
Deckhouses on Flush Deck Ships ...	-	-	-	-	-	-	-	-
Particulars of Closing Appliances (state if capable of being manipulated from both sides).								
Poop Bulkhead ...	1 (p & s) Hinged steel watertight doors - manipulated from both sides							
Raised Quarter Deck Bulkhead ...	----							
Bridge, After Bulkhead ...	1 (s) Steel plate, hook bolts 15" apart - 1 (p & s) Hinged steel W.T. doors - Manipulated both sides							
Bridge, Forward Bulkhead ...	1 (p & s) Hinged steel W.T. doors - manipulated both sides							
Forecastle Bulkhead ...	1 (cr) Steel plate, hook bolts 15" apart - 1 (s) Hinged steel W.T. door - manipulated both sides							
Exposed Machinery Casings on Freeboard or Raised Quarter Decks ...	----							
Exposed Machinery Casings on Superstructure Decks ...	1 (p & s) Hinged steel W.T. doors - manipulated from both sides							
Machinery Casings within Superstructures not fitted with Class I Closing Appliances ...	----							
Deckhouses on Flush Deck Ships ...	----							

PARTICULARS OF PROTECTION TO OPENINGS, ETC.

The following diagrams should be used to indicate the positions of cargo and coaling hatchways, gangway, cargo and coaling ports, ventilators, companionways, etc., which would affect the seaworthiness of the ship:—

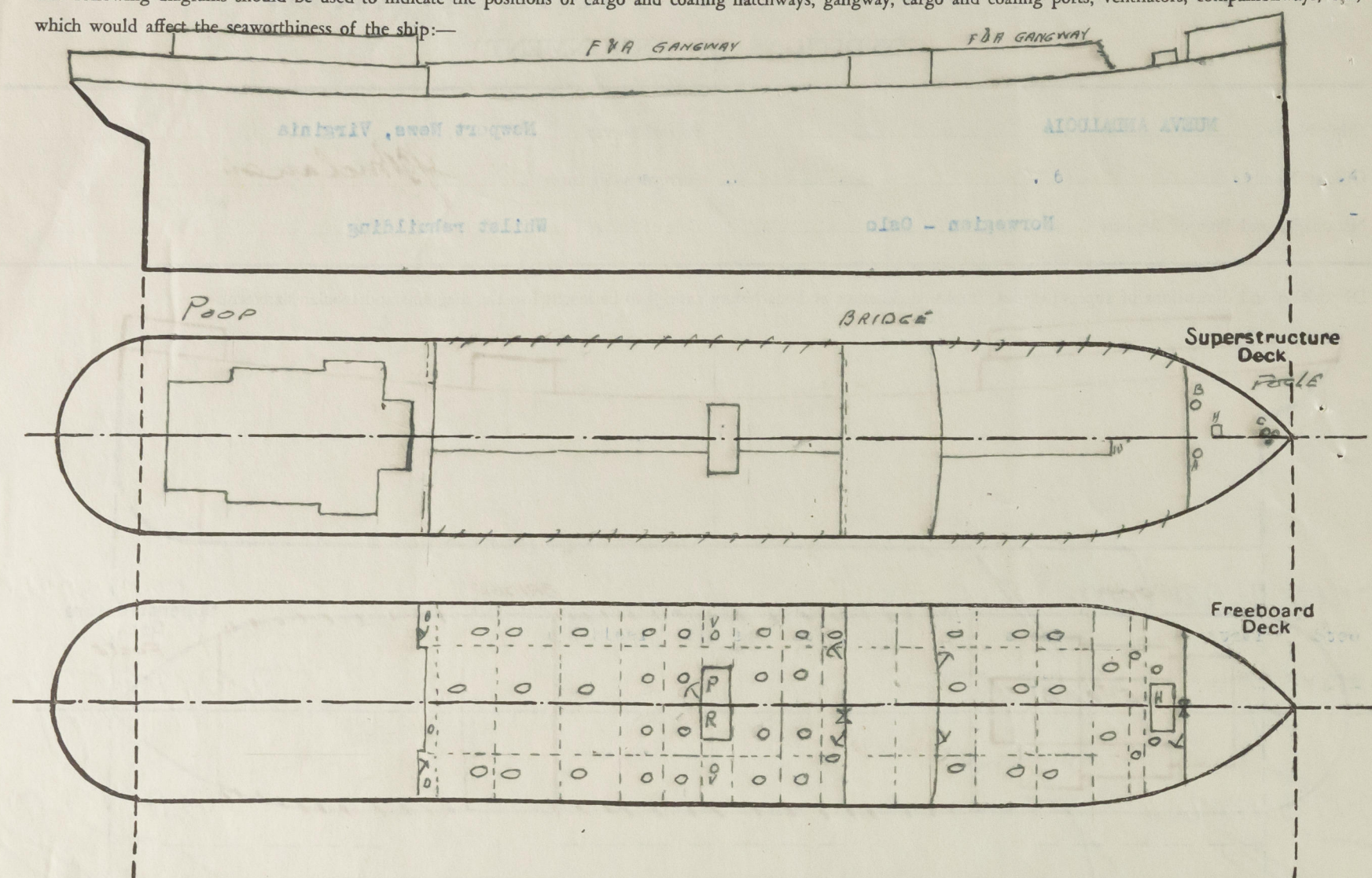

Particulars of fiddle, funnel and ventilator coamings, engine room skylight and other openings in machinery casing tops and their means of closing:—

- Fiddle top gratings closed with hinged steel flaps. ✓
- Funnel and ventilators, good condition, efficiently fastened. ✓
- E. R. skylight, good condition, of steel, with hinged steel flaps. ✓

Particulars of Flush Bunker Scuttles:—

None.

Particulars of Companionways:—

- Pump room casing, of steel efficiently constructed. ✓
- Doorway 60" x 26", sill 18" closed with hinged steel W.T. door, manipulated from both sides. ✓

Particulars of Ventilators in exposed positions on freeboard and superstructure decks:—

- Forecastle Deck - A - 1 cr. 17" dia., .36", 36" high ✓
- B - 1 (p) 18" dia., .38", 38" high ✓
- C - 2 (cr) 11" dia., goose neck to foole and upper peak ✓
- After Well Deck - D - 1 (p & s) to pump room 17" dia., .40, 8 feet high supported to pump room casing ✓
- Poop Deck - Same as originally fitted. ✓
- Ventilators closed with steel caps and canvas covers; goose necks with hinged flaps. ✓

Particulars of Air Pipes in exposed positions on freeboard, raised quarter, or superstructure decks:—

- Foole deck - 1 (cr) 4" dia., 25" high ✓
- Poop deck - same as originally fitted. ✓
- Closed with hinged steel flaps. ✓

Particulars of Gangway Cargo and Coaling Ports:—

None.

Particulars of Scuppers and Sanitary Discharge Pipes:—

- Sanitary discharges fitted with storm valves in way of bridge. ✓
- Discharges at after end, same as originally fitted. ✓

Particulars of Side Scuttles:—

- Good construction, in bridge and forecandle, complete with deadlights. ✓
- Aft - same as originally fitted. ✓

Vertical distance of Sill of lowest Side Scuttle above top of keel 10.700 m. (per Hamburg Report) ✓

Particulars of Guard Rails:—

- Upper deck, forecandle and poop decks - 3 tier rails, 3' 6" high; stanchions 4' 6" apart ✓
- Bridge Deck - steel bulwark 42" high, stays 5' apart ✓

Particulars of Gangways, Lifelines, etc:—

- From poop to bridge and ✓
- from bridge to foremast. ✓

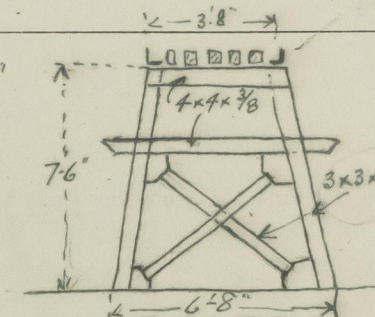

SPACED ABOUT 9'-6" ✓
AND BRACED F & P.

Particulars of Freeing Arrangements.

	Length of Bulwark	Height of Bulwark	Size of Freeing Ports	Number each side	Area each side	Rule area each side
After Well ...	Open rails					
Forward Well ...	Open rails					

State position of each freeing port ... { After Well:—
(F. and A. position and height above deck edge) { Forward Well:—

State whether the freeing ports are fitted with shutters, bars, or rails, and give particulars of such:—

Additional area where sheer is less than standard.

PARTICULARS OF PROTECTION TO OPENINGS, ETC.

HATCHWAYS ON FREEBOARD AND SUPERSTRUCTURE DECKS.										
UPPER DECK										
Description of Hatchway	23 to cargo tanks	16 to cargo tanks	Dry Hold	To Cofferdams	To O.F. tanks	FOCLE To Store	POOP To Store Room	DECK To O.F. Tanks		
Dimensions of Hatchway	66 x 42 oval	43" dia.	9' x 18'	25" dia.	24" x 17	24" x 24"	44 x 41	32 x 24		
COAMINGS	Height above Deck	33	33	31	33	10"	24"	20	24	
	Thickness { Sides			.44			.36	.44	.40	
	Ends	44	.42	.44	.44	.40				
	Stiffeners	-	-	6 x 3 1/2	-	-	.36	.44	.40	
	Brackets, Stays	-	-	Bkts.	-	-	-	-	-	
HATCH BEAMS	Number									
	Spacing									
FORE AND AFTERS	Scantling and Sketch									
	Bearing Surface	-	-	-	-	-	-	-	-	
	Number									
	Spacing									
HATCH COVERS	Material	Steel	Steel	Steel	Steel	Steel	Steel	Steel	Steel	
	Thickness	.50	.50	.36	.40	.36	.36	.32	.40	
	How fitted	Hinged	Hinged	Hinged	Hinged	Hinged	Hinged	Hinged	Hinged	
	Bearing Surface	O.T.	O.T.	W.T.	O.T.	O.T.	W.T.	W.T.	O.T.	
Spacing of Cleats	13	10	Toggles	5	4	4				
Number of Tarpaulins	toggles	toggles	Spaced 17" - 21"	Toggles	toggles	toggles				
*Are wood fore and afters steel shod at all bearing surfaces? Are battens and wedges efficient and in good condition? Are tarpaulins in good condition and in accordance with rule requirements? Are lashings provided in accordance with rule requirements?										

Particulars of any special features:—

This vessel sustained enemy action damage, resulting in the forward half from approximately 10 feet forward of midships being lost.

A new forward half has now been built and joined to existing half.

The arrangement of cargo tanks amidships is now different from original construction, also, per Hamburg C11 Report (No. 36195), the lengths of the Bridge and Forecastle superstructures are less in length.

Particulars of items not rebuilt and marked ~~X~~ have been taken from Hamburg report.

Endorsement at first survey and at surveys for renewal of Certificate:—

The fittings and appliances are in accordance with the particulars shown on this form (or as now modified) and are in good condition.

