

Nº 65-42

JOB Nº J1155

PROFILE & STEEL DECK'S

SCALE $\frac{1}{8}'' = 1$ FOOT

DIMENSIONS 200'-0" BP x 33'-0" MLD x 13'-6"

CLASS LLOYD'S 100A1 CARRYING PETROLEUM IN BULK

LONGITUDINAL FRAMING IN CENTRE TANKS AT BOTTOM & DECK

WINDLASS, WINCH, STEERING GEAR AND DECKHOUSES
SUPPORTED TO SURVEYORS SATISFACTION

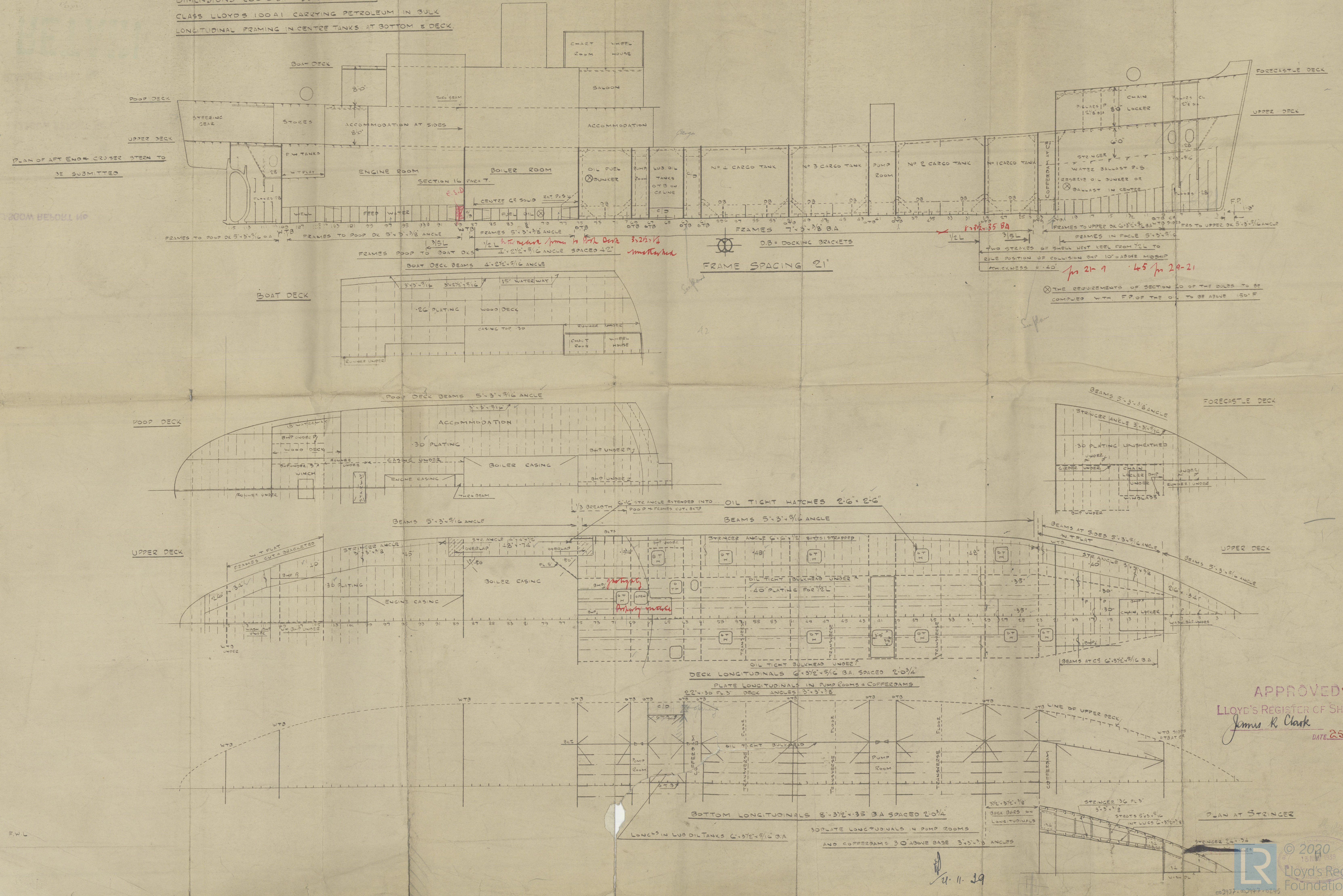

APPROVED For No. 42.
LLOYD'S REGISTER OF SHIPPING
James R. Clark
DATE 25/1/41.

003937-003947-0245



© 2020

Lloyd's Register
Foundation

(2)

Blythwood S.B. & Co. Co.

No. 65 - T. 1155

72.

Profile & Steel Shs.

GLASGOW REPORT No 61875

46d

GLASGOW REPORT No 63167

65 Nasprite

GLASGOW REPORT No

63500



46d 72 Airsprite

GLASGOW REPORT No

66271

72 Airsprite

GLASGOW REPORT No

66613

RETAIN

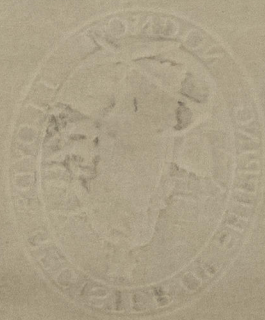

003937.003947-0245



© 2020

Lloyd's Register
Foundation