

Lloyd's Register of Shipping.

SURVEYS FOR FREEBOARD.

Computation of Freeboard for Steamer, Sailing Ship, Tanker
having Prop. Bridge Newcastle

Port of Survey Newcastle-on-Tyne

Date of Survey 2nd May /32

Name of Surveyor John. A. Lawson

Particulars of Classification +100.A.1.
Rated for oil fuel 10.21 G.

Ship's Name KYRIAKOULA (Type of Superstructures.)

Ship's Name EX ZELO Nationality and Port of Registry Greek Newcastle Panama Official Number 145457 Gross Tonnage 2294 Date of Build 1921-10

Moulded Dimensions: Length 307.16 Breadth 42.75 Depth 22.0
Moulded displacement at moulded draught = 85 per cent. of moulded depth 5120 tons
Coefficient of fineness for use with Tables .730

Depth for Freeboard (D)		Depth correction		Round of Beam correction	
Moulded depth	22.00	(a) Where D is greater than Table depth (D-Table depth) R = (22.05 - 20.48) 2.362 = +3.71		Moulded Breadth (B)	42.75
Stringer plate	.05	(b) Where D is less than Table depth (if allowed) (Table depth-D) R =		Standard Round of Beam = $\frac{B \times 12}{50}$	10.26
Sheathing on exposed deck $T \left(\frac{L-S}{L} \right) =$		If restricted by superstructures		Ship's Round of Beam	$\frac{10.26}{24}$
Depth for Freeboard (D) =	22.05			Difference	.24
				Restricted to	
				Correction = $\frac{\text{Diff}^2}{4} \times \left(1 - \frac{S_1}{L} \right)$	$\frac{.24^2}{4} \times \left(1 - \frac{.6142}{4} \right) = -.04$

DEDUCTION FOR SUPERSTRUCTURES.

	Mean Covered Length (S)	Equivalent Enclosed Length (S ₁)	Height	Height Correction	Effective Length (E)
Poop enclosed ...	25.0	25.00	7.5		25.00
" overhang ...					
R.Q.D. enclosed ...					
" overhang ...					
Bridge enclosed...	62.0	62.00	7.5		62.00
" overhang aft ...	2.66	1.50			1.50
" overhang forward	2.1	1.00			1.00
Deck enclosed ...	29.0	29.0	7.5		29.00
" overhang ...					
Trunk aft ...					
" forward ...					
Tonnage opening aft ...					
" forward ...					
Total ...	120.00	118.50			118.50

Standard Height of Superstructure 6.572

" " R.Q.D. ✓

Deduction for complete superstructure 35.81

Percentage covered $\frac{S}{L} = \frac{39.07}{20} = 39.07\%$

" " $\frac{S_1}{L} = \frac{38.58}{20} = 38.58\%$

" " $\frac{E}{L} = \frac{38.58}{20} = 38.58\%$

Percentage from Table, Line A. ✓

(corrected for absence of forecastle (if required)) 26.29%

Percentage from Table, Line B. ✓

(corrected for absence of forecastle (if required)) ✓

Interpolation for bridge less than 2L (if required) ✓

Deduction = $35.81 \times .2629 = -9.41$

SHEER CORRECTION.

Station	Standard Ordinate	S	M	Product	Actual Ordinate	Effective Ordinate	S	M	Product	Mean actual sheer aft = Excess	Mean standard sheer aft
A.P. ...	40.72	1		40.72	45	45.00	1		45.00		
1/2 L from A.P. ...	18.12	4		72.48	19.2	19.55	4		78.20	Mean actual sheer forward = Excess	Mean standard sheer forward
2/3 L " ...	4.48	2		8.96	5	4.89	2		9.78		
Amidships ...	✓	4		✓	-	✓	4		✓	Length of enclosed superstructure forward of amidships = .096	
2/3 L from F.P. ...	8.96	2		17.92	9.4	9.77	2		19.54	" " aft of " = .106	
1/2 L " ...	36.23	4		144.92	39	39.10	4		156.40		
F.P. ...	81.43	1		81.43	90	90.00	1		90.00		
Total ...				366.43					398.92		

Correction = $\frac{\text{Difference between sums of products}}{18} \left(\frac{.75 - S}{2L} \right) = \frac{32.49}{18} \times \left(\frac{.75 - .1953}{2} \right) = -1.00$

If limited on account of midship superstructure, $-1.00 \times \frac{.196}{.200} = -.98$

If limited to maximum allowance of 1 1/2 ins. per 100 ft. ✓

Deduction for Tropical Freeboard. Addition for Winter and Winter North Atlantic Freeboard. Ft. Depth to Freeboard Deck = 22.05 Summer freeboard = 3.35 Moulded draught (d) = 18.70 Reduction for Tropical freeboard and addition for Winter freeboard = $\frac{d}{4}$ inches = 4.67 = 4 3/4 Addition for Winter North Atlantic Freeboard (if required) = 2"	Deduction for Fresh Water. Displacement in salt water at summer load water line $\Delta = 5146$ Tons per inch immersion at summer load water line T = 25.73 Deduction = $\frac{\Delta}{40T}$ inches = 5.00 = 5"	TABULAR FREEBOARD corrected for Flush Deck (if required) Correction for coefficient $\frac{.730 + .68}{1.36} = \frac{1.410}{1.36}$ Depth Correction ... 3.71 ✓ Deduction for superstructures ... 9.41 ✓ Sheer correction98 ✓ Round of Beam correction04 ✓ Correction for Thickness of Deck amidships ... ✓ Other corrections, scantlings, etc. ... ✓ 3.71 10.43 - 6.72 Summer Freeboard = 40.13
--	--	---

SUMMER FREEBOARD amidships from Centre of Disc to top of Deck Line, Wood, Steel, Deck :-

Tropical Fresh Water Line above Centre of Disc ...		Tropical Fresh Water Freeboard ...	
Fresh Water Line " " ...		Fresh Water " " ...	
Tropical Line " " ...		Tropical " " ...	
Winter Line below " " ... 4 3/4		Winter " " ... 3' - 9"	
Winter North Atlantic Line " " ... 6 3/4		Winter North Atlantic " " ... 3' - 11"	

PARTICULARS OF PROTECTION TO OPENINGS, ETC.

HATCHWAYS ON FREEBOARD AND SUPERSTRUCTURE DECKS										
Description of Hatchway	1	2	3	4	5	6	7	8	9	10
Dimensions of Hatchway	32'-0" x 24'-0"	34'-0" x 26'-0"	6'-0" x 26'-0"	38'-0" x 26'-0"	38'-0" x 25'-0"	1'-11" x 1'-11"	1'-11" x 1'-11"	2'-11" x 2'-11"	4'-0" x 3'-7"	8'-0" x 2'-2"
COAMINGS										
Height above Deck	42"	42"	42"	42"	42"	15"	15"	15"	15"	15"
Thickness	5/8"	5/8"	5/8"	5/8"	5/8"	3/8"	3/8"	3/8"	3/8"	3/8"
Stiffeners	2"	3"	3"	3"	3"	1"	1"	1"	1"	1"
Brackets, Stays	2"	3"	3"	3"	3"	1"	1"	1"	1"	1"
HATCH BEAMS										
Number	3	3	3	3	3	1	1	1	1	1
Spacing	8'-1"	7'-11"	10'-1"	10'-0"	10'-0"	10'-0"	10'-0"	10'-0"	10'-0"	10'-0"
Scantling and Sketch	5" x 3 1/2" x 46"	5" x 3 1/2" x 46"	5" x 3 1/2" x 46"	5" x 3 1/2" x 46"	5" x 3 1/2" x 46"	5" x 3 1/2" x 46"	5" x 3 1/2" x 46"	5" x 3 1/2" x 46"	5" x 3 1/2" x 46"	5" x 3 1/2" x 46"
Bearing Surface	3 1/2"	3 1/2"	3 1/2"	3 1/2"	3 1/2"	3 1/2"	3 1/2"	3 1/2"	3 1/2"	3 1/2"
FORE AND AFTERS										
Number	1 CRE 4 SIDE	1 CRE 4 SIDE	1 CRE 4 SIDE	1 CRE 4 SIDE	1 CRE 4 SIDE	1 CRE 4 SIDE	1 CRE 4 SIDE	1 CRE 4 SIDE	1 CRE 4 SIDE	1 CRE 4 SIDE
Spacing	7'-3"	7'-1"	5'-5"	5'-2"	5'-2"	5'-2"	5'-2"	5'-2"	5'-2"	5'-2"
Unsupported Lengths	12'-0"	12'-0"	12'-0"	12'-0"	12'-0"	12'-0"	12'-0"	12'-0"	12'-0"	12'-0"
Scantling and Sketch	12" x 50 PL	12" x 50 PL	12" x 50 PL	12" x 50 PL	12" x 50 PL	12" x 50 PL	12" x 50 PL	12" x 50 PL	12" x 50 PL	12" x 50 PL
Bearing Surface	3 x 3 x 40 Ls	3 x 3 x 40 Ls	3 x 3 x 40 Ls	3 x 3 x 40 Ls	3 x 3 x 40 Ls	3 x 3 x 40 Ls	3 x 3 x 40 Ls	3 x 3 x 40 Ls	3 x 3 x 40 Ls	3 x 3 x 40 Ls
HATCH COVERS										
Material	W.P.	W.P.	W.P.	W.P.	W.P.	W.P.	W.P.	W.P.	W.P.	W.P.
Thickness	3"	3"	3"	3"	3"	3"	3"	3"	3"	3"
How fitted	ATH	ATH	ATH	ATH	ATH	ATH	ATH	ATH	ATH	ATH
Bearing Surface	3 1/2"	3 1/2"	3 1/2"	3 1/2"	3 1/2"	3 1/2"	3 1/2"	3 1/2"	3 1/2"	3 1/2"
Spacing of Cleats	24"	24"	24"	24"	24"	24"	24"	24"	24"	24"
Number of Tarpaulins	2	2	2	2	2	2	2	2	2	2

Particulars of fiddle, funnel and ventilator coamings:— Fiddle, gratings covered by strong steel hinges covers. Funnel fiddle vents in efficient condition. Engine skylight of steel strongly constructed.

Particulars of Flush Bunker Scuttles:— none.

Particulars of Companionways:— One to crew space aft on poop deck. 5'-0" long x 3'-3 1/2" wide x 5'-4" high. Door 2'-10" wide x 3'-4" in height. Leak door 2' x 8 1/2" sill above wood deck.

Particulars of Ventilators in exposed positions on freeboard and superstructure decks:— Fore 5' 1 vent, 12" dia. Coaming 86" x 32" to hold. 1 vent, 12" dia. Coaming 86" x 32" to hold. 1 vent, 12" dia. Coaming 86" x 32" to hold. 1 vent, 12" dia. Coaming 86" x 32" to hold. 1 vent, 12" dia. Coaming 86" x 32" to hold. 1 vent, 12" dia. Coaming 86" x 32" to hold. 1 vent, 12" dia. Coaming 86" x 32" to hold. 1 vent, 12" dia. Coaming 86" x 32" to hold. 1 vent, 12" dia. Coaming 86" x 32" to hold. 1 vent, 12" dia. Coaming 86" x 32" to hold.

Particulars of Air Pipes in exposed positions on freeboard, raised quarter, or superstructure decks:— Fore 5' 1 m. air pipe, 3" dia. 12' to top. 1 m. air pipe, 3" dia. 12' to top. 1 m. air pipe, 3" dia. 12' to top. 1 m. air pipe, 3" dia. 12' to top. 1 m. air pipe, 3" dia. 12' to top. 1 m. air pipe, 3" dia. 12' to top. 1 m. air pipe, 3" dia. 12' to top. 1 m. air pipe, 3" dia. 12' to top. 1 m. air pipe, 3" dia. 12' to top. 1 m. air pipe, 3" dia. 12' to top.

Particulars of Gangway Cargo and Coaling:— none.

Particulars of Scuppers and Sanitary Discharge Pipes:— Lavatory discharge under foreboom deck aft have storm valves on ship's side above.

Particulars of Side Scuttles:— Side scuttles to crew space have hinges deadlocks fitted of strong construction. All side scuttles of substantial construction.

Particulars of Guard Rails:— Fore 5' 2 tier, 3'-3" high, stanchions about 4'-0" apart. Poop 2 tier, 3'-2" high, stanchions about 4'-0" apart.

Particulars of Gangways, Lifelines, etc.:— none provided.

Lifelines provided in after well.

Particulars of Freeing Arrangements.						
	Length of Bulwark	Height of Bulwark	Size of Freeing Ports	Number each side	Area each side	Rule area each side
After Well	94'-16"	4'-0"	3'-0" x 1'-6"	5	22.02	18.8
Forward Well	93'-0"	4'-0"	2'-10" x 1'-6"	5	20.77	18.6

State position of each freeing port:— After Well: 12' 5'-0" x 2' 25'-0" x 3' 42'-9" x 4' 60'-4" x 5' 74'-0" x 6' 104'-0" x 7' 138'-0" x 8' 172'-0" x 9' 206'-0" x 10' 240'-0" x 11' 274'-0" x 12' 308'-0" x 13' 342'-0" x 14' 376'-0" x 15' 410'-0" x 16' 444'-0" x 17' 478'-0" x 18' 512'-0" x 19' 546'-0" x 20' 580'-0" x 21' 614'-0" x 22' 648'-0" x 23' 682'-0" x 24' 716'-0" x 25' 750'-0" x 26' 784'-0" x 27' 818'-0" x 28' 852'-0" x 29' 886'-0" x 30' 920'-0" x 31' 954'-0" x 32' 988'-0" x 33' 1022'-0" x 34' 1056'-0" x 35' 1090'-0" x 36' 1124'-0" x 37' 1158'-0" x 38' 1192'-0" x 39' 1226'-0" x 40' 1260'-0" x 41' 1294'-0" x 42' 1328'-0" x 43' 1362'-0" x 44' 1396'-0" x 45' 1430'-0" x 46' 1464'-0" x 47' 1498'-0" x 48' 1532'-0" x 49' 1566'-0" x 50' 1590'-0" x 51' 1624'-0" x 52' 1658'-0" x 53' 1692'-0" x 54' 1726'-0" x 55' 1760'-0" x 56' 1794'-0" x 57' 1828'-0" x 58' 1862'-0" x 59' 1896'-0" x 60' 1930'-0" x 61' 1964'-0" x 62' 1998'-0" x 63' 2032'-0" x 64' 2066'-0" x 65' 2090'-0" x 66' 2124'-0" x 67' 2158'-0" x 68' 2192'-0" x 69' 2226'-0" x 70' 2260'-0" x 71' 2294'-0" x 72' 2328'-0" x 73' 2362'-0" x 74' 2396'-0" x 75' 2430'-0" x 76' 2464'-0" x 77' 2498'-0" x 78' 2532'-0" x 79' 2566'-0" x 80' 2590'-0" x 81' 2624'-0" x 82' 2658'-0" x 83' 2692'-0" x 84' 2726'-0" x 85' 2760'-0" x 86' 2794'-0" x 87' 2828'-0" x 88' 2862'-0" x 89' 2896'-0" x 90' 2930'-0" x 91' 2964'-0" x 92' 2998'-0" x 93' 3032'-0" x 94' 3066'-0" x 95' 3090'-0" x 96' 3124'-0" x 97' 3158'-0" x 98' 3192'-0" x 99' 3226'-0" x 100' 3260'-0" x 101' 3294'-0" x 102' 3328'-0" x 103' 3362'-0" x 104' 3396'-0" x 105' 3430'-0" x 106' 3464'-0" x 107' 3498'-0" x 108' 3532'-0" x 109' 3566'-0" x 110' 3590'-0" x 111' 3624'-0" x 112' 3658'-0" x 113' 3692'-0" x 114' 3726'-0" x 115' 3760'-0" x 116' 3794'-0" x 117' 3828'-0" x 118' 3862'-0" x 119' 3896'-0" x 120' 3930'-0" x 121' 3964'-0" x 122' 3998'-0" x 123' 4032'-0" x 124' 4066'-0" x 125' 4090'-0" x 126' 4124'-0" x 127' 4158'-0" x 128' 4192'-0" x 129' 4226'-0" x 130' 4260'-0" x 131' 4294'-0" x 132' 4328'-0" x 133' 4362'-0" x 134' 4396'-0" x 135' 4430'-0" x 136' 4464'-0" x 137' 4498'-0" x 138' 4532'-0" x 139' 4566'-0" x 140' 4590'-0" x 141' 4624'-0" x 142' 4658'-0" x 143' 4692'-0" x 144' 4726'-0" x 145' 4760'-0" x 146' 4794'-0" x 147' 4828'-0" x 148' 4862'-0" x 149' 4896'-0" x 150' 4930'-0" x 151' 4964'-0" x 152' 4998'-0" x 153' 5032'-0" x 154' 5066'-0" x 155' 5090'-0" x 156' 5124'-0" x 157' 5158'-0" x 158' 5192'-0" x 159' 5226'-0" x 160' 5260'-0" x 161' 5294'-0" x 162' 5328'-0" x 163' 5362'-0" x 164' 5396'-0" x 165' 5430'-0" x 166' 5464'-0" x 167' 5498'-0" x 168' 5532'-0" x 169' 5566'-0" x 170' 5590'-0" x 171' 5624'-0" x 172' 5658'-0" x 173' 5692'-0" x 174' 5726'-0" x 175' 5760'-0" x 176' 5794'-0" x 177' 5828'-0" x 178' 5862'-0" x 179' 5896'-0" x 180' 5930'-0" x 181' 5964'-0" x 182' 5998'-0" x 183' 6032'-0" x 184' 6066'-0" x 185' 6090'-0" x 186' 6124'-0" x 187' 6158'-0" x 188' 6192'-0" x 189' 6226'-0" x 190' 6260'-0" x 191' 6294'-0" x 192' 6328'-0" x 193' 6362'-0" x 194' 6396'-0" x 195' 6430'-0" x 196' 6464'-0" x 197' 6498'-0" x 198' 6532'-0" x 199' 6566'-0" x 200' 6590'-0" x 201' 6624'-0" x 202' 6658'-0" x 203' 6692'-0" x 204' 6726'-0" x 205' 6760'-0" x 206' 6794'-0" x 207' 6828'-0" x 208' 6862'-0" x 209' 6896'-0" x 210' 6930'-0" x 211' 6964'-0" x 212' 6998'-0" x 213' 7032'-0" x 214' 7066'-0" x 215' 7090'-0" x 216' 7124'-0" x 217' 7158'-0" x 218' 7192'-0" x 219' 7226'-0" x 220' 7260'-0" x 221' 7294'-0" x 222' 7328'-0" x 223' 7362'-0" x 224' 7396'-0" x 225' 7430'-0" x 226' 7464'-0" x 227' 7498'-0" x 228' 7532'-0" x 229' 7566'-0" x 230' 7590'-0" x 231' 7624'-0" x 232' 7658'-0" x 233' 7692'-0" x 234' 7726'-0" x 235' 7760'-0" x 236' 7794'-0" x 237' 7828'-0" x 238' 7862'-0" x 239' 7896'-0" x 240' 7930'-0" x 241' 7964'-0" x 242' 7998'-0" x 243' 8032'-0" x 244' 8066'-0" x 245' 8090'-0" x 246' 8124'-0" x 247' 8158'-0" x 248' 8192'-0" x 249' 8226'-0" x 250' 8260'-0" x 251' 8294'-0" x 252' 8328'-0" x 253' 8362'-0" x 254' 8396'-0" x 255' 8430'-0" x 256' 8464'-0" x 257' 8498'-0" x 258' 8532'-0" x 259' 8566'-0" x 260' 8590'-0" x 261' 8624'-0" x 262' 8658'-0" x 263' 8692'-0" x 264' 8726'-0" x 265' 8760'-0" x 266' 8794'-0" x 267' 8828'-0" x 268' 8862'-0" x 269' 8896'-0" x 270' 8930'-0" x 271' 8964'-0" x 272' 8998'-0" x 273' 9032'-0" x 274' 9066'-0" x 275' 9090'-0" x 276' 9124'-0" x 277' 9158'-0" x 278' 9192'-0" x 279' 9226'-0" x 280' 9260'-0" x 281' 9294'-0" x 282' 9328'-0" x 283' 9362'-0" x 284' 9396'-0" x 285' 9430'-0" x 286' 9464'-0" x 287' 9498'-0" x 288' 9532'-0" x 289' 9566'-0" x 290' 9590'-0" x 291' 9624'-0" x 292' 9658'-0" x 293' 9692'-0" x 294' 9726'-0" x 295' 9760'-0" x 296' 9794'-0" x 297' 9828'-0" x 298' 9862'-0" x 299' 9896'-0" x 300' 9930'-0" x 301' 9964'-0" x 302' 9998'-0" x 303' 10032'-0" x 304' 10066'-0" x 305' 10090'-0" x 306' 10124'-0" x 307' 10158'-0" x 308' 10192'-0" x 309' 10226'-0" x 310' 10260'-0" x 311' 10294'-0" x 312' 10328'-0" x 313' 10362'-0" x 314' 10396'-0" x 315' 10430'-0" x 316' 10464'-0" x 317' 10498'-0" x 318' 10532'-0" x 319' 10566'-0" x 320' 10590'-0" x 321' 10624'-0" x 322' 10658'-0" x 323' 10692'-0" x 324' 10726'-0" x 325' 10760'-0" x 326' 10794'-0" x 327' 10828'-0" x 328' 10862'-0" x 329' 10896'-0" x 330' 10930'-0" x 331' 10964'-0" x 332' 10998'-0" x 333' 11032'-0" x 334' 11066'-0" x 335' 11090'-0" x 336' 11124'-0" x 337' 11158'-0" x 338' 11192'-0" x 339' 11226'-0" x 340' 11260'-0" x 341' 11294'-0" x 342' 11328'-0" x 343' 11362'-0" x 344' 11396'-0" x 345' 11430'-0" x 346' 11464'-0" x 347' 11498'-0" x 348' 11532'-0" x 349' 11566'-0" x 350' 11590'-0" x 351' 11624'-0" x 352' 11658'-0" x 353' 11692'-0" x 354' 11726'-0" x 355' 11760'-0" x 356' 11794'-0" x 357' 11828'-0" x 358' 11862'-0" x 359' 11896'-0" x 360' 11930'-0" x 361' 11964'-0" x 362' 11998'-0" x 363' 12032'-0" x 364' 12066'-0" x 365' 12090'-0" x 366' 12124'-0" x 367' 12158'-0" x 368' 12192'-0" x 369' 12226'-0" x 370' 12260'-0" x 371' 12294'-0" x 372' 12328'-0" x 373' 12362'-0" x 374' 12396'-0" x 375' 12430'-0" x 376' 12464'-0" x 377' 12498'-0" x 378' 12532'-0" x 379' 12566'-0" x 380' 12590'-0" x 381' 12624'-0" x 382' 12658'-0" x 383' 12692'-0" x 384' 12726'-0" x 385' 12760'-0" x 386' 12794'-0" x 387' 12828'-0" x 388' 12862'-0" x 389' 12896'-0" x 390' 12930'-0" x 391' 12964'-0" x 392' 12998'-0" x 393' 13032'-0" x 394' 13066'-0" x 395' 13090'-0" x 396' 13124'-0" x 397' 13158'-0" x 398' 13192'-0" x 399' 13226'-0" x 400' 13260'-0" x 401' 13294'-0" x 402' 13328'-0" x 403' 13362'-0" x 404' 13396'-0" x 405' 13430'-0" x 406' 13464'-0" x 407' 13498'-0" x 408' 13532'-0" x 409' 13566'-0" x 410' 13590'-0" x 411' 13624'-0" x 412' 13658'-0" x 413' 13692'-0" x 414' 13726'-0" x 415' 13760'-0" x 416' 13794'-0" x 417' 13828'-0" x 418' 13862'-0" x 419' 13896'-0" x 420' 13930'-0" x 421' 13964'-0" x 422' 13998'-0" x 423' 14032'-0" x 424' 14066'-0" x 425' 14090'-0" x 426' 14124'-0" x 427' 14158'-0" x 428' 14192'-0" x 429' 14226'-0" x 430' 14260'-0" x 431' 14294'-0" x 432' 14328'-0" x 433' 14362'-0" x 434' 14396'-0" x 435' 14430'-0" x 436' 14464'-0" x 437' 14498'-0" x 438' 14532'-0" x 439' 14566'-0" x 440' 14590'-0" x 441' 14624'-0" x 442' 14658'-0" x 443' 14692'-0" x 444' 14726'-0" x 445' 14760'-0" x 446' 14794'-0" x 447' 14828'-0" x 448' 14862'-0" x 449' 14896'-0" x 450' 14930'-0" x 451' 14964'-0" x 452' 14998'-0" x 453' 15032'-0" x 454' 15066'-0" x 455' 15090'-0" x 456' 15124'-0" x 457' 15158'-0" x 458' 15192'-0" x 459' 15226'-0" x 460' 15260'-0" x 461' 15294'-0" x 462' 15328'-0" x 463' 15362'-0" x 464' 15396'-0" x 465' 15430'-0" x 466' 15464'-0" x 467' 15498'-0" x 468' 15532'-0" x 469' 15566'-0" x 470' 15590'-0" x 471' 15624'-0" x 472' 15658'-0" x 473' 15692'-0" x 474' 15726'-0" x 475' 15760'-0" x 476' 15794'-0" x 477' 15828'-0" x 478' 15862'-0" x 479' 15896'-0" x 480' 15930'-0" x 481' 15964'-0" x 482' 15998'-0" x 483' 16032'-0" x 484' 16066'-0" x 485' 16090'-0" x 486' 16124'-0" x 487' 16158'-0" x 488' 16192'-0" x 489' 16226'-0" x 490' 16260'-0" x 491' 16294'-0" x 492' 16328'-0" x 493' 16362'-0" x 494' 16396'-0" x 495' 16430'-0" x 496' 16464'-0" x 497' 16498'-0" x 498' 16532'-0" x 499' 16566'-0" x 500' 16590'-0" x 501' 16624'-0" x 502' 16658'-0" x 503' 16692'-0" x 504' 16726'-0" x 505' 16760'-0" x 506' 16794'-0" x 507' 16828'-0" x 508' 16862'-0" x 509' 16896'-0" x 510' 16930'-0" x 511' 16964'-0" x 512' 16998'-0" x 513' 17032'-0" x 514' 17066'-0" x 515' 17090'-0" x 516' 17124'-0" x 517' 17158'-0" x 518' 17192'-0" x 519' 17226'-0" x 520' 17260'-0" x 521' 17294'-0" x 522' 17328'-0" x 523' 17362'-0" x 524' 17396'-0" x 525' 17430'-0" x 526' 17464'-0" x 527' 17498'-0" x 528' 17532'-0" x 529' 17566'-0" x 530' 17590'-0" x 531' 17624'-0" x 532' 17658'-0" x 533' 17692'-0" x 534' 17726'-0" x 535' 17760'-0" x 536' 17794'-0" x 537' 17828'-0" x 538' 17862'-0" x 539' 17896'-0" x 540' 17930'-0" x 541' 17964'-0" x 542' 17998'-0" x 543' 18032'-0" x 544' 18066'-0" x 545' 18090'-0" x 546' 18124'-0" x 547' 18158'-0" x 548' 18192'-0" x 549' 18226'-0" x 550' 18260'-0" x 551' 18294'-0" x 552' 18328'-0" x 553' 18362'-0" x 554' 18396'-0" x 555' 18430'-0" x 556' 18464'-0" x 557' 18498'-0" x 558' 18532'-0" x 559' 18566'-0" x 560' 18590'-0" x 561' 18624'-0" x 562' 18658'-0" x 563' 18692'-0" x 564' 18726'-0" x 565' 18760'-0" x 566' 18794'-0" x 567' 18828'-0" x 568' 18862'-0" x 569' 18896'-0" x 570' 18930'-0" x 571' 18964'-0" x 572' 18998'-0" x 573' 19032'-0" x 574' 19066'-0" x 575' 19090'-0" x 576' 19124'-0" x 577' 19158'-0" x 578' 19192'-0" x 579' 19226'-0" x 580' 1926

Superstructure bulkheads, trunks, deckhouses, casings, cargo and coaling hatchways, extent and thickness of sheathing on the freeboard deck, gangway, cargo and coaling ports, and any other openings, etc., which would affect the seaworthiness of the ship are to be shown on the following sketches:—

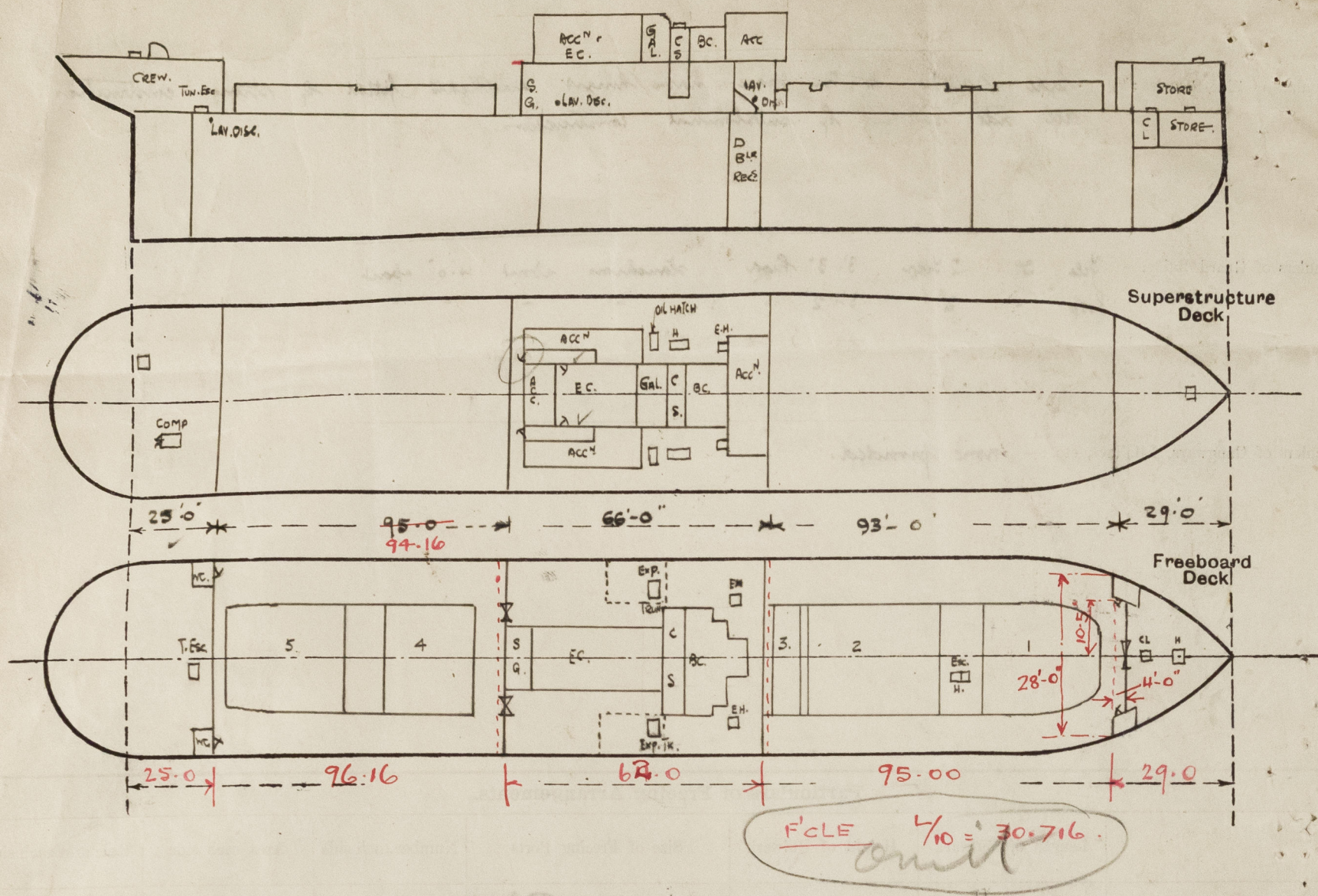

State any special features in the construction of the ship:—

*Vessel measured afloat.
Yimbu assignment required.*

Rule 88. *Boiler* Engine Room Longitudinally divided. This vessel has deep side tanks in Engine Room Port Side. 72 Tons - 7
Starboard Side. 110 Tons.

Rule 89. Ballast tanks at Tunnel sides aft. X
Bulwarks 4'-0" high. 6 1/2 x 3" by 3/4" Rail Bar. Slaps 8 x 1/40 bull plate spaced about 6'-0" apart.
Bridge Bulwarks. 3'-6" high. 4 1/2 x 3" angle rail. 6 x 7/20 bull plate slaps spaced about 6'-0" apart. ✓

Rule 90. Steering gear fitted amidships. Rods chains alongside bulwark inside slaps not protected.
Hand gear fitted aft over quadrant. ✓

Rule 91. No eye-bolts or sockets fitted on this vessel.

Builder's name and yard number *B.P. Austin Son. Ltd. Sunderland.*

Names of sister ships *Similar to S.S. STESSO.*

Owners *Pelton - S.S. Co. Ltd.*

Fee £ *10 : 4 : 0* ✓ Received by me



© 2021

Lloyd's Register
Foundation