

Lloyd's Register of Shipping.

Ship's Name "ACAPULCO" (EX "NASSAU")

Official No. ✓

Memorandum of alterations reported since ship was surveyed for assignment of Load Lines

AT GLASGOW - IN NOVEMBER & DECEMBER 1961

RETAIN

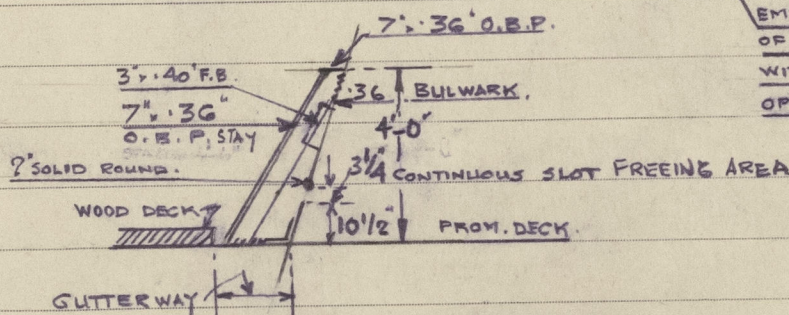
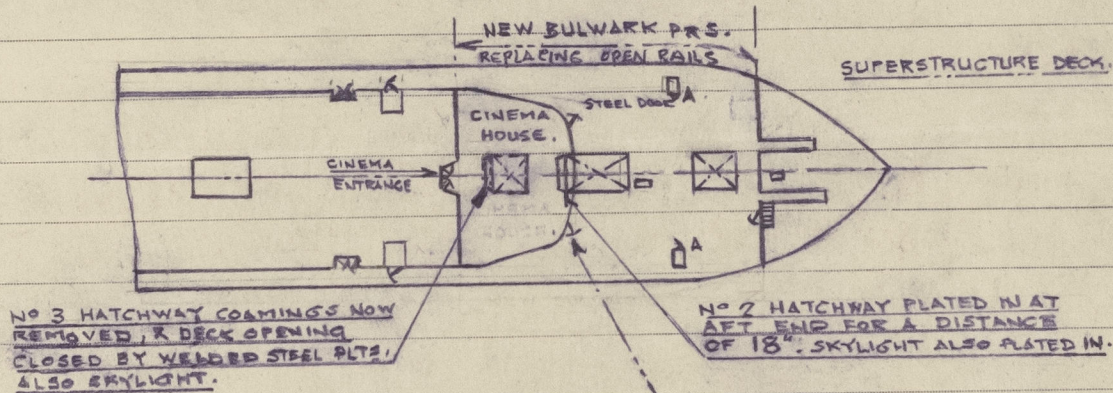
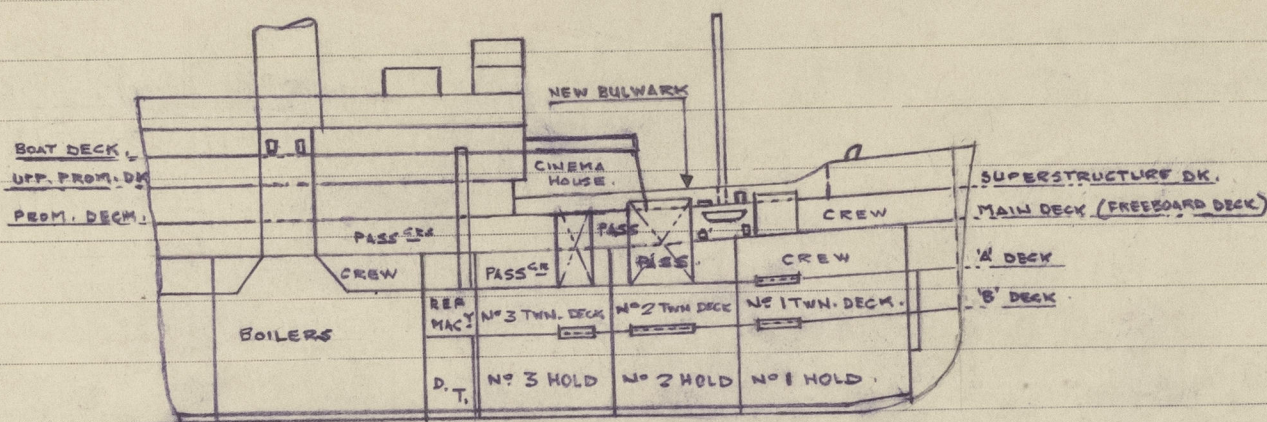

DETAIL OF BULWARK STAYS.
SPACED APPROX 4' 6" APART.

EMERGENCY EXIT DOORS (F & S)
OF STRONG STEEL, W.T. DOORS
WITH TOGGLES - 5'-0", 2'-3", 2'-4" COAMING,
OPERATED BOTH SIDES.

NOTED
18.1.62

H. Little