

OWNERS' C.11 ISSUED
LLOYD'S REGISTER OF SHIPPING

Index No. _____
(For London Office only.)

UNITED WITH THE BRITISH CORPORATION REGISTER

SURVEYS FOR FREEBOARD.

(CONDITIONS OF ASSIGNMENT.)

GRK. REPORT N° 25858.

Ship's Name..... AYRSHIRE. Port of Survey..... GREENOCK.
Official Number..... 300171 Surveyor's Signature..... Alexander J. Moore
Nationality and Port of Registry..... BRITISH GLASGOW. Date of Survey..... DURING CONSTRUCTION.

Disposition and dimensions of superstructures, trunks, deckhouses, machinery casings and wood sheathing to be inserted in the diagrams and tabular statement :—

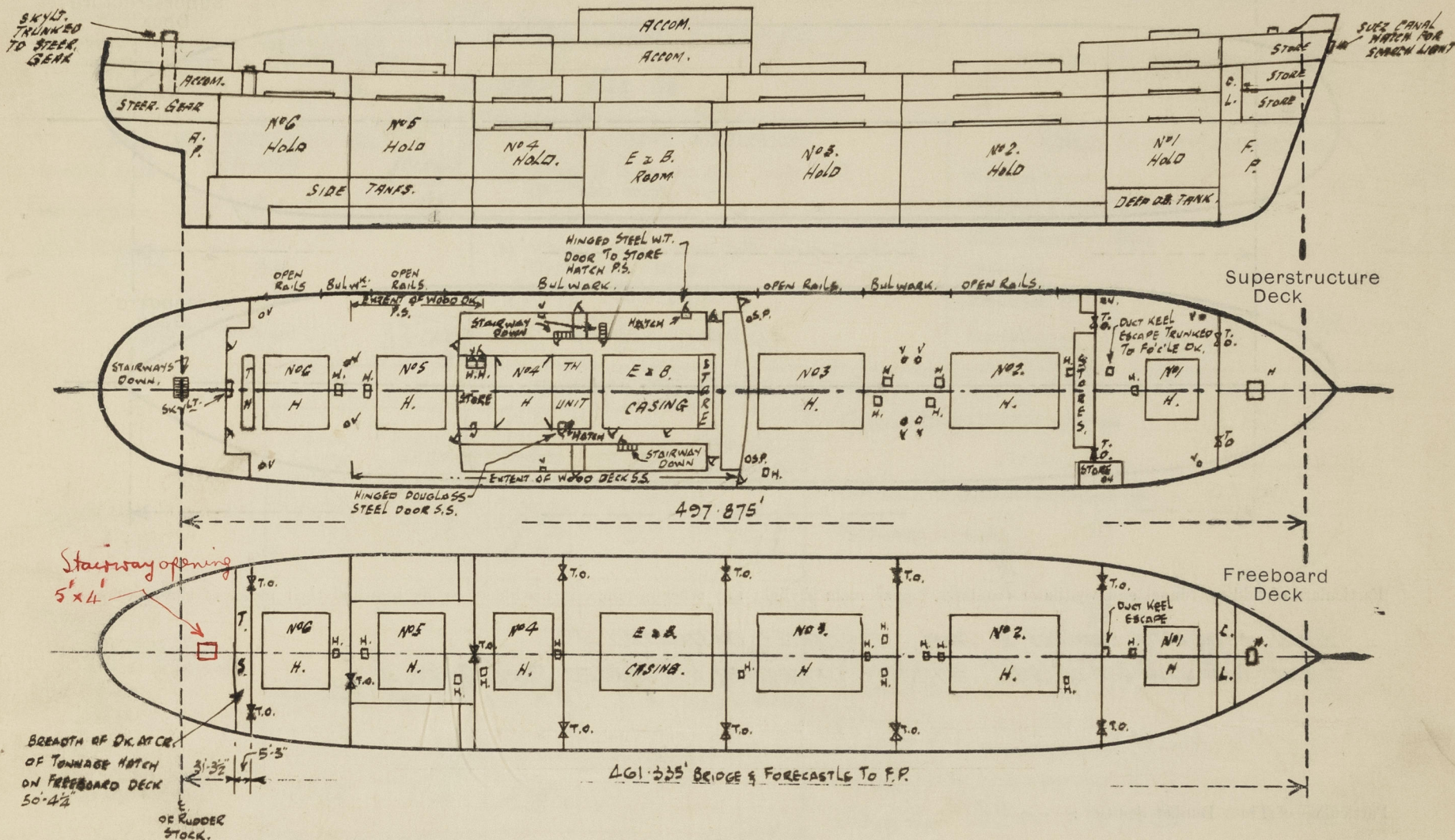

Particulars of Superstructures, Trunks, Casings, Deckhouses.

	Coaming	Plating	Stiffeners	Spacing	End Attachments of Stiffeners	Size of Openings	Height of Sills	Height, Beam to Beam
Poop Bulkhead26"✓	.26"✓	3" x 3" x .38"✓	3 1/2" / 33"✓	NONE ✓	NONE	-	8'-6"✓
Raised Quarter Deck Bulkhead								
Bridge, After Bulkhead								
Bridge, Forward Bulkhead								
COMBINED BRIDGE & Forecastle Bulkhead... } ✓	.26"✓	.26"✓	3" x 3" x .38"✓	3 1/2" / 33"✓	NONE ✓	4'-1" x 3'-1"	15"✓	8'-6"✓
Trunk, Aft								
ENCLOSED Machinery Casings on Freeboard or Raised Quarter Decks ...	15" x .49"✓	.29"✓	3" x 2 1/2" x .32"✓	.33"✓	CARRIED UP AT TOP RIVETED AT BOTTOM ✓	5'-2" x 2'-0"	17"✓	8'-6"✓
ENCLOSED Machinery Casings on Superstructure Decks	15" x .34"✓	.25"✓	3" x 2 1/2" x .32"✓	.33"✓	SKTS AT TOP CARRIED DOWN AT BOTTOM ✓	5'-6" x 1'-11"	15"✓	8'-3"✓
Machinery Casings within Superstructures not fitted with Class I Closing Appliances	15" x .34"✓	.25"✓	3" x 2 1/2" x .32"✓	.33"✓	CARRIED UP AT TOP CARRIED DOWN AT BOTTOM ✓	5'-2" x 2'-0"	17"✓	8'-3"✓
Deckhouses and Pump Room Entrances	.30"✓	.30"✓	5" x 3" x .34"✓	.33"✓	WELDED TOP & BOTTOM ✓	4 @ 5'-3" x 2'-9" 2 @ 5'-3" x 2'-3"	18"✓	8'-3"✓

Particulars of Closing Appliances (state if capable of being manipulated from both sides).

Poop Bulkhead	NO OPENINGS. ✓
Raised Quarter Deck Bulkhead	
Bridge, After Bulkhead	
Bridge, Forward Bulkhead	
COMBINED BRIDGE & Forecastle Bulkhead... } ✓	1 - TONNAGE OPENING (P.S.) FITTED WITH PORTABLE PLATE SECURED BY HOOK BOLTS NOT PASSING THRO' BHD. ✓
ENCLOSED Machinery Casings on Freeboard or Raised Quarter Decks ...	1 - DOUGLAS STEEL DOOR (SS) CAPABLE OF BEING OPERATED FROM BOTH SIDES. ✓
ENCLOSED Machinery Casings on Superstructure Decks	1 - WOODEN DOOR (PIS) CAPABLE OF BEING OPERATED FROM BOTH SIDES. ✓
Machinery Casings within Superstructures not fitted with Class I Closing Appliances ...	2 - DOUGLAS STEEL DOORS (PIS) CAPABLE OF BEING OPERATED FROM BOTH SIDES. ✓
Deckhouses and Pump Room Entrances	3 - SOLID TEAK 2" TH. WOOD DOORS (PSS) CAPABLE OF BEING OPERATED FROM BOTH SIDES. ✓

PARTICULARS OF PROTECTION TO OPENINGS, ETC.

The following diagrams should be used to indicate the positions of cargo and coaling hatchways, gangway, cargo and coaling ports, side scuttles, scuppers, ventilators, companionways, etc., which would affect the seaworthiness of the ship :—

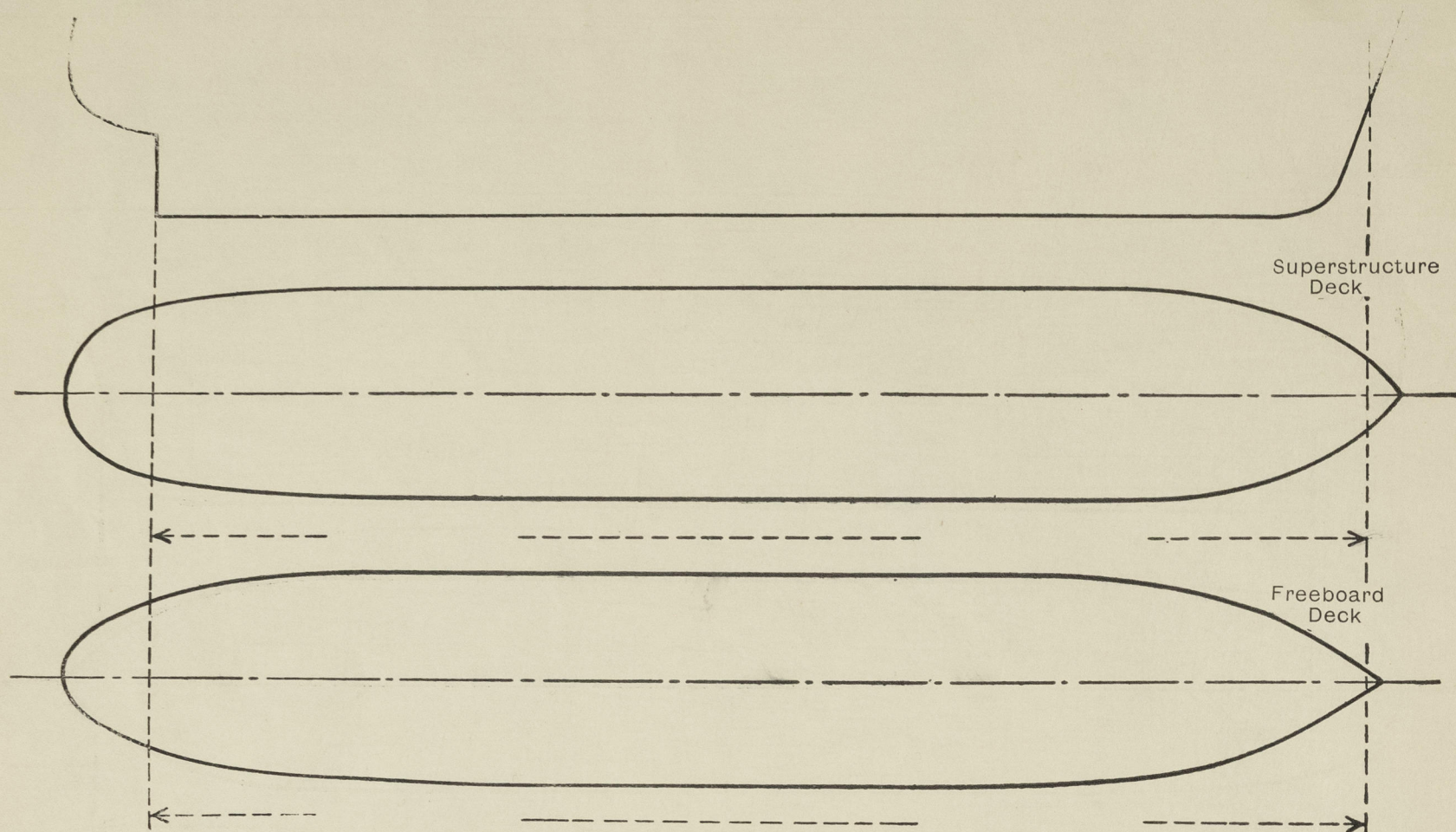

Particulars of fiddley, funnel and ventilator coamings, engine room skylight and other openings in machinery casing tops and their means of closing :—

FUNNEL & VENTILATOR COAMINGS OF STEEL, EFFICIENTLY CONSTRUCTED ✓

ENGINE ROOM SKYLIGHT OF STEEL STRONGLY CONSTRUCTED WITH HINGED STEEL COVERS. ✓

Particulars of Flush Bunker Scuttles :—

NONE. ✓

Particulars of Companionways :—

(including those incorporated in deckhouses and masthouses)

POOP DK :— ACCESS TO POOP SPACE ENCLOSED IN STRONG STEEL DECKHOUSE
DECK OPENING PROTECTED BY 2" SOLID TEAK DOOR 5'0" x 2'6"
CAPABLE OF BEING OPERATED FROM BOTH SIDES, SILL 20"
ABOVE HOOD DECK ✓
POOP SPACE :— (BETWEEN UPPER & POOP DKS.) OPENING ENCLOSED IN
STRONG STEEL DECKHOUSE, OPENING PROTECTED BY 2-2"
SOLID TEAK DOORS - 5'0" x 2'3" CAPABLE OF BEING OPERATED
FROM BOTH SIDES - SILL 20" ABOVE HOOD DK. ✓

INSIDE MIDSHIP ACCOMMODATION SHELTER DK :—
ACCESS HATCHES TO NO 4 & 5 TWEEN DKS (BOFF)
ENCLOSED IN STRONG STEEL DECKHOUSE, DECK
OPENING PROTECTED BY HINGED DOUBLES STEEL
DOORS 5'3" x 1'6" CAPABLE OF BEING
OPERATED FROM BOTH SIDES
HEIGHT OF SILLS 18" ✓

ACCESS HATCH TO DOMESTIC CHAMBERS P.S.
ENCLOSED BY STRONG STEEL DECKHOUSE
PROTECTED BY STEEL H.T. DOOR 5'3" x 2'4"
HEIGHT OF SILL 18" DOOR SECURED BY 6
TURNBUCKLES CAPABLE OF BEING OPERATED
FROM BOTH SIDES. ✓

DECK COMPENSATION HAS BEEN FITTED IN NAY OF OPENINGS. ✓

Particulars of Ventilators in exposed positions on freeboard and superstructure decks :—

FOCILE DK :—
4 @ 6" DIA CV TO STOREROOM COAMING 36" x 30" ✓
1 @ 9" " " " DUCT KEEL ESCAPE " 36" x 40" ✓
2 @ 21" " " " NO 1 H. & TN. DKS " 36" x 40" ✓
2 @ 23" " " " " " " " 36" x 40" ✓
1 @ 14" " " " STOREROOM " 36" x 36" ✓

BRIDGE DK :—
2 @ 14" DIA CV TO NO 4 UPPER TN. DKS " 36" x 36" ✓

UPPER DK :— (AFTER HELL)
2 @ 11 1/4" DIA CV TO NO 6 UPPER TN. DKS " 36" x 34" ✓
2 @ 17 1/4" " CV " (ON TOP OF MASTHOUSE) TO " 30" x 40" ✓
NO 6 H. & TWEEN DK.

UPPER DK :— (MIDSHIP PASSAGE)
2 @ 8 x 6" SNV TO STOREROOMS " 30" x 3 3/8" ✓
2 @ 4 x 4 " " " " " 30" x 3 3/8" ✓

UPPER DK (FORD HELL)
2 @ 16 1/2" DIA C.V. TO NO 3 UPPER TN. DKS COAMING 36" x 38" ✓
2 @ 18" " CV TO NO 2 " " " 36" x 40" ✓

POOP DK.
1 @ 14" DIA. CV. TO TUNNEL ESCAPE COAMING 33" x 36" ✓
2 @ " " " " NO 6. HOLD " 36" x 36" ABOVE HOOD DK.
1 @ 6" " " " STOREROOM " 30" x 30" ✓
1 @ 4" " " " " " " " " " ABOVE HOOD DK
2 @ 5" " " " " " " " " " ✓
1 @ 8" " " " " STEER. G. (TOP SKYLIT.) " " " " ✓
2 @ 16" M.V. NE. " PASSAGE " 30" x 40" ✓
4 @ 4 x 4 SNV NE. " STOREROOMS ETC " 30" x 36" ✓
2 @ 6 x 4 " " " " " " " " ✓
1 @ 10 x 6 " " " " " " " " ✓
1 @ 8 x 6 " " " " " " " " ✓
1 @ 11 x 6 " " " " " " " " ✓
1 @ 9 x 4 " " " " " " " " ✓

ALL VENTS FITTED WITH WOOD PLUGS & CANVAS COVERS. ✓

Particulars of Air Pipes in exposed positions on freeboard, raised quarter, or superstructure decks :—

FORECASTLE DK :—
8 - 4" DIA AIR PIPES 18" TO OPENING ✓
2 - 3" " " " " " " " ✓
2 - 2" " " " " " " " ✓

BRIDGE DK :—
12 - 3" " " " " " " " ✓
1 - 2" " " " " " " " ✓

BOAT DK :—
1 - 6" " " " " " " " ✓

POOP DK :—
3 - 3" " " " " " " " ✓

UPPER DK :—
7 - 5" DIA AIR PIPES 30" TO OPENING ✓
28 - 4" " " " " " " " ✓
24 - 3" " " " " " " " ✓
6 - 2 1/2" " " " " " " " ✓

AIR PIPES TO DE. TANKS FITTED WITH GAUZE & CANVAS COVERS ✓
" " " WATER " " " WOOD PLUGS & CANVAS COVERS ✓

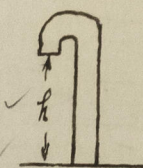

© 2021

Lloyd's Register
Foundation

Ayrshire

NG

Particulars of Scuppers and Sanitary Discharge Pipes :—

- ✓ SCUPPERS FROM UPPER THREE DKS LED TO BILGES WITH GUNMETAL SCREEN DOWN 2 1/2" DIA VALVES GEARED TO UPPER DK. WITH INDICATORS. SHOWING OPEN & SHUT POSITION.
- ✓ SCUPPERS FROM UPPER DK. CUT THRO' STRINGER BAR 1A OFF (P.S.S.)
- ✓ SCUPPERS FROM NO 4 UPPER THREE DK LED TO ENG. ROOM BILGE WITH SELF CLOSING COCK.
- ✓ SCUPPERS FROM TONNAGE WELL AFT - 2 @ 5" DIA LED OVERBOARD HAVING GUNMETAL SCREEN DOWN VALVE GEARED TO UPPER DECK WITH INDICATOR SHOWING. OPEN & SHUT POSITION.
- ✓ SCUPPER FROM UPPER FO'LE FRONT DRAINED THRO' BRASS NON DETACHABLE SCREEN PLUGS.
- ✓ SCUPPERS FROM CRENS SPACE IN UPPER THREE DECK AFT 2 @ 2 1/2" DIA. LED THRO' SHELL BROWN FREEB'D DK. WITH BRASS NON RETURN VALVE HAVING CAPTIVE COVER
- ✓ SCUPPERS FROM BRINE ROOM IN UPPER TH. DKS. - 2 @ 2 1/2" DIA LED TO ER. BILGES WITH SELF CLOSING COCK.
- ✓ SCUPPERS FROM REFRIG. MACHY SPACE IN UPPER THREE DK SPACE SS. 3 @ 2 1/2" DIA. LED TO ER BILGES WITH SELF CLOSING COCK.
- ✓ SCUPPERS FROM DOMESTIC CHAMBER IN UPPER THREE DK - 1 @ 2 1/2" DIA. LED OVERBOARD WITH BRASS N.R.V. AT SHIPS SIDE.
- ✓ DISCHARGES & SCUPPERS FROM MIDSHIP ACCOMMOD. SPACES LED OVERBOARD BELOW FREEBOARD DK. HAVING HIGH & LOW DISCHARGE VALVES AT SHIPS SIDE N.R. BRASS (WITH POSITIVE MEANS OF CLOSING.)
- ✓ DISCHARGES FROM HOSPITAL AT AFT END OF BRIDGE DK LED OVER BOARD ABOVE FREEBOARD DK WITH BRASS N.R.V AT SHIPS SIDE.
- ✓ DISCHARGES FROM POOP SPACES LED OVERBOARD WITH HIGH & LOW DISCHARGES THRO' SHELL (LOW VALVES HAVE POSITIVE MEANS OF CLOSING.)

Particulars of Side Scuttles and Deadlights :—

- | | | | | | | |
|--------------------------------------|----|----------|--------------------------------|---|---|---|
| ✓ UPPER POOP | :- | 12" DIA. | FITTED WITH HINGED DEADLIGHTS. | | | |
| ✓ LOWER POOP | :- | 12" " | " | " | " | " |
| ✓ UPPER FO'CLE | :- | 10" " | " | " | " | " |
| ✓ BRIDGE SPACE | :- | 12" " | " | " | " | " |
| (BETWEEN UPPER & 2 ND DX) | | | | | | |

ALL SIDELIGHTS & DEADLIGHTS TO APPROVED PATTERN
WELDED STEEL FRAMES TO SHELL & M.C.I. DEADLIGHTS.

38'-2 $\frac{3}{4}$ "

3-3 1/2 FORD. OF. MIDSHIP.

Particulars of Guard Rails and Bulwarks :—

FORECASTLE & POOP OK. RAILS :- 3'-6" HIGH 3 TIER TOP RAIL 1/4" DIA TUBE BOTTOM RAIL 7/8" DIA SOLID, STANCHIONS APPROX 5'-0" APART
BRIDGE DECK RAILS :- 3'-6" " 4 " " " " " " " " " " " "
UPPER DECK RAILS :- 3'-9" " 3 " " " " " " " " " " " "
ALL RAILS EFFICIENTLY STAYED ✓
UPPER DECK BULWARK :- 3'-9" HIGH 6 x 3/2 x .40 OR RAIL BAR - PLATE .40 - STIFFS 6 x 3/8 B.R STACED APPROX 5'-6" APART.
EFFICIENTLY STAYED.

Particulars of Gangways, Lifelines, etc. :—

LIFELINES FITTED

Particulars of Freeing Arrangements.						
	Length of Bulwark	Height of Bulwark	Size of Freeing Ports	Number each side	Area each side	Rule area each side
After Well			OPEN RAILS. ✓			
Forward Well			OPEN RAILS. ✓			

State position of each freeing port { After Well :—
(F. and A. position and height above deck edge) { Forward Well :—

State whether the freeing ports are fitted with shutters, bars, or rails, and give particulars of such :—

Additional area where sheer is less than standard.

PARTICULARS OF PROTECTION TO OPENINGS, ETC.

HATCHWAYS ON FREEBOARD AND SUPERSTRUCTURE DECKS.									
<div> <div>IN FO'LE SPACE</div> <div>UPPER DECK</div> <div>FO'LE DK. BRIDGE DK.</div> </div>									
Description of Hatchway ...	Nº1	Nº2	Nº3	Nº4	Nº5	Nº6		Nº1	Nº4
Dimensions of Hatchway ...	22'6" x 18'0"	48'9" x 22'0"	35'9" x 22'0"	27'0" x 22'0"	30'3" x 22'0"	22'0" x 22'0"		20'3" x 18'0"	27'6" x 22'0"
COAMINGS	Height above Deck ...	12' x 3 1/2" x 44"	33"	33"	33"	33"		33"	33"
	Thickness ...	8 A.	44"	44"	44"	44"		44"	44"
	Sides ...	COAMING.	44"	44"	44"	44"		44"	44"
	Stays ...	4 @ 2 1/2" DIA.	3 @ 2 1/2" DIA.	2 @ 2 1/2" DIA.	3 @ 2 1/2" DIA.	2 @ 2 1/2" DIA.		2 @ 2 1/2" DIA.	2 @ 2 1/2" DIA.
HATCH BEAMS	Number ...	3	9	7	5	3		5	5
	Spacing ...	5' 7 3/8"	4' 11 1/16"	4' 6 1/32"	5' 1 1/16"	5' 7 1/16"		4' 8"	4' 8"
	Scantling and Sketch ...	4" x 3" x 44"	3 1/2" x 3" x 46"	3 1/2" x 3" x 46"	3 1/2" x 3" x 30"	3 1/2" x 3" x 46"		3 1/2" x 3" x 41"	3 1/2" x 3" x 41"
	Bearing Surface ...	4"	3 1/2"	3 1/2"	3 1/2"	3 1/2"		3 1/2"	3 1/2"
FORE AND AFTERS	Number ...								
	Spacing ...								
	Unsupported Lengths ...								
	Scantling* and Sketch ...								
HATCH COVERS	Material ...	WOOD	WOOD	WOOD	WOOD	WOOD		WOOD	WOOD
	Thickness ...	2 3/4"	2 3/8"	2 3/8"	2 3/4"	2 3/4"		2 3/8"	2 3/8"
	How fitted ...	F. & A.	F. & A.	F. & A.	F. & A.	F. & A.		F. & A.	F. & A.
	Bearing Surface ...	3 1/2"	3 1/8"	3 1/8"	3 1/8"	3 1/8"		3 1/8"	3 1/8"
Spacing of Cleats ...				24" APART.				3' 3" CROSS JOINT WEDGES NOT MORE THAN 4' 0" APART.	24"
Number of Tarpaulins...	2	2	2		2	2		2	2
<p>*Are wood fore and afters steel shod at all bearing surfaces? NONE.</p> <p>Are battens and wedges efficient and in good condition? YES.</p> <p>Are tarpaulins in good condition and in accordance with rule requirements? YES.</p> <p>Are lashings provided in accordance with rule requirements? YES. ALSO 2 LOCKING BARS FITTED TO EACH BAY OF Nº2 MAIN HATCH & 1 LOCKING BAR TO EACH BAY OF REMAINDER.</p> <p>Are wood covers fitted with galvanised end bands? YES.</p>									

Particulars of any special features:— (Timber Deck-cargo Fittings, Skylights, Sewage Systems, Ash Ejectors, Rubbish Shoots, etc.)

SMALL HATCHES.

FO'LE DECK:— HATCH TO FO'LE SPACE:— 4'0" x 3'6" COAMING 30" HIGH x 40" WITH HINGED STEEL W.T. COVER 40" PLATE SECURED BY 8 TOGGLES.

HATCH TO DUCT KEEL ESCAPE:— 2'0" x 2'6 3/8" " 30" " x 40" " " " 40" " " 8 "

POOP DECK:— HATCH TO C.O.'S DECK STORES:— 2'0" x 2'3" " 30" " (ABOVE WOOD DK.) x 40" WITH HINGED STEEL W.T. COVER 40" PLATE SECURED BY 8 TOGGLES.

UPPER DECK:— TONNAGE HATCH:— 4'11" x 22'0" COAMING 12" x 3 1/2" x 42" B.A. 2 1/2" WOOD COVERS. BEARING SURFACE 3 1/2" WOOD COVERS FITTED F. & A. AND SECURED BY LASHINGS.

UPPER DECK ACCESS HATCHES:— TO Nº3 & 6 UPPER TWEEN DECKS, 2 OFF TO COOLER ROOM:— 2'4" x 2'7" COAM. 30" HIGH x 50" WITH HINGED STEEL NT COVER 50" PLATE SECURED BY 8 TOGGLES

TO Nº5 UPPER TW. DECKS:— 3'1" x 3'6 1/2", COAM. 30" HIGH x 50" WITH HINGED STEEL W.T. COVER 50" PLATE SECURED BY 8 TOGGLES

TO Nº2 UPPER TW. DECKS:— 2'0" x 2'7" COAM. 32" HIGH x 50" WITH HINGED STEEL NT COVER 50" PLATE SECURED BY 8 TOGGLES.

TO Nº3 UPPER TW. DECKS. (SB ONLY):— 2'0" x 2'0" COAM. 32" HIGH x 50" WITH HINGED STEEL NT. COVER 50" PLATE SECURED BY 8 TOGGLES.

TO Nº1 UPPER TW. DECKS:— (IN FO'LE SPACE):— 1'10 1/2" x 2'6" COAM. 9" x 44" B.P. WITH 2 1/2" x 2 1/2" x 5/16" REST BAR WOOD COVERS 2 1/2" TH. F. & A. SECURED BY CLEATS & BATTENS - 1 TARPULIN.

TO CHAIN LKR & UPPER STORE (IN FO'LE SPACE):— 6'0" x 4'5" COAM. 9 1/2" x 44" B.A. WITH 2 1/2" x 2 1/2" x 5/16" REST BAR WOOD COVERS 2 1/2" TH. F. & A. SECURED BY CLEATS & BATTENS - 1 TARPULIN.

FREEBOARD DECK ACCESS HATCHES:— TO HOLDS ETC., 10 OFF, 3'0" x 2'6" COAM. 9" x 3 1/2" x 40" B.A. WITH HINGED STEEL NT COVER 40" THICK SECURED BY 6 TOGGLES

" " " 4 OFF 2'6" x 2'0" COAM 9" x 7/16" FLAT BAR WITH 2 1/2" x 2 1/2" x 5/16" REST BAR. WOOD COVERS 2 1/2" THICK FITTED FORE & AFT. BEARING SURFACE 2 1/2". SECURED BY CLEATS & BATTENS. 1 TARPULIN.

TO LOWER STORE 10 OFF 3'3" x 2'1" COAMING 9" x 3 1/2" x 44" I.A. WELDED TO DECK WITH STEEL COVER 40" THICK SECURED BY BOLTS W.T. FITCH.

BRIDGE DECK ACCESS HATCH:— 1 OFF 2'3" x 2'0" COAMING 18" ABOVE WOOD DECK x 44" WITH HINGED STEEL W.T. COVER 40" THICK SECURED BY 8 TURNBUCKLES.

SKYLIGHTS:— ON UPPER DECK TO AFT ACCOMMODATION 5'1" x 2'6" COAMING 27" HIGH x 44" THICK WITH HINGED STEEL W.T. FLAPS HAVING 2 BULLSEYES 9" DIA. OF STRONG CONSTRUCTION.

ON POOP DECK, TRUNKED TO STEERING GEAR COMPARTMENT 6'0" x 4'6" COAMING 27" HIGH x 44" THICK WITH HINGED STEEL W.T. FLAPS HAVING 6 BULLSEYES 9" DIA. OF STRONG CONSTRUCTION.

MACGREGOR STEEL W.T. HATCH COVER FITTED TO Nº1 HATCH ON FORECASTLE DECK.

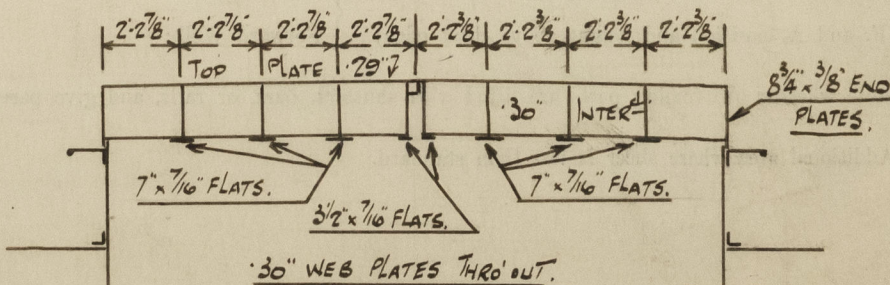

© 2021

Lloyd's Register Foundation