

Bb. vingedæk og hus vist, sb contra !

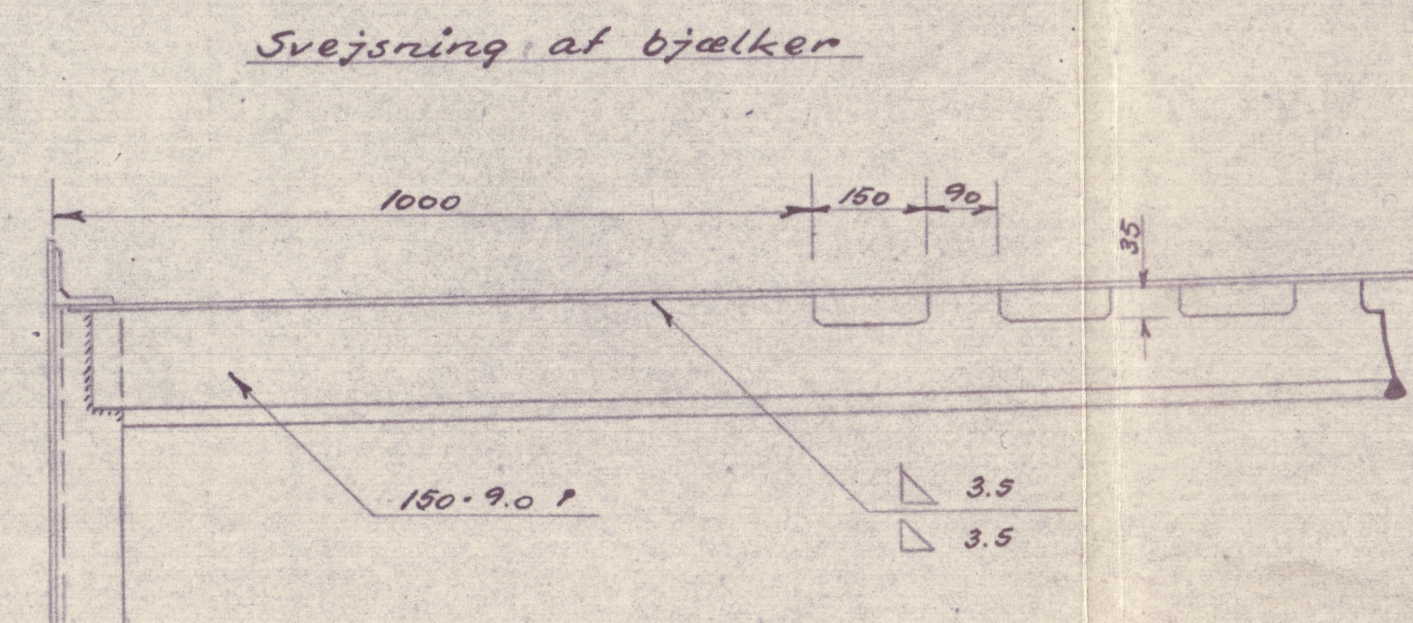

Måling			
Hus:	Høj.	Afsl.	Lap.
Fodladjern	16	80	
Stag	16	110	
Somme	16	80	60
Top af stringer x	16	80	
Skodder indv.:			
Fodladjern	13	65	
Hj. & m. indv. skodder	13	65	

2 stk. davidsoklen fra lager
2" spygater
sb. davids og båd (jolle) m. bådclamper
fra pæle anbringes i sb. side
sb. jolle tages i land.
Hus om 66 bibeh. karm forlæn.
ges til 760mm over vingedæk.

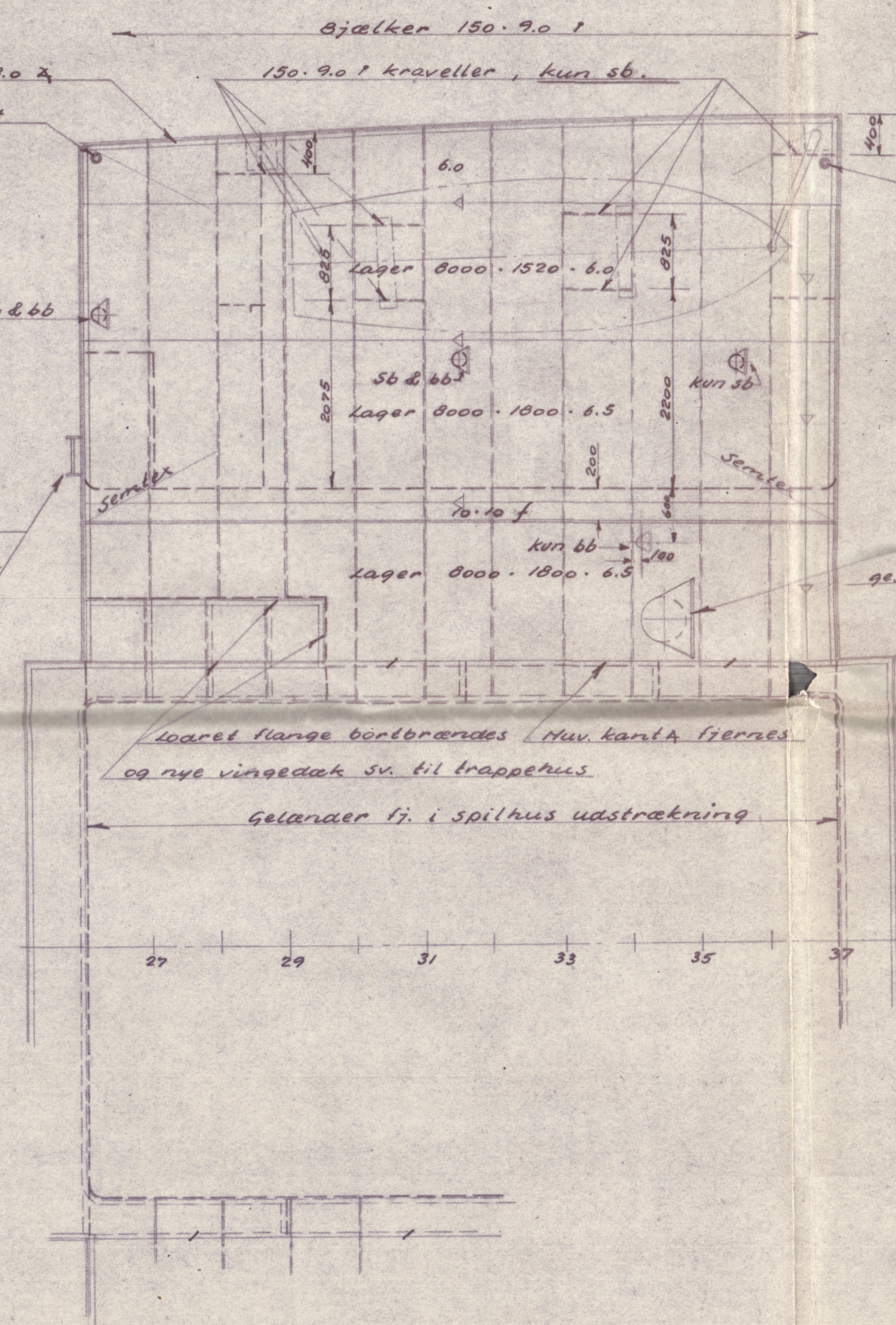
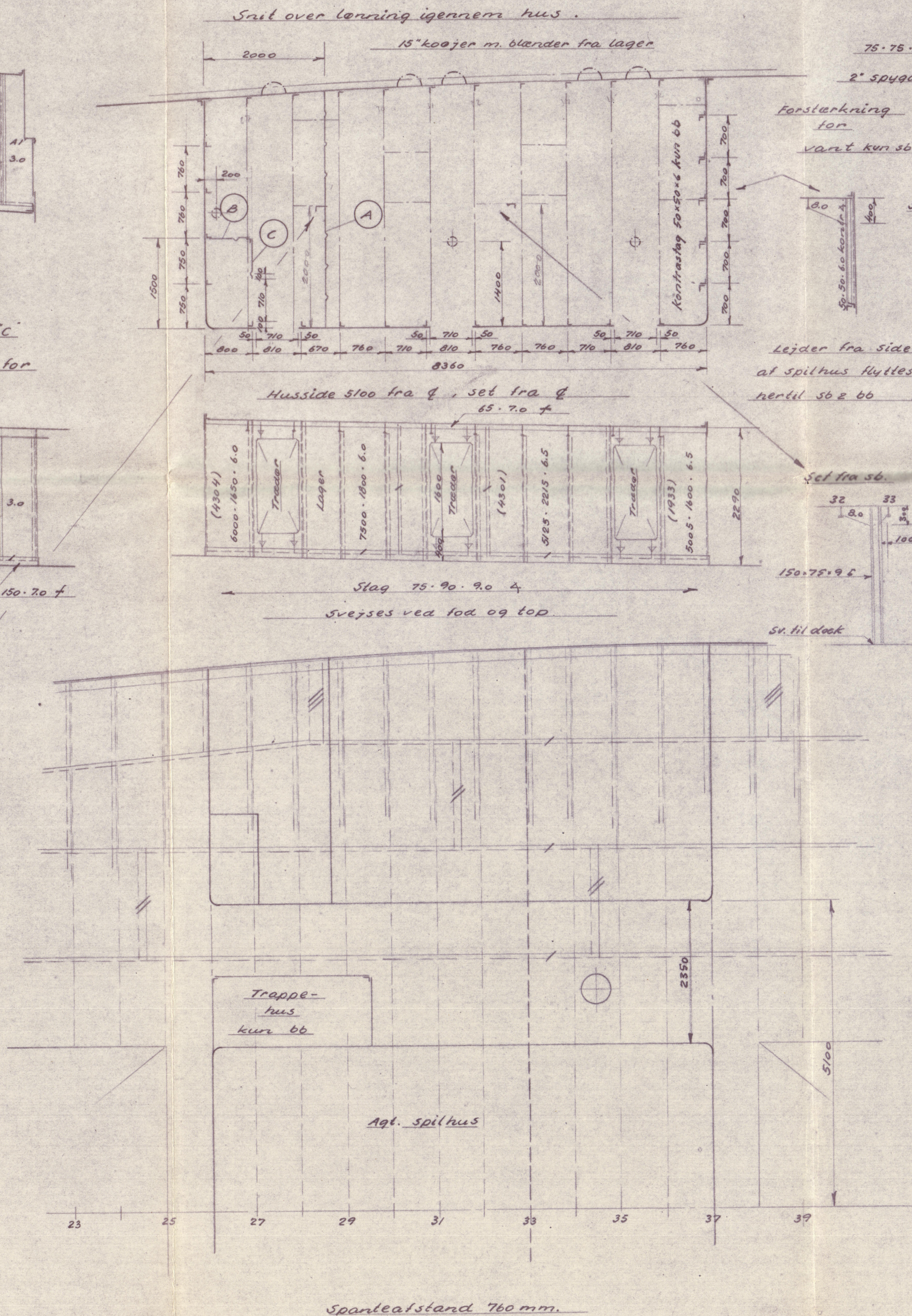
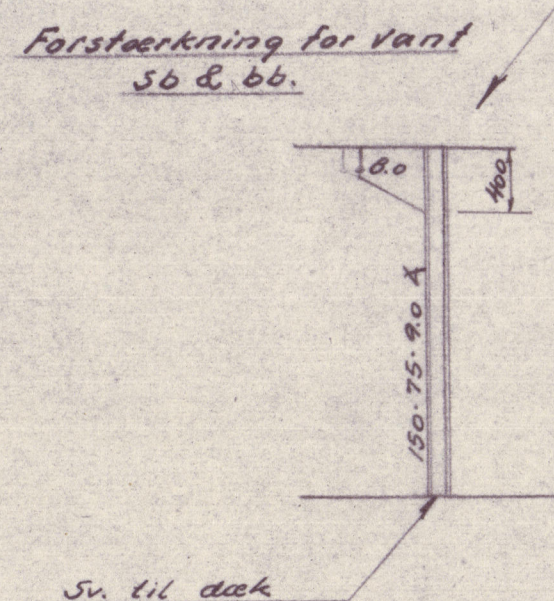
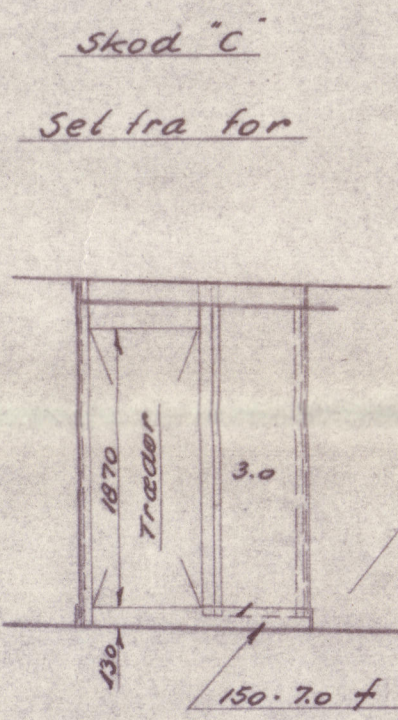
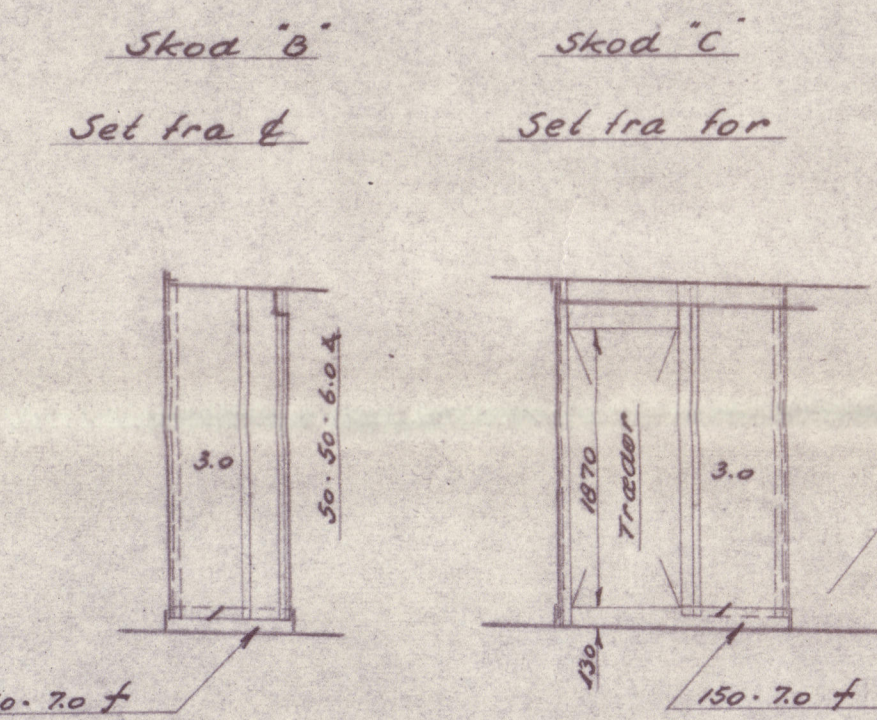
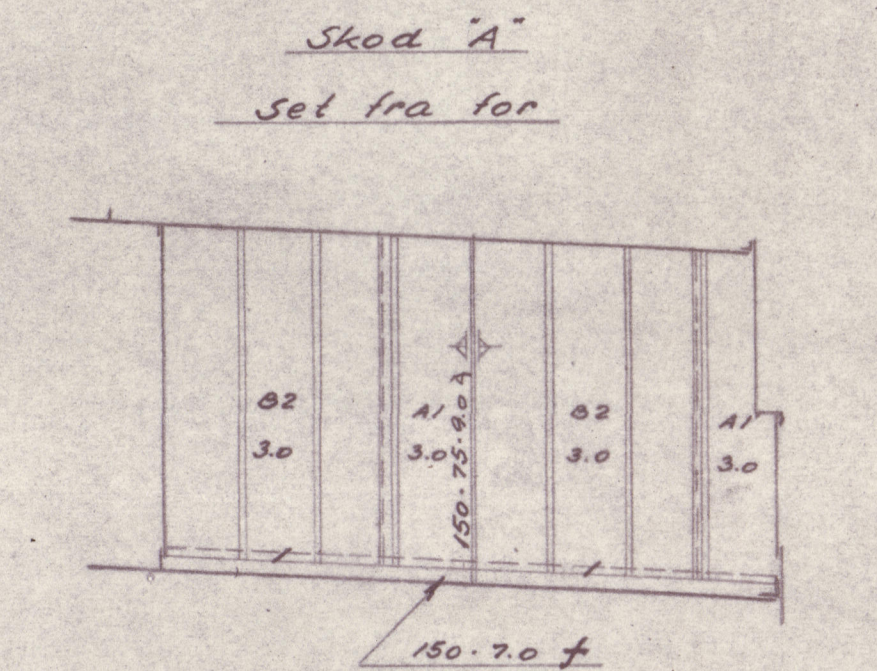
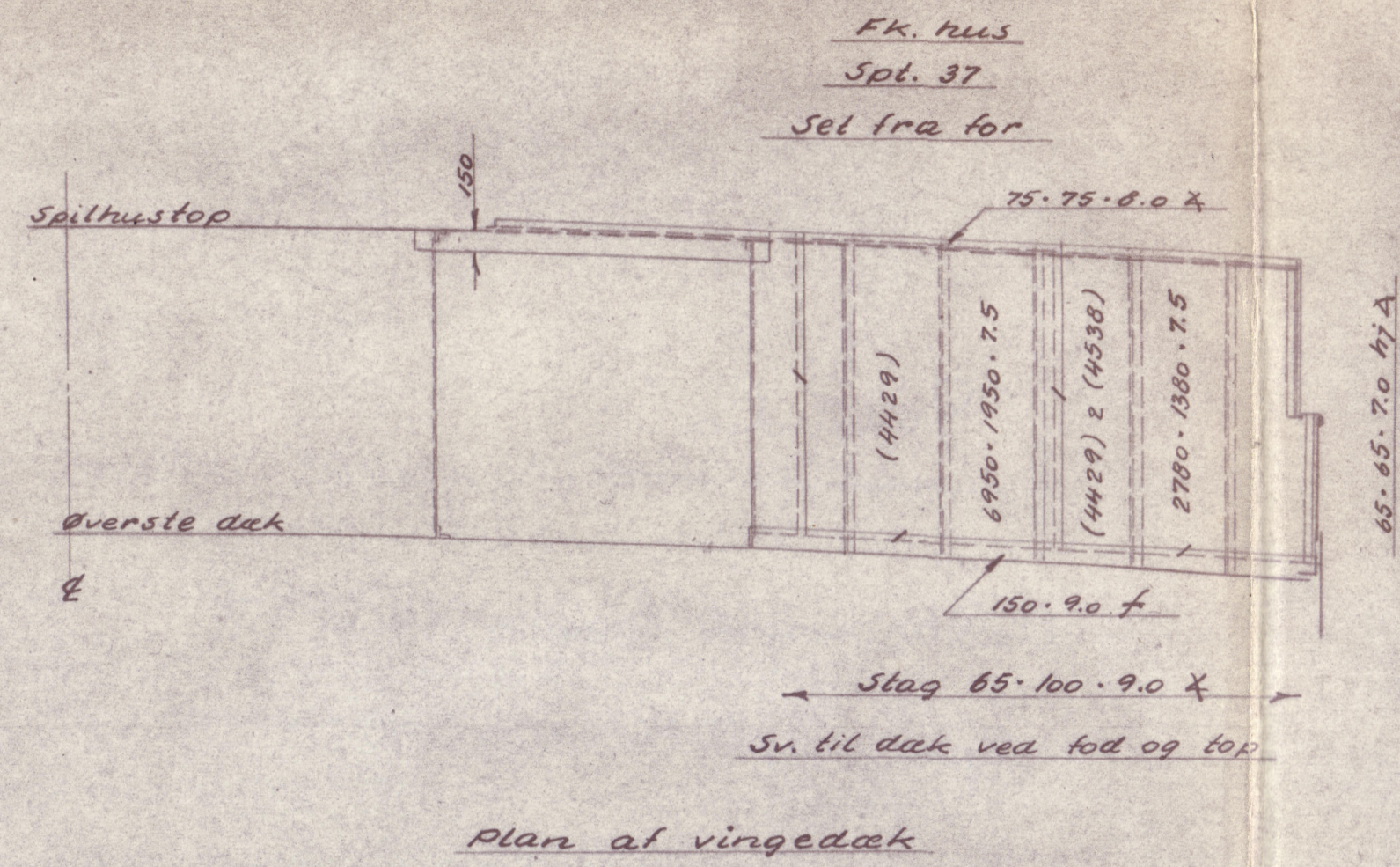
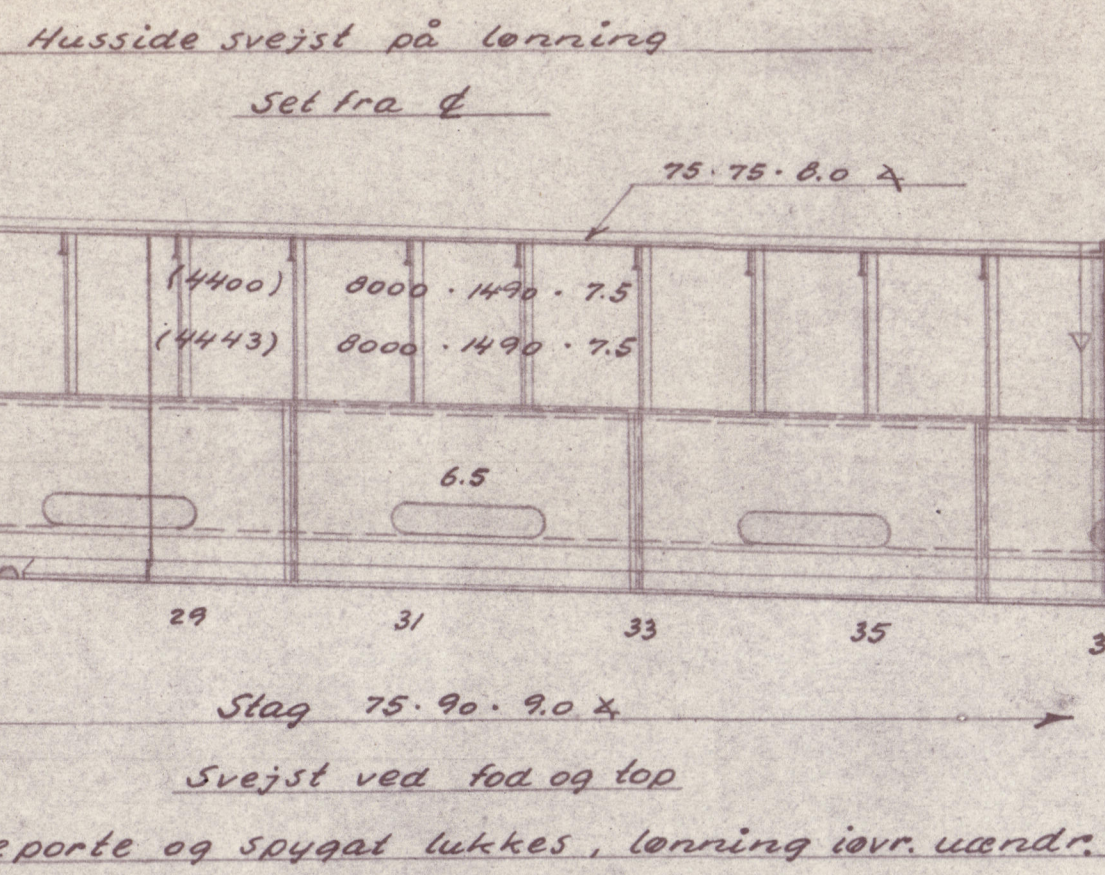
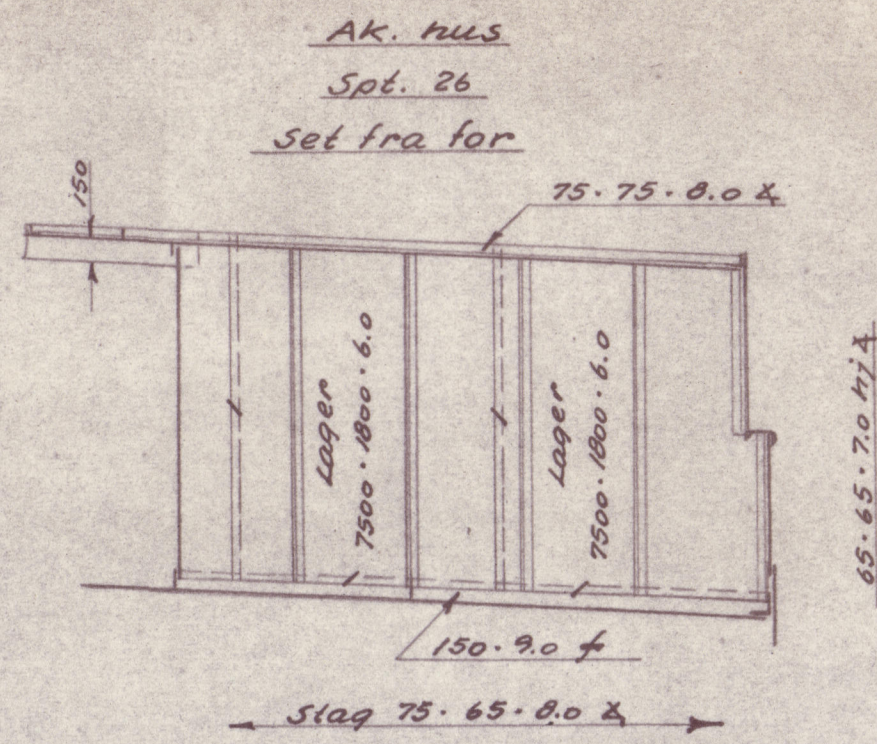
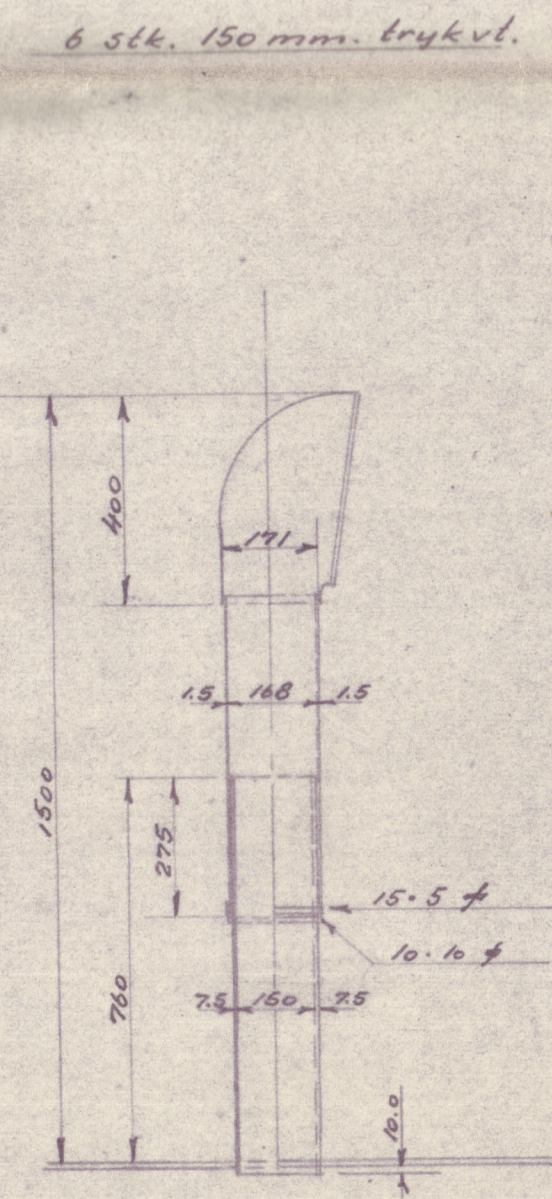

AKS NAKSKOV SKIBSVÆRFT
Dato 1/10-52 Indlæg til:
Lloyds Register

M/S "Jutlandia"

Msk.	Genskab	Ant.	Mat.	Msk. nr.	Ant.
Antikvariat	Nakskov Skibsværft				
1:50					
Huse og vingedæk					
agterste spilhus					

© 2021
R-592
Lloyds Register

"Jutândia".

Deck house frame 26 637.

Cpu. rept No. 13969.



© 2021

Lloyd's Register
Foundation