

Lloyd's Register of Shipping.

Ship's Name "PORT ALMA"

Official No. 160615

Memorandum of alterations reported since ship was surveyed for assignment of Load Lines in

The tonnage opening, the shelter tween deck freeing ports and overboard scuppers have been permanently closed at this time as a wartime measure. ✓

An additional scupper (P & S) has been fitted, leading to the Engine Room bilge. ✓

A small hatch has been fitted on the permanently closed tonnage opening.

2 - 11 x 2 - 3 x 25" coaming

fastened with hinged steel W. T. cover. ✓

Suitable provision has been made for rigging lifelines. ✓

Forcle. B'h'd:- $3\frac{1}{2}$ x 3 x 7/20. 24" apart. no end attachments.

openings in front-4 hinged steel doors operated from both sides 5' x 2' x 12" coaming

1 steel hinged W.T. door operated from both sides

4ft- 6" x 24" x 21" coaming

1 steel door in halves at end of alleyway - operated from both sides

5'-0" x 33" x 12" coaming.

Wood doors 4'-11" x 24" x 14" coaming.

Forcle. ~~62'~~ long. 7' - 6" beam to beam.
 57.5'

Distance from Fcle. front to Bridge House front and commencement of steel bulwark 102' steel bulwarks for 164'

3 freeing ports (P & S) in same:- 2 - 9 x 12" deep, 12" above deck.

with hinged shutters

& 1 protection bar.

The new freeboard deck is wood sheathed 3" thick. ✓

The amended tonnages are - 10240.20 gross tons. (Freeboard cert. copy amended.)
6399.24 net tons.

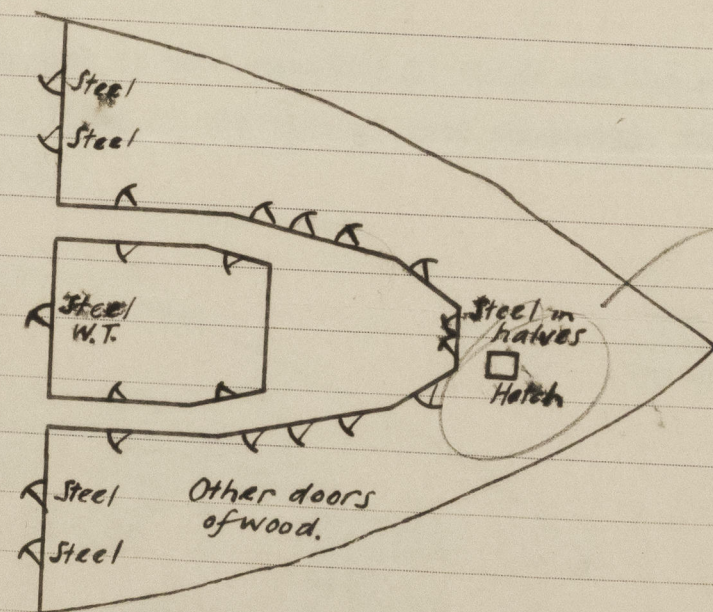

Only wood
hatch.

W. Robinson
Liv. 12/12/39

A copy of this information has been placed on the vessel on C11 (contd.)