

Lloyd's Register of Shipping.

SURVEYS FOR FREEBOARD.

(CONDITIONS OF ASSIGNMENT.)

Ship's Name "BURNSIDE"Port of Survey Glasgow.Official Number 165988Surveyor's Signature T.R. McIlwanna.Nationality and Port of Registry British "SUVA"Date of Survey May/1940.

Disposition and dimensions of superstructures, trunks, deckhouses and machinery casings to be inserted in the diagrams and tabular statement :-

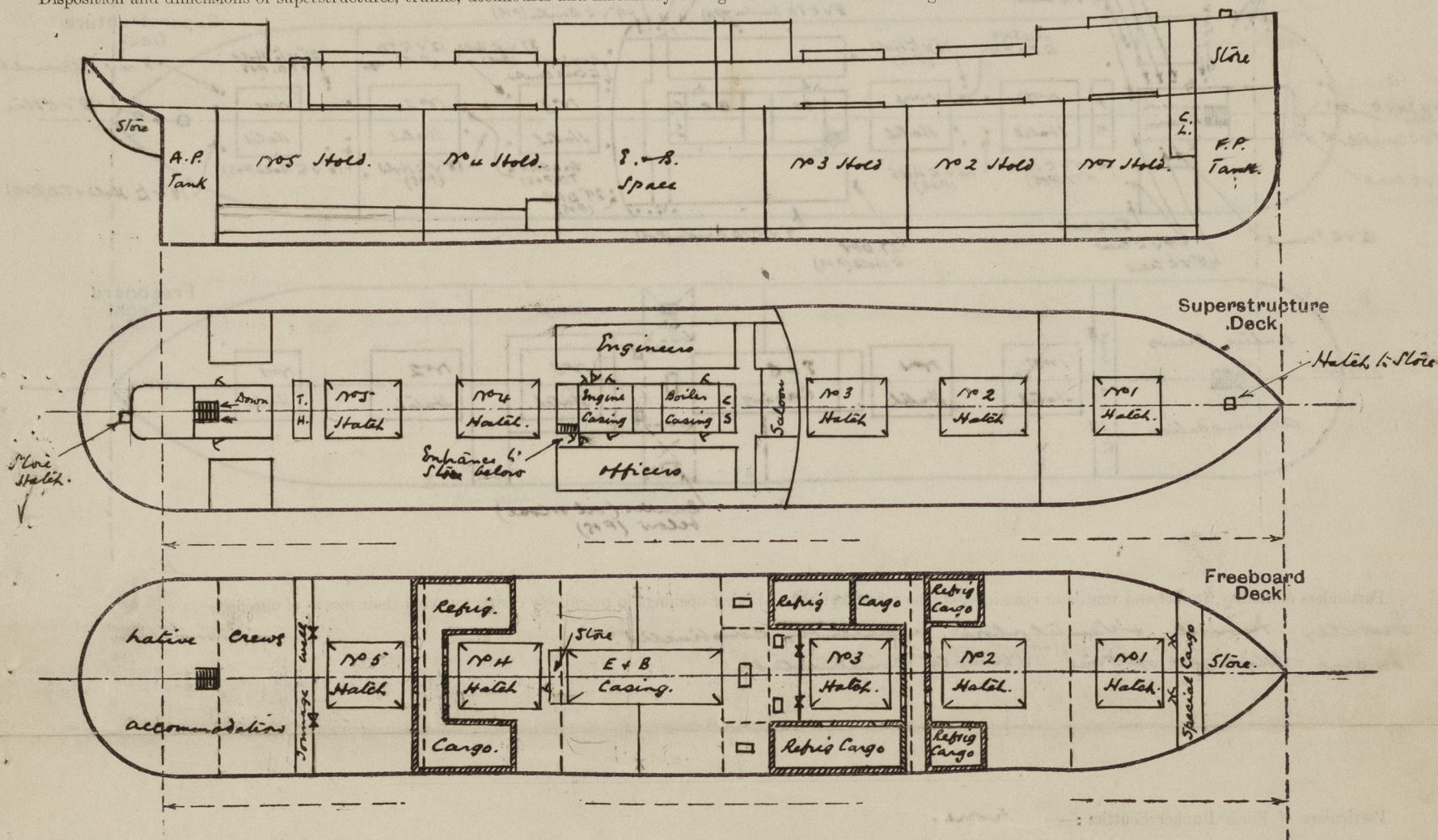

Particulars of Superstructures, Trunks, Casings, Deckhouses.								
	Coaming	Plating	Stiffeners	Spacing	End Attachments of Stiffeners	Size of Openings	Height of Sills	Height of Casings
Poop Bulkhead28	✓ .28	3½ x 2½ x .37	36"	Riveted 6" boundary bar	none	✓	10'-0" ✓
Raised Quarter Deck Bulkhead ...								
Bridge, After Bulkhead30	✓ .30	4 x 3 x .30	36"	- do.	4'-7" x 37"	18 ✓	10'-0" ✓
Bridge, Forward Bulkhead ...								
Forecastle Bulkhead (Bulkhead at break of shell deck)40	✓ .40	5 x 3 x .30	30"	Lugged.	none	✓	4'-0" ✓
Trunk, Aft ...	✓							
Trunk, Forward ...	✓							
Exposed Machinery Casings on Freeboard or Raised Quarter Decks ...	✓							
Exposed Machinery Casings on Superstructure Decks26 ✓	.26 ✓	3½ x 2½ x .33 ✓	31½" ✓	Riveted 6" boundary bar	5'-4" x 24"	15" ✓	8'-0" ✓
Machinery Casings within Superstructures not fitted with Class I Closing Appliances ...	" ✓	" ✓	" ✓	" ✓	"	none	✓ ✓	10'-0" ✓
Deckhouses on Flush Deck Ships ...	✓							

Particulars of Closing Appliances (state if capable of being manipulated from both sides).

Poop Bulkhead ...	none
Raised Quarter Deck Bulkhead ...	✓
Bridge, After Bulkhead ...	2½" wood sheathing boards full height in channels welded to Bhd. ✓
Bridge, Forward Bulkhead ...	✓
Forecastle Bulkhead (Bulkhead at break of shell deck) ...	✓ none.
Exposed Machinery Casings on Freeboard or Raised Quarter Decks ...	none.
Exposed Machinery Casings on Superstructure Decks ...	Steel Hinged door capable of manipulation from both sides. ✓
Machinery Casings within Superstructures not fitted with Class I Closing Appliances ...	none
Deckhouses on Flush Deck Ships ...	✓

Name of Ship

BURNSIDE

Freeboard Report Examined

(Date)

20 May 1957

Signed

[Signature]

0132 2/3

PARTICULARS OF PROTECTION TO OPENINGS, ETC.

The following diagrams should be used to indicate the positions of cargo and coaling hatchways, gangway, cargo and coaling ports, ventilators, companionways, etc., which would affect the seaworthiness of the ship:-

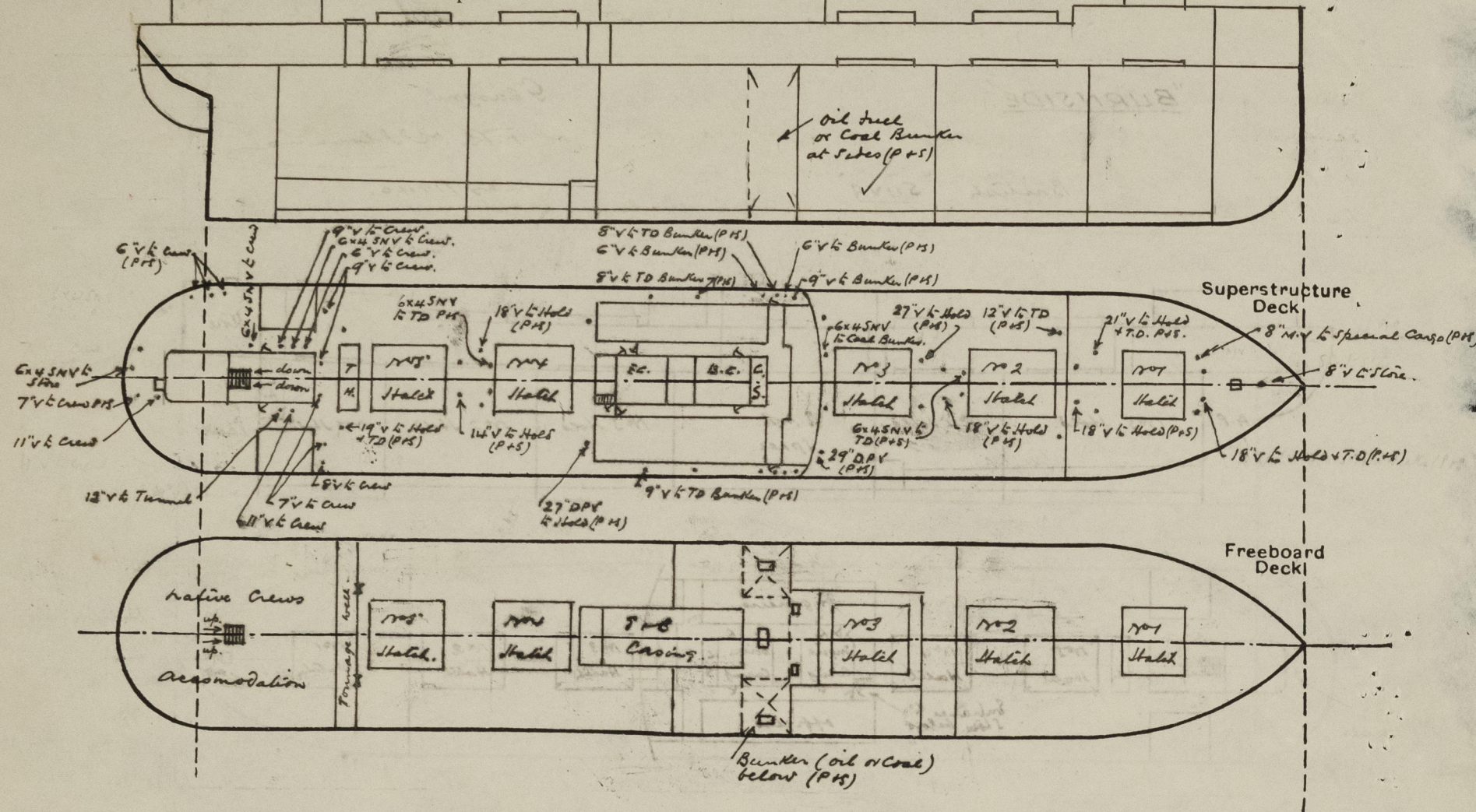

Particulars of fiddle, funnel and ventilator coamings, engine room skylight and other openings in machinery casing tops and their means of closing:-

Fiddle funnel ventilators efficiently constructed. ✓ Fiddle covers permanently attached.
Engine skylight of steel strongly constructed. ✓ Fiddle closing appliances

Particulars of Flush Bunker Scuttles:-

none. ✓

Particulars of Companionways:-

CREWS ENTRANCE AFTER DECKHOUSE - 2 Strong hinges bolt down 4' 6" x 2' 6" operated from both sides Coaming 15" x 28" ✓
MIDSHIP HOUSE - SHELTER DECK
2 " " " 5' 2" x 2' 6" " " " 15" x 32 ✓
2 " " " 5' 2" x 2' 6" " " " 15" x 32 ✓
1 " " " 5' 2" x 2' 6" " " " 15" x 32 (1/5 Gls) Portside ✓

Particulars of Ventilators in exposed positions on freeboard and superstructure decks:-

RAISED SHELTER DECK:-

1 @ 21" dia (P.H.) Coaming 11' 6" x 50 (Flayed) D.P.V. 4' 10" Hols. ✓
1 @ 18" " " 7' 6" x 40 " 1/2 No 2 Hols. ✓
1 @ 18" " " 36" x 40 " 1/2 No 1 Hols. ✓
1 @ 8" " " 36" x 30 " 1/2 Special Cargo ✓
1 @ 8" " " 36" x 30 " 4 Stie. ✓

SHELTER DECK:-

1 @ 12" dia (P.H.) Coaming 7' 6" x 34 (Flayed) 4' Turn Deck ✓
1 @ 18" " " 11' 6" x 50 " 1/2 No 2 Hols. ✓
1 @ 27" " " 33' 7" x 80 " D.P.V. 4' No 3 Hols. ✓
1 @ 29" " " 34' 11" x 80 " " " " " ✓
1 @ 9" " " 30" x 32 " 1/2 Coal Bunker ✓
2 @ 6" " " 30" x 30 " " (over) ✓
2 @ 8" " " " " " " " ✓

SHELTER DECK (Contd)

1 @ 9" dia (P.H.) Coaming 30" x 32 4' Turn Deck ✓
1 @ 27" " " 34' 3" x 70 (Flayed) D.P.V. 4' No 4 Hols. ✓
1 @ 18" " " 11' 6" x 50 " " " " ✓
1 @ 14" " " 7' 6" x 36 " " " " ✓
1 @ 19" " " 30" x 40 " 1/2 No 5 Hols. ✓
4 @ 6" " (A) 30" x 30 " 4' Crew ✓
1 @ 7" " " 30" x 30 " " " " ✓
3 @ 9" " " 30" x 32 " " " " ✓
4 @ 6" " (S) 30" x 30 " " " " ✓
2 @ 7" " " 30" x 30 " " " " ✓
1 @ 8" " " 30" x 30 " " " " ✓
2 @ 11" " " 30" x 34 " 1/2 Tunnel ✓
1 @ 12" " " 30" x 34 " " " " ✓
1 @ 5" x 5" " 30" To twin decks 4' Crew spaces ✓
All Ventilators are fitted with wood Plugs + Canvas covers. ✓

Particulars of Air Pipes in exposed positions on freeboard, raised quarter, or superstructure decks:-

RAISED SHELTER DECK.

1 @ 4" dia (P.H.) 4' No 2 DB Tank 18" 4' lip ✓
1 @ 4" " 4' For Peak 18" 4' lip ✓
1 @ 4" " (S) 4' No 1 DB Tank 18" 4' lip ✓

SHELTER DECK:-

1 @ 2 1/2" dia (P.H.) 4' No 2 DB Tank 18" 4' lip ✓
1 @ 4" " " No 3 " " " " ✓
1 @ 2 1/2" " " " " " " " ✓
1 @ 4" " " " " " " " ✓
1 @ 3" " " " " " " " ✓
1 @ 2 1/2" " " " " " " " ✓
1 @ 3 1/2" " " " " " " " ✓
2 @ 3 1/2" " " " " " " " ✓

SHELTER DECK (Contd)

3 @ 2 1/2" dia 4' For Tanks, C/Dam 18" 4' lip ✓
2 @ 3" dia (P.H.) 4' No 6 DB Tank " " " ✓
1 @ 2 1/2" " 4' DB C/Dam " " " ✓
1 @ 3" " 4' No 7 DB Tank " " " ✓
1 @ 3" " 4' For Peak " " " ✓
1 @ 3" " (P) Ruston Tank " " " ✓
1 @ 3" " (P) Lub oil Tank " " " ✓
All Air pipes fitted with wood Plugs or Canvas covers. ✓

Particulars of Gangway Cargo and Coaling Ports:-

Burnside.

Particulars of Scuppers and Sanitary Discharge Pipes:-

Scuppers & sanitary discharges from spaces on freeboard deck led overboard & fitted with strain valves at ship's side. ✓ 5" Scuppers in Tonnage well operated from shelter deck. ✓
No scuppers or discharges from spaces below freeboard deck.

Particulars of Side Scuttles:-

All sidelights of substantial construction fitted with shut hinges deadlights. ✓

Vertical distance of Sill of lowest Side Scuttle above top of keel

36' 3" ✓

Particulars of Guard Rails:-

SHELTER DECK. Rails 3' 10 1/2" & 3' 6" high 3 Rods Transverse spaces about 4' 6" apart. ✓

Particulars of Gangways, Lifelines, etc.:-

none. ✓

Particulars of Freeing Arrangements.

	Length of Bulwark	Height of Bulwark	Size of Freeing Ports	Number each side	Area each side	Rule area each side
Tonnage After Well	✓	5" Searies Valve fitted (P.H.) in Tonnage well				
Forward Well			Operated from deck above			

State position of each freeing port ... (After Well:-

(F. and A. position and height above deck edge) (Forward Well:-

State whether the freeing ports are fitted with shutters, bars, or rails, and give particulars of such:-

Additional area where sheer is less than standard.

PARTICULARS OF PROTECTION TO OPENINGS, ETC.

HATCHWAYS ON FREEBOARD AND SUPERSTRUCTURE DECKS.											
← FREEBOARD DECK →						← SHELTER DECK →					
Description of Hatchway	No. 1	No. 2 & 4	No. 5	No. 1	No. 2	No. 3	No. 4	No. 5	Journey Hatch	Coal Hatch	Boat deck
Dimensions of Hatchway	22'-6" x 24	31'-2" x 24	23'-5 1/2" x 24	22'-6" x 24	31'-3" x 24	31'-3" x 24	31'-3" x 24	23'-5 1/2" x 24	5'-2 1/2" x 24	7'-6" x 17'-6"	
COAMINGS											
Height above Deck	9" BA	9" BA	9" BA	30	30	30	30	30	9" BA	9	
Thickness	.48	.48	.40	.44	.44	.44	.44	.44	.45	.40	
Sides	✓	✓	✓	✓	✓	✓	✓	✓	✓	✓	
Ends	✓	✓	✓	✓	✓	✓	✓	✓	✓	✓	
Stiffeners	7x3x36 BA	7x3x36 BA	7x3x36 BA	7x3x36 BA	7x3x36 BA	7x3x36 BA	7x3x36 BA	7x3x36 BA	7x3x36 BA	7x3x36 BA	
Brackets, Stays	2	2	2	2	2	2	2	2	2	2	
HATCH BEAMS											
Number	4	5	4	4	5	5	5	4		3	
Spacing	4'-6"	5'-2 1/2"	4'-8 1/4"	4'-7"	5'-3 1/8"	5'-3 1/8"	5'-3 1/8"	4'-9 1/4"		3'-9"	
Scantling and Sketch	23 1/2 x 40	21 1/2 x 38	19 1/4 x 37	18 3/4 x 38	15 1/2 x 38	15 1/2 x 38	15 1/2 x 38	14 1/2 x 34		13 x 38	
	6 x 3 1/2 x 50 double angles top & bottom			5 x 3 1/2 x 46 double angles top & bottom						4 x 5 x 38 double angles top & bottom	
Bearing Surface	3	3	3	3	3	3	3	3	✓	3	
FORE AND AFTERS											
Number											
Spacing											
Unsupported Lengths											
Scantling* and Sketch											
Bearing Surface	✓	✓	✓	✓	✓	✓	✓	✓	✓	✓	
HATCH COVERS											
Material	WP			WP						WP	
Thickness	2 3/8			2 3/8						2 3/8	
How fitted	F & A			F & A						F & A	
Bearing Surface	3			3						3	
Spacing of Cleats	24			24	24	24	24	24	✓	24	
Number of Tarpaulins	1			3	2	2	2	2	✓	3	

*Are wood fore and afters steel shod at all bearing surfaces? ☒ Yes

Are battens and wedges efficient and in good condition? ☒ Yes

Are tarpaulins in good condition and in accordance with rule requirements? ☒ Yes

Are lashings provided in accordance with rule requirements? ☒ Yes

Particulars of any special features:—

COAL HATCHES TO HOLD (FBD DECK)

2 @ 4'-7 1/2" x 6'-0" 9" B.A. Coaming
 .30 Steel cover secured by Toggles.

COAL HATCH FORE END CASING (FBD DECK)

5'-2 1/2" x 10'-0" 9" B.A. Coaming
 2 3/8 W.P. Covers 3" rest angle cleats 24" apart 1 Tarpaulin

O.T. HATCHES TO SIDE BUNKERS (FBD DECK)

2 @ 7'-6 3/4" x 4'-0" 9" angle coaming welded to deck
 .44 Steel cover secured by bolts 3 1/2" apart.

HATCH TO STORE AFT (SHELTER DECK)

1 @ 2'-6" x 2'-0" 30" x .44 Coaming
 2 3/8 W.P. Cover 3" rest angle
 Cleats 34" apart 2 Tarpaulins.

HATCH TO STORE FOR (SHELTER DECK)

1 @ 4'-0" x 2'-6" 30" x .44 Coaming
 .44 Steel cover secured by Toggles.

Endorsement at first survey and at surveys for renewal of Certificate:—

The fittings and appliances are in accordance with the particulars shown on this form (or as now modified) and are in good condition.

Full Displacement at 25'-0" draft = 12807 Tons T.P.I. = 48.
 " " " 26'-0" " = 13385 " T.P.I. = 48.36

Freeboard application (Reg 9) enclosed.
 Midship Section & Profile enclosed for reference.
 Plan of Sheers & Tween deck height enclosed.



© 2020

Lloyd's Register Foundation