

Coperchio tuga timoneria

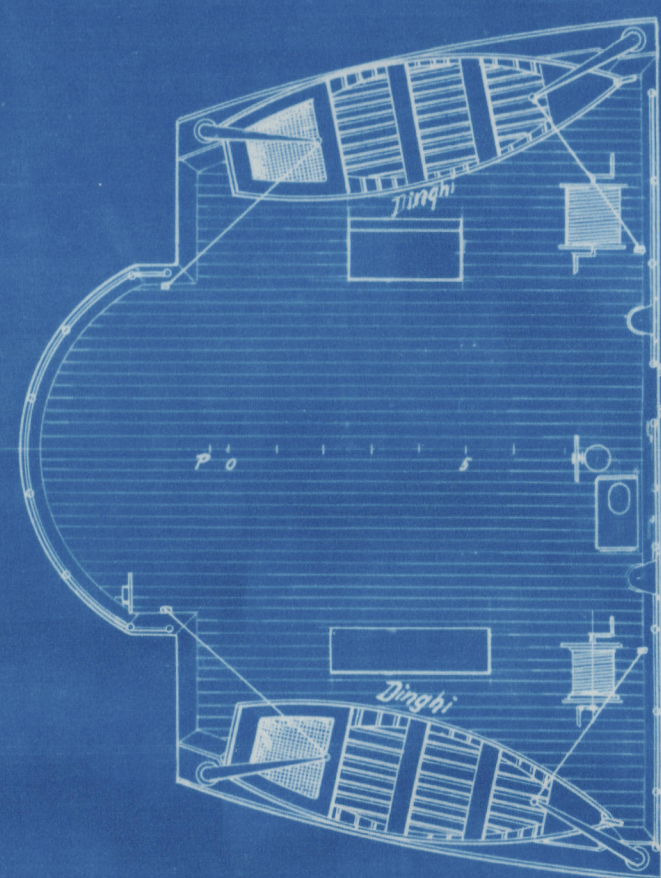

Coperchio tuga radiotelegrafica

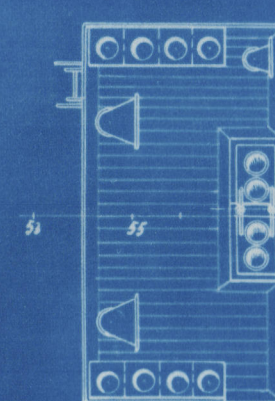

Coperta imbarcazioni

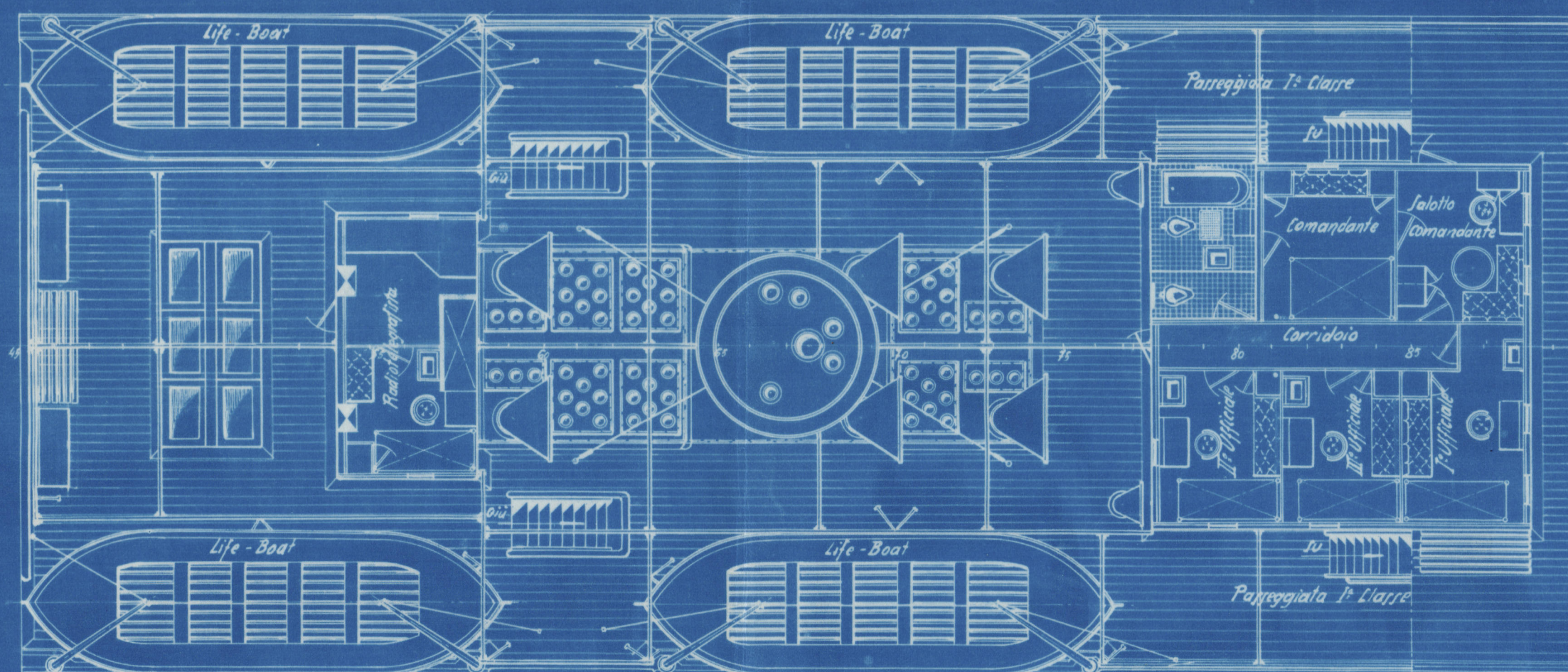

Ponte di Comando

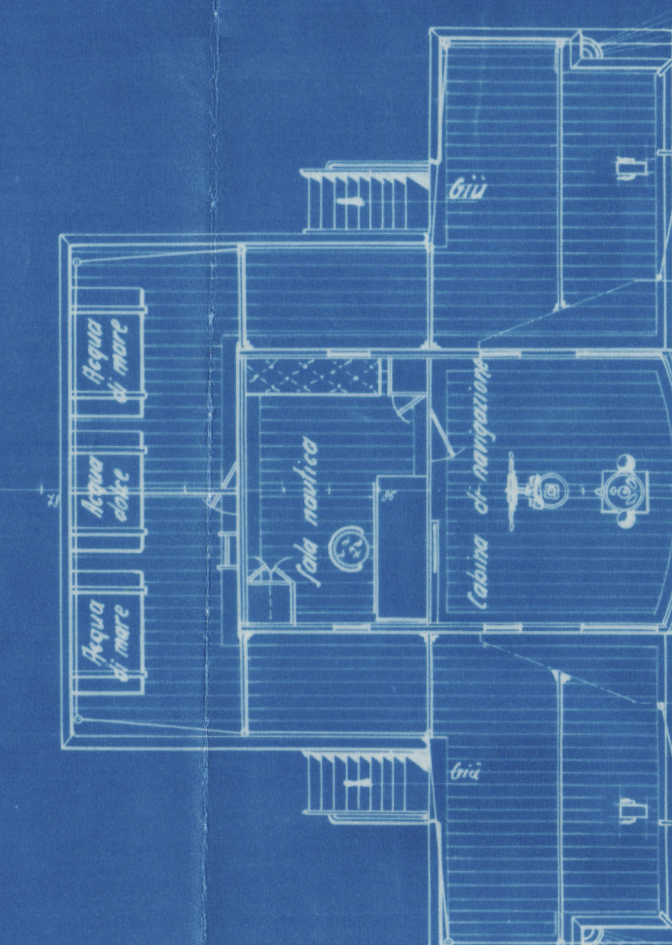

Coperchio tuga pilotaggio

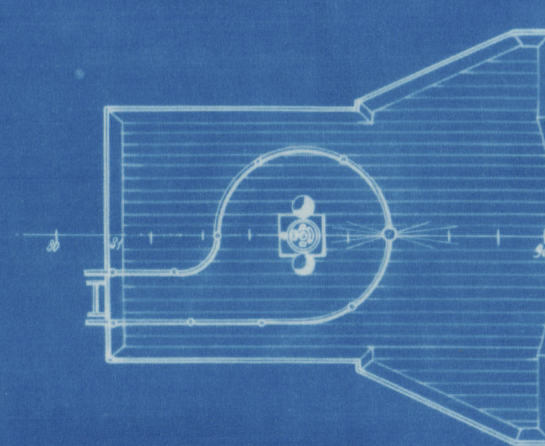

COSTRUZIONE N° 191 e 193

PUCCINI - VERDI

PER L'ADRIA SOCIETÀ ANONIMA DI NAVIGAZIONE MARITTIMA
FIUME

MOTONAVI DA CARICO E PASSEGGERI

Scala 1/800

Sezione longitudinale

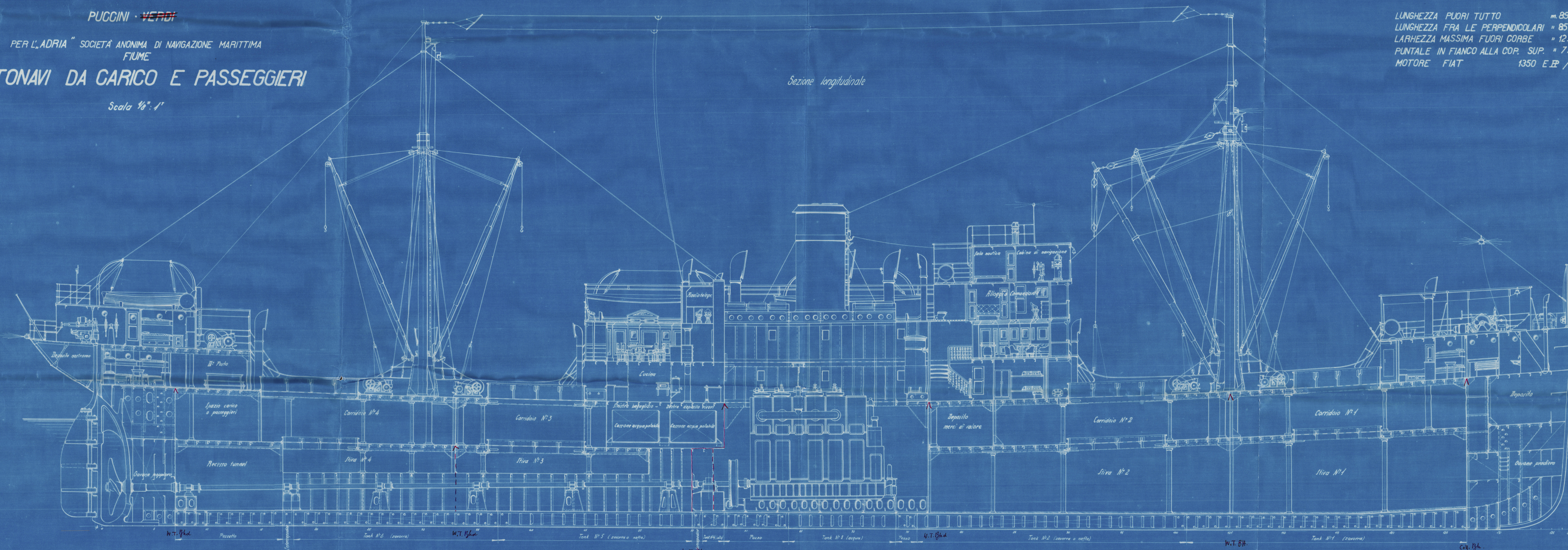

DIMENSIONI PRINCIPALI

LUNGHEZZA FUORI TUTTO m. 89.611
LUNGHEZZA FRA LE PERPENDICOLARI " 85.344
LARGHEZZA MASSIMA FUORI CORBE " 12.192
PUNTALE IN FIANCO ALLA COP. SUP. " 7.112
MOTORE FIAT 1350 E.P. /125 rot.

Coperta Carrara Poppiera

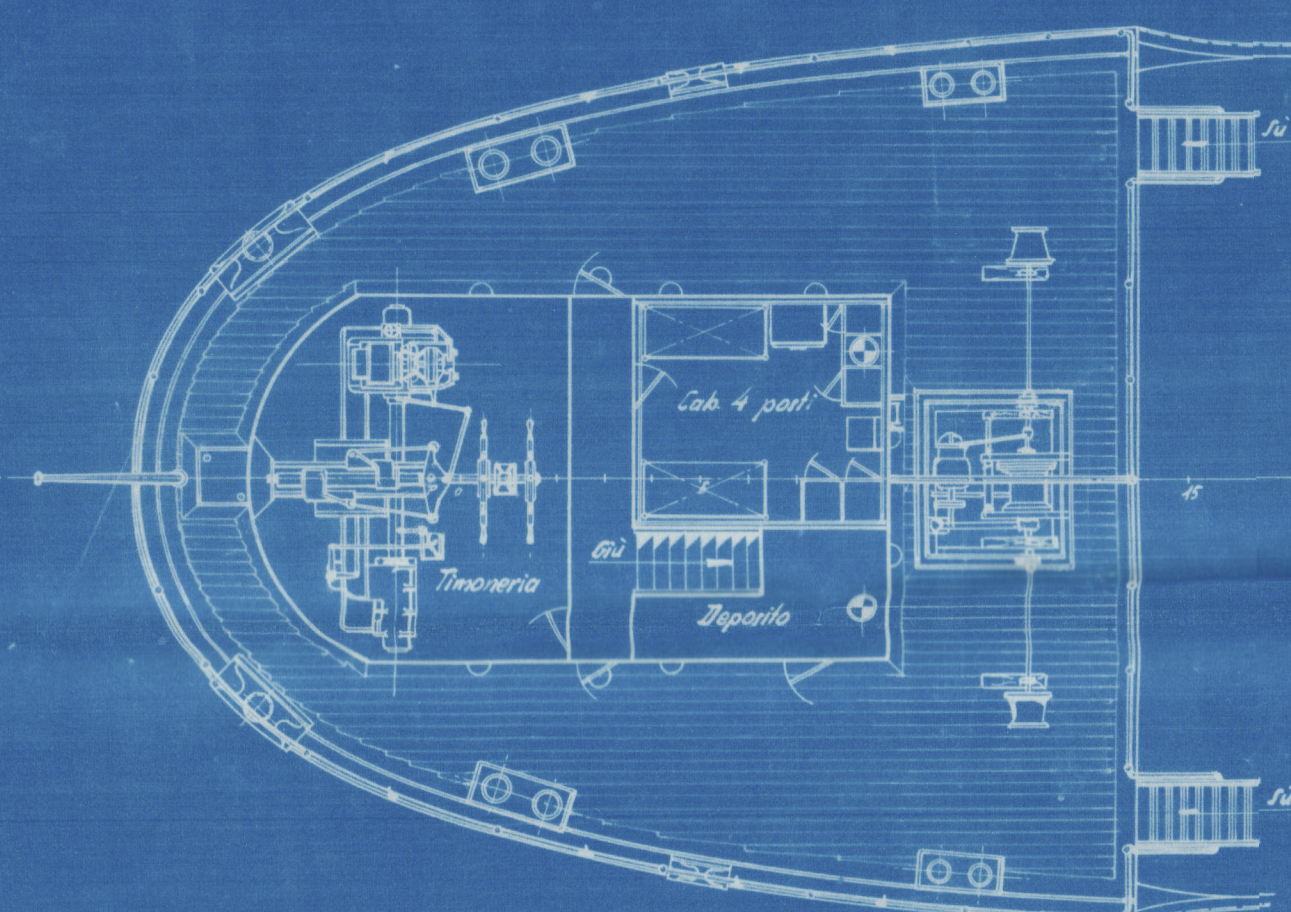

Coperta Carrara Centrale

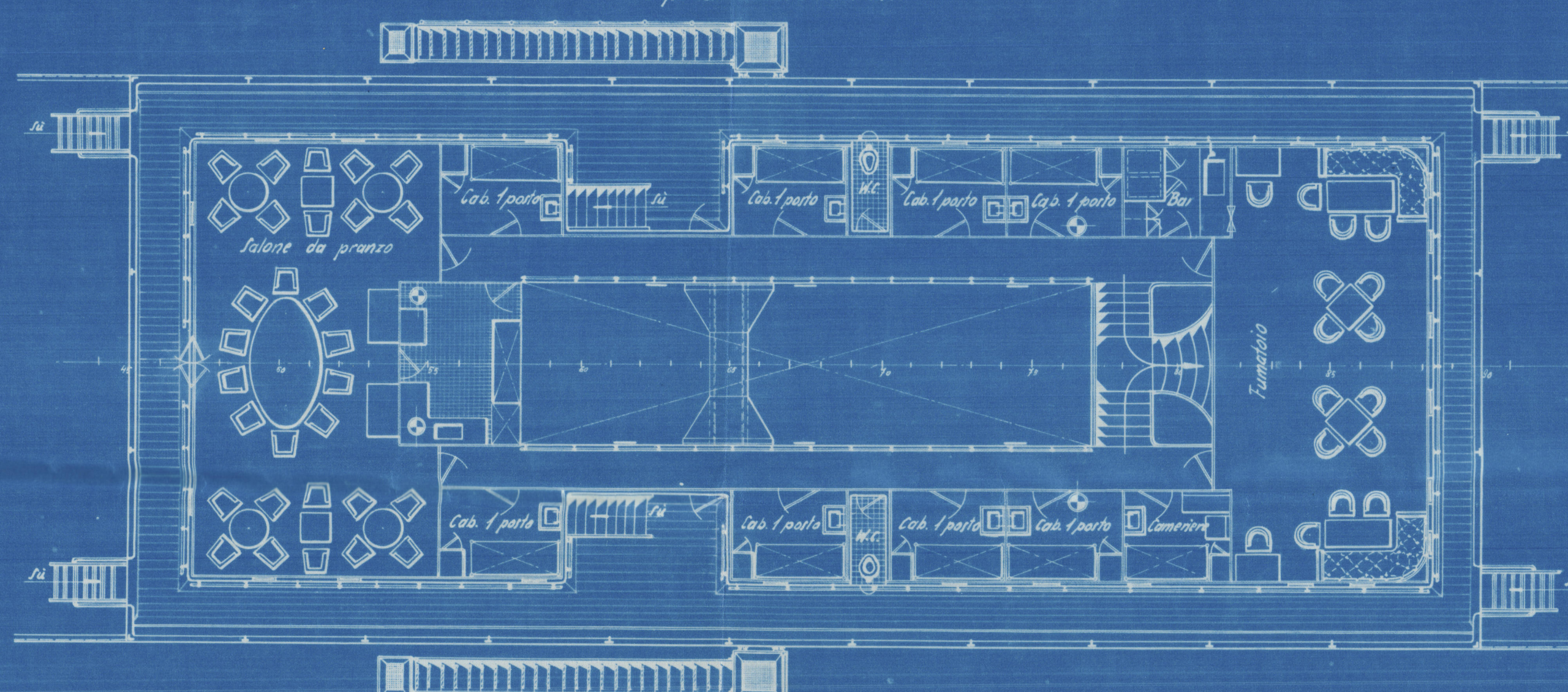

Coperta Castello

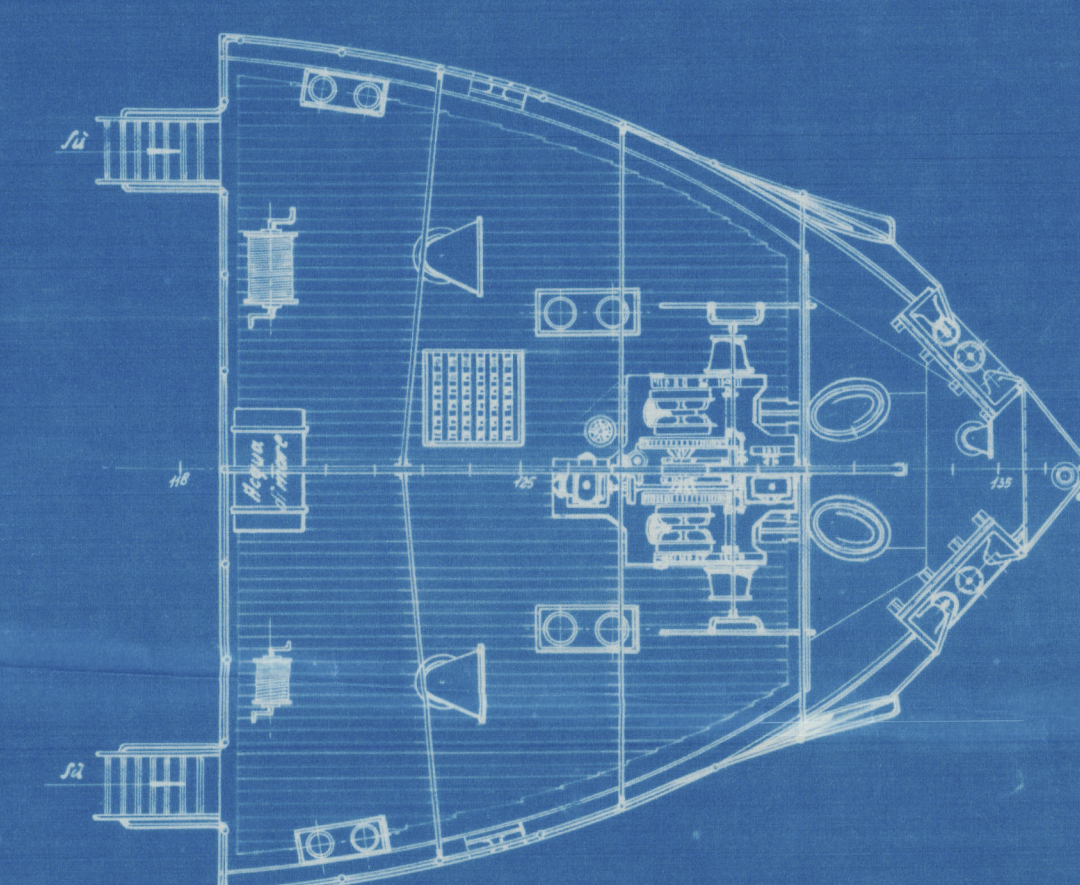

Cantiere Navale Trastevere 1901-1903

Lloyd's Register
Foundation

000216-000304-0003

C. N. T. No 191

M. V. Puccini
Trieste Rpt. No 8077

General arrangement
(Profile & Superstructure Details)

f



© 2020

Lloyd's Register
Foundation

008296-008304-0003