

# Lloyd's Register of Shipping.

Ship's Name "BOTHNIA"

Official No. 160475

Memorandum of alterations reported since ship was surveyed for assignment of Load Lines  
in \_\_\_\_\_  
\_\_\_\_\_ and  
Gunner's Accommodation in aft of Bridge Space.

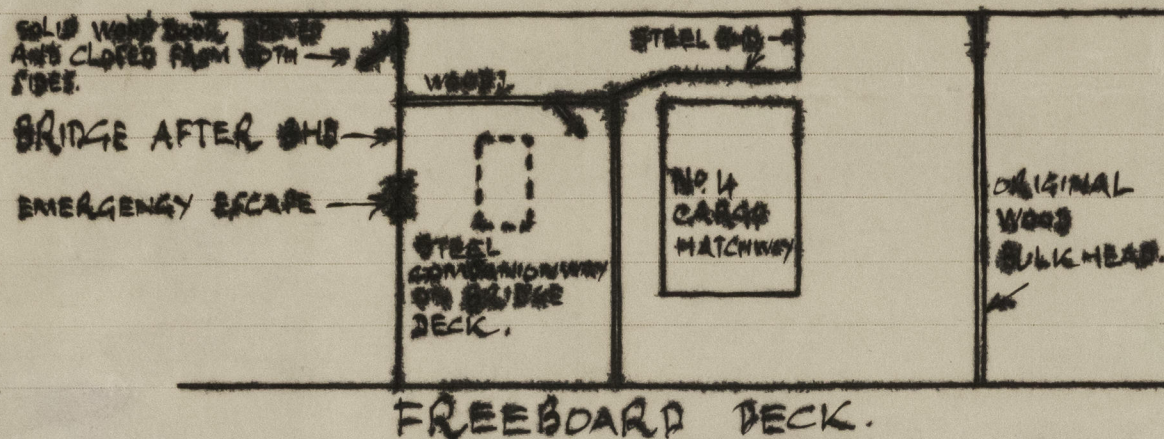

Sidescuttles in bridge sides in way of accommodation fitted with hinged deadlights.

Overboard discharges from wash hand basins and W.C.'s fitted with automatic non-return valves.

Ventilators in bridge deck, mushroom type with W.T. screw-down tops.

Steel companionway on bridge deck, strongly constructed, fitted with wood door closed and secured from both sides, sill 18" high.

Original openings for stormboards in Bridge after bulkhead permanently closed by riveted plates.

Emergency escape fitted with steel plate secured by four strongbacks.

Additional Accommodation in No. 1 tween decks (Between F.P. BHD. and new steel bhd., 7ft. spaces aft.)

Entrance to this accommodation is by two small hatchways in freeboard deck inside forecastle. Coamings 9" high, fitted with hinged steel W.T. covers closed and secured from both sides.

Sidescuttles, 9" in diameter, fitted between frames 9 and 10, 11 and 12, 13 and 14 from forward; provided with hinged deadlights. Sill of sidescuttles 21" below freeboard deck.

Two mushroom type ventilators fitted on forecastle deck; fixed tops, provided with canvas cover.

Closing appliances in openings in end bulkheads of the superstructures are now as follows

Forecastle. Hinged steel doors and hinged wood doors.

Bridge, fore end. Hinged steel doors with through bolts.

Bridge, aft end. Hinged wood door.

Load Line Certificates amended accordingly.

