

Lloyd's Register of Shipping.

Ship's Name "RADFIELD"

Official No.

Memorandum of alterations reported since ship was surveyed for assignment of Load Lines in

The steel doors at poop bulkhead which were operated from outside only have now been permanently closed by electrowelding.

Strongly constructed companionway of steel built on poop deck (S.S) giving access to accommodation below, having strong hinged wood door 0.D.S. sill 18 high.

One additional lavatory fitted having discharge led overboard thro storm valve at ship's side above upper deck.

The forecastle front has been amended as shown below.

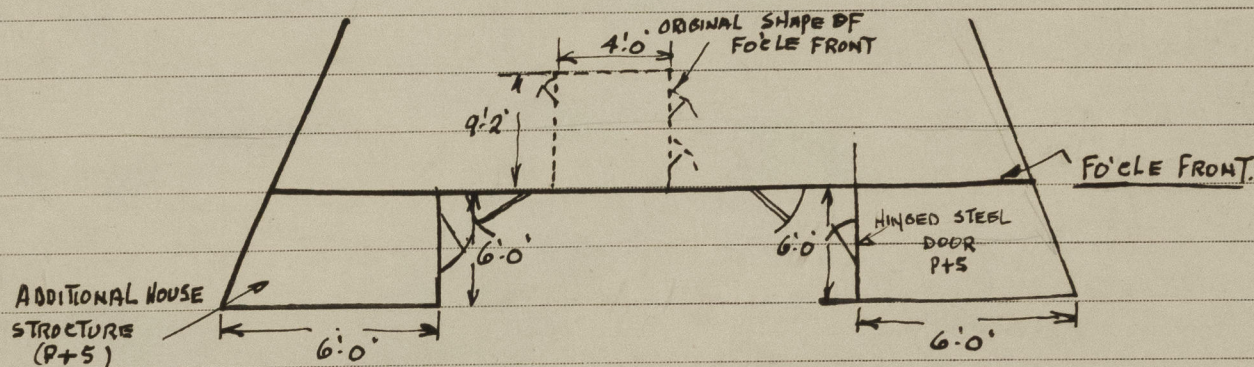

The original recess in bulkhead now removed and bulkhead plated across having 2 stronghinged wood doors 4'8" x 21" O.D.S. sill 19" high.

H. Little
Lloyd's Register of Shipping
Newcastle.

6/11/46