

## CAPACITIES OF HOLDS

COMPARTMENTS	FRAMES	GROSS CUBIC FEET MEASURED TO TOP OF BEAMS & INSIDE SMELL	NETT CUBIC FEET MEASURED TO TOP OF BEAMS & INSIDE CARGO BATTENS	BALE CUBIC FEET MEASURED TO BOTTOM OF BEAMS & INSIDE CARGO BATTENS
Nº 1 HOLD	113-137	41,880	38,630	36,680
Nº 1 TWEEN DECK	113-137	23,850	22,370	21,680
Nº 2 HOLD	82-113	95,850	93,180	89,440
Nº 2 TWEEN DECK	82-113	53,330	51,600	49,090
Nº 3 HOLD	74-82	23,530	22,990	20,780
Nº 3 TWEEN DECK	74-82	13,380	13,020	12,050
DEEP TANK	48-57	24,470	23,340	20,160
Nº 4 HOLD	27-48	57,980	56,210	53,620
Nº 4 TWEEN DECK	27-57	52,970	51,370	48,340
Nº 5 HOLD	9-27	29,360	26,630	24,820
Nº 5 TWEEN DECK	4-27	30,140	28,900	26,810
FORECASTLE	113-STEM	21,220	20,970	18,600
Nº 1 BRIDGE SPACE	75-113	49,140	48,130	44,860
Nº 3 " "	47-57	11,130	10,430	9,380
POOP SPACE	12-26	16,640	16,470	14,690
<b>TOTAL</b>		<b>544,870</b>	<b>524,240</b>	<b>491,000</b>
Nº 2 BRIDGE SPACE	57-75	17,230	16,720	15,300
POOP SPACE	11-12	1,000	1,000	1,000
<b>GRAND TOTAL</b>		<b>563,100</b>	<b>541,960</b>	<b>507,300</b>

NOTE: TRUNKS AND HATCHWAYS ARE INCLUDED IN THE  
COMPARTMENTS WHICH THEY FEED

## CAPACITIES OF BUNKERS

COMPARTMENTS	FRAMES	TONS @ 4.5 CU FT
MAIN TWEEN DECK (PORT)	57-75	172
" " " (STARBOARD)	57-75	188
LOWER POCKET BUNKERS (P&S)	67-74	106
COAL SHOOT (P&S)	74-75	8
<b>TOTAL PERMANENT</b>		<b>474</b>
Nº 3 HOLD	74-82	510
Nº 3 TWEEN DECK	74-82	288
Nº 1 BRIDGE SPACE	75-113	1,044
Nº 3 " "	47-57	236
COAL TRUNK	65-67	38
<b>TOTAL RESERVE</b>		<b>2,116</b>
IF REQUIRED FURTHER COAL SPACE IS AVAILABLE IN Nº 2 BRIDGE SPACE WHICH MUST BE CLEAR WHEN PASSING THROUGH THE SUEZ CANAL	57-75	326
<b>TOTAL PERMANENT &amp; RESERVE</b>		<b>2916</b>

CAPACITY PLAN.  
S.S. "RYDAL HALL"

S.S. "CITY OF KHIOS."

Scale 1/16" = 1 Foot.

## DIMENSIONS

LENGTH (EXTREME)	417' 5"
LENGTH (B.P.)	400' 0"
BREADTH (EXTREME)	54' 11 3/4"
BREADTH (MOULDED)	54' 9"
DEPTH (EXTREME)	32' 2"

## TONNAGES

	BRITISH	SUEZ CANAL	PANAMA CANAL
GROSS	5580.30	6483.67	6798.60
UNDER DECK	5283.23	5283.23	5348.37
NETT	3551.42	5118.61	5173.49

## MANCHESTER CANAL

HEIGHT OF BRIDGES ABOVE CANAL	73' 0"
LIGHT LINE, DOUBLE BOTTOM FULL, DEEP TANK EMPTY	11' 0"
HEIGHT OF CHIMNEY (PERMANENT PART) ABOVE LIGHT LINE	73' 0"
DETACHABLE TOP ON CHIMNEY	14' 6"

## DEADWEIGHT

SUMMER DRAFT	9610 TONS ON 27' 1/4"
WINTER " "	9335 " 26' 7/4"
AVERAGE DISPLACEMENT	42.52 TONS PER INCH
LIGHT DRAFT- 10' 6" AFT. 6' 0 1/2" FOR?	

## CAPACITIES OF WATER BALLAST

COMPARTMENTS	FRAMES	WATER @ 35 CU FT	FRESH WATER
Nº 1 TANK	113-137	97	
Nº 2 "	82-113	357	
Nº 3 "	72-82	119	
Nº 4 " CENTRE WATERTIGHT DIVISION	66-73		86
Nº 5 "	58-66		101
Nº 6 "	33-58	274	
Nº 7 "	17-33	76	
<b>TOTAL</b>		<b>923</b>	<b>187</b>
DEEP TANK	48-57	726	
<b>GRAND TOTAL</b>		<b>1649</b>	<b>187</b>

## FRESH WATER

2 PORTABLE TANKS IN BRIDGE SPACE-18 TONS

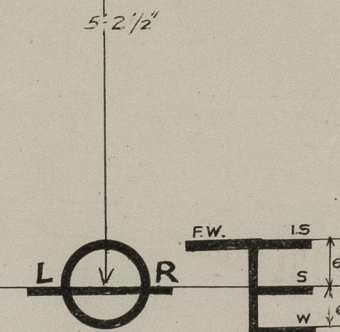

FREEBOARD IN FEET	DEADWEIGHT IN TONS	DRAFT IN FEET	DISPLACEMENT IN TONS.	TONS PER INCH
V				
VI	9500	XVII	13000	
VII	9000	XXVI	12500	4.5
VIII	8500	XXV	12000	
IX	8000	XXIV	11500	
X	7500	XXIII	11000	4.4
XI	7000	XXII	10500	
XII	6500	XXI	10000	
XIII	6000	XX	9500	4.3
XIV	5500	XIX	9000	
	5000	XVIII	8500	
	4500	XVII	8000	
	4000	XVI	7500	4.2
	3500	XV	7000	
	3000	XIV	6500	
	2500	XIII	6000	
	2000	XII	5500	4.1
	1500	XI	5000	
	1000	X	4500	
	500	IX	4000	4.0
	0	VIII	3500	

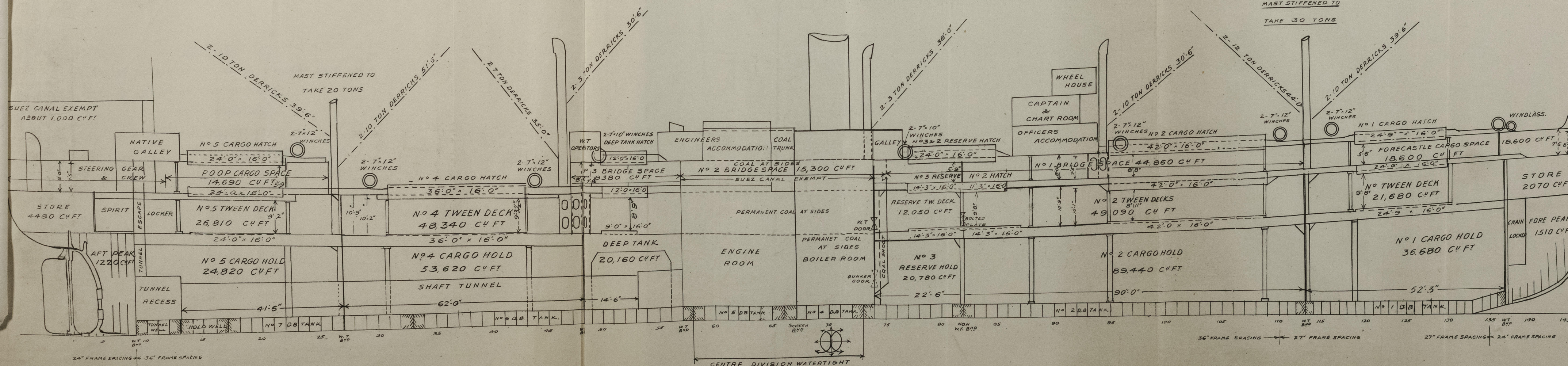

HALL LINE LTD LIVERPOOL, MARCH 1925