

New beams

NYA BALKAR 140x65x8

FÖRDLÄGGNING

New beams

NYA BALKAR 140x65x8

8-10 5 1/2 2 1/2 3 1

17 OCT 1939

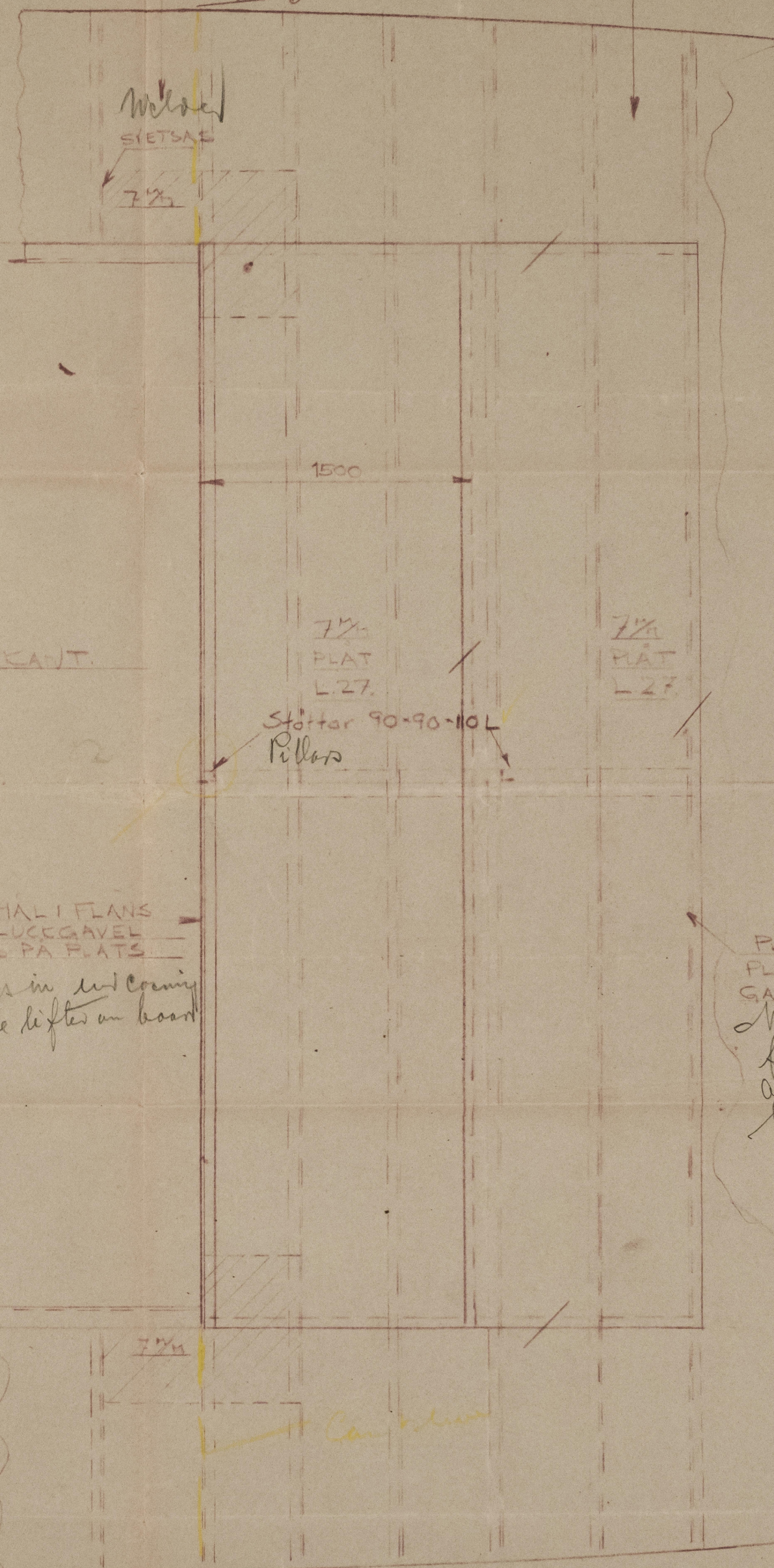
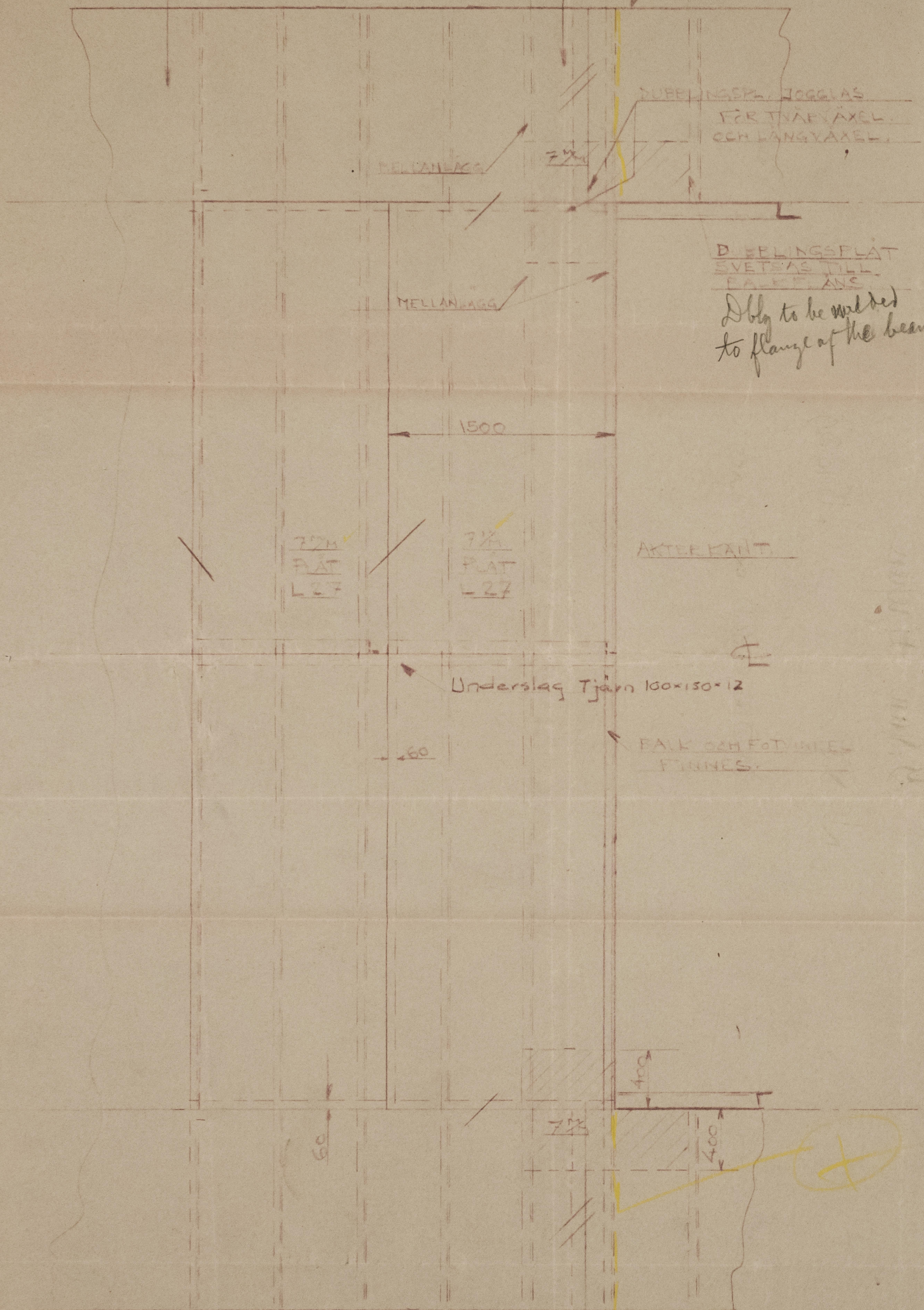

All old beam knees to be used
ALLA GAMLA SPANTBECKOR
ANVÄNDAS.

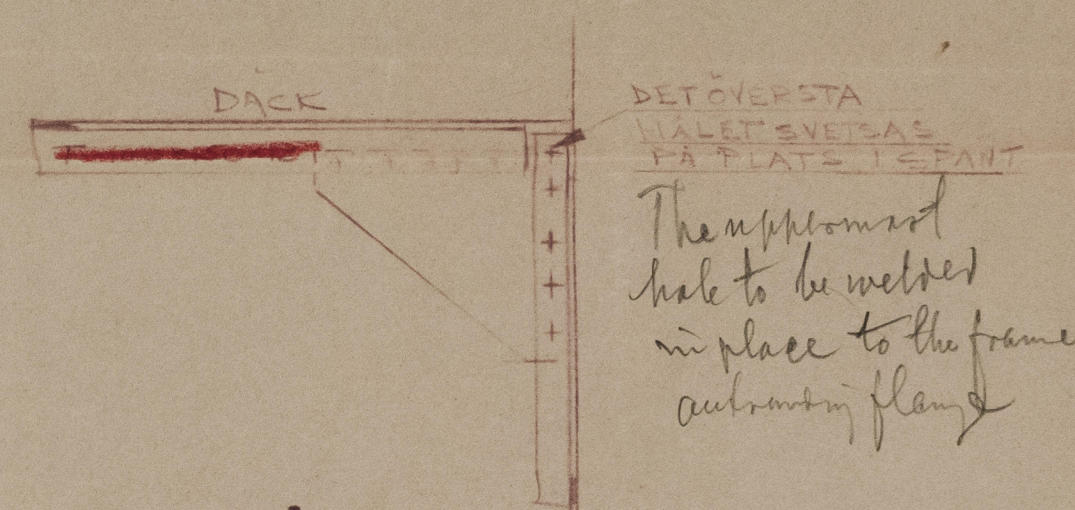

The hatch is made shorter by 5 frame
Luckan inkortad 5 spant förkant
och 5 spant i akterkant

PLÅT PASSAS PÅ
PLATS OCH NITAS TILL
GAMLA LUCKANDBALKEN.
New plate to be
fitted in place
and riveted to old
hatchwood beam

M/S "SIGVARD" Ex. Dollard

ÄNDRING AV 1 ÅRS LASTLUCKA
Addition to Hatch No 1
I HUVUDDÄCK
main deck

Gfey Oct 5th 39
A.P.



© 2021
Lloyd's Register
Foundation

F-698

SÖLVESEDEGS VARVS & FLEDERIA D. 20-1-1939

010428-010439-0136

5

Alteration to No 1 Hatch.

G. Van Diepen

No 827.

17.10.39

S^m SIGVARD ex DOLLARD.

British Corporation

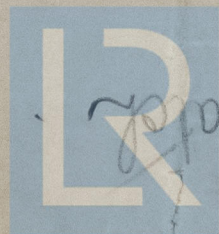

© 2021

Lloyd's Register
Foundation

010428-010439-0136