

S.S. "Markab."

Modification of bulkheads 68 and 75

Scale: 1/4" = 1 Foot

Typical detail of long T.D.  
Connection to Bulkheads (Transverse Beam)

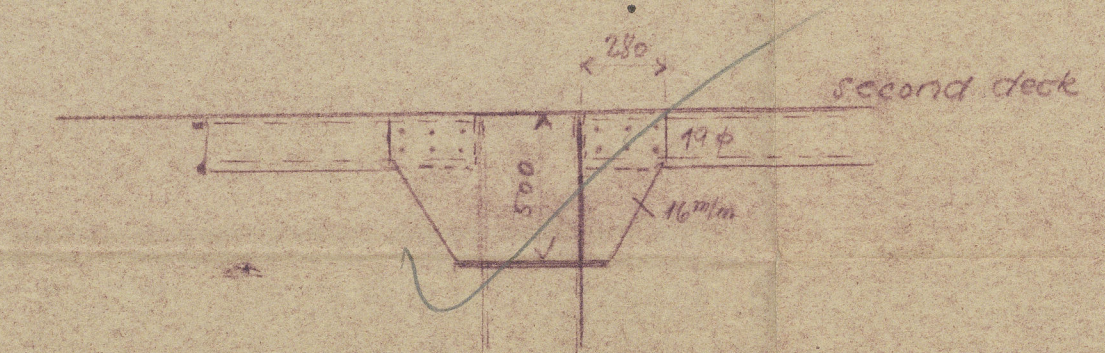

Section B-B

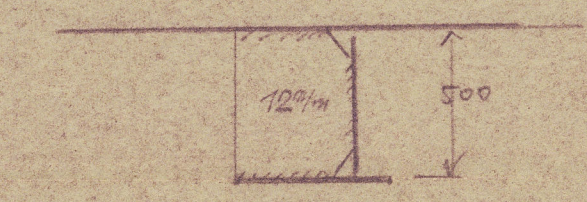

Section Frame 68  
W.T. Bulkhead

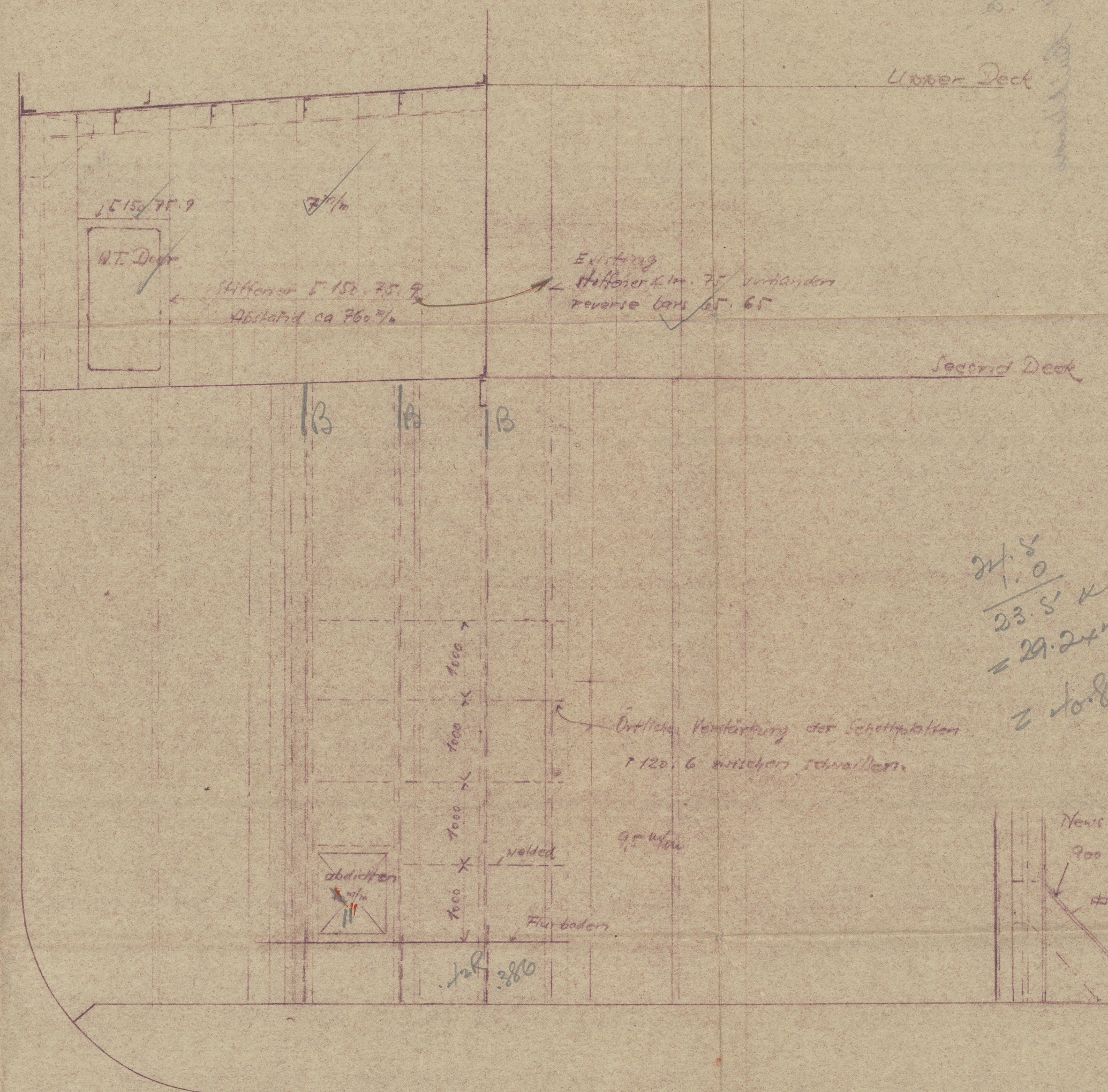

$$\frac{24.5}{23.5} \times 40 = 29.2 \times 12 = 350.4$$

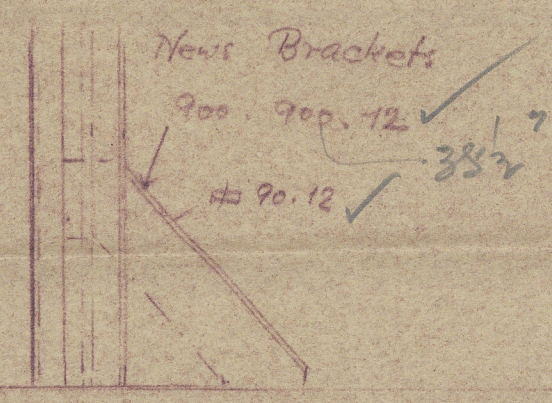

Reverse built up 48  
Reg. 800, 90, 12-13 in. layer.

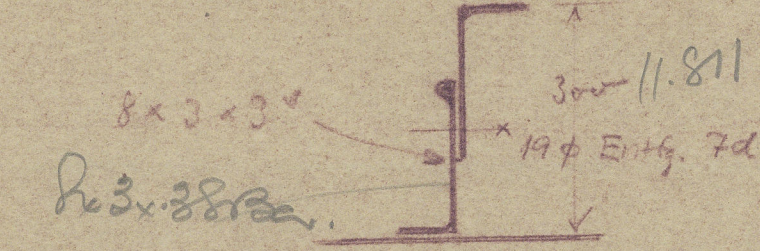

780 = 28 1/2

Section Frame 75 New Transverse

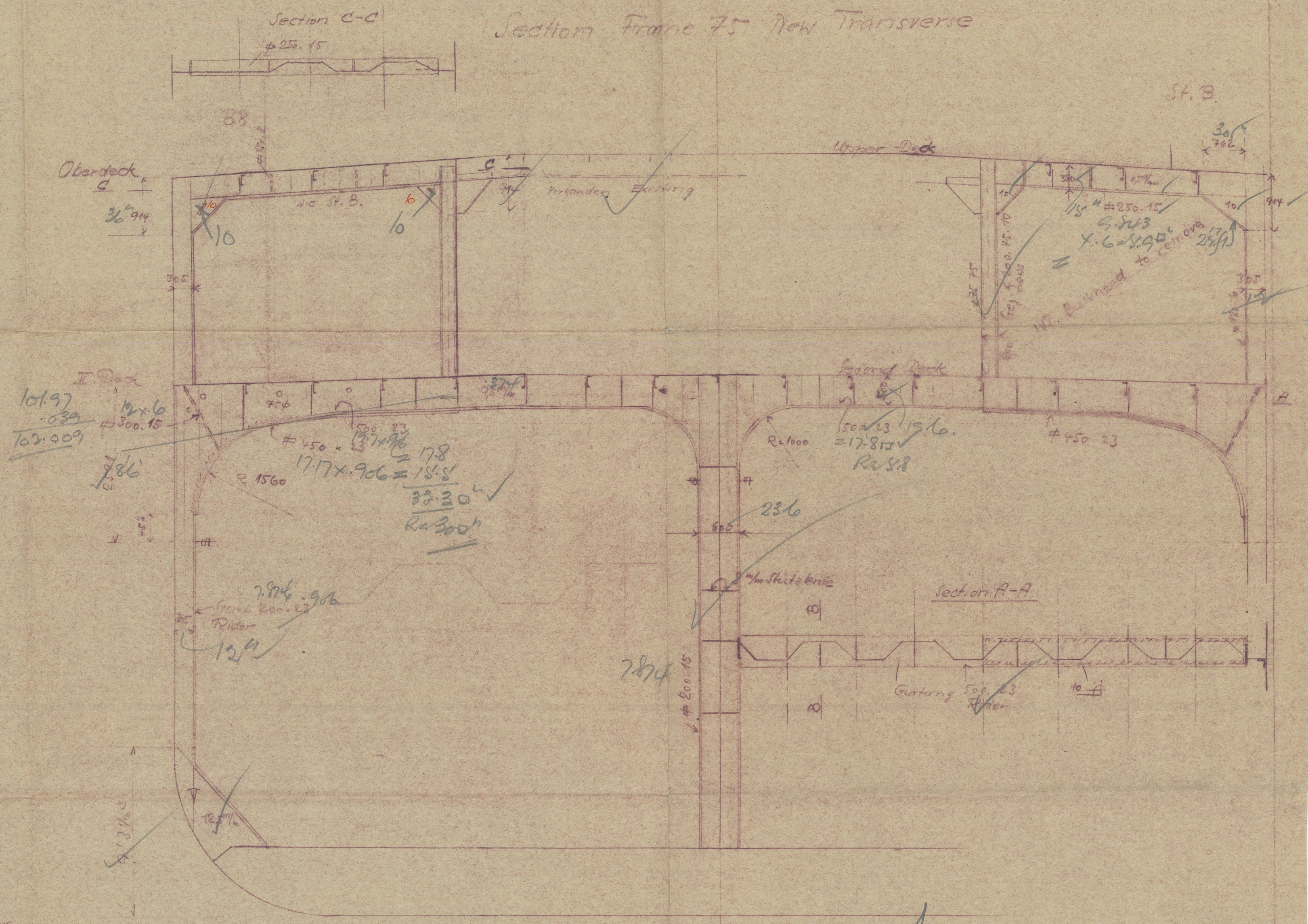

29.9.49

A.G. WESER BREMEN  
Büro: T. B.S.  
Planung des Schiffs 68 und 75  
29.9.49

010495-010501-026



MARKAB

Modification of Bulkheads

68-75.

Bln 35.



© 2021

Lloyd's Register

010445-010501-0269  
Foundation