

6-12-45.

SPANT 16

SPANT 22

SPANT 20

SPANT 34

SPANT 38

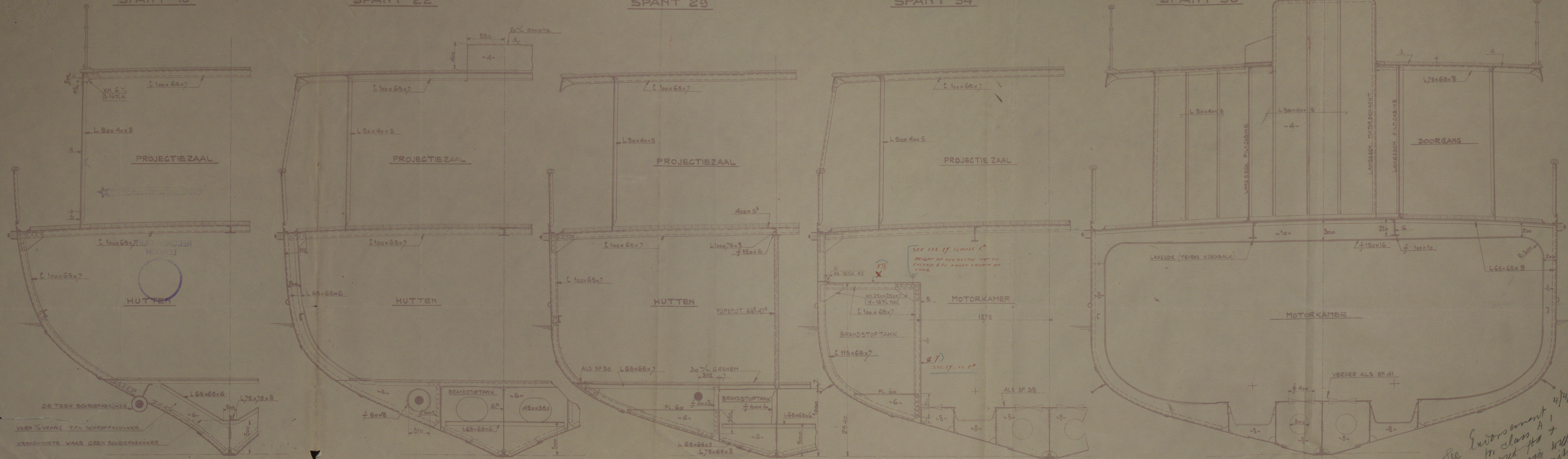

CLASS : 100 A1 IN YACHT REGISTER

RULE LENGTH = 40.65 m  
B = 6.80 m  
D = 3.29 m

T.M. =  $\frac{6.80}{2} + 3.29 = 6.69 \times 3.29 = 21.94$  T.M.

L.H. =  $40.65 \times 6.69 = 271.85$   
 $271.85 \times 0.7 (40.65 - 10.5) = 55.35$   
 $307.50 \times 10.764 = 3308$  L.H.

EQUIPMENT TO RULE (LETTER 'U') EN = 3680

- 1 BOEGANKER 6% CWT. STOKLOOS
- 1 " " 6% CWT.
- 1 STROOMANKER 1 1/2% CWT. ZONDER STOK
- 2 x 75 VADEN ANKERKETTING 3/8" DIAMETTER OF 1" KORTSCHAALIG
- 45 " 2" STAALDE. VOOR STROOMANKER
- 75 " 2 1/2" " SLEEPTROS
- 75 " 4 1/2" HENNEP " MEERDRADEN

SPANT 41

SPANT 50

SPANT 52

SPANT 6

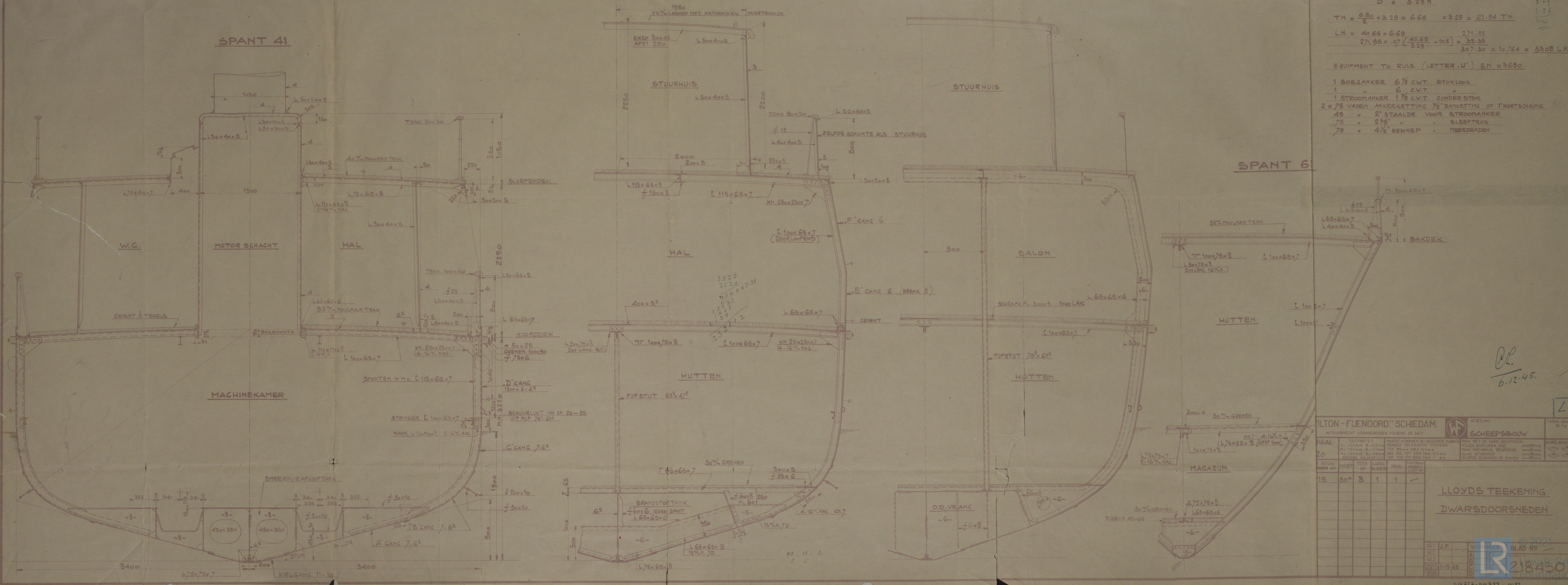

ILTON - FUENORD - SCHIEDAM.

AFTEKENING: VORMGEVENDE VULLEN DE NET

HAAL: 15 50" B 1 1

HAAL: 15 50" B 1 1

HAAL: 15 50" B 1 1

HAAL: 15 50" B 1 1

HAAL: 15 50" B 1 1

HAAL: 15 50" B 1 1

HAAL: 15 50" B 1 1

HAAL: 15 50" B 1 1

HAAL: 15 50" B 1 1

HAAL: 15 50" B 1 1

HAAL: 15 50" B 1 1

HAAL: 15 50" B 1 1

HAAL: 15 50" B 1 1

AFTEKENING: VORMGEVENDE VULLEN DE NET

HAAL: 15 50" B 1 1

HAAL: 15 50" B 1 1

HAAL: 15 50" B 1 1

HAAL: 15 50" B 1 1

HAAL: 15 50" B 1 1

HAAL: 15 50" B 1 1

HAAL: 15 50" B 1 1

HAAL: 15 50" B 1 1

HAAL: 15 50" B 1 1

HAAL: 15 50" B 1 1

HAAL: 15 50" B 1 1

HAAL: 15 50" B 1 1

HAAL: 15 50" B 1 1

HAAL: 15 50" B 1 1

LLOYDS TEKENING  
DWARSDOORSNEDEN





"VAN DER STENG" ★

~~"VANDERSTENG" ★~~

RECORDS DEPT.,  
LONDON

3

*see endorsement 4.4.46  
for allocation to class*

WILTON - FLEENDOORD

YARD NO 715

MODIFIED MIDSHIP SECTION



WILTON-FYENOORD.

YARD N° 415

MODIFIED

MIDSHIP SECTION, ETC.

010927-010733-0082



© 2021

Lloyd's Register  
Foundation