

Form LL. 4.C. Revised

THE BRITISH CORPORATION REGISTER OF
SHIPPING AND AIRCRAFT

"CHETICAMP" SURVEY FOR FREEBOARD

STEAMER, TANKER, SAILER: EX "HAMPSTEAD PARK" WITH WITHOUT TIMBER DECK CARGO

Nationality BRITISH Builders' Name and No. of Ship UNITED SHIPYARDS LTD.

Port of Registry MONTREAL. HALIFAX N.S. MONTREAL. YARD N° 40.

Official Number 175613. Owners CONSTANTINE LINES CANADA LTD.

Gross Tonnage 7160. MGRS. CANADIAN PACIFIC STEAMSHIPS LTD.

Date of Build NOV 1944. Port and Date of survey MONTREAL. DURING CONSTRUCTION.

Particulars of Classification B.S.* (WITH FREEBOARD). Name of Surveyor ALEX PULLIN.

Type of Superstructures FLUSH DECK Names of Sister Ships FORT REMY, FORT LONGUEUIL, SUWALIA PARK

Trade of Ship

Service Endorsement if any

SUMMER FREEBOARD recommended amidships from centre of disc to top of deck line, (..... wood steel)				
TROPICAL FRESH WATER LINE	above	centre of disc	13 1/2"	Corresponding Freeboard
FRESH WATER LINE	"	"	7"	9'-5"
TROPICAL LINE	"	"	6 1/2"	9'-11 1/2"
WINTER LINE	below	"	6 1/2"	10'-0"
WINTER NORTH ATLANTIC LINE	"	"	"	11'-1"

SUMMER TIMBER FREEBOARD recommended amidships from top of deck line				
TROPICAL FRESH WATER	Timber line	above	L.S.	Corresponding Freeboard
FRESH WATER	"	"	"	"
TROPICAL	"	"	"	"
WINTER	"	below	"	"
WINTER NORTH ATLANTIC	"	"	"	"

Number of years recommended for load line certificate

DATE OF ISSUE 18-12-44
DATE OF EXPIRY NOV 12. 1949
(CANADIAN D.L.)

The scantlings and protective arrangements being in accordance with the Load Line Rules it is submitted that the freeboards be assigned

Chief Surveyor

Passed at a meeting of the Committee of Management of the British Corporation Register of Shipping and Aircraft
on the 10TH JANUARY, 1945



© 2021

Lloyd's Register
Foundation
Secretary

010890-010904-0199 1/4

Lloyd's Register
Foundation

PEAK

AVAILABLE

~~approved~~

The Freeboard Report has been compared with the plans and found in order.

0199 $\frac{4}{9}$

Att. K.
22 JUN 1950

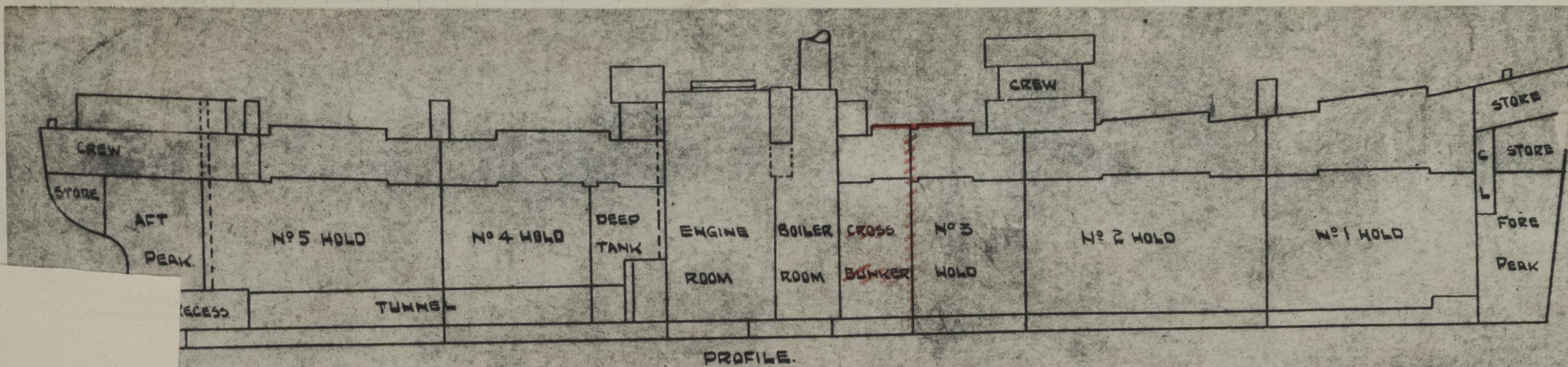

PROFILE.

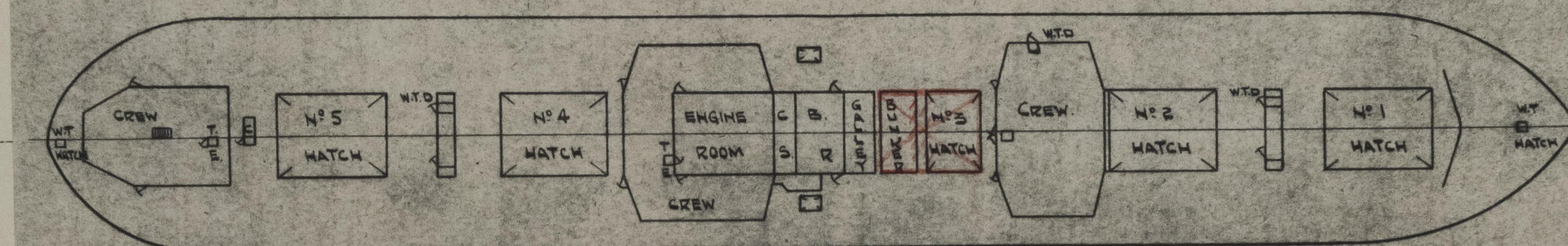

FREEBOARD DK.

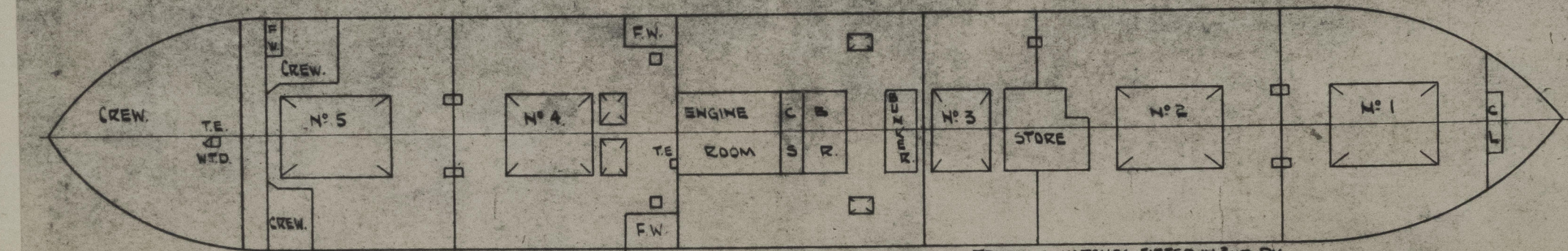

SECOND DK.

TRIMMING HATCHES FITTED IN END DK. TO HOLDS - STEEL HINGED COVERS

0199 1/4

0199 1/4

PARTICULARS OF ALL HATCHWAYS ON FREEBOARD AND SUPERSTRUCTURE DECKS

Number and description of Hatchway from forward	1	2	3	BUNKER	4	5	COAL HATCH P & S	STORE HATCH FORD.	STORE HATCH AFT	
Dimensions of Hatchway	33'-9" x 20'-0"	35'-0" x 20'-0"	15'-0" x 20'-0"	7'-6" x 20'-0"	35'-0" x 20'-0"	35'-0" x 20'-0"	7'-3" x 4'-0"	3'-3" x 2'-6"	1'-9" x 2'-0"	
COAMINGS	Height above steel deck	3'-0"	3'-2"	0"	0"	0"	2'-6"	2'-6"	2'-6"	
	Thickness	7/16"	7/16"	0"	9" BA.	7" BA.	7/16"			
	Stiffeners	7" x 3 1/2" x 3/8" BA	9" BA.	7" BA.	0"	9" BA.	7" BA.			
	Brackets or Stays	STAYS FITTED								
HATCH BEAMS	Number	5	5	2	1	5	5			
	Spacing	5'-7 1/2"	5'-10"	4'-7" & 5'-10"	4'-0"	5'-10"	5'-10"			
	Scantling and Sketch	18 1/2" x 1 1/2"			18 1/2" x 5/16"	As No. 1				
	Bearing Surface and thickness of carriers or sockets	5" x 3" x 3/8"	0"	0"	5" x 3" x 3/8"	0"	0"			
FORE AND AFTERS	Number	3 1/2"								
	Spacing									
	Unsupported lengths									
	Scantling and Sketch									
HATCH COVERS	Material	SPRUCE					SPRUCE			
	Thickness	3"					3"			
	How Fitted	F&A					ATH.			
	Bearing Surface	3"					3"			
Spacing of Cleats	24"						24"			
Number of Tarpaulins	2						2			

FITTED WITH HINGED STEEL W.T. COVER

© 2021 Lloyd's Register Foundation

Are tarpaulins in good condition and in accordance with rule requirements? YES
Are lashings provided in accordance with rule requirements? LOCKING BARS

Are wood fore and afters steel shod at all bearing surfaces? -
Are battens and wedges efficient and in good condition? YES

Give full particulars of the following:—

Fiddley, Funnel and Vent Coamings, Engine Room skylight and other openings in Machinery Casing tops and their means of closing (state height of coamings, type of fiddley covers, and if these are permanently attached in their proper positions)

TOP OF E.R. AND B.R. CASING 10'-6" ABOVE UPPER DECK - FIDDLEY GRATINGS AND E.R. SKYLIGHT STEEL WITH HINGED STEEL COVERS FITTED TO OPENINGS PERMANENTLY SECURED. FUNNEL SECURED DIRECT TO CASING TOP.

Flush Bunker Scuttles on freeboard and superstructure decks (state material, type of joints, etc., and if secured by hinge or permanent chain attachment)

Companionways on freeboard and superstructure decks (state material, height of doorway sills, type of doors, and if these can be closed and secured from both sides)

STEEL COMPANIONWAY TO CREW'S QUARTERS AFT - 24" COAMING - 2" SOLID WOOD DOOR OPERATED BOTH SIDES.
ENTRANCES IN DECK-HOUSE AFT 24" COAMINGS - 2" SOLID WOOD DOORS OPERATED BOTH SIDES.
DOORS TO PANTRY IN FORD HOUSE - STEEL - WEATHERTIGHT - OPERATED BOTH SIDES - REINFORCED WITH PORTABLE WOOD STRONG BACK.
DOORS GIVING ACCESS TO HOLDS AND 'TWEEN DECKS ARE STEEL, RUBBER JOINTED AND WITH Toggles - OPERATED BOTH SIDES.

Ventilators in exposed positions on freeboard, raised quarter and superstructure decks to spaces below freeboard decks and fully enclosed superstructures enclosed by Class 1 appliances (state height of steel coamings, pitch of rivets in deck connection, type of closing arrangements)

UPPER DECK COAMINGS 36" MINIMUM - WELDED ABOVE AND BELOW DECK. WOOD PLUGS AND CANVAS COVERS SUPPLIED.

Airpipes in exposed positions on freeboard, raised quarter and superstructure decks (state height to opening and if satisfactory closing arrangements are provided)

MINIMUM HEIGHTS OF AIR PIPES ON UPPER DECK 36" TO BOTTOM OF BEND
CLOSING ARRANGEMENTS (a) WOOD PLUGS SECURED BY CHAIN TO AIR PIPES. WHERE W.B. OR F.W. CARRIED (b) SPECIAL BALL FLOAT VALVE AND GAUZE FITTED TO D.B. O.F. TANKS. (c) GAUZE FITTED TO DEEP TANKS AND SETTING TANKS PORT AND STARBOARD.

Scuppers and Sanitary Discharge Pipes (state material, type and number of valves)

IN 'TWEEN DECKS:- 7 OFF STORM VALVES FROM DECK HOUSES ON UPPER DECK (PORT)
4 " " " " " " " " (STBD)
3 " DOUBLE " " ACCOM. IN T.D. AFT PORT.
IN NO 3 HOLD :- 1 " GEARED " " REFRIG. SPACE IN T.D. STBD.
VALVE GEARED TO UPPER DECK
ALL VALVES OF BRASS

Side Scuttles to spaces below freeboard and superstructure decks (state type or pattern, and if permanent or portable deadlights are supplied)

10" BRASS FRAMED SIDE SCUTTLES HAVING C.I. HINGED DEAD LIGHTS, FITTED TO CREW ACCOMMODATION AFT.

Vertical distance of sill of lowest side scuttle below top of freeboard deck at side amidships

SIDE SCUTTLES AFT ARE 36" BELOW UPPER DECK

Guard Rails on freeboard and superstructure decks (state type and where fitted)

BULWARKS AMIDSHIPS AND FORWARD. GUARD RAILS, THREE IN NO. ELSEWHERE ON UPPER DECK

Gangways and Lifelines

LIFELINES TO CREW ACCOMMODATION AFT.

Gangway, Cargo and Coaling Ports in sides of ship

NONE

SUPPLEMENTARY REQUIREMENTS FOR STEAMER CARRYING TIMBER DECK CARGOES

Do Superstructure and Machinery Casings comply with rules?

Is provision made for protection of steering gear?

Is emergency steering gear provided?

Are efficient sockets and eyes for lashings provided and properly spaced?

State particulars of longitudinal subdivision in double bottom

State particulars of Bulwarks and Rails

Particulars of any Special Features in the construction of the Ship

Endorsement at first survey and at surveys for Renewal of Certificate:—

The fittings and appliances are in accordance with the particulars shown in the form and are in good condition