

TEST HEAD 5'-0" ABOVE CROWN OF TANK

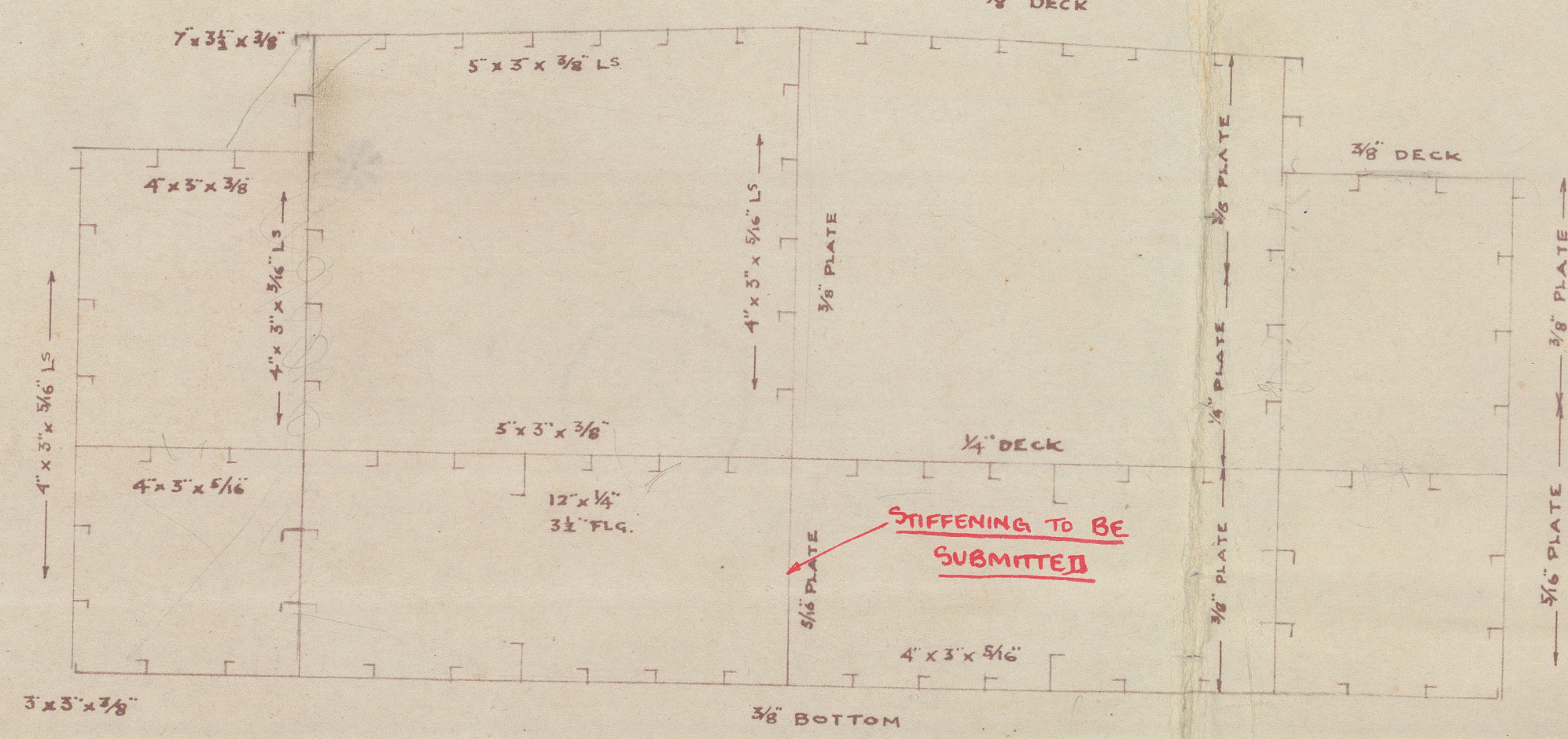

MIDSHIP SECTION

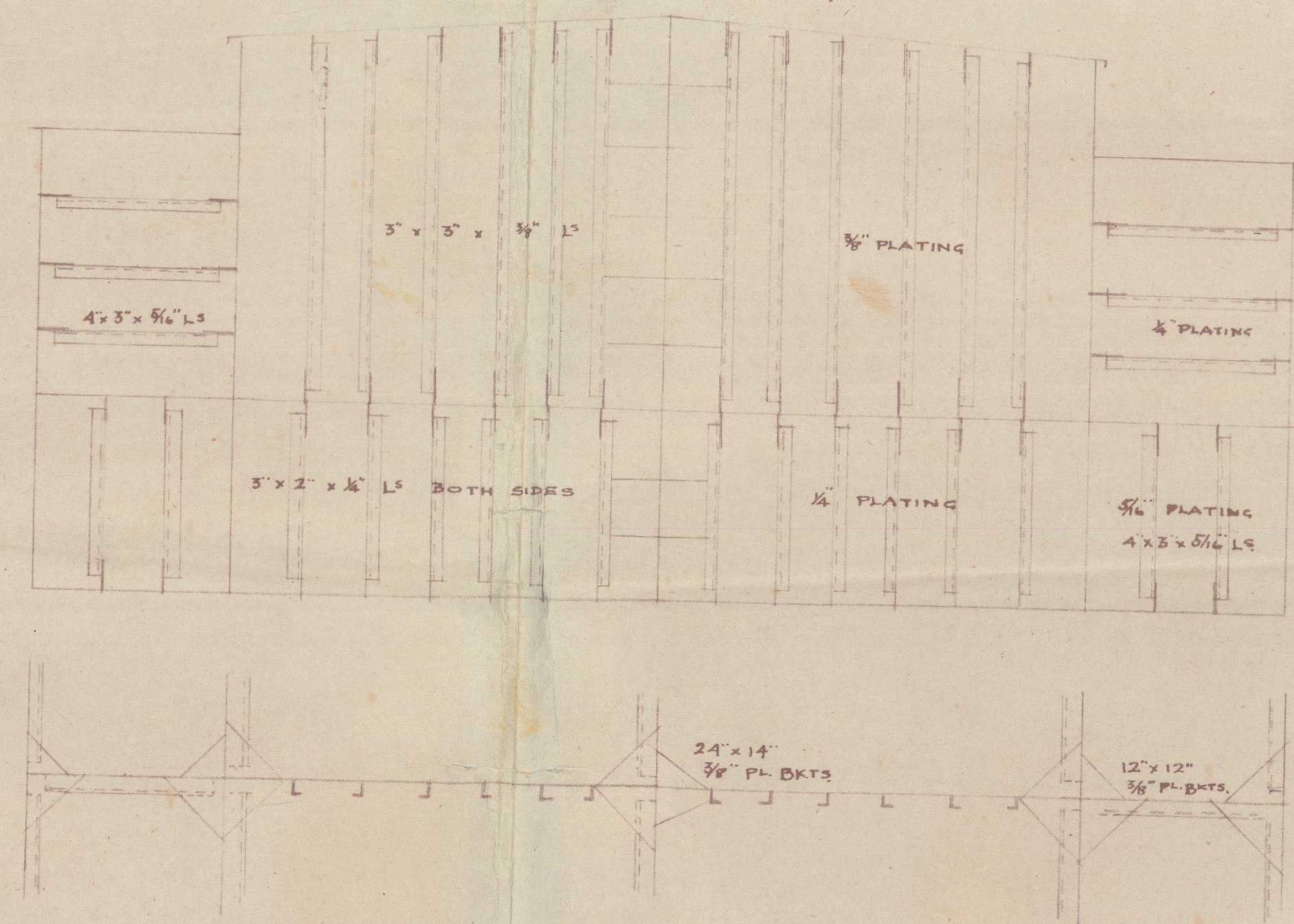

SECTION AT TRANSVERSE BHD

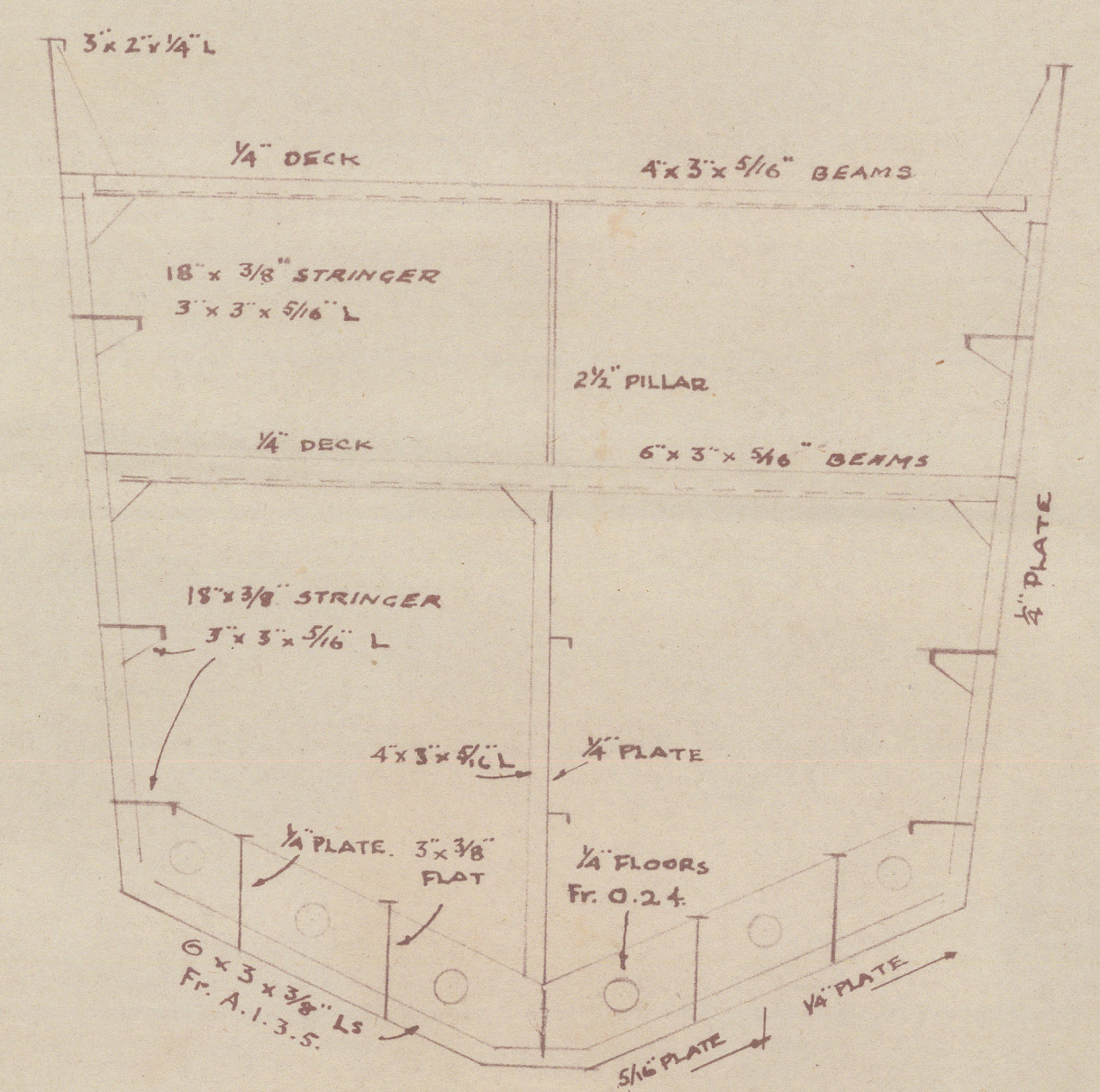
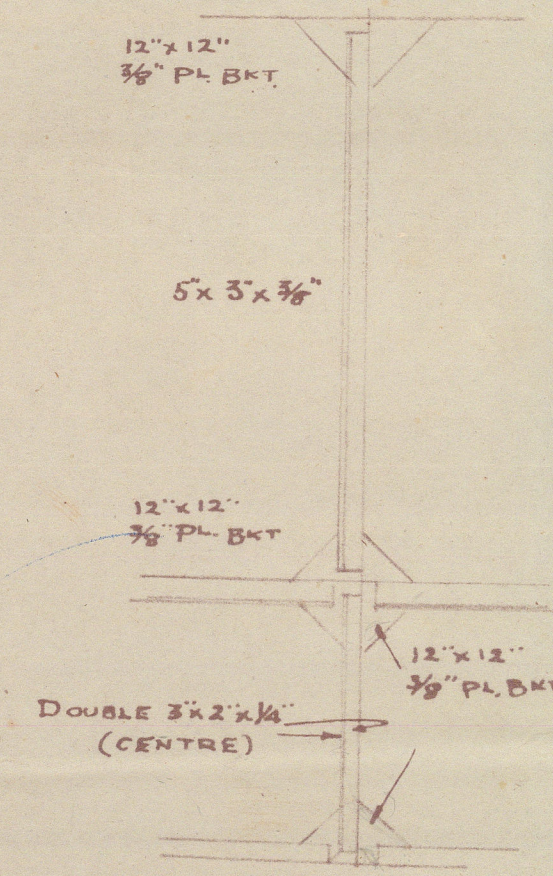

SECTION THRO' FORE PEAK

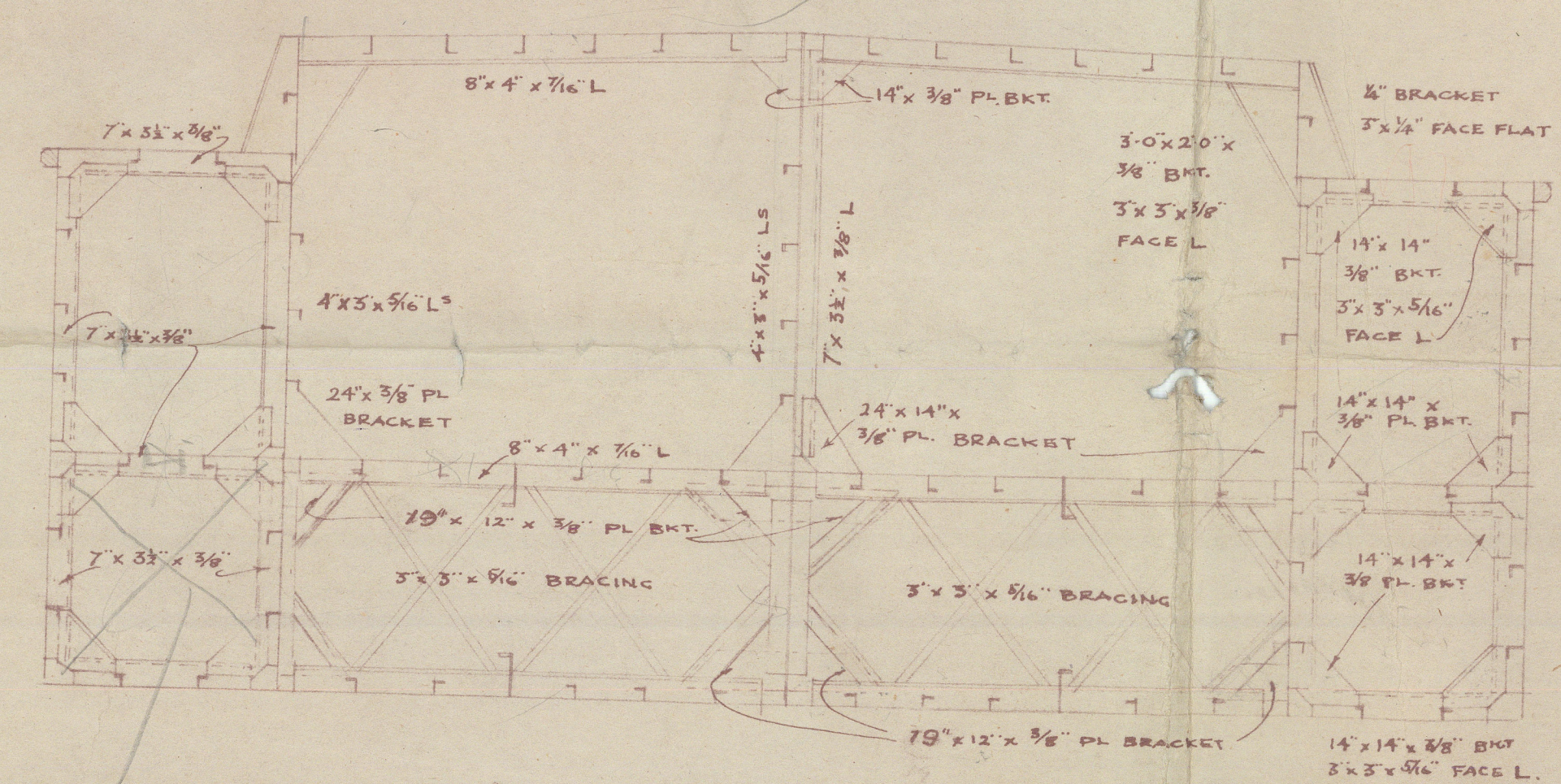

SECTION AT OPEN FRAME

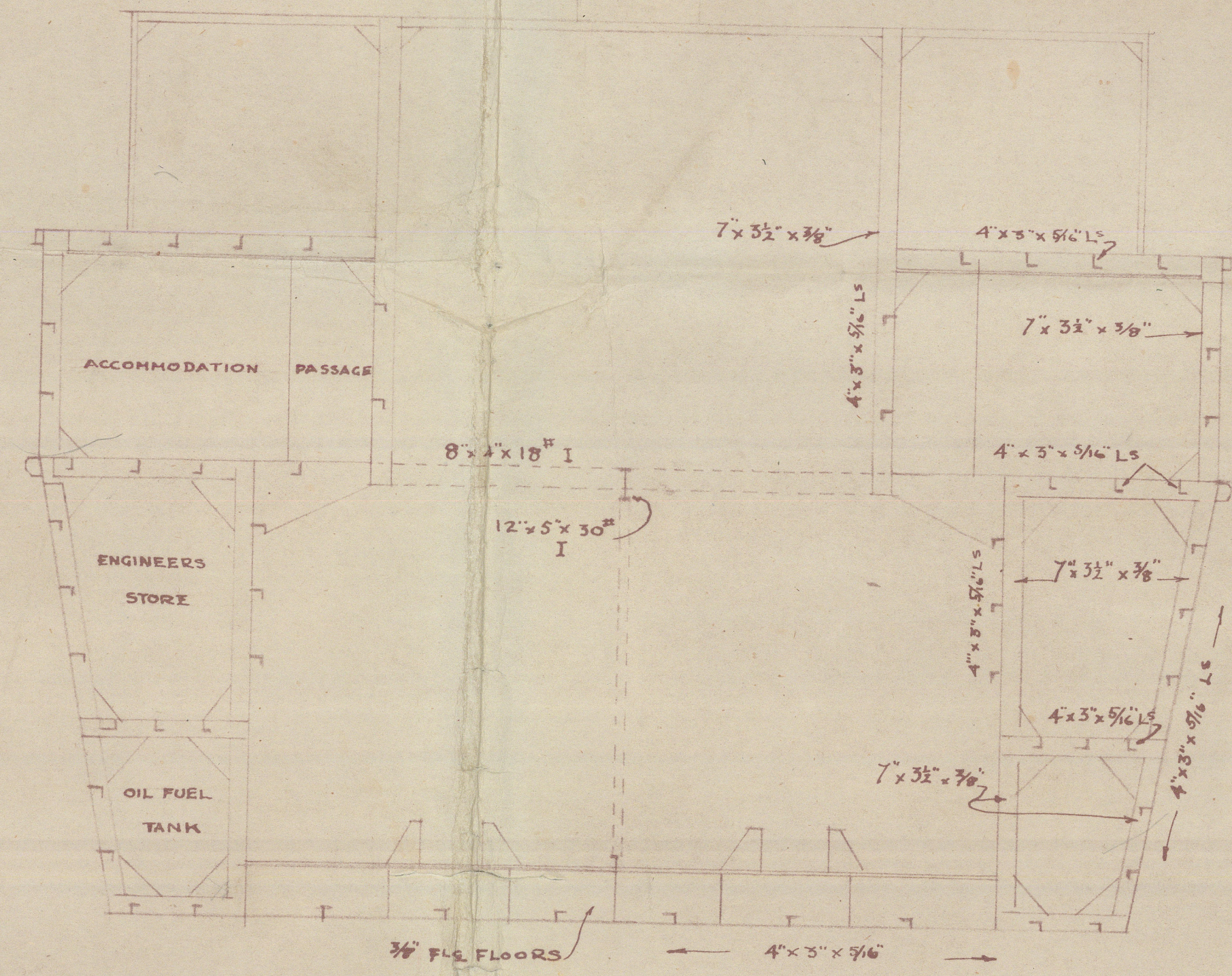

SECTION THRO' ENGINE RM

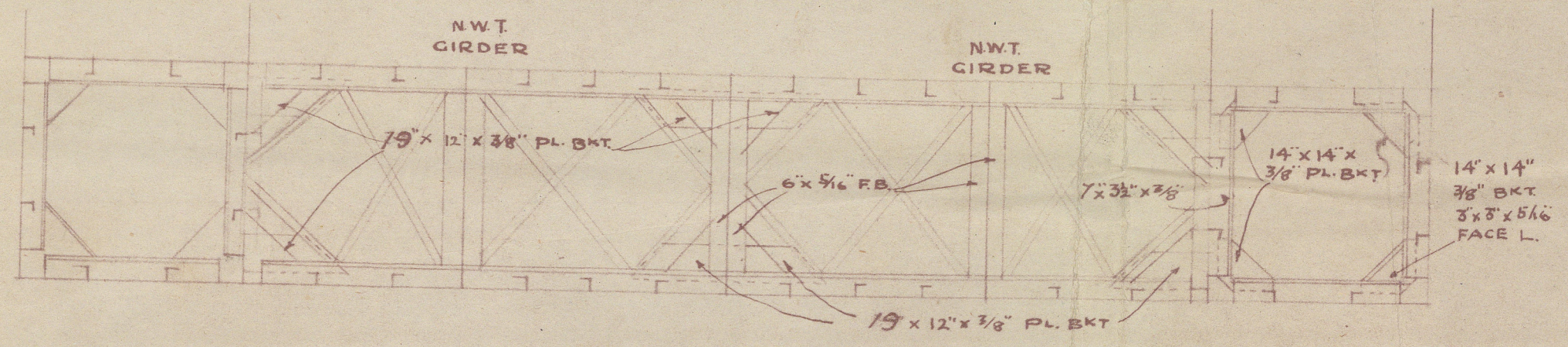

SECTION BETWEEN FRG 17-23

Leslie Knapp A.M.I.N.A., A.M.I.M.E.
Naval Architect & Surveyor
3, Harewood Rd.
S. Croydon

Length a 13/16 N.L. frame stem to centre of transverse bulkhead
Breadth 38
Depth 14
Equipment Removal
L(R+D) = 11367
Prop 638 x 70 x 3/4 = 3344
7 etc 353 x 65 x 3/4 = 172
hulk 1195 x 325 x 1/2 = 194
12067

T102 TANKER SCANTLING SECTIONS

Scale 1/4" = 1 ft

CLASS A - "WITH FREEBOARD CORRESPONDING TO A SUMMER MOULDED DRAUGHT OF 12'-0"

"CARRYING PETROLEUM IN BULK"

"FOR COASTING SERVICE, SANTOS TO RIVER PLATE"

Callao to Balboa
See letter 4 June 1946

WARRENPOINT SHIPYARD CO., LTD.
WARRENPOINT
N. IRELAND.

Verified copy of plan
app. London 21/3/46
mub

PLAN No T2/502

16 MAR 1946

T102

Midship Section
app 21.3.46

~~2~~

Juanita Beazley *

2

Bel. reg. no. 14361.

- Juanita Beazley

D/S 742

011294. 011303. 0439



© 2021

Lloyd's Register
Foundation