

No 2105.

PONNYA.

QUARTER WHEEL MOTOR VESSELS

FOR

INLAND WATER TRANSPORT BOARD, BURMA

GENERAL ARRANGEMENT. (AS FITTED).

SCALE: 1/8" = 1 FOOT.



LENGTH OVERALL	148'-6"
LENGTH, HULL, EX TONGUE	134'-0"
LENGTH, WATER LINE	130'-0"
BREADTH, MOULDED	34'-0"
DEPTH, MOULDED	5'-6"
LOAD DRAUGHT	4'-0"

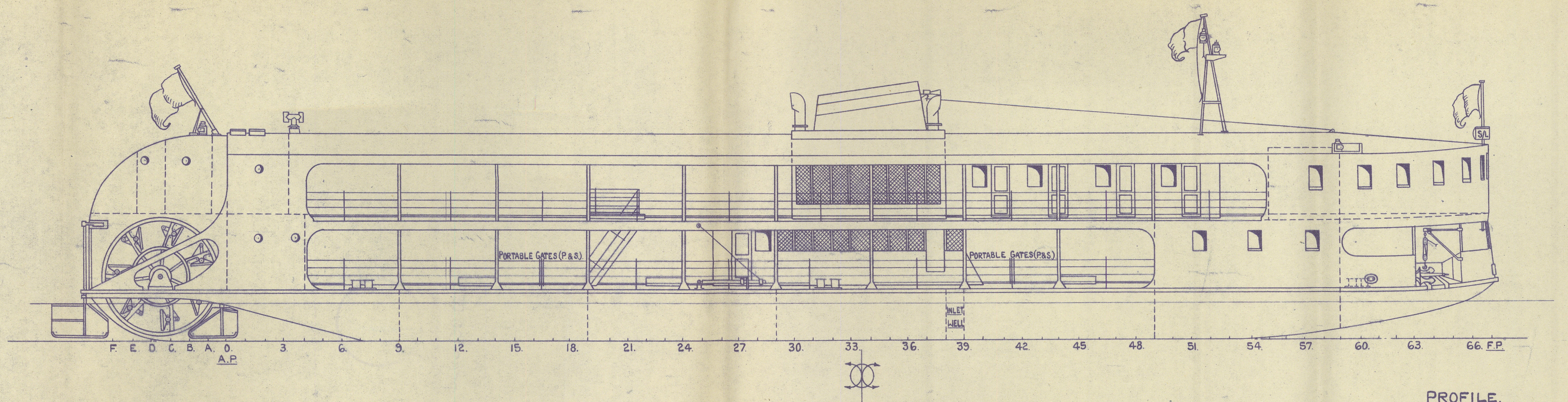

PROFILE.

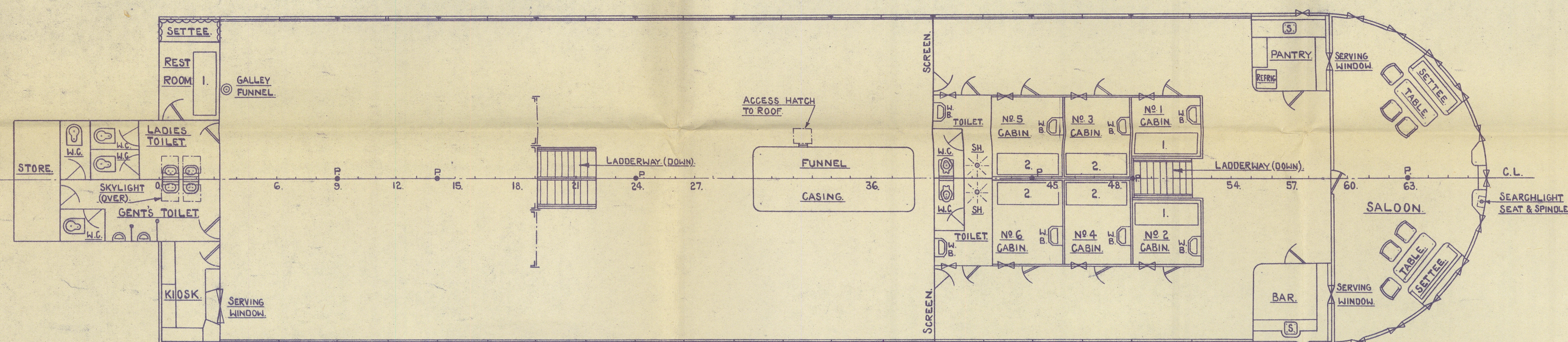

UPPER DECK.

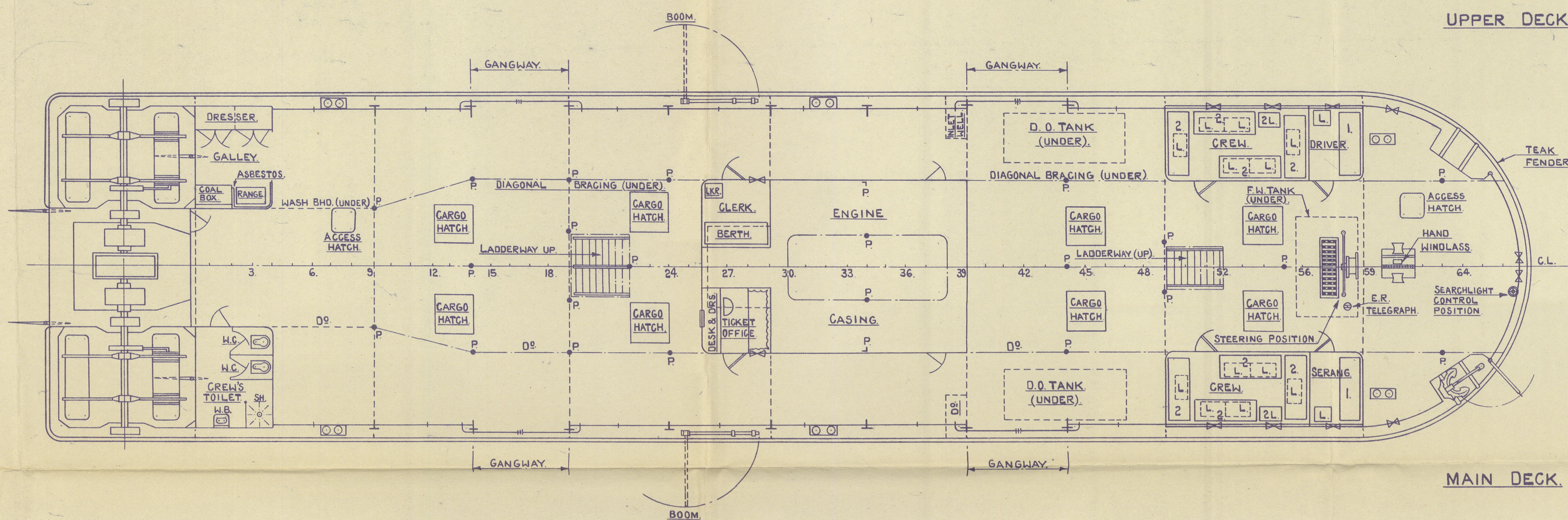

MAIN DECK.

No 40787.

No 40787.

PONNYA ★

RECORDS DEPT.
LONDON.

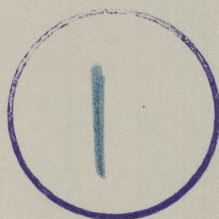

*General Arrangement
as fitted*



© 2021

Lloyd's Register
Foundation

011636-011645-0045