

Nº 2108.
PADAPYAN.

QUARTER WHEEL MOTOR VESSELS
FOR
INLAND WATER TRANSPORT BOARD, BURMA
GENERAL ARRANGEMENT. (AS FITTED).

SCALE: $\frac{1}{8}$ " = 1 FOOT.



LENGTH OVERALL	148'-6"
LENGTH, HULL, EX. TONGUE	134'-0"
LENGTH, WATER LINE	130'-0"
BREADTH, MOULDED	34'-0"
DEPTH, MOULDED	5'-6"
LOAD DRAUGHT	4'-0"

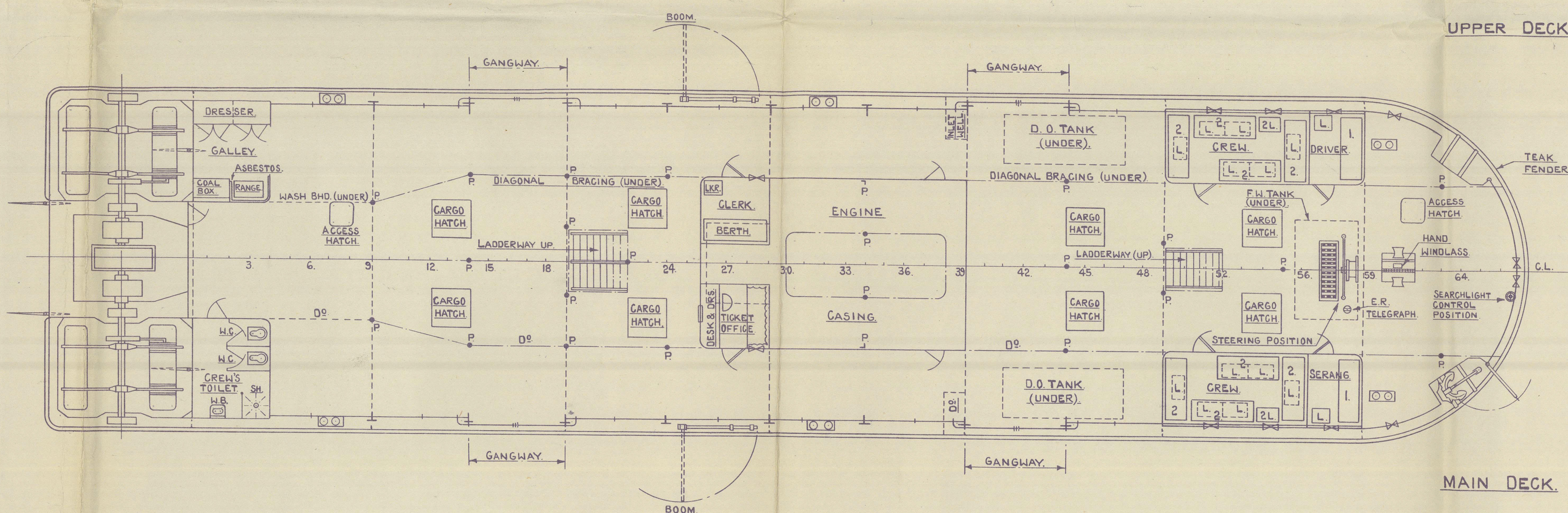
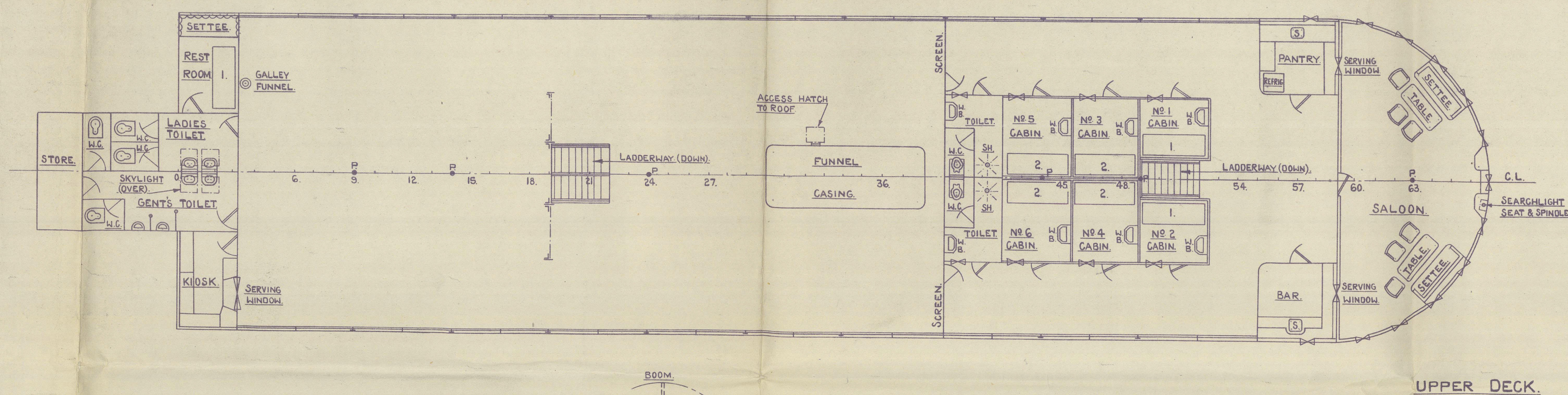
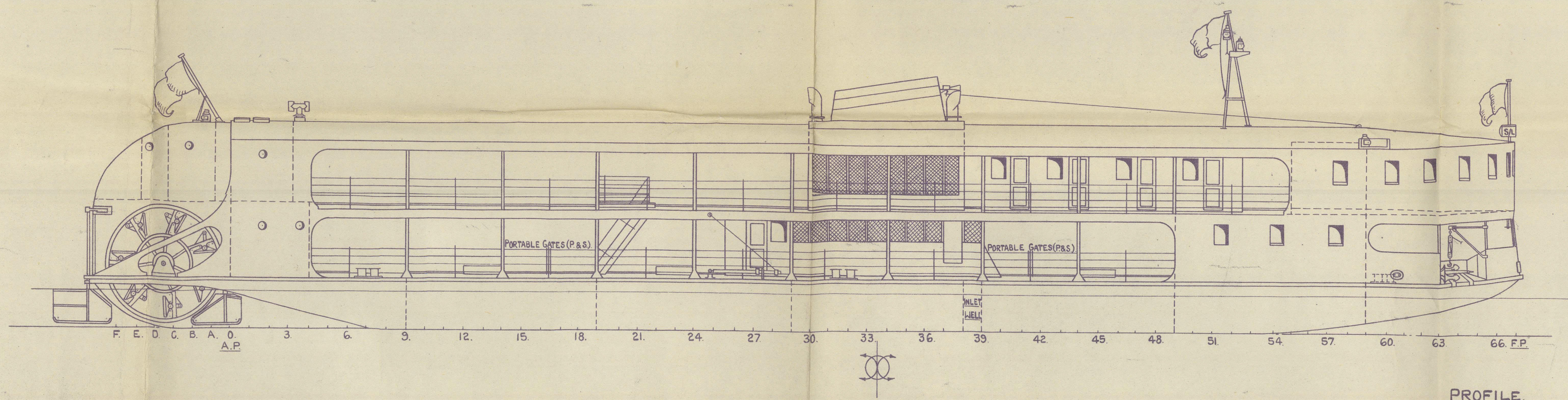

Nº 40787.

Nº 40787.

"
PADAPYAN"

RECORDS DEPT.,
LONDON.

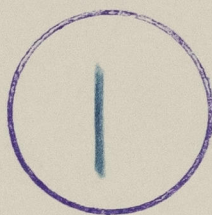

*General Arrangement
as fitted*



© 2021

Lloyd's Register
Foundation

012598-012605-0001