

Lloyd's Register of Shipping.

Index No. _____
(For London Office only).

SURVEYS FOR FREEBOARD.

No. 32843

(CONDITIONS OF ASSIGNMENT.)

*"LANTAO"*Ship's Name *ex* *SS. GRAIGLAS*Port of Survey *Sunderland*Official Number *167801*Surveyor's Signature *W. E. Hulla*Nationality and Port of Registry *BRITISH* *CARDIFF*
*HONG KONG*Date of Survey *While Building*

Disposition and dimensions of superstructures, trunks, deckhouses and machinery casings to be inserted in the diagrams and tabular statement: --

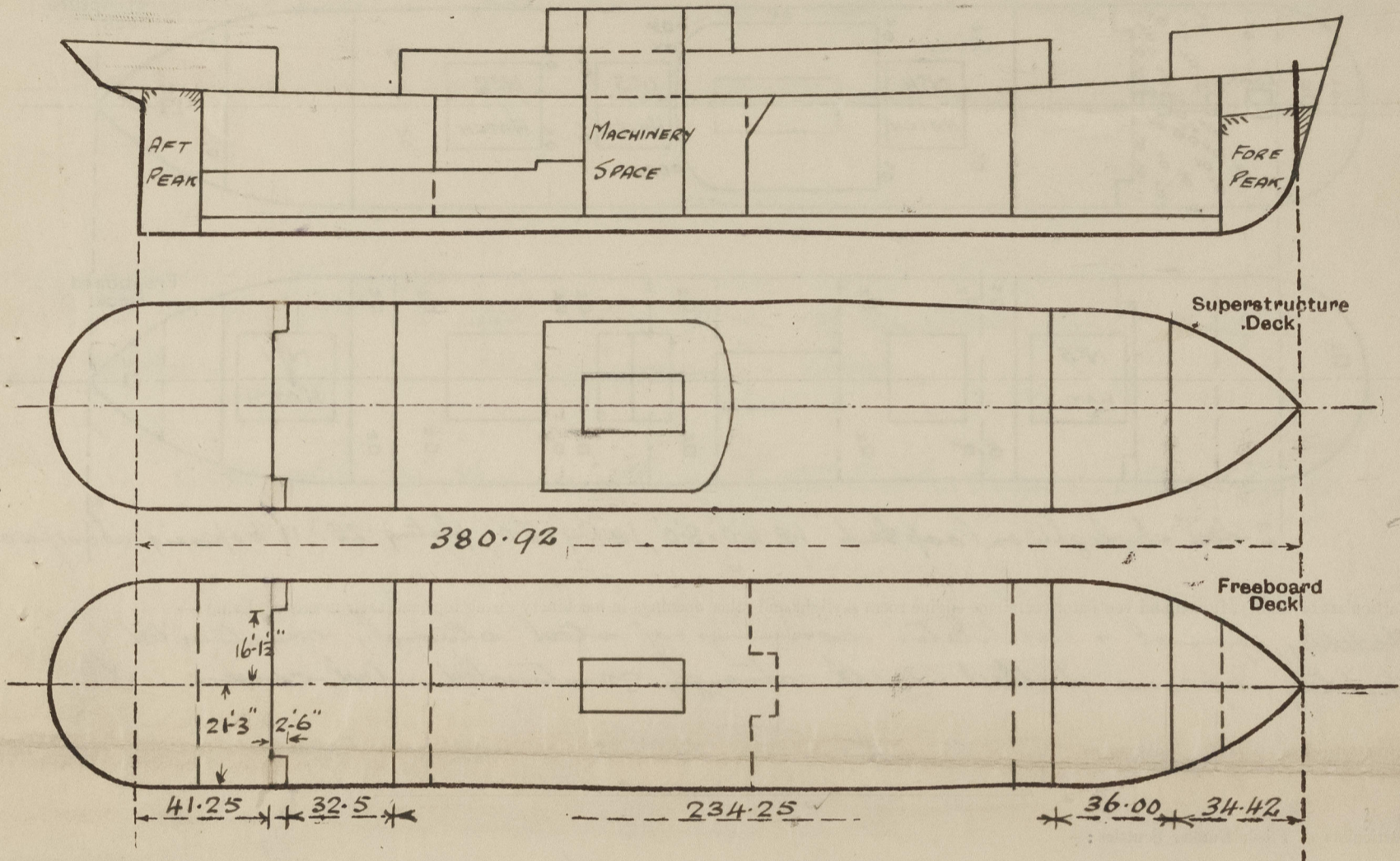

Particulars of Superstructures, Trunks, Casings, Deckhouses.

	Coaming	Plating	Stiffeners	Spacing	End Attachments of Stiffeners	Size of Openings	Height of Sills	Height of Casings
Poop Bulkhead37 ✓	.37 ✓	6x3x40 OA ✓	30 ✓	Lugged ✓	5'-0" x 2'-3" ✓	18 ✓	8'-6" ✓
Raised Quarter Deck Bulkhead ...	✓	✓						
Bridge, After Bulkhead30	.30 ✓	4x3x32 OA ✓	30	Riveted to boundaries ✓	2@ 5'-0" x 3'-1" (a) 1@ 4'-6" x 2'-0" (b)	18" ✓ 24" ✓	8'-6" ✓
Bridge, Forward Bulkhead44 ✓	.44 ✓	9x3 1/2 x 38 L ✓	30	Lugged ✓	2@ 5'-6" x 3'-6"	18"	8'-6"
Forecastle Bulkhead31 ✓	.31 ✓	4x3x32 OA ✓	31 ✓	Riveted to boundaries ✓	2@ 5'-0" x 3'-1" (a) 2@ 5'-0" x 2'-0" (b)	18" ✓ 18" ✓	8'-6" ✓ 8'-6" ✓
Trunk, Aft	✓	✓						
Trunk, Forward	✓	✓						
Exposed Machinery Casings on Freeboard or Raised Quarter Decks ...	✓	✓						
Exposed Machinery Casings on Superstructure Decks	✓	✓						
Machinery Casings within Superstructures not fitted with Class I Closing Appliances34 ✓	.30	3x3x30 ✓	30	continuous ✓	✓ ✓	✓	✓ ✓
Deckhouses on Flush Deck Ships ...	✓	✓						

Particulars of Closing Appliances (state if capable of being manipulated from both sides).

Poop Bulkhead37" W.T. steel door operated from both sides, 4 clips ✓
Raised Quarter Deck Bulkhead ...	✓
Bridge, After Bulkhead	(a) 2 1/2" shifting boards in full height channels (b) 25" steel door operated from both sides ✓
Bridge, Forward Bulkhead44 W.T. Lugged steel door operated from both sides, clips 16" apart (12 clips) ✓
Forecastle Bulkhead	(a) 2 1/2" shifting boards in full height channels (b) 25" steel door operated from both sides ✓
Exposed Machinery Casings on Freeboard or Raised Quarter Decks ..	✓
Exposed Machinery Casings on Superstructure Decks	✓
Machinery Casings within Superstructures not fitted with Class I Closing Appliances	✓
Deckhouses on Flush Deck Ships ...	✓

PARTICULARS OF PROTECTION TO OPENINGS, ETC.

The following diagrams should be used to indicate the positions of cargo and coaling hatchways, gangway, cargo and coaling ports, ventilators, companionways, etc., which would affect the seaworthiness of the ship:—

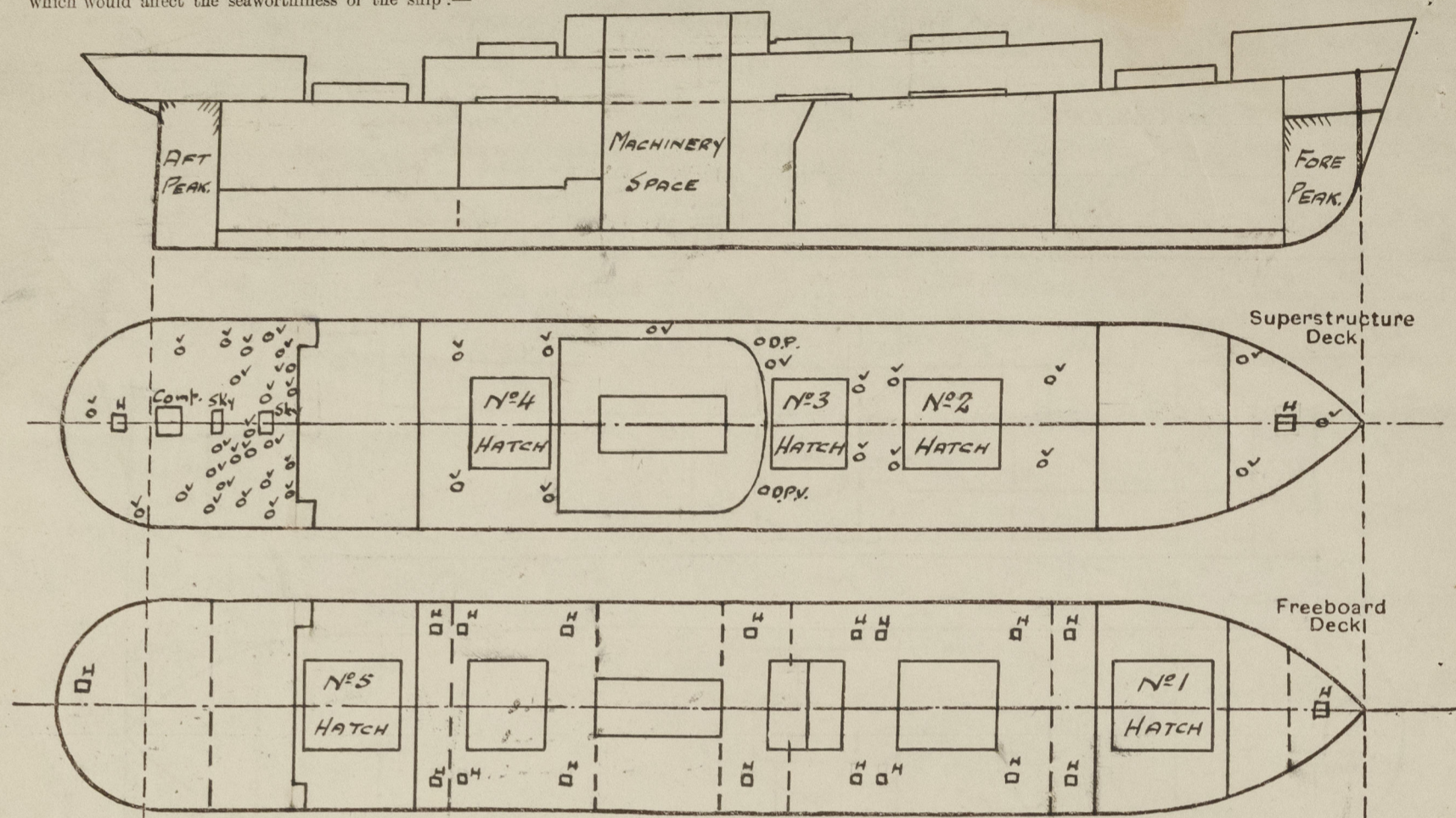

2 Steel skylights on Poop Deck 1 @ 4'0" x 3'0", 1 @ 1'9" x 3'0", plating .25", 11" opening above wood deck

Particulars of fiddle, funnel and ventilator coamings, engine room skylight and other openings in machinery casing tops and their means of closing:—

Fiddle, funnel & ventilator coaming of steel strongly constructed.
Fiddle opening fitted with strongly constructed steel cover.

Particulars of Flush Bunker Scuttles:—

NONE.

Particulars of Companionways:—

Companionway on Poop Deck to Crew Accommodation
opening in deck 5'0" x 2'6", plating .375, steel door 4'2" x 37, coaming 18"
capable of opening from both sides.

Particulars of Ventilators in exposed positions on freeboard and superstructure decks:—

Ventilator	Coaming	Notes
1-9 V. to Fore Space on Fore Deck	36" x 32"	
2-15 V. " " " " " "	36" x 36"	
4-27 V. " Bridge Space " " Bridge Deck	30" x 42"	
3-15 V. " " " " " "	30" x 36"	
4-18 V. " Bridge Space & Hold " " "	30" x 40"	
1-20 D. Port Vent 5, only to Hold " " "	high 50	Specialty supported.
1-6 V. to Cabin Store Port only on " " "	30" x 30"	
1-12 V. " Funnel Aft " Poop Deck	30" x 34"	above wood deck.
2-12 V. " Hold " " " "	30" x 34"	do.
4-9 V. " Crew Accom " " " "	30" x 32"	do.
16-6 V. " " " " " "	30" x 30"	do.
2-9 V. " Steering Gear " " " "	30" x 32"	do.

ventilators fitted with wood plug & canvas covers.

Particulars of Air Pipes in exposed positions on freeboard, raised quarter, or superstructure decks:—

Air Pipe	Height	Notes
1-3 1/2 G.N. to Fore Peak Tank on Fore Deck	18" to top	
3-2 1/2 " " No. 1 O.B. Tank 1 on Fore 2 on Br. Sh.	18" " "	
4-4 " " No. 2 " " on Bridge Deck	18" " "	
2-4 2/3 " " No. 3 " " " "	18" " "	
4-2 " " Ford's After Cofferdams " " "	18" " "	
2-3 2-2 1/2 " " No. 4 O.B. Tank " " "	18" " "	
2-4 2-3 " " No. 5 " " " "	18" " "	
3-2 1/2 " " No. 6 " " 2 on Br. Sh. 1 on Poop Sh.	18" " "	
1-3 1/2 " " Aft Peak Tank on Poop Deck	18" " "	

Air pipes fitted with wood plugs.

Particulars of Gangway Cargo and Coaling Ports:—

NONE

Particulars of Scuppers and Sanitary Discharge Pipes:—

1-3" discharge each side from Crew Space in Poop Lower Deck, with R.V.
1 P, 2 S, 4 " " " " " "
3 P, 2 S, 2" scuppers from Bridge Lower Deck led to E.R. bilge, with self-closing cocks.
5- 6x2 1/2" slots, cut in Bridge deck stinger angle, to drain Bridge deck.
2- 6x2 1/2" " each side in upper deck stinger angle, to drain deck.
2- 6x2 1/2" " " " " " " after " " "

Particulars of Side Scuttles:—

2-10" dia sidelights to Cabin Store & in Bridge Lower Deck. Porty.
8 P, 9 S, 10" dia " " Crew Accom " Poop " "

Sidelights fitted with substantial hinged deadlights.

Vertical distance of Sill of lowest Side Scuttle above top of keel

31'-6"

Particulars of Guard Rails:—

Steel bulwark in way of House on Bridge Deck 62'-6", 42" high, plating .26" rail 5 1/2" x 3" x 30 B.A.
on remainder of Bridge deck, and on Poop & Fore Decks, rails 3'-6" high, 3 rails,
stanchions about 5'-0" apart. between in wells. See lower page.

Particulars of Gangways, Lifelines, etc.:—

Portable Gangway in each well, 2 portable supports on each 3 1/2" x 3 1/2" x 40" angle,
bracketed to deck, tee bracket at top with 2 cross stays 3" x 40", 3 planks 10" x 2 1/2" x 14,
portable wire rails 36" high, stanchions 5'-0" apart, planks bolted to house ends.

Particulars of Freeing Arrangements.

	Length of Bulwark	Height of Bulwark	Size of Freeing Ports	Number each side	Area each side	Rule area each side
After Well ...	32.5	48"	4'-5" x 9"	3	9.95 10.5	9.75
Forward Well ...	36.0	48"	3'-5" x 9"	4	10.24	10.10

State position of each freeing port ... (After Well:— 22-24 ; 24 1/2-26 ; 26 1/2-28 1/2.

(F. and A. position and height above deck edge) (Forward Well:— 129-130 1/2 ; 133-134 1/2 ; 135 1/2-137 ; 138-139 1/2.

State whether the freeing ports are fitted with shutters, bars, or rails, and give particulars of such:— No.

Additional area where sheer is less than standard.

PARTICULARS OF PROTECTION TO OPENINGS, ETC.

HATCHWAYS ON FREEBOARD AND SUPERSTRUCTURE DECKS.									
FREEBOARD DECK.					BRIDGE DECK.				
Description of Hatchway	Nº1	Nº2	Nº3	Nº4	Nº5	Nº2	Nº3	Nº4	
Dimensions of Hatchway	27'x20'	32'-6"x20'	20'x20'	32'-6"x20'	27'-6"x20'	32'-6"x20'	20'x20'	32'-6"x20'	
COAMINGS	Height above Deck	36 ✓			30 ✓	30 ✓			
	Thickness	44 ✓			44 ✓	44 ✓			
	Sides		9"x3 1/2"x44 B.A.				do.	do.	
	Stiffeners	7x3x40L			7x3x40L	7x3x40L			
HATCH BEAMS	Brackets, Stays	2 ✓				3 ✓	1	3.	
	Number	4	5	2	5	4	5	3	5
	Spacing	equal	do.	do.	do.	do.	do.	do.	do.
	Scantling and Sketch	4x3x44	do.	do.	do.	do.	do.	do.	do.
FORE AND AFTERS		20x36	do.	18x36	20x36	20x36	14 1/2x34	13x34	14 1/2x34
		4x3x44	do.	do.	do.	do.	do.	do.	do.
	Bearing Surface	3	do.	do.	do.	do.	do.	do.	do.
HATCH COVERS	Material	Steel ✓	W.P. ✓	W.P.	W.P.	Steel Simple Patent ✓			
	Thickness	1/8	2 7/8	2 7/8 ✓	2 7/8 ✓	1/8			
	How fitted	F.A. ✓	do. ✓	do.	do.	F.A.	do.	do.	do.
	Bearing Surface	3x4	do.	do.	do.	do.	do.	do.	do.
Spacing of Cleats	24 ✓	24 ✓	do. ✓	do.	24 ✓				
Number of Tarpaulins	2 ✓	1			2 ✓				

*Are wood fore and afters steel shod at all bearing surfaces? ☒
 Are battens and wedges efficient and in good condition? ☒
 Are tarpaulins in good condition and in accordance with rule requirements? ☒
 Are lashings provided in accordance with rule requirements? ☒

SMALL HATCHES.

Hatch to Fore Space on Fore Deck 3'9"x2'6" Coaming 24x36
 Rest 2 1/2", Covers 2 1/2", Cleats 16", 2 tarpaulins ✓

Hatch to Fore Peak Store on U.D. 3'9"x3'0" Coaming 9x3x40L ✓
 Rest 2 1/2", Covers 2 1/2", Cleats 16" 24", 1 tarpaulin ✓

16 Luminous Escape Hatches to Holds in Bridge Space
 2'0"x2'0", Coaming 9x35", 35" hinged steel W.T. covers.

Hatch to Steering Gear on Poop Deck 1'9"x1'9" ✓
 Coaming 18x36", 35" hinged steel W.T. covers.

Hatch to Store Off. 1'9"x2'0", Coaming 9x3x40" L
 Cleats 9x12", Covers 2 1/2", Rest 2 1/2", 1 tarpaulin ✓

Particulars of any special features:—

TIMBER ASSIGNMENT.

Vessel fitted with a Forecastle 34'42" feet long (9.04%), a bridge protecting the machinery casings, and a poop housing the steering gear. The double bottom tank within the midship half length are fitted with a W.T. centre division. Permanent bulwarks 48"x30", rail 5 1/2"x3x30" L, L stanchions spaced not more than 6'0" apart are fitted in both wells. The steering gear in the poop is worked by telemotor, the auxiliary steering gear & tackle is fitted on the poop deck. Lugs for uprights, eyeplates for lashings welded to deck about 7'8" apart in fore well, 9'9" apart in after well, the end eyeplate being 6'6" from end bulkheads in each case.

Endorsement at first survey and at surveys for renewal of Certificate:—

The fittings and appliances are in accordance with the particulars shown on this form (or as now modified) and are in good condition.



© 2021

Lloyd's Register Foundation