

LLOYDS
LONDON
STAMP
12/26

NUMERALS.
 $L \times D = 14,925$
 $L \times (B \times D) = 39,895$
 $L/D = 12.94$
 $L \times \text{SPACING OF TRANSVERSES } 440' \times 18' = 3,599$

Nos. 968-9-70.

MIDSHIP SECTION.

SCALE $\frac{1}{2}'' = 1 \text{ FOOT}$

DIMENSIONS 440' O.B.P. \times 56' 9" M.L.D. \times 33' 11" M.L.D. TO UPPER DK.
CLASS + 100 A.I. (LONG. FRAMING) CARRYING PETROLEUM IN BULK.

EQUIPMENT TO BE SUBMITTED SEPARATELY.

RIVETING		OR QUINT. RIV. OVERLAPS	
ITEM	$\frac{1}{2}$ LENGTH	ENDS	
BUTTS OF KEEL PLATE	DOUBLE STRAP TREBLE	QUAD. TO TREBLE (WHERE $\frac{1}{2}$)	
" SHELL PLATING FROM KEEL TO UPPER TURN OF BILGE	QUADRUPLE	TREBLE	
" " " " UPPER TURN OF BILGE	TREBLE	TREBLE	
" " " " TO STRAKE BELOW SHEERSTRAKE	QUADRUPLE	TREBLE	
" " STRAKE BELOW SHEERSTRAKE	QUADRUPLE	TREBLE	
" " SHEERSTRAKE	QUADRUPLE	TREBLE	
" " POOP SIDE PLATING (ONE STRAKE)	QUADRUPLE	TREBLE	
" " BRIDGE	DOUBLE	DOUBLE	
" " FCL. SIDE PLATING	DOUBLE	DOUBLE	
" " UPPER DECK STRINGER	QUADRUPLE	SINGLE	
" " " " PLATING	TREBLE	DOUBLE	
" " " " SECOND " STRINGER	DOUBLE	DOUBLE	
" " " " PLATING & TRUNK SIDE	DOUBLE	DOUBLE	
" " POOP BRIDGE & FCL. STRINGER & D. PLATING	SINGLE	SINGLE	
" " CR. LINE BULKHEAD BOTTOM STRAKE	TREBLE	TREBLE	
SEAMS OF SHELL PLATING	DOUBLE	DOUBLE	
" " UPPER DECK PLATING	DOUBLE IN WAY OF	SINGLE	
" " SECOND " " "	DOUBLE	SINGLE	
" " POOP BRIDGE & FCL. DECK PLATING	SINGLE	SINGLE	
" " FORECASTLE, SIDE PLATING	SINGLE	SINGLE	

TRANSVERSE & CL BULKHEAD PLATING & BOUNDARY ANGLES TO BE INCREASED AT ENDS FOR SHEER (AS PER TABLES).
CL BULKHEAD STIFFENERS AS SHOWN ON MIDSHIP SECTION TO BE INCREASED $\frac{1}{2}$ IN DEPTH OR EQUIVALENT FOR EACH 2' 6" INCREASE IN THE DISTANCE OF THE STIFFENERS FROM THE TOP OF THE BHD. CLEAR OF MIDSHIPS.
NOTCHES FOR LONGLS. TO BE WELL ROUNDED AT CORNERS, NOT ROUGH PUNCHED.
LIGHTENING HOLES IN TRANSVERSE TO MAINTAIN THE SAME RELATIVE POSITION TO SHELL AS SHOWN.

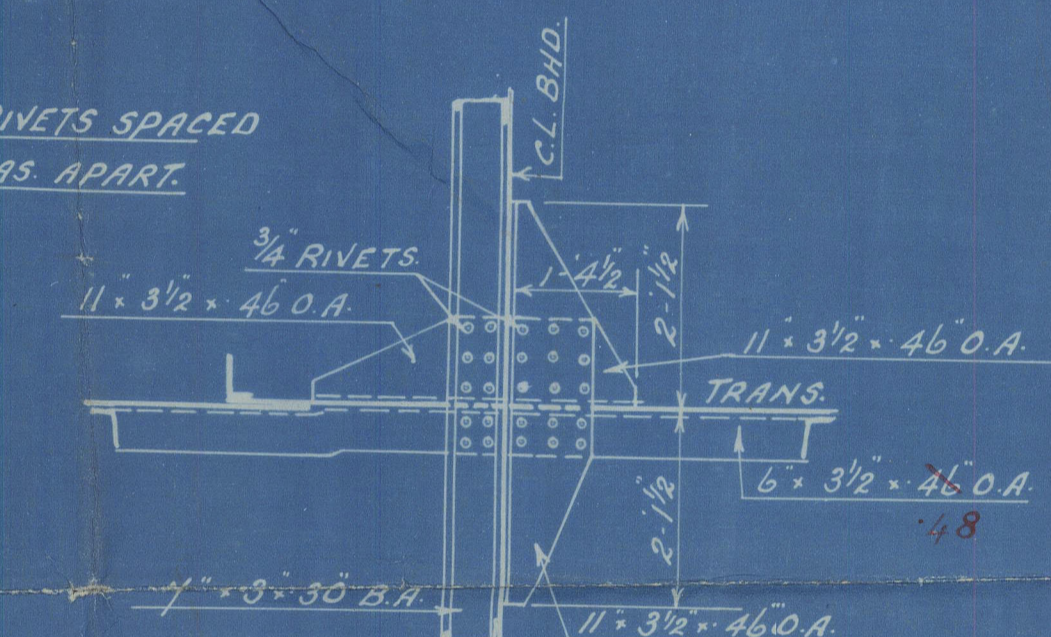

DETAIL OF ATTACHMENT OF 2ND DECK TRANSVERSE TO CL BULKHEAD.

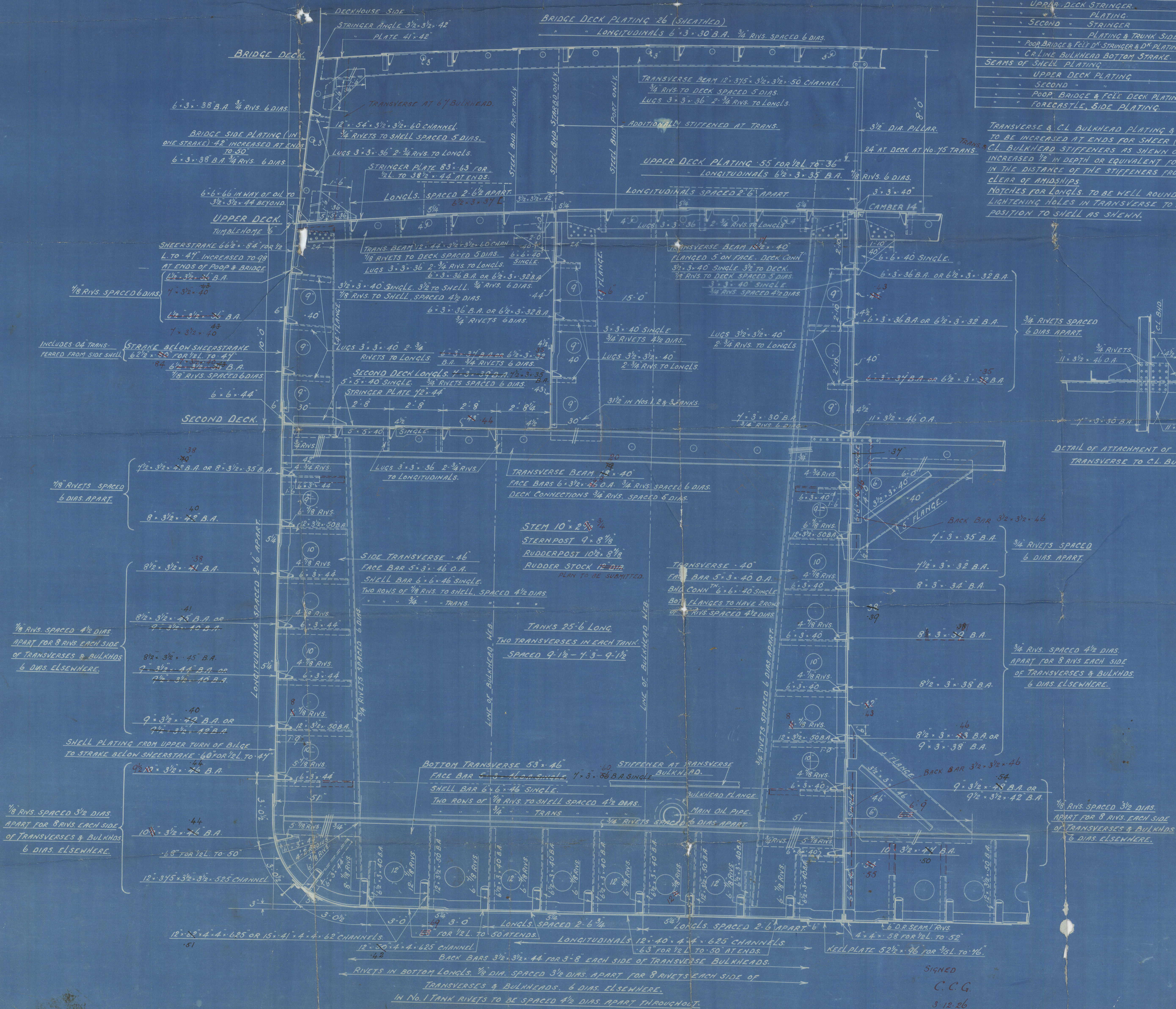

SIGNED

C. C. G.

3.12.26

FOR ENCLOSURE TO

10/12/26

Lloyds Register of Shipping
From *Newcastle*

PALMERS S. & I. CO., Ltd.,

Shipyard Department,

JARROW-ON-TYNE.

(E.W.M.O. NO. 19)

0190 2 1/2

1
82866
Palmers

968-9-70-77

78-79-80

Midship Section

British Honour



S.S. "British Loyalty"

169

82273.

cancelled.



S.S. "British Freedom"

82866.

RECORDS DEPT.
LONDON



British Ardour
S.S. "British Ardour"

NEWCASTLE ON TYNE

Report No. 82998.

S.S. "British Chivalry"



© 2021
83900.

Lloyd's Register
Foundation

012744-012751-0190

101



© 2021

Lloyd's Register
Foundation

