

# PRINCIPAL DIMENSIONS

LENGTH OVERALL	296'-4 1/2"
LENGTH B.P.	270'-0"
BREADTH MOULDED	46'-0"
DEPTH MOULDED TO MAIN DK	22'-0"
DRAFT (PASSENGER)	16'-9" MOULDED
DRAFT (CARGO)	17'-0" MOULDED

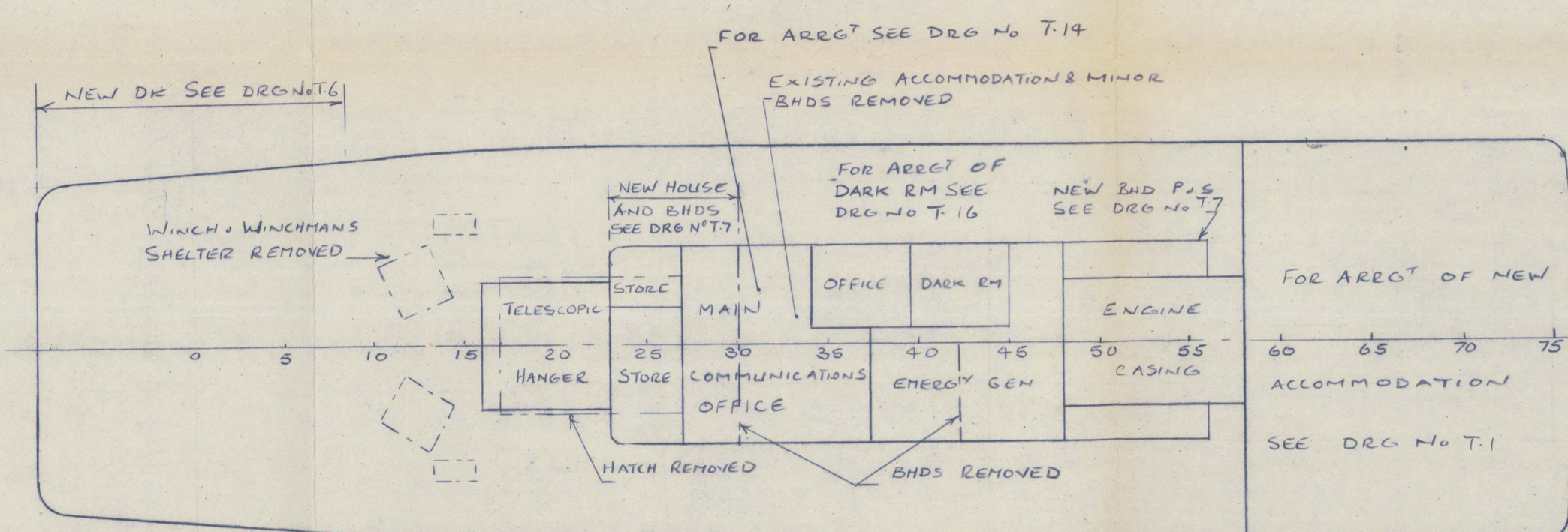

No 01 DECK (BOAT DK)

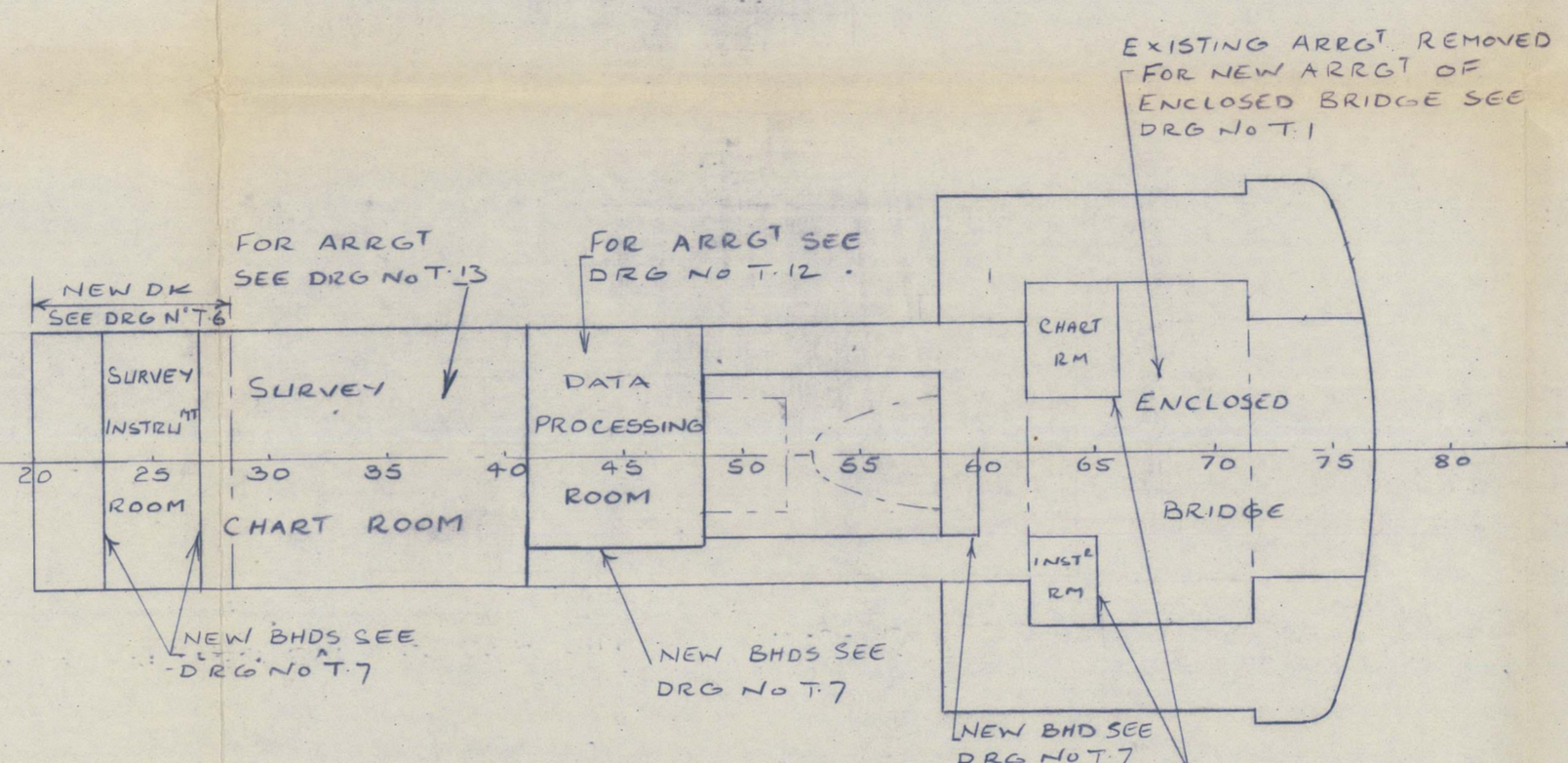

No 02 DECK (NAV. BRIDGE DK)

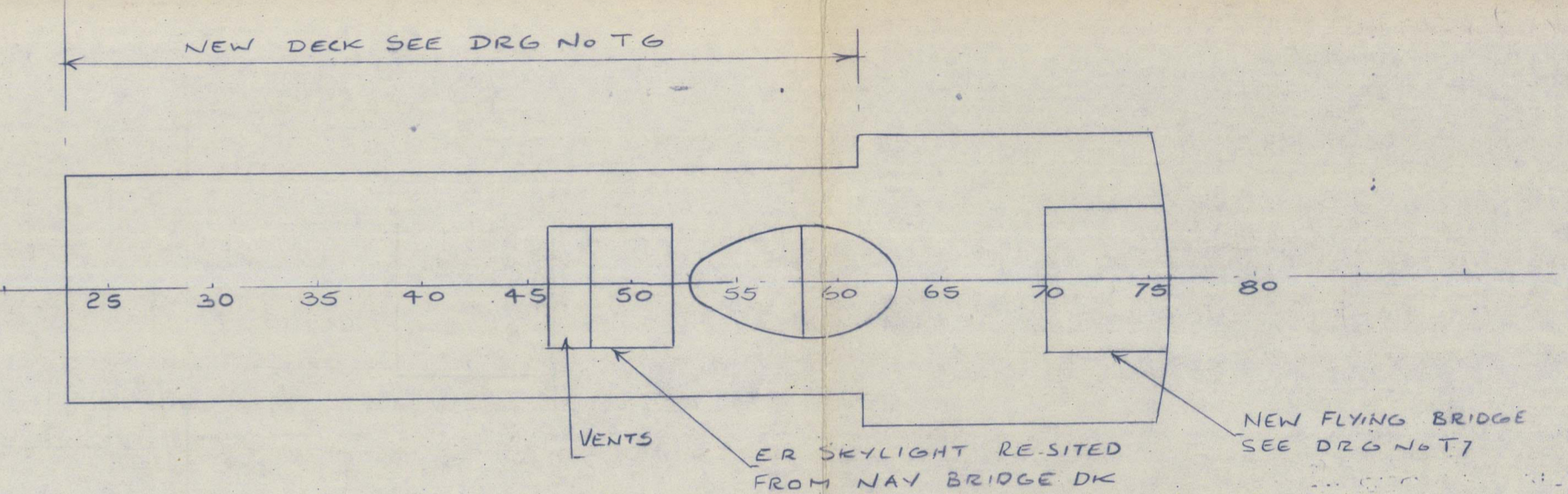

No 03 DECK (WHEELHOUSE TOP)

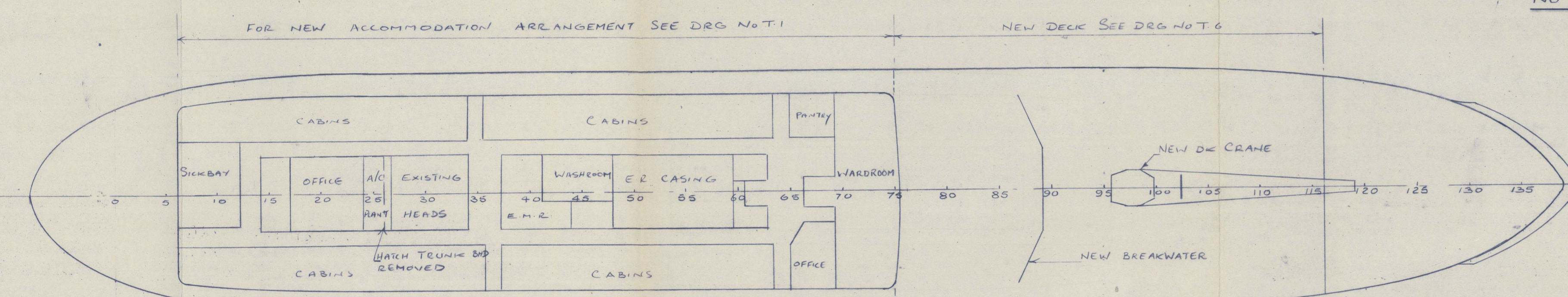

No 01 DECK (BRIDGE DK)

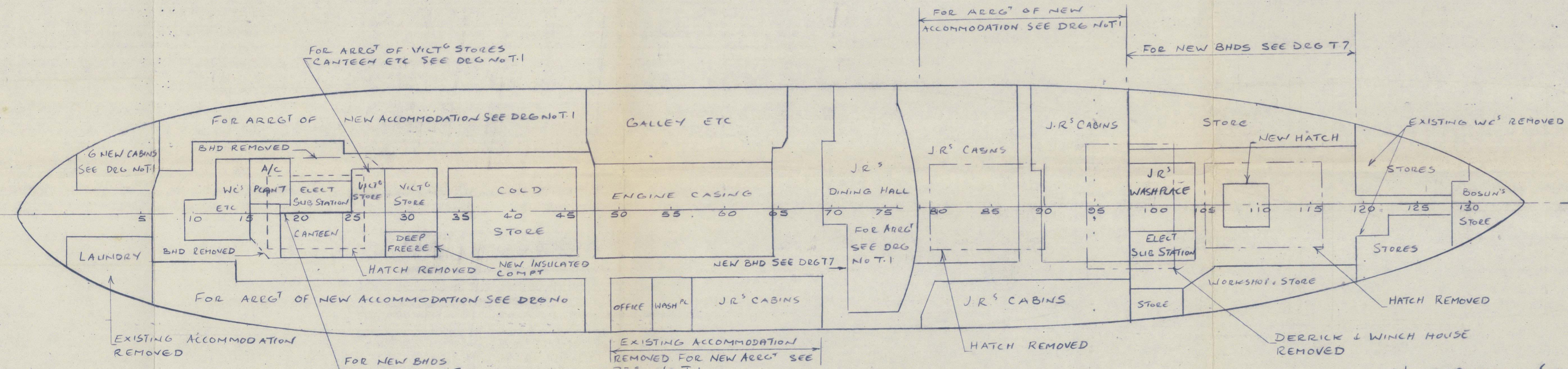

No 02 DECK (MAIN DK)

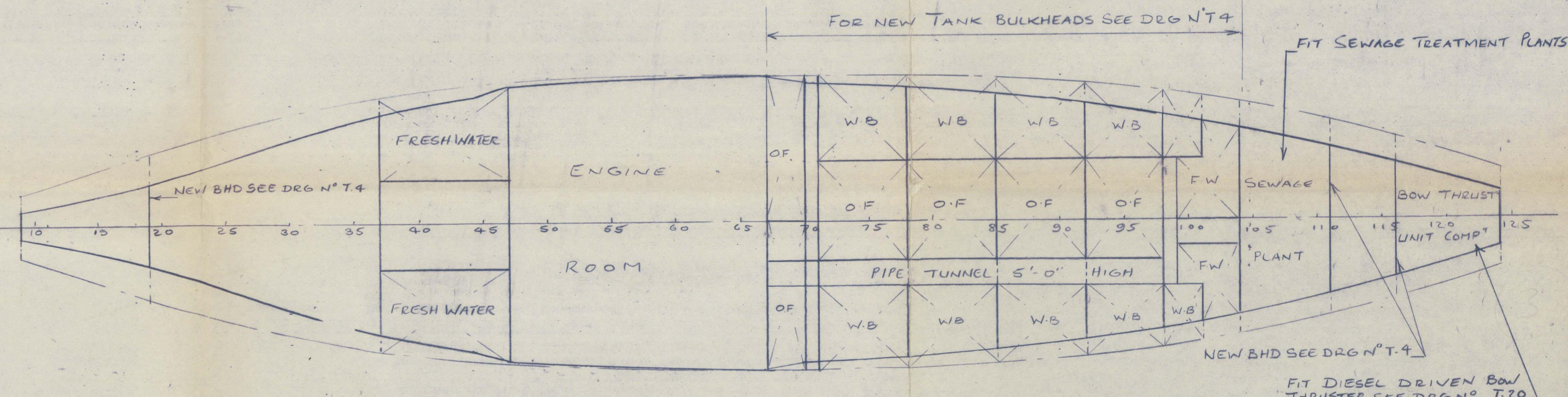

TANK TOP - No 05 DECK

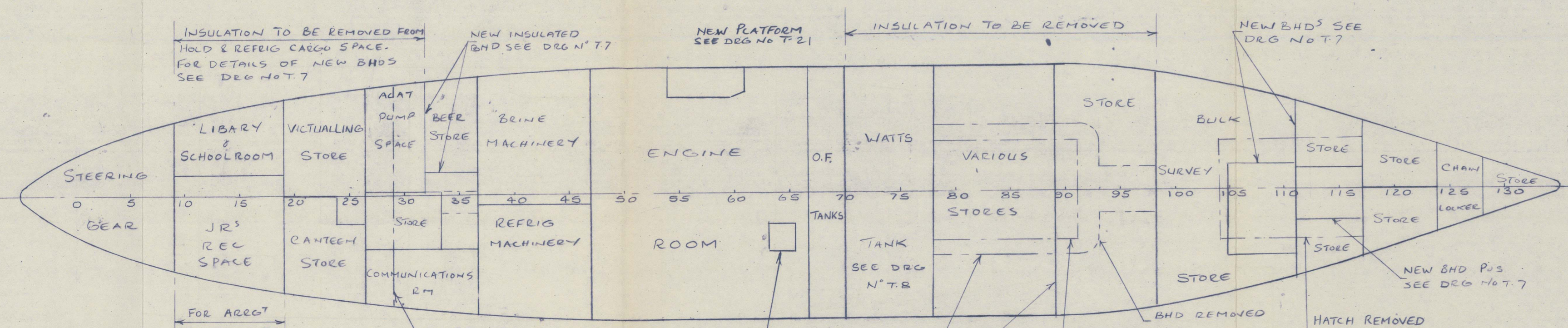

No 03 DECK (SECOND DK)

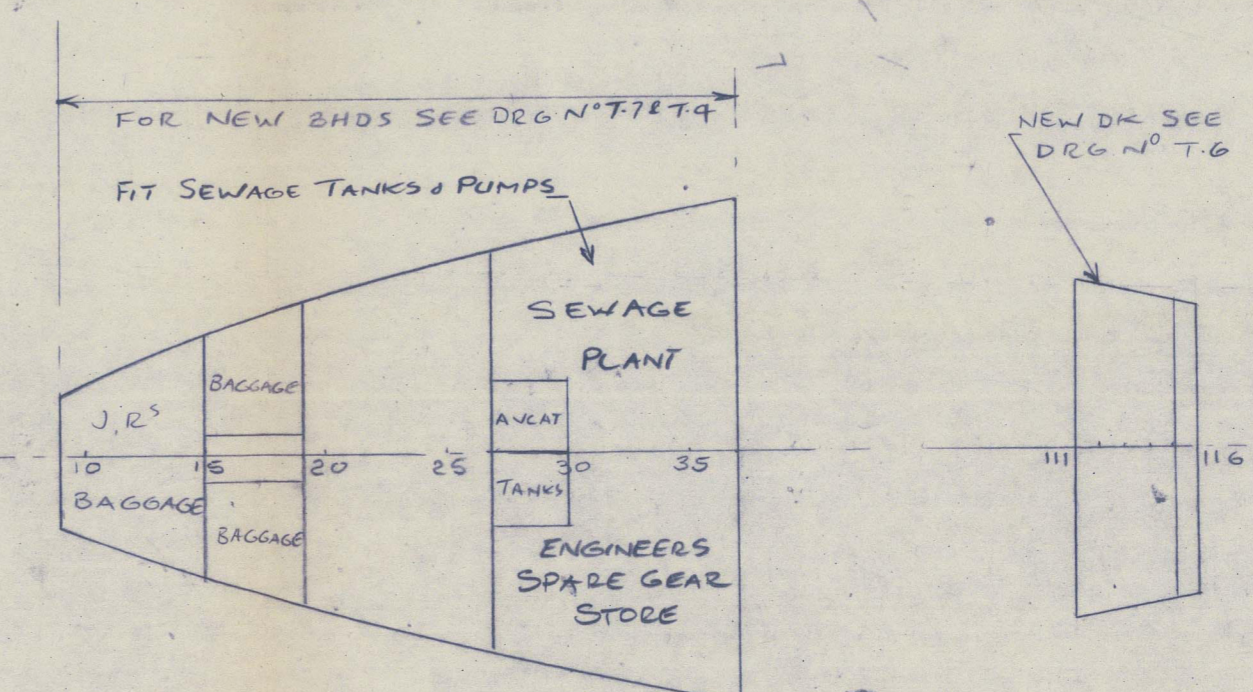

No 04 DECK

BURNES, CORLETT & PARTNERS LTD.  
NAVAL ARCHITECTS,  
- 2 JUL 1974  
MARINE CONSULTANTS  
BASINGSTOKE ENGLAND

FOR INFORMATION ONLY

**BURNES, CORLETT & PARTNERS LTD.**  
BASINGSTOKE, ENGLAND.  
NAVAL ARCHITECTS & MARINE CONSULTANTS.

PROJECT	TITLE
G.M.V. MOANA ROA	CONVERSION KEY PLAN
CONVERSION TO HYDROGRAPHIC SURVEY VESSEL FOR ROYAL NEW ZEALAND NAVY	SCALE - 1/16" TO 1 FOOT
REF No. J11662	DATE 1-7-74
DRAWN BY J.A.S.	ISSUED TO DATE
CHECKED BY	ISSUED TO DATE
APPROVED BY	ISSUED TO DATE

013884-013887-0002