

PRINCIPAL DIMENSIONS

LENGTH BETWEEN PERPENDICULARS-----135'-0"
 BREADTH MOULDED-----23'-6"
 DEPTH MOULDED-----11'-0"

ENGINES AND BOILER

BOILER:- 12'-0" DIAMETER x 10'-0" LONG
 ENGINES:- CYLINDERS 17" x 24" STROKE

| DISPLACEMENT IN TONS | DRAFT IN FEET | DEADWEIGHT IN TONS |
|-------------------------|------------------|-----------------------|
| 715 | 11 | 314 |
| 700 | 10 | 400 |
| 600 | 9 | 300 |
| 500 | 8 | 200 |
| 400 | 7 | 100 |
| 300 | 6 | 0 |
| | 5 | |
| | 4 | |

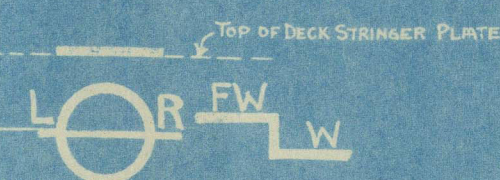

S.S. SANDHOLM GENERAL ARRANGEMENT

OF A
 STEEL SCREW STEAMER
 TO CARRY ABOUT 400 TONS DEADWEIGHT

SCALE $\frac{1}{8}$ " = ONE FOOT

MIDSHIP SECTION

SCALE $\frac{1}{2}$ " = 1 FT

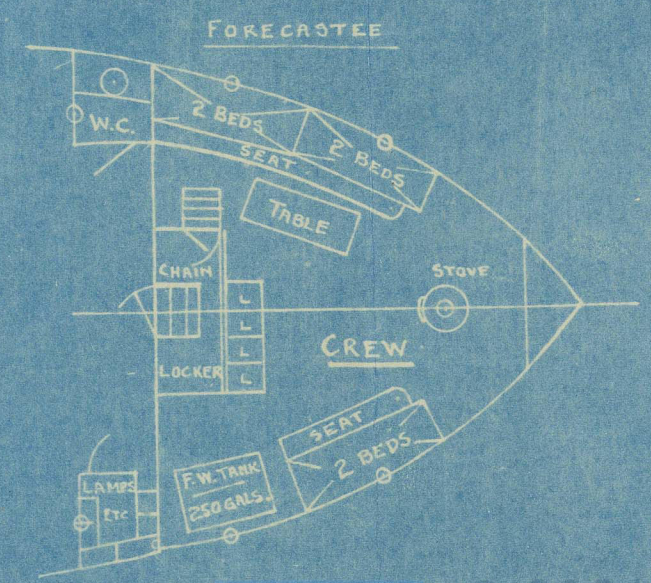
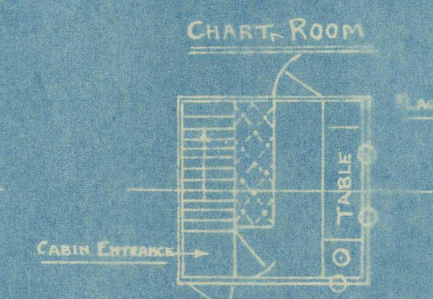
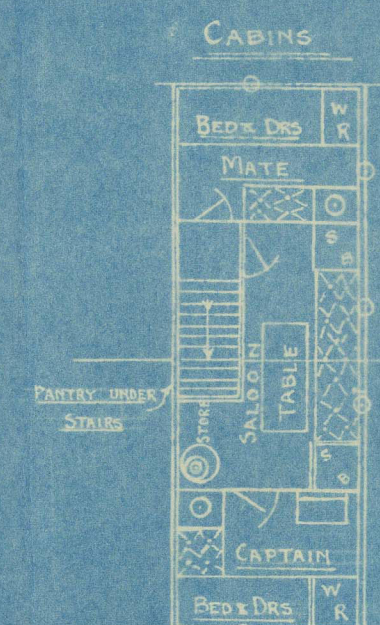
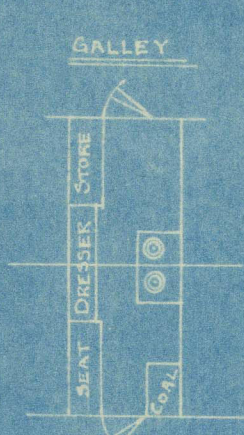
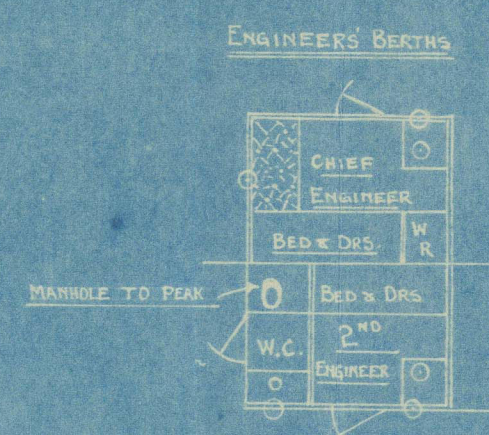
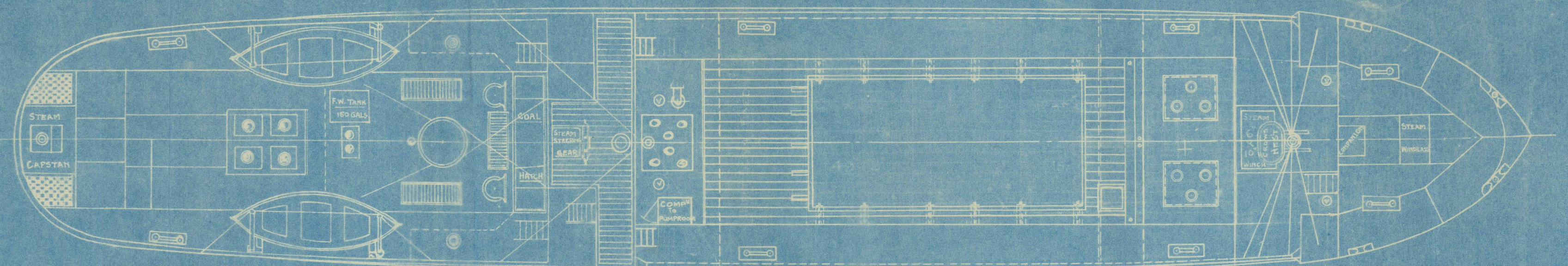
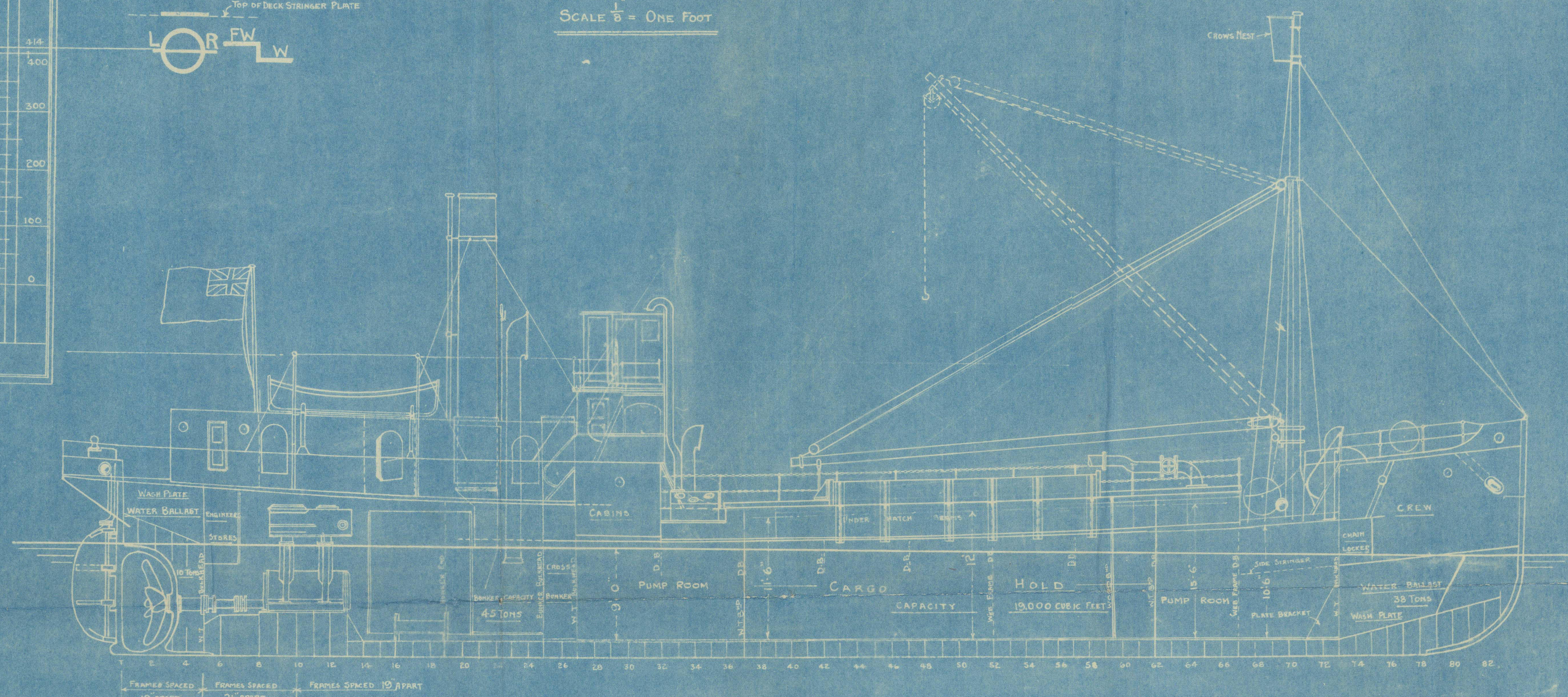

Sandholm.



01 440-014491-0040



© 2021

Lloyd's Register
Foundation