

— LLOYDS DIMENSIONS. —

LENGTH FROM AFTER PART OF STEM TO FORE PART OF STERNPOST = 313.2'
BREADTH MOULDED = 46.3 ¹⁴/₂₀'
DEPTH ASSUMING 1 1/2" ROUND OF BEAM = 23.1 ¹/₂'
13-54 DEPTHS IN LENGTH - 13-14 LESS 1 DEPTH FOR TRUNK STEAMER = 12-13.
6.76 BREADTHS IN LENGTH.

12.3.98
20.5.98 (P. 355)

— ELEVATION. —

— DIMENSIONS 315' x 46' 6" x 22' 2" MTD —

— SCALE 8' = ONE FOOT. —

— TO CLASS AT LLOYDS '100AL' STEEL 2 DK RULE TRUNK DK. —

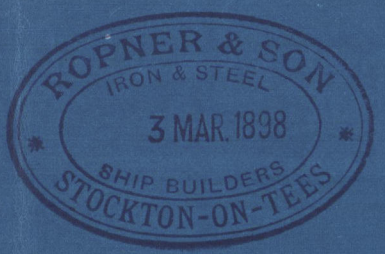

CHANNEL STANCHIONS MARKED THUS (S)

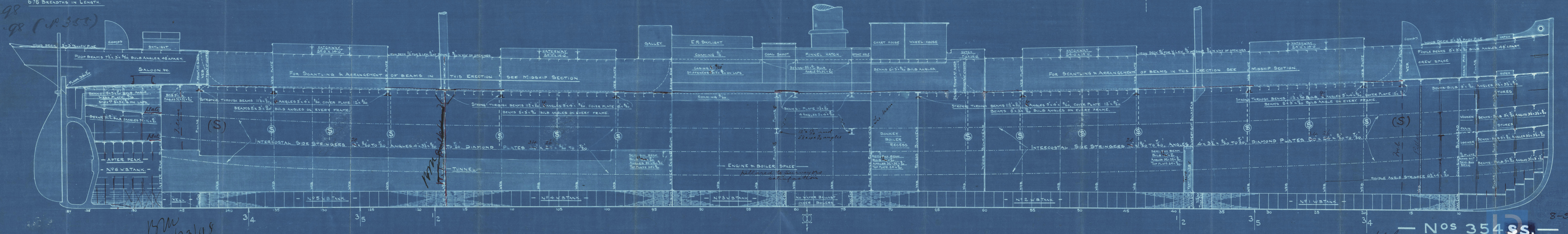

17/3/98

8-3-98
12/13/98
Nos 354 ss.
P. 355
Lloyd's Register
Foundation
MOB761-0083

© 2020

To be returned for guidance
in the survey of water vessels

MD8761-0083

Profile.
Popner Hon's
No 354

Notes

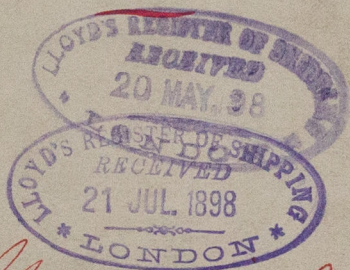

S.S. "Greenwich."
Abro Report - No 2520

MOB761-0083

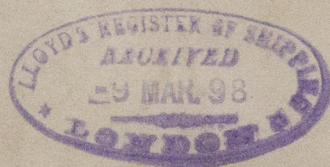

© 2020

Lloyd's Register
Foundation