

LIST OF CHARGE NUMBERS

CHARGE NO.	DESCRIPTION
A 200	ERECTOR DRAWINGS
A 201	RUDDER
A 202	SHELL PLATING, BULGE KEEL, BULKHEAD BRACKETS,
A 203	MARGIN IS, DOUBLERS, LINERS,
A 204	DOUBLER PLATES FOR DOCKING PLATES
A 205	BULKHEAD RAILING
A 206	INNER BOTTOM PLATES, BOUNDARY IS, LINERS, MANHOLE
A 207	COVERS, RINGS AND GASKETS
A 208	INNER BOTTOM LINERS
A 209	DYNAMO AND WELFLAT PLATES, LINERS AND BOUNDARY IS
A 210	2ND DECK PLATES, MARGIN IS, DOUBLERS, DOUBLES,
A 211	ACCESS-HOLE COVERS, INTERCOSTAL IS AND LINERS
A 212	UPPER DECK PLATES, MARGIN IS, DOUBLERS, LINERS AND
A 213	INTERCOSTAL IS
A 214	FORECASTLE, BRIDGE, POOP DECK PLATES, MARGIN IS,
A 215	DOUBLERS, LINERS, CURBS FOR HATCHES AND BUTT STRIPS,
A 216	BULKHEADS 62, 71, 87, 98, 109, 116, 155, 65, 76, 77, 40, 73,
A 217	71, 87, 81, 107, 116, 155, 65, 76, 77, 40, 73,
A 218	71, 87, 81, 107, 116, 155, 65, 76, 77, 40, 73,
A 219	71, 87, 81, 107, 116, 155, 65, 76, 77, 40, 73,
A 220	71, 87, 81, 107, 116, 155, 65, 76, 77, 40, 73,
A 221	71, 87, 81, 107, 116, 155, 65, 76, 77, 40, 73,
A 222	71, 87, 81, 107, 116, 155, 65, 76, 77, 40, 73,
A 223	71, 87, 81, 107, 116, 155, 65, 76, 77, 40, 73,
A 224	71, 87, 81, 107, 116, 155, 65, 76, 77, 40, 73,
A 225	71, 87, 81, 107, 116, 155, 65, 76, 77, 40, 73,
A 226	71, 87, 81, 107, 116, 155, 65, 76, 77, 40, 73,
A 227	71, 87, 81, 107, 116, 155, 65, 76, 77, 40, 73,
A 228	71, 87, 81, 107, 116, 155, 65, 76, 77, 40, 73,
A 229	71, 87, 81, 107, 116, 155, 65, 76, 77, 40, 73,
A 230	71, 87, 81, 107, 116, 155, 65, 76, 77, 40, 73,
A 231	71, 87, 81, 107, 116, 155, 65, 76, 77, 40, 73,
A 232	71, 87, 81, 107, 116, 155, 65, 76, 77, 40, 73,
A 233	71, 87, 81, 107, 116, 155, 65, 76, 77, 40, 73,
A 234	71, 87, 81, 107, 116, 155, 65, 76, 77, 40, 73,
A 235	71, 87, 81, 107, 116, 155, 65, 76, 77, 40, 73,
A 236	71, 87, 81, 107, 116, 155, 65, 76, 77, 40, 73,
A 237	71, 87, 81, 107, 116, 155, 65, 76, 77, 40, 73,
A 238	71, 87, 81, 107, 116, 155, 65, 76, 77, 40, 73,
A 239	71, 87, 81, 107, 116, 155, 65, 76, 77, 40, 73,
A 240	71, 87, 81, 107, 116, 155, 65, 76, 77, 40, 73,
A 241	71, 87, 81, 107, 116, 155, 65, 76, 77, 40, 73,
A 242	71, 87, 81, 107, 116, 155, 65, 76, 77, 40, 73,
A 243	71, 87, 81, 107, 116, 155, 65, 76, 77, 40, 73,
A 244	71, 87, 81, 107, 116, 155, 65, 76, 77, 40, 73,
A 245	71, 87, 81, 107, 116, 155, 65, 76, 77, 40, 73,
A 246	71, 87, 81, 107, 116, 155, 65, 76, 77, 40, 73,
A 247	71, 87, 81, 107, 116, 155, 65, 76, 77, 40, 73,
A 248	71, 87, 81, 107, 116, 155, 65, 76, 77, 40, 73,
A 249	71, 87, 81, 107, 116, 155, 65, 76, 77, 40, 73,
A 250	71, 87, 81, 107, 116, 155, 65, 76, 77, 40, 73,
A 251	71, 87, 81, 107, 116, 155, 65, 76, 77, 40, 73,
A 252	71, 87, 81, 107, 116, 155, 65, 76, 77, 40, 73,
A 253	71, 87, 81, 107, 116, 155, 65, 76, 77, 40, 73,
A 254	71, 87, 81, 107, 116, 155, 65, 76, 77, 40, 73,
A 255	71, 87, 81, 107, 116, 155, 65, 76, 77, 40, 73,
A 256	71, 87, 81, 107, 116, 155, 65, 76, 77, 40, 73,
A 257	71, 87, 81, 107, 116, 155, 65, 76, 77, 40, 73,
A 258	71, 87, 81, 107, 116, 155, 65, 76, 77, 40, 73,
A 259	71, 87, 81, 107, 116, 155, 65, 76, 77, 40, 73,
A 260	71, 87, 81, 107, 116, 155, 65, 76, 77, 40, 73,
A 261	71, 87, 81, 107, 116, 155, 65, 76, 77, 40, 73,
A 262	71, 87, 81, 107, 116, 155, 65, 76, 77, 40, 73,
A 263	71, 87, 81, 107, 116, 155, 65, 76, 77, 40, 73,
A 264	71, 87, 81, 107, 116, 155, 65, 76, 77, 40, 73,
A 265	71, 87, 81, 107, 116, 155, 65, 76, 77, 40, 73,
A 266	71, 87, 81, 107, 116, 155, 65, 76, 77, 40, 73,
A 267	71, 87, 81, 107, 116, 155, 65, 76, 77, 40, 73,
A 268	71, 87, 81, 107, 116, 155, 65, 76, 77, 40, 73,
A 269	71, 87, 81, 107, 116, 155, 65, 76, 77, 40, 73,
A 270	71, 87, 81, 107, 116, 155, 65, 76, 77, 40, 73,
A 271	71, 87, 81, 107, 116, 155, 65, 76, 77, 40, 73,
A 272	71, 87, 81, 107, 116, 155, 65, 76, 77, 40, 73,
A 273	71, 87, 81, 107, 116, 155, 65, 76, 77, 40, 73,
A 274	71, 87, 81, 107, 116, 155, 65, 76, 77, 40, 73,
A 275	71, 87, 81, 107, 116, 155, 65, 76, 77, 40, 73,
A 276	71, 87, 81, 107, 116, 155, 65, 76, 77, 40, 73,
A 277	71, 87, 81, 107, 116, 155, 65, 76, 77, 40, 73,
A 278	71, 87, 81, 107, 116, 155, 65, 76, 77, 40, 73,
A 279	71, 87, 81, 107, 116, 155, 65, 76, 77, 40, 73,
A 280	71, 87, 81, 107, 116, 155, 65, 76, 77, 40, 73,
A 281	71, 87, 81, 107, 116, 155, 65, 76, 77, 40, 73,
A 282	71, 87, 81, 107, 116, 155, 65, 76, 77, 40, 73,
A 283	71, 87, 81, 107, 116, 155, 65, 76, 77, 40, 73,
A 284	71, 87, 81, 107, 116, 155, 65, 76, 77, 40, 73,
A 285	71, 87, 81, 107, 116, 155, 65, 76, 77, 40, 73,
A 286	71, 87, 81, 107, 116, 155, 65, 76, 77, 40, 73,
A 287	71, 87, 81, 107, 116, 155, 65, 76, 77, 40, 73,
A 288	71, 87, 81, 107, 116, 155, 65, 76, 77, 40, 73,
A 289	71, 87, 81, 107, 116, 155, 65, 76, 77, 40, 73,
A 290	71, 87, 81, 107, 116, 155, 65, 76, 77, 40, 73,
A 291	71, 87, 81, 107, 116, 155, 65, 76, 77, 40, 73,
A 292	71, 87, 81, 107, 116, 155, 65, 76, 77, 40, 73,
A 293	71, 87, 81, 107, 116, 155, 65, 76, 77, 40, 73,
A 294	71, 87, 81, 107, 116, 155, 65, 76, 77, 40, 73,
A 295	71, 87, 81, 107, 116, 155, 65, 76, 77, 40, 73,
A 296	71, 87, 81, 107, 116, 155, 65, 76, 77, 40, 73,
A 297	71, 87, 81, 107, 116, 155, 65, 76, 77, 40, 73,
A 298	71, 87, 81, 107, 116, 155, 65, 76, 77, 40, 73,
A 299	71, 87, 81, 107, 116, 155, 65, 76, 77, 40, 73,
A 300	71, 87, 81, 107, 116, 155, 65, 76, 77, 40, 73,



LIST OF ERECTION DRAWINGS

FILE NO.	DESCRIPTION	FILE NO.	DESCRIPTION	FILE NO.
1	LONGITUDINAL AND TRANSVERSE SECTIONS	24	BANDS 19, 62, 116, 157	F 6444
2	PLAN OF BOTTOM SHELL FORD FR 52	25	BRIDGE DECK HOUSE FORD	F 6445
3	PLAN OF BOTTOM SHELL FR 52 TO 115	26	PLAN BRIDGE DECK	F 6446
4	PLAN OF BOTTOM SHELL AFT FR 115	27	PLAN BRIDGE DECK ENGINE HATCH, FIDLEY TOP	F 6447
5	PLAN OF INNER BOTTOM FORD FR 52	28	PLAN BRIDGE DECK ENGINE HATCH, FIDLEY TOP	F 6448
6	PLAN OF INNER BOTTOM FR 52 TO 115	29	ENGINE AND BOILER CASING - LONGITUDINAL	F 6449
7	PLAN OF INNER BOTTOM AFT FR 115	30	ENGINE AND BOILER CASING - LONGITUDINAL	F 6450
8	PLAN OF 2ND DECK FORD FR 52	31	ENGINE AND BOILER CASING - TRANSVERSE	F 6451
9	PLAN OF 2ND DECK AFT FR 115	32	ENGINE AND BOILER CASING - TRANSVERSE	F 6452
10	PLAN OF 2ND DECK FR 52 TO 115	33	ENGINE AND BOILER CASING - TRANSVERSE	F 6453
11	PLAN OF 2ND DECK FR 115	34	ENGINE AND BOILER CASING - TRANSVERSE	F 6454
12	PLAN OF 2ND DECK FORD FR 52	35	ENGINE AND BOILER CASING - TRANSVERSE	F 6455
13	PLAN OF 2ND DECK AFT FR 115	36	ENGINE AND BOILER CASING - TRANSVERSE	F 6456
14	PLAN OF 2ND DECK FR 115	37	ENGINE AND BOILER CASING - TRANSVERSE	F 6457
15	STARBOARD SIDE SHELL FORD FR 52	38	ENGINE AND BOILER CASING - TRANSVERSE	F 6458
16	STARBOARD SIDE SHELL FR 52 TO 115	39	ENGINE AND BOILER CASING - TRANSVERSE	F 6459
17	STARBOARD SIDE SHELL AFT FR 115	40	ENGINE AND BOILER CASING - TRANSVERSE	F 6460
18	STARBOARD SIDE SHELL FR 115	41	ENGINE AND BOILER CASING - TRANSVERSE	F 6461
19	STARBOARD SIDE SHELL FORD FR 52	42	ENGINE AND BOILER CASING - TRANSVERSE	F 6462
20	STARBOARD SIDE SHELL AFT FR 115	43	ENGINE AND BOILER CASING - TRANSVERSE	F 6463
21	STARBOARD SIDE SHELL FR 115	44	ENGINE AND BOILER CASING - TRANSVERSE	F 6464
22	STARBOARD SIDE SHELL FORD FR 52	45	ENGINE AND BOILER CASING - TRANSVERSE	F 6465
23	STARBOARD SIDE SHELL AFT FR 115	46	ENGINE AND BOILER CASING - TRANSVERSE	F 6466
24	STARBOARD SIDE SHELL FR 115	47	ENGINE AND BOILER CASING - TRANSVERSE	F 6467
25	STARBOARD SIDE SHELL FORD FR 52	48	ENGINE AND BOILER CASING - TRANSVERSE	F 6468
26	STARBOARD SIDE SHELL AFT FR 115	49	ENGINE AND BOILER CASING - TRANSVERSE	F 6469
27	STARBOARD SIDE SHELL FR 115	50	ENGINE AND BOILER CASING - TRANSVERSE	F 6470
28	STARBOARD SIDE SHELL FORD FR 52	51	ENGINE AND BOILER CASING - TRANSVERSE	F 6471
29	STARBOARD SIDE SHELL AFT FR 115	52	ENGINE AND BOILER CASING - TRANSVERSE	F 6472
30	STARBOARD SIDE SHELL FR 115	53	ENGINE AND BOILER CASING - TRANSVERSE	F 6473
31	STARBOARD SIDE SHELL FORD FR 52	54	ENGINE AND BOILER CASING - TRANSVERSE	F 6474
32	STARBOARD SIDE SHELL AFT FR 115	55	ENGINE AND BOILER CASING - TRANSVERSE	F 6475
33	STARBOARD SIDE SHELL FR 115	56	ENGINE AND BOILER CASING - TRANSVERSE	F 6476
34	STARBOARD SIDE SHELL FORD FR 52	57	ENGINE AND BOILER CASING - TRANSVERSE	F 6477
35	STARBOARD SIDE SHELL AFT FR 115	58	ENGINE AND BOILER CASING - TRANSVERSE	F 6478
36	STARBOARD SIDE SHELL FR 115	59	ENGINE AND BOILER CASING - TRANSVERSE	F 6479
37	STARBOARD SIDE SHELL FORD FR 52	60	ENGINE AND BOILER CASING - TRANSVERSE	F 6480
38	STARBOARD SIDE SHELL AFT FR 115	61	ENGINE AND BOILER CASING - TRANSVERSE	F 6481
39	STARBOARD SIDE SHELL FR 115	62	ENGINE AND BOILER CASING - TRANSVERSE	F 6482
40	STARBOARD SIDE SHELL FORD FR 52	63	ENGINE AND BOILER CASING - TRANSVERSE	F 6483
41	STARBOARD SIDE SHELL AFT FR 115	64	ENGINE AND BOILER CASING - TRANSVERSE	F 6484
42	STARBOARD SIDE SHELL FR 115	65	ENGINE AND BOILER CASING - TRANSVERSE	F 6485
43	STARBOARD SIDE SHELL FORD FR 52	66	ENGINE AND BOILER CASING - TRANSVERSE	F 6486
44	STARBOARD SIDE SHELL AFT FR 115	67	ENGINE AND BOILER CASING - TRANSVERSE	F 6487
45	STARBOARD SIDE SHELL FR 115	68	ENGINE AND BOILER CASING - TRANSVERSE	F 6488
46	STARBOARD SIDE SHELL FORD FR 52	69	ENGINE AND BOILER CASING - TRANSVERSE	F 6489
47	STARBOARD SIDE SHELL AFT FR 115	70	ENGINE AND BOILER CASING - TRANSVERSE	F 6490
48	STARBOARD SIDE SHELL FR 115	71	ENGINE AND BOILER CASING - TRANSVERSE	F 6491
49	STARBOARD SIDE SHELL FORD FR 52	72	ENGINE AND BOILER CASING - TRANSVERSE	F 6492
50	STARBOARD SIDE SHELL AFT FR 115	73	ENGINE AND BOILER CASING - TRANSVERSE	F 6493
51	STARBOARD SIDE SHELL FR 115	74	ENGINE AND BOILER CASING - TRANSVERSE	F 6494
52	STARBOARD SIDE SHELL FORD FR 52	75	ENGINE AND BOILER CASING - TRANSVERSE	F 6495
53	STARBOARD SIDE SHELL AFT FR 115	76	ENGINE AND BOILER CASING - TRANSVERSE	F 6496
54	STARBOARD SIDE SHELL FR 115	77	ENGINE AND BOILER CASING - TRANSVERSE	F 6497
55	STARBOARD SIDE SHELL FORD FR 52	78	ENGINE AND BOILER CASING - TRANSVERSE	F 6498
56	STARBOARD SIDE SHELL AFT FR 115	79	ENGINE AND BOILER CASING - TRANSVERSE	F 6499
57	STARBOARD SIDE SHELL FR 115	80	ENGINE AND BOILER CASING - TRANSVERSE	F 6500
58	STARBOARD SIDE SHELL FORD FR 52	81	ENGINE AND BOILER CASING - TRANSVERSE	F 6501
59	STARBOARD SIDE SHELL AFT FR 115	82	ENGINE AND BOILER CASING - TRANSVERSE	F 6502
60	STARBOARD SIDE SHELL FR 115	83	ENGINE AND BOILER CASING - TRANSVERSE	F 6503
61	STARBOARD SIDE SHELL FORD FR 52	84	ENGINE AND BOILER CASING - TRANSVERSE	F 6504
62	STARBOARD SIDE SHELL AFT FR 115	85	ENGINE AND BOILER CASING - TRANSVERSE	F 6505
63	STARBOARD SIDE SHELL FR 115	86	ENGINE AND BOILER CASING - TRANSVERSE	F 6506
64	STARBOARD SIDE SHELL FORD FR 52	87	ENGINE AND BOILER CASING - TRANSVERSE	F 6507
65	STARBOARD SIDE SHELL AFT FR 115	88	ENGINE AND BOILER CASING - TRANSVERSE	F 6508
66	STARBOARD SIDE SHELL FR 115	89	ENGINE AND BOILER CASING - TRANSVERSE	F 6509
67	STARBOARD SIDE SHELL FORD FR 52	90	ENGINE AND BOILER CASING - TRANSVERSE	F 6510
68	STARBOARD SIDE SHELL AFT FR 115	91	ENGINE AND BOILER CASING - TRANSVERSE	F 6511
69	STARBOARD SIDE SHELL FR 115	92	ENGINE AND BOILER CASING - TRANSVERSE	F 6512
70	STARBOARD SIDE SHELL FORD FR 52	93	ENGINE AND BOILER CASING - TRANSVERSE	F 6513
71	STARBOARD SIDE SHELL AFT FR 115	94	ENGINE AND BOILER CASING - TRANSVERSE	F 6514
72	STARBOARD SIDE SHELL FR 115	95	ENGINE AND BOILER CASING - TRANSVERSE	F 6515
73	STARBOARD SIDE SHELL FORD FR 52	96	ENGINE AND BOILER CASING - TRANSVERSE	F 6516
74	STARBOARD SIDE SHELL AFT FR 115	97	ENGINE AND BOILER CASING - TRANSVERSE	F 6517
75	STARBOARD SIDE SHELL FR 115	98	ENGINE AND BOILER CASING - TRANSVERSE	F 6518
76	STARBOARD SIDE SHELL FORD FR 52	99	ENGINE AND BOILER CASING - TRANSVERSE	F 6519
77	STARBOARD SIDE SHELL AFT FR 115	100	ENGINE AND BOILER CASING - TRANSVERSE	F 6520

"A" SHIP
LONGITUDINAL AND TRANSVERSE SECTIONS
7500 TON D. W. CARGO SHIP
UNITED STATES SHIPPING BOARD
EMERGENCY FLEET CORPORATION
AMERICAN INTERNATIONAL SHIPBUILDING CORPORATION
PHILADELPHIA OFFICE
R 6745

Profile
D.D. "Schodack" No 512.
A. J. D.C. Hog Island

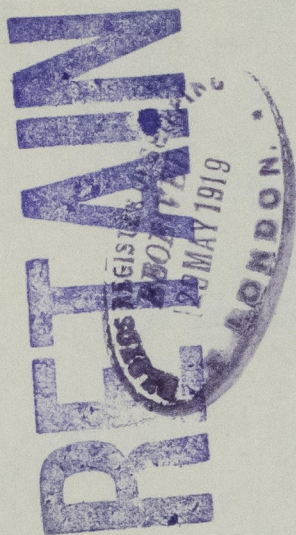

Plb 3229.

W1582-0085



© 2021

Lloyd's Register
Foundation

ISSUED
AMERICAN INSTITUTE
MAR 4 1910
SHIPBUILDING CO. H. I.
DRAFTING ROOM
HOG ISLAND, PA.

W1532-0085



© 2021

Lloyd's Register
Foundation