

3 11-15  
16-2-14  
18-3-16  
18-6-16  
28-12-16

N<sup>o</sup> 5.

S.S. "N<sup>o</sup> 277."

Midship section. Scale 1:24.

Class 100 A I.

Principal dimensions and numbers

Length between S.P.	420'-0"
Breadth	54'-0"
Depth to upper deck	30'-0"
Bridge	37'-9"
B + D	54'-30"
L x (B + D)	420 x 84
L for second deck	30 - (3.67 x 7.75) = 18.58
L for third	30 - (3.67 x 7.75 x 7.5) = 11.08
L to bridge deck	420 - 37.75 = 382.25
L to upper deck	420 - 30 = 390
Equipment	38240

Fore castle

Side plating	42'-0"
Stinger angle	3 1/2 x 3 1/2 x 36'
Plating	36'
Wood deck	2 1/2"
Beams to every frame	5' x 5 1/2' x 42' welded knees

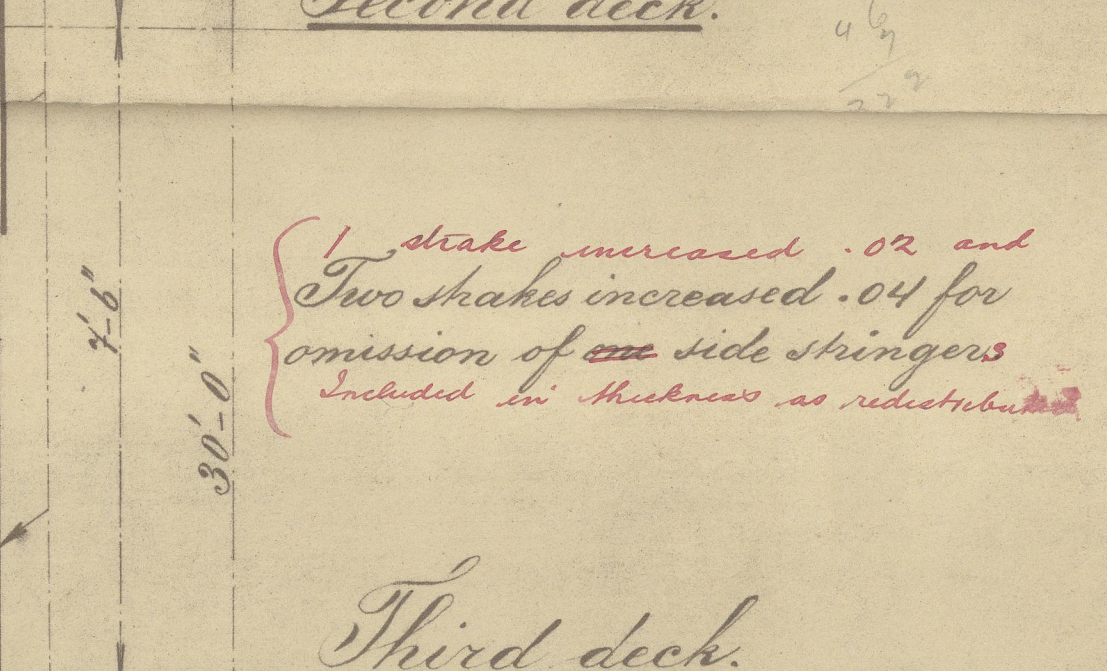
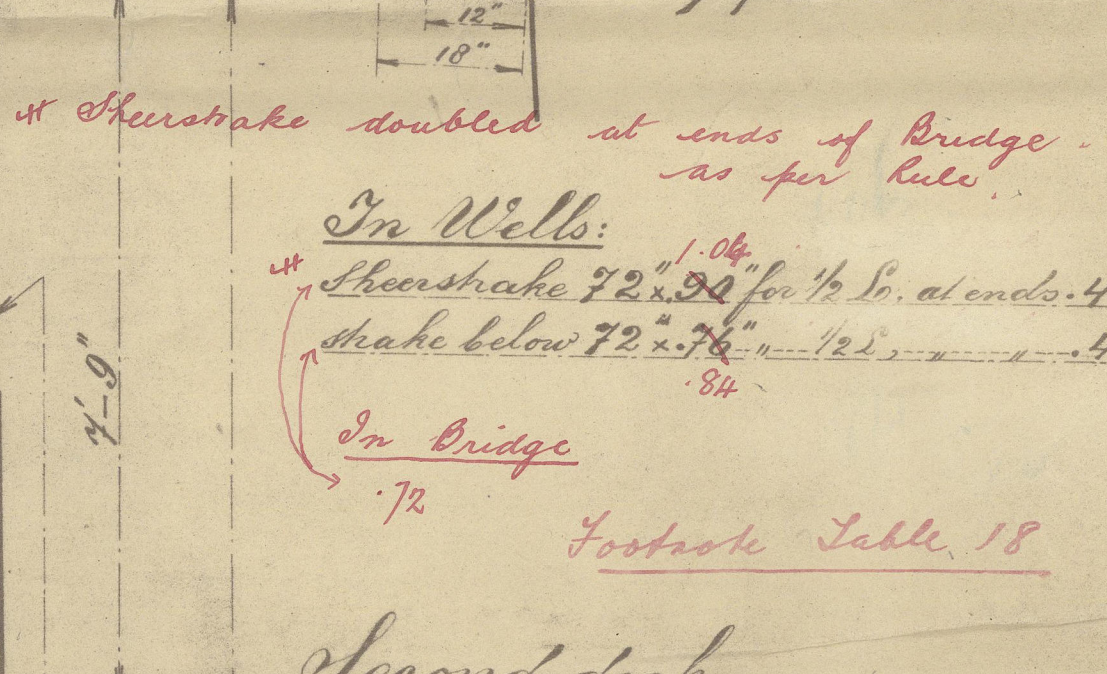
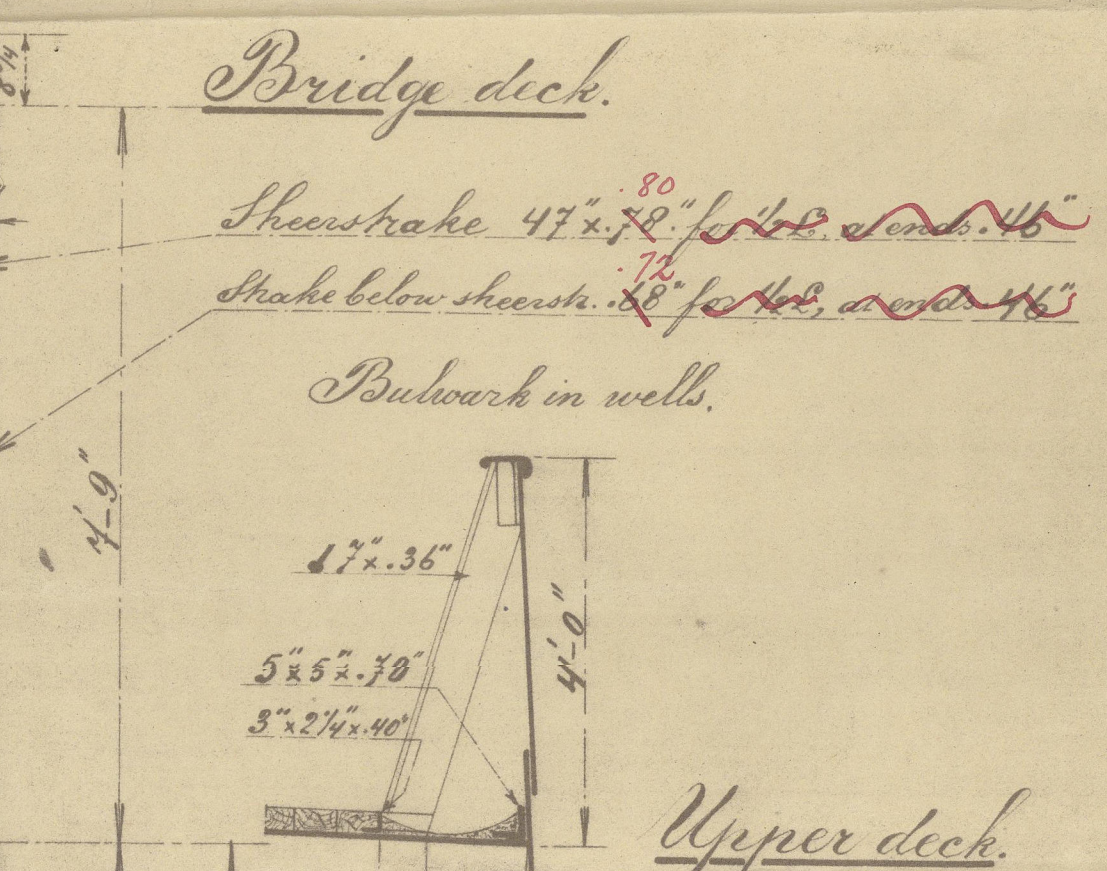
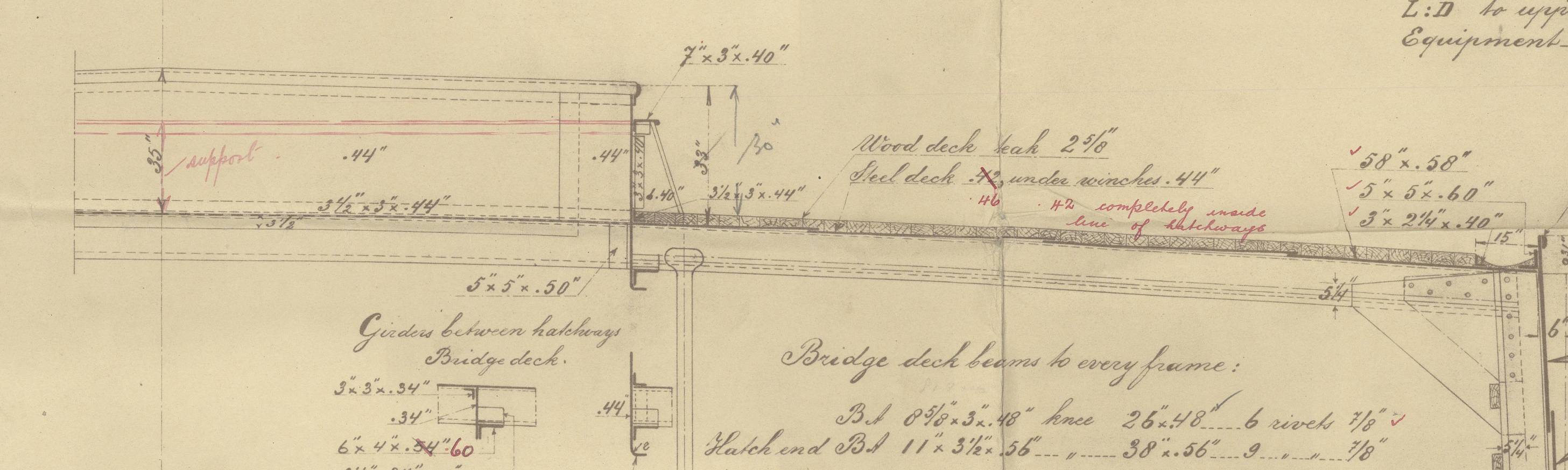
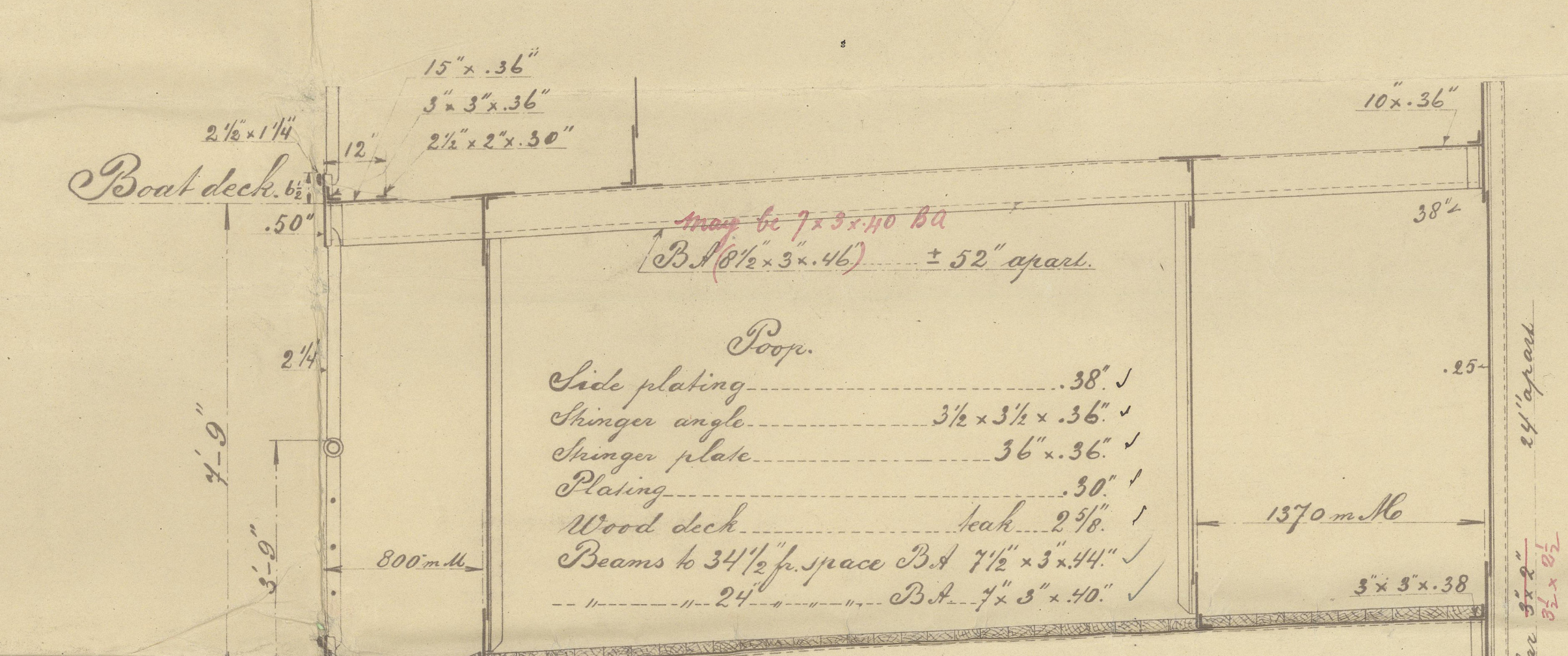

Equipment

2 Heckles anchors	01.5 Cwt	coll. weight 253.5 Cwt
1 anchor	70.0	20% above Rule
1 Kedge	(ex stock)	19.0 Cwt
270 Gutters steel chain cable	2 1/2 inches	
30 steel wire	8 1/4	
120 steel wire	5 1/4	
4 x 120 steel wire	5 1/4	
2 x 120 manilla rope (cable laid)	8 1/2	
2 x 120 manilla rope (cable laid)	8 1/2	

**Riveting.**

- Butts flat plate keel double sharp held riveted throughout
- bottom and edge plating quadruple riveted at ends
- side plating to stabs below sheerstrake 3/4" at ends
- best plate quadruple riveted
- Bridge keels and stabs below quadruple riveted
- Upper deck sheerstrake double sharp held riveted for pl. above 84'
- at ends quadruple riveted last 10 ft. for pl. above 84'-68'
- stabs below sheerstrake for pl. above 60' quadruple riveted
- at ends held riveted not exceeding 68'
- Side plating Pop and Fore castle double riveted
- Stinger plate Bridge and upper deck held riveted
- at second and third deck held in double bottom
- plates of all decks double for 10 ft. single at ends not exceeding 102'
- center girder in double bottom held riveted throughout
- margin plate single sharp held double at ends where not exceeding 102'
- middle line of double bottom held in pop & double at ends where not exceeding 102'
- remainder plating double 10' single
- Edges outside plating double riveted
- side plating Pop and Fore castle single
- of all deck plating single
- middle line stabs of double bottom double
- remainder stabs single

**Diameter of rivets.**

Outside pl.

- Flat plate keel for plates above 88' 1 1/2" for remainder plates 1"
- Bottom and side pl. for pl. above 66' 1 1/2"
- Sheerstrake and stabs below 66' 1 1/2"
- Side plating Pop and Fore castle 1"
- Outside plating to frames and side girders for 10 ft. 1"
- at ends 1 1/2"
- Flat plate keel to center girder 1 1/2"

**Double bottom**

- Center girder, and angle on top and bottom through center girder
- and middle line stabs of double bottom 1 1/2"
- Inner bottom pl. floor and side girders in Engine and Boiler space 1 1/2"
- at ends 1 1/2"
- remainder 1"

**Decks**

- Bridge and Upper deck stinger where above 40' 3/4"
| 1. remainder | 3/4" |
- Second and third deck 3/4"
- Remainder plating of all decks 3/4"
- Stinger and deck plating to beams of all decks 3/4"
- Brackets margin plate where single angle 2" double angle 1"

**Pillars less than 4" diam.** two rivets 3/4"

**5 and above** four 1"

**Frames in peaks**

10-14	B.S. 7' x 3 1/2' x 44' spaced 24"	34 1/2"
15-33	B.S. 9' x 3 1/2' x 51' spaced 24"	34 1/2"
34-60	B.S. 10' x 3 1/2' x 59' spaced 24"	34 1/2"
61-70	B.S. 11' x 3 1/2' x 61' spaced 24"	34 1/2"
71-110	B.S. 8' x 3 1/2' x 40' spaced 26"	26"

**Section in way of boiler space.**

Half beams connected to coverings of hatchways and casings by double angle 3 1/2' x 3 1/2' x 50' at each end frame remain the single

In each flange three rivets 78"

See for hatchways also de. R. 7. and for pillars de. R. 6.

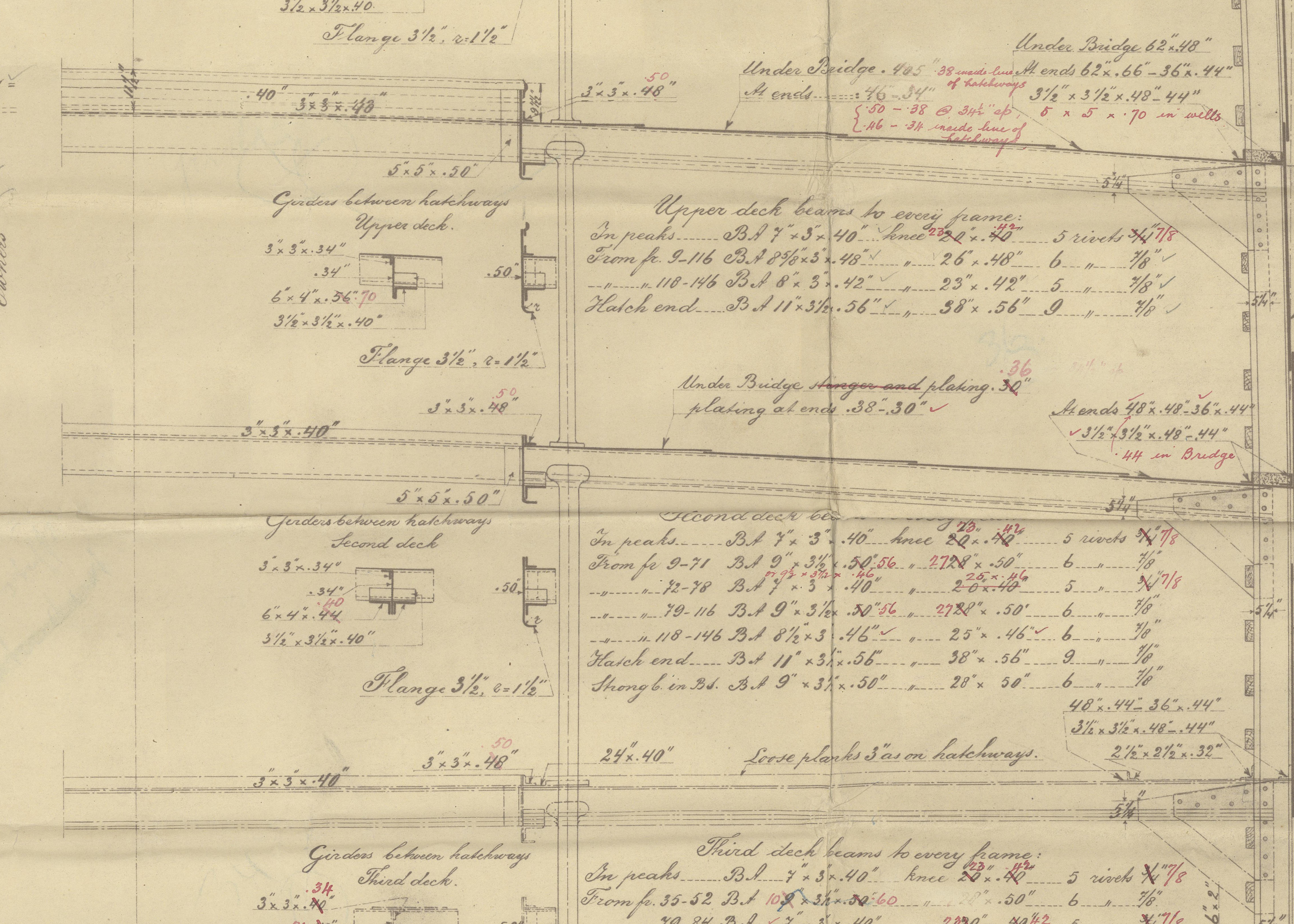
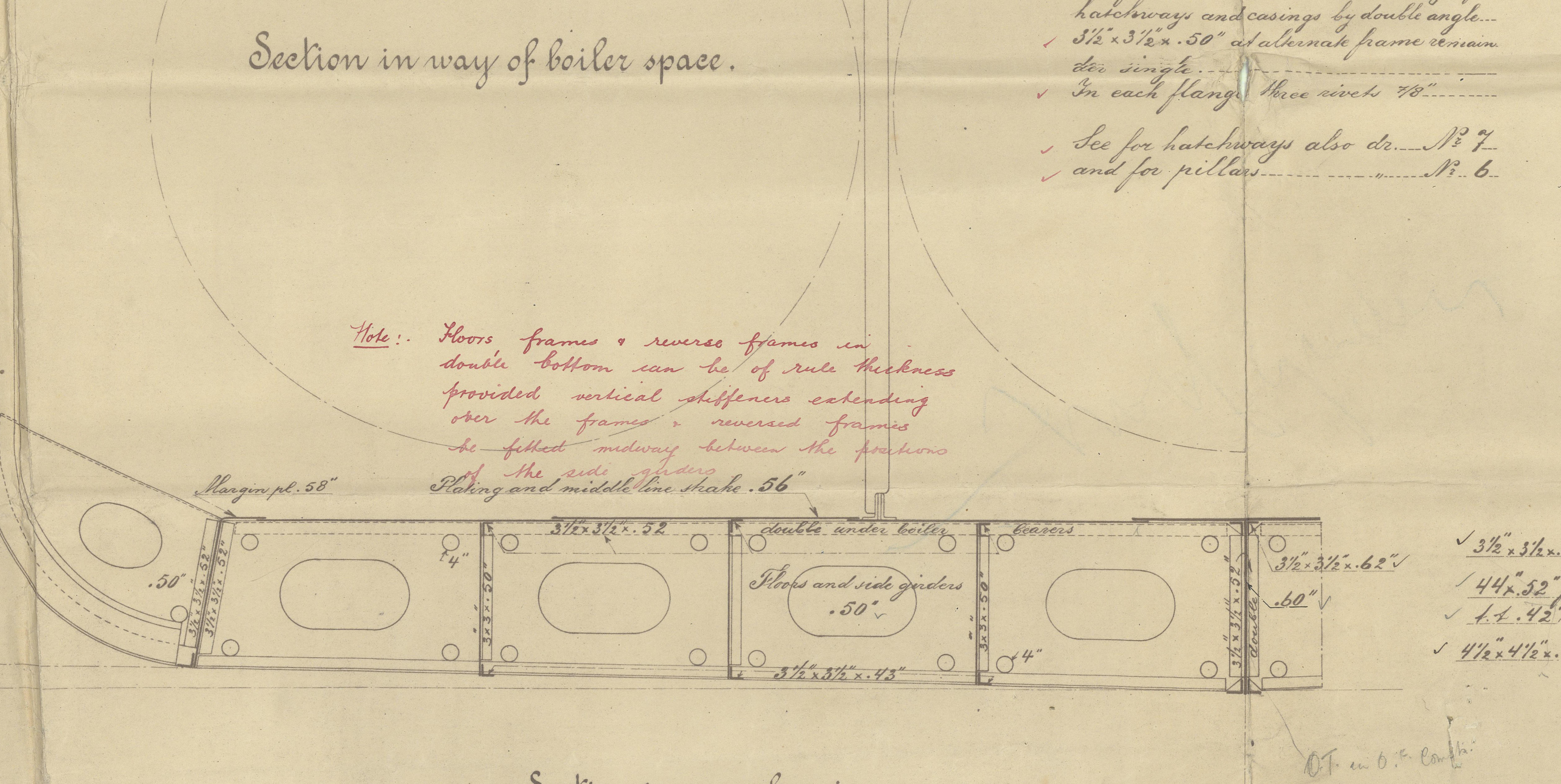

**Side plating.** 30' @ 20% spacing

78' for 10 ft. at ends 36' over with 20% in way of widely spaced frames

66' - 68' @ 22' spacing

46' in peaks

**Base plate 76"**

Plates connected stern frame 64"

This height to be maintained right up in view of thickness of side stringer

78' for 10 ft. at ends 36' over with 20% in way of widely spaced frames

66' - 68' @ 22' spacing

**Section in way of 26' frame space.**

Manholes in side girders 14 x 18"

Plating 40' x 36"

Stinger pl. 40"

Bottom strengthening from 10 ft. fore to coll. in ahead: three stabs of bottom plating midships thickness maintained, tank frames doubled. margin to margin.

Bottom sketch to be submitted

ETABLISSEMENT INGEGNIEUR ROTTERDAM.

N<sup>o</sup> 5.

Fryenoord, Oct. 1915.



S.S. Gjelleboel.

Plan of midship Section

Port of Rotterdam.

report. No. 10622<sup>a</sup>



277 midship Section

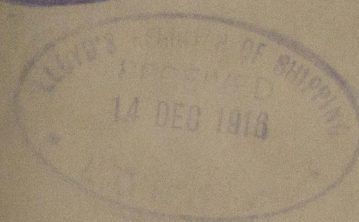
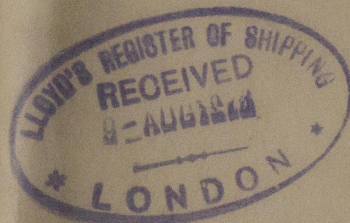
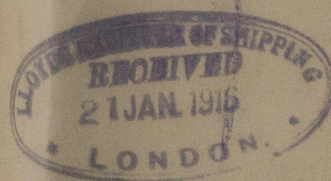

W223-0181



© 2019

Lloyd's Register  
Foundation